

# POOL & SPA WATER TESTS

Instr. #5113

1. Keep test kit out of reach of children.
2. Read precautions on all labels.
3. Store test kit in cool, dark place.
4. Replace reagents once each year.
5. Do not dispose of solutions in pool or spa.
6. Rinse cells before and after each test.
7. Obtain samples 18" (45 cm) below water surface.
8. Hold dropper bottle vertically when dispensing reagent.

## Total Chlorine/ Total Bromine Test

Test daily

Ideal Total Chlorine Range:  
2-4 ppm (pools or spas)

Ideal Total Bromine Range:  
2-3 ppm (pools) / 2-4 ppm (spas)

### STEP 1

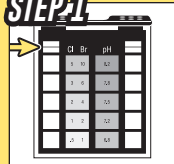

Rinse left test cell and fill with sample water up to black line.

### STEP 2

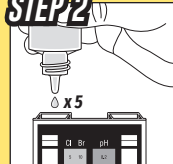

Add 5 drops R-0600.

### STEP 3

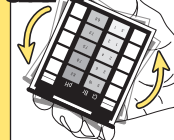

Cap and invert to mix (DO NOT SHAKE).

### STEP 4

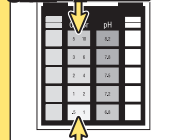

Match color with color standard. Record as parts per million (ppm) total chlorine or total bromine.\*

\* If any adjustments are needed, contact your local pool/spa supply store for recommendations. (over)

# pH Test

Test daily

Ideal pH Range: 7.4-7.6 (pools or spas)

## STEP 1

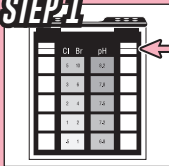

Rinse right test cell and fill with sample water up to black line.

## STEP 2

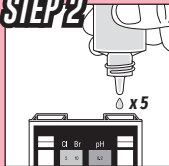

Add 5 drops R-0014.

## STEP 3



Cap and invert to mix (DO NOT SHAKE).

## STEP 4

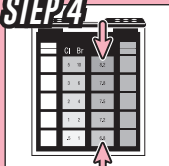

Match color with color standard. Record as pH units. If sample color is between two values, pH is average of the two.\*

\* If any adjustments are needed, contact your local pool/spa supply store for recommendations.

*Note: This kit is designed for testing water in residential pools and spas. Upgrading to a kit with additional tests is recommended for those with higher usage or recurrent water problems.*

Visit [web.suretreat.com](http://web.suretreat.com) to create an account, save your test results, and receive personalized treatment recommendations.

800-TEST KIT (837-8548) • [www.taylortechnologies.com](http://www.taylortechnologies.com)

 **taylor**<sup>®</sup>  
rev. 042519