

IMPORTANT

IMPORTANT: There are two types of Aqua Decals, **A** and **B**. When purchasing, please select the decal that is right for your pool.

- VINYL LINER POOLS require decal **A**. Decal A comes **with** pre-applied 3M adhesive for simple (Peel & Stick) installation.
(A) indicates decals with pre-applied adhesive.
- FIBERGLASS and CONCRETE POOLS require decal **B**. Decal B comes **without** pre-applied adhesive; BOSS 803 (3 oz tube) or BOSS 801 (10 oz tube) silicone adhesive is applied to the decal immediately before installation.
(B) indicates decals requiring BOSS adhesive.

Decal packages are clearly marked for VINYL LINER POOLS **(A)** or FIBERGLASS and CONCRETE POOLS **(B)**

NOTE: Decal **(A)** with pre-applied adhesive (Peel & Stick) can be installed in FIBERGLASS POOLS before filling with water.

Installation Supplies (homeowner)

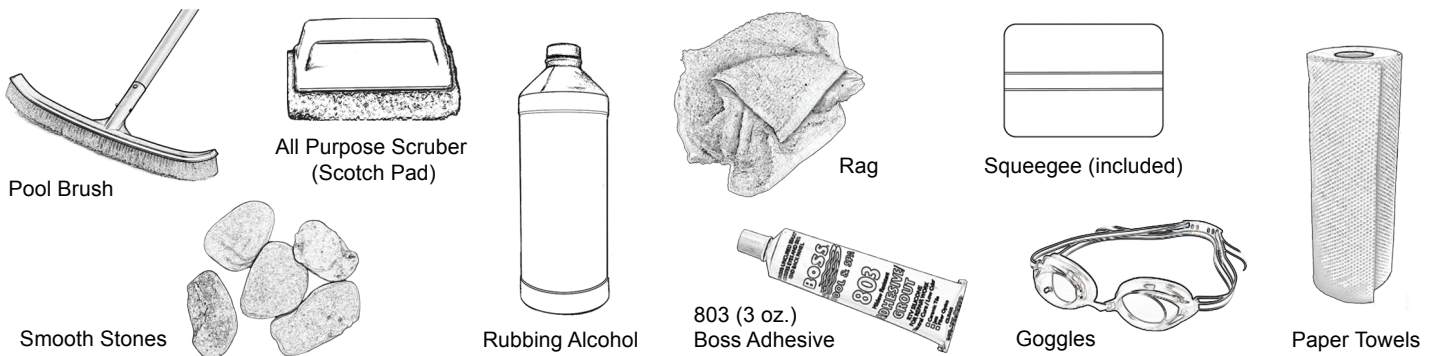

Installation Supplies (contractor)

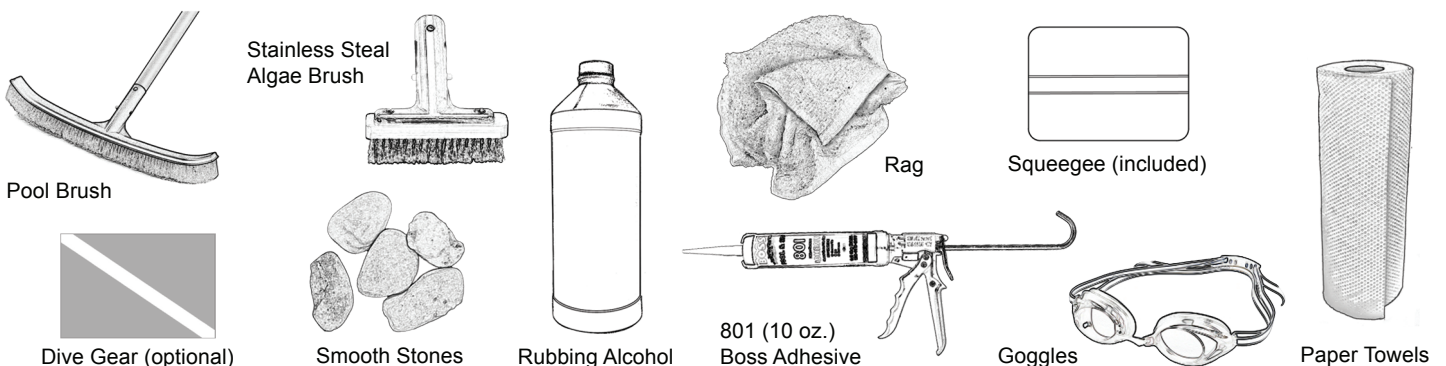

PREPERATION

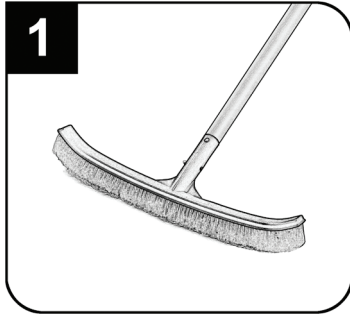

Step 1: Preliminary Surface Preparation

- Brush and vacuum the pool to remove any loose debris.

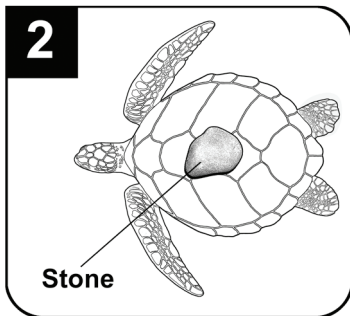

Step 2: Determine Layout

- Arrange the decals in your pool until you find a suitable layout.
- Use a small, smooth stone or a similar object to hold the decals stationary while you exit the pool to ensure your approval of the layout.

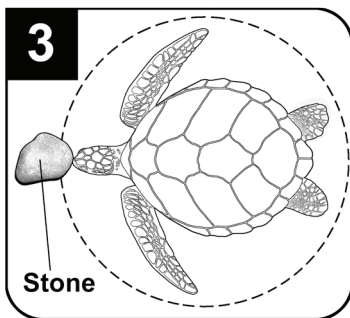

Step 3: Mark Decal Location

- Remove the stone from the decal you will be installing first and place it on the floor of the pool to mark the location of that decal.
- Clean an area that is slightly larger than the size of the decal as indicated by the dashed line.

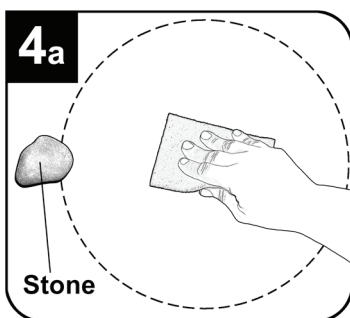

Step 4a: Scrub Pool Surface Thoroughly

IMPORTANT: You must clean the pool surface thoroughly to insure maximum adhesion.

- Scrub the area using a stainless steel algae brush or scotch pad to remove heavy contaminants.

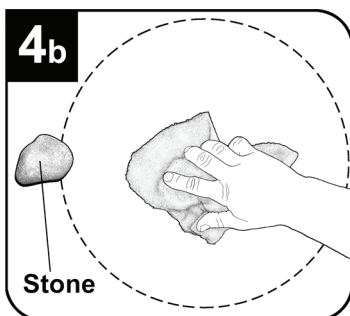

Step 4b: Wipe Pool Surface

- Wipe the area using a rag or sponge saturated with Isopropyl Alcohol (Rubbing Alcohol) to remove any algae, dirt or oils.

INSTALLATION

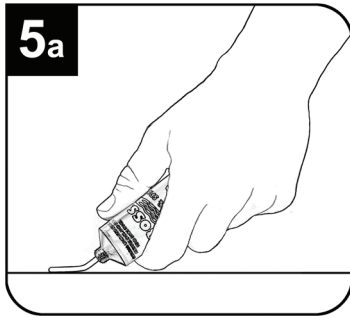

Step 5a: Apply Silicone Adhesive

- Apply Boss 803 silicone adhesive to the back of the first decal.
- The bead of silicone adhesive should be approximately 1/8 inch thick (the thickness of 2 pennies).

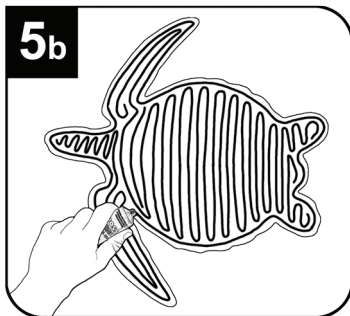

Step 5b: Work Quickly

- Apply a continuous bead of adhesive around the edge then complete the pattern as shown.
- There needs to be enough adhesive to fully cover the back after applying pressure with the squeegee.

NOTE: Work quickly on large sections, tooling time of the adhesive is **5 minutes**.

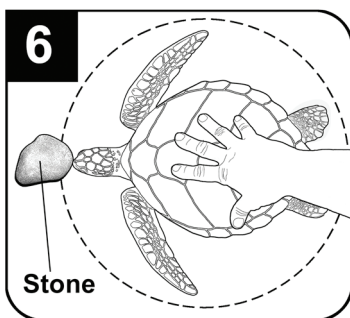

Step 6: Apply Decal

- Stick the decal in the predetermined area by pressing down using moderate pressure.

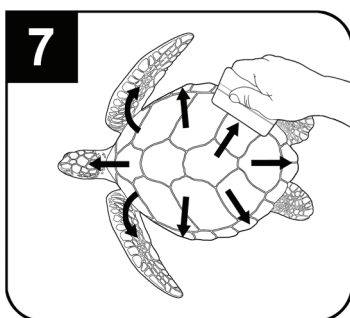

Step 7: Squeegee Decal

- Using the supplied squeegee, apply firm pressure to the entire surface of the decal. Start in the center pressing outward toward the edges using smooth strokes.
 - Silicone will squeeze out around the edges at this point. Be prepared to clean the squeegee off after each stroke.
- Hint:** wear a rubber glove on your free hand to wipe the silicone from the squeegee. Periodically wipe the silicone from your gloved hand with paper towels. When complete, wipe up excess silicone from the pool surface.

NOTE: Some large decals consist of multiple sections and should be installed one section at a time, completely finishing each section before installing the next. This will ensure proper adhesion of each section as well as proper alignment.

IMPORTANT: Allow 24 hours for adhesive to fully cure before disturbing decals or operating automatic cleaners.

For video instructions go to www.aquadecal.com/FiberglassConcreteVideo.html