

DuraMax
DuraMax Bi-Turbo T2
DuraMax RC
DuraMax Duo Jr
DuraMax Duo
DuraMax Trio

MAXIMUM DURABILITY
DuraMax
MAXIMUM PERFORMANCE

Use & Care Guide
Robotic Pool Cleaning System

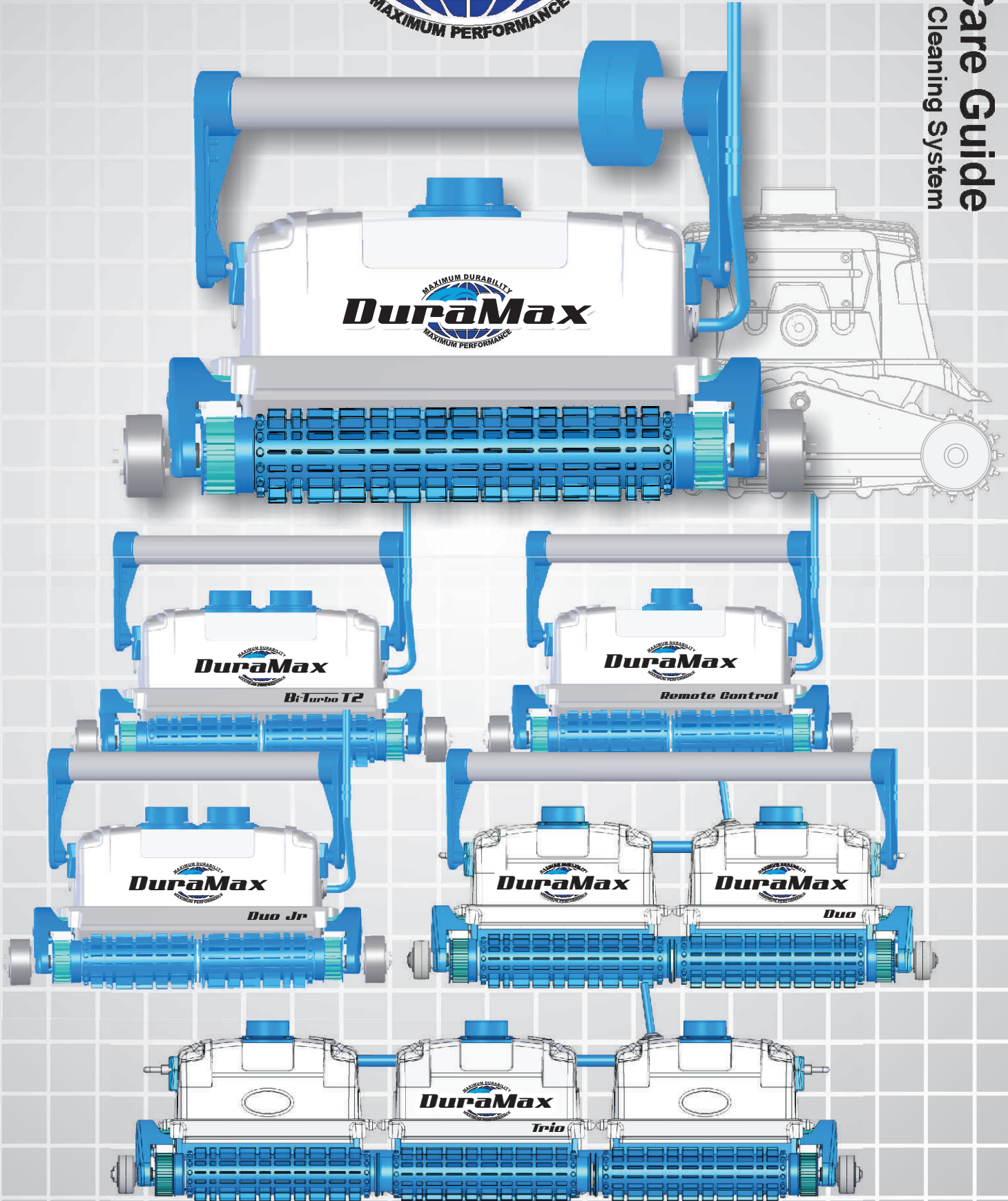

IMPORTANT INFORMATION

MAKE A RECORD FOR FUTURE USE

Model _____

Purchase Date _____

Place Purchased _____

Serial Number _____

Note: Serial number can be found on the warrantee card or on the packing carton.

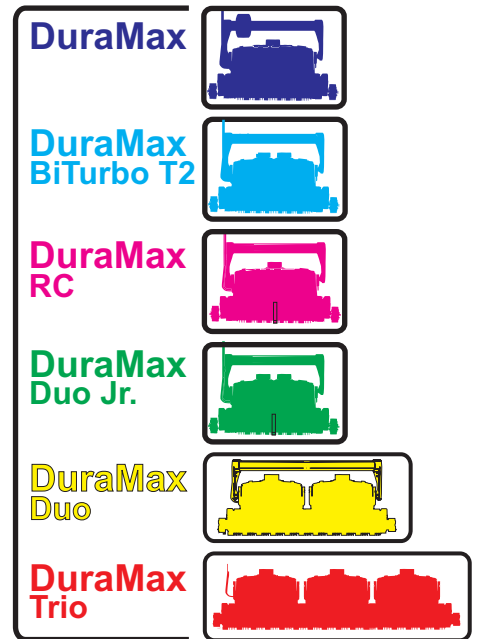

QUESTIONS ?

1-888-AQUATECH (888-278-2832)
For Technical Support
FAX: 973-857-0261

INTERNET

For online support and product information
visit www.AquaProducts.com/Service



Before performing any troubleshooting or maintenance procedures on your cleaner, it should be disconnected from the Power Supply (transformer) and the Power Supply should be unplugged from the electrical outlet to prevent the possibility of personal injury or damage to the cleaner.

Always Unplug your Power Supply when not in use to prevent accidental starts.



Never operate the cleaner out of the water. Doing so will cause severe damage to the motor and void the product Warrantee.



Water temperature and chemical composition changes can greatly affect the buoyancy of your cleaner. Therefore, if you have previously installed floatation devices in your cleaner to assist its buoyancy, it may be necessary to remove the devices one by-one until proper buoyancy is restored.



Never lift your cleaner out of the pool using the Floating Cable. You may use the Floating Cable to pull the cleaner to the side of the pool, but always use the Floating Handle to remove it from the pool. Pulling on the Floating Cable to remove the cleaner from the pool will result in internal connections being broken and severe damage being caused to your cleaner.

Do Not Swim In Pool While Cleaner Is In Use

Please Read The Entire Manual Carefully Before Using Your Automatic Commercial Pool Cleaner

CAUTION

**RISK OF ELECTRIC SHOCK
DO NOT REMOVE TRANSFORMER
COVER. NO USER-SERVICABLE
PARTS INSIDE.**



This symbol is intended to alert the user to the presence of "dangerous voltage" within the product's enclosure that may be of sufficient magnitude to constitute a risk of electric shock to persons.



This symbol is intended to alert the user to the presence of important operating and maintenance (servicing) instructions in the literature accompanying the appliance.

Robotic Commercial Pool Cleaner

For Commercial - Public Swimming Pools

COMPONENTS OVERVIEW

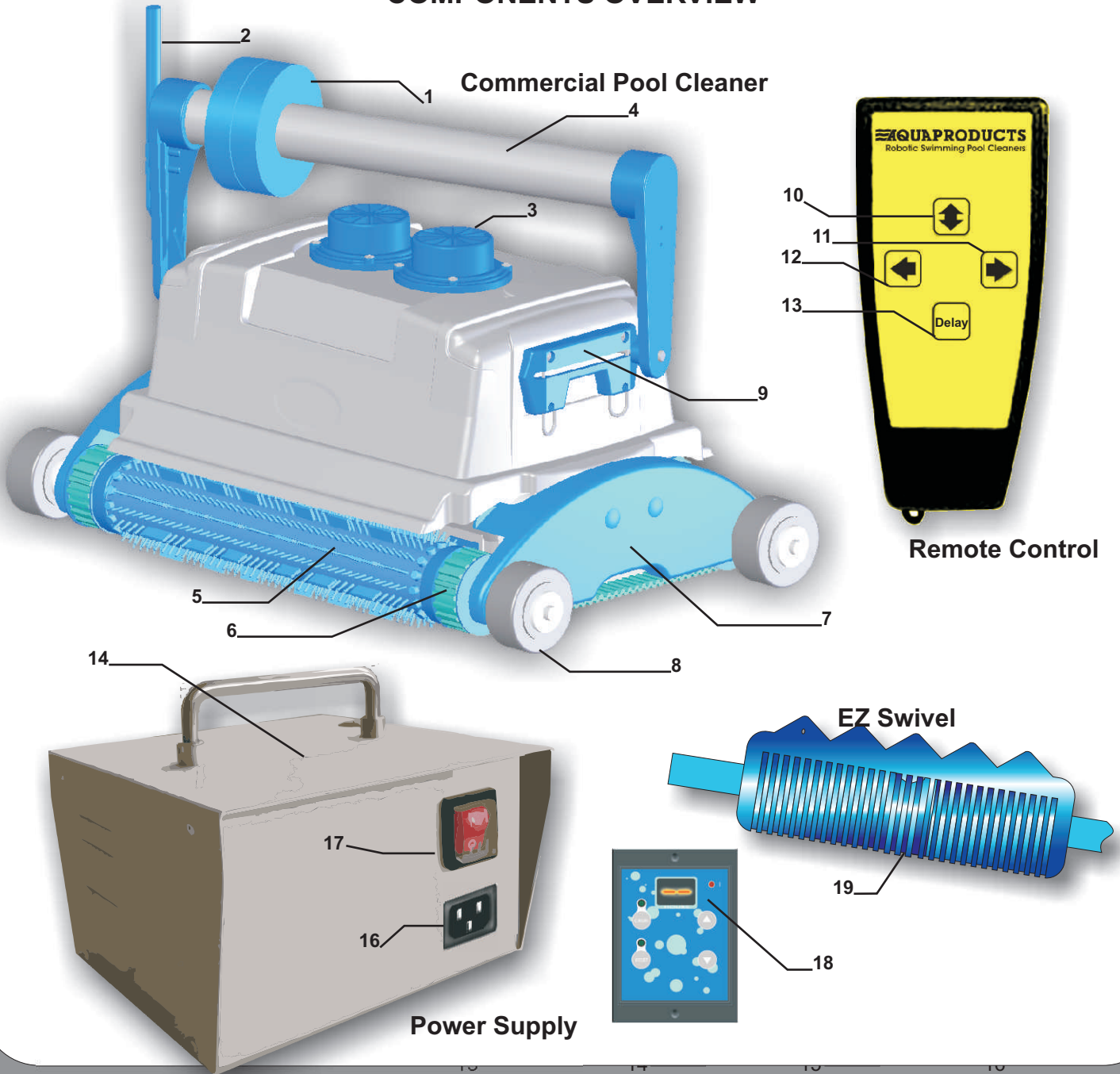

Commercial Pool Cleaner

- 1 Float
- 2 Floating Cable
- 3 Outlet Cover
- 4 Floating Handle
- 5 Brush
- 6 Drive Track
- 7 Side Plate
- 8 Bumper Wheels
- 9 Handle Bracket

Remote Control

- 10 Forward/Reverse
- 11 Right
- 12 Left
- 13 1Hr. Delay

Power Supply

- 14 Power Supply
- 16 Cable Connector
- 17 On / Off Switch
- 18 Electronic Timer

Floating Cable

- 19 EZ Swivel

LOCATING INFORMATION

Location of the Power Supply Unit (Transformer)

Timed Operation: Press the “UP” arrow button (**Fig.#1**) once for each hour of operation you desire (up to 7 hours). When you have selected the proper number of hours, press the RESET button you have set the cleaning time you may add or subtract hours by simply pressing the “UP” or “DOWN” arrow button. This may be done while the cleaner is in operation.



Set the operating mode for your cleaner after the cleaner has been placed in the pool, the Floating Cable from the cleaner has been attached to the Power Supply and the Power Supply has been plugged into a GFCI protected 115v electrical outlet.



The Power Supply should be placed in a sheltered area, at least ten (10) feet away from the pool. While the Power Supply is weather-resistant, it should be placed in an elevated area where it will not sit in puddles of water.

For best performance, locate the Power Supply at the mid-point on the longest side of your pool (**Fig.#2**). This will make the best use of its length of Floating Cable. If necessary, a heavy duty, 16ga. grounded extension cord may be used. Once connected to the cleaner in the pool and a 110V power source, you can control the length of the cleaning cycle by using the Control Pad Switch located on the power supply. Up to a 2 hour cleaning cycle is recommended.

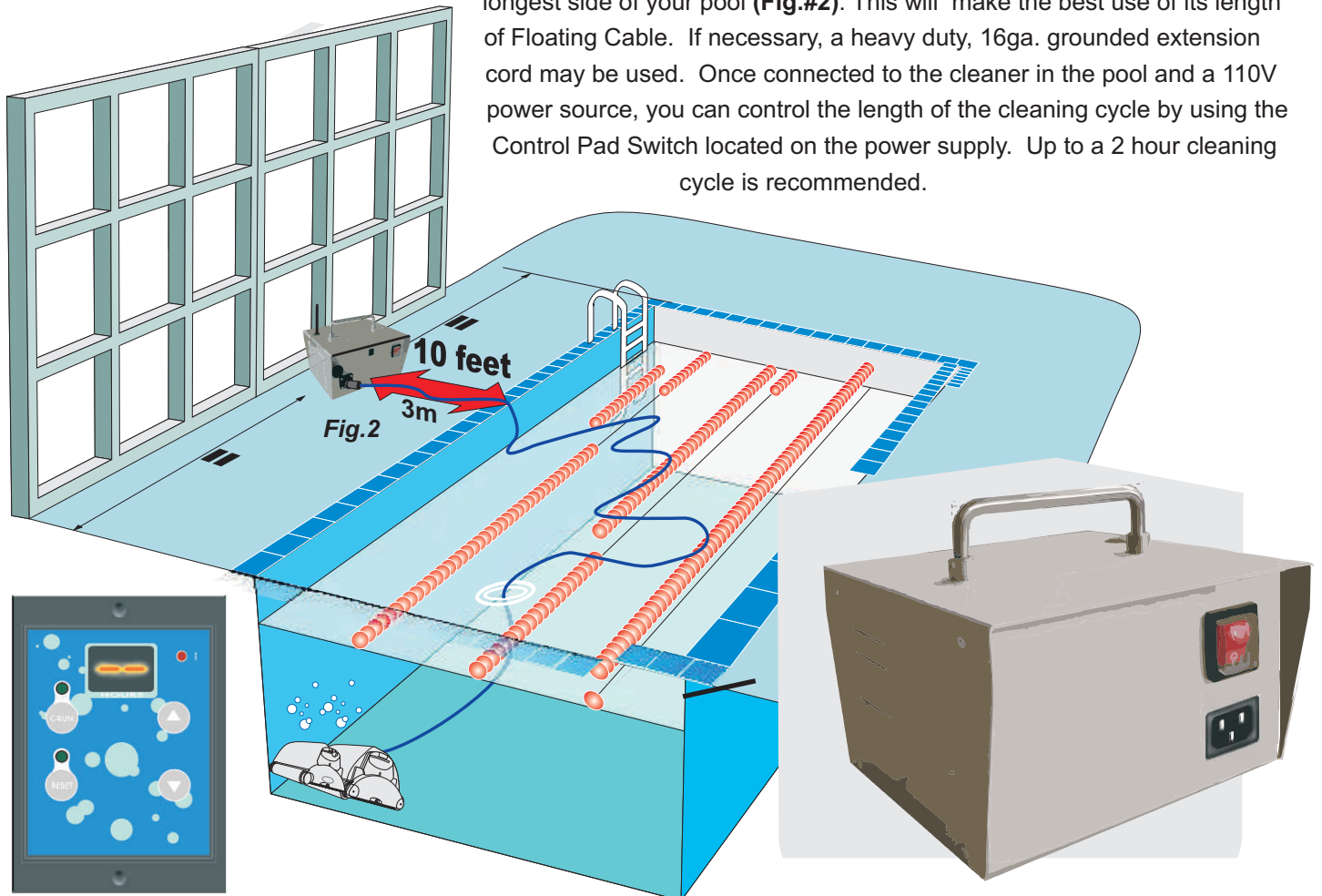

QUICK START GUIDE

To Operate Cleaner

- (1) Locate a GFCI 110Vac. receptacle, and plug the transformer in.
- (2) Completely immerse the cleaner in water.
- (3) While the cleaner is in the water, gently tilt it side to side (fig3). This will allow any trapped air to escape through the pump outlets. Then, with a gentle push, allow the cleaner to sink to the bottom of the pool.



NOTE: If the cleaner does not sink to the bottom of the pool, it's a result of trapped air. This air must be removed for proper operation.

- (4) Uncoil the floating cable fully and spread it over the surface of the water as evenly as possible. Make sure the cable has no tangles or kinks.
- (5) To start the Commercial Pool Cleaner, press the Power Supply ON/OFF switch to the On position. If your Power Supply is equipped with an adjustable Timer (pg.6, fig 2) you can now select the length of the cleaning cycle and press the Reset button to start the cleaner.

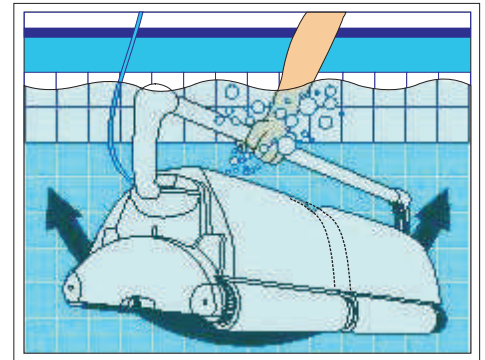

Fig.3

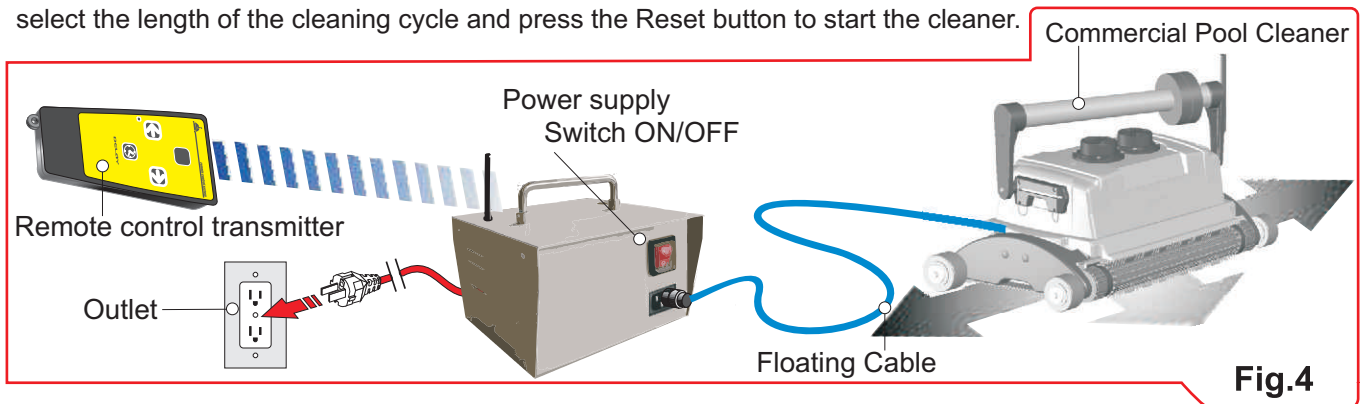

Fig.4

To Maintain and Protect you Cleaner

- Shut off and unplug power supply every time you remove the cleaner from the water.
- Clean your filter Bag after every cleaning cycle.
- Replace worn brushes to ensure maximum cleaning performance.
- Save your cleaner's packaging materials for off-season storage or if shipping to your dealer if service is required.
- Clean the unit with fresh water after every cleaning cycle. This will wash the cleaner free of chlorine or other chemicals found in the pool, extending the life of all the cleaner's components.
- Do not leave your cleaner or power supply in direct sunlight when not in use.
- Periodically straighten out the cable using the E-Z Swivel

CABLE USE AND CARE

The cable may become twisted after a period of time in use. To correct this condition, simply lock the moveable handle on the top of the cleaner in the opposite diagonal direction. The Commercial Pool Cleaner will now travel in the opposite direction while cleaning your pool and the cable will uncoil. If the problem persists, or your cleaner does not have a diagonal handle, using the E-Z Swivel device will untangle the cable.



Using the Floating Cable to lift the cleaner out of the water will cause severe damage!

OPERATING INSTRUCTIONS



Check the cable periodically for external damage. Continual rubbing against sharp or rough surfaces may abrade the Floating Cable resulting in damage and possible short-circuiting of the cleaner.

Disconnect the Power Supply Cord from the Power Supply, place your cleaner on the ground outside of the pool perpendicular to you. At the end of the Cable, located near the connection plug to the Power Supply, is a plastic handle ("Swivel"). Grab the handle firmly as shown in the illustration. Walk away from the cleaner while pulling the handle. This will cause the Cable to rotate within the plastic handle and force the Cable to untwist itself. For best results remember to pull the handle until the Cable is completely untwisted.

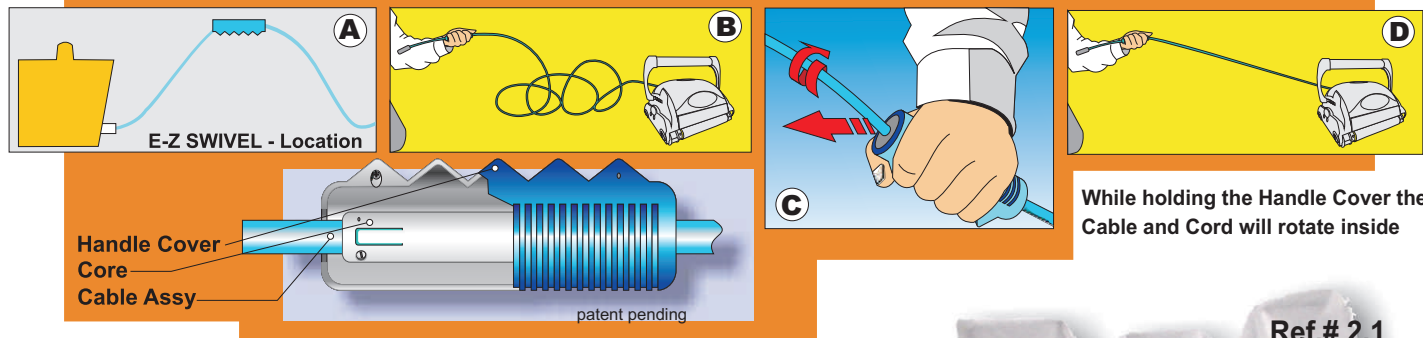

While holding the Handle Cover the Cable and Cord will rotate inside

Filter Bag

Lay the cleaner on its back on a soft surface to avoid scratching it. Gently pull-on the Lock Tab on one end or side of the Bottom Lid freeing one end of the Bottom Lid. Repeat this procedure on the other end and remove the Bottom Lid Assembly. Remove the Filter Bag from the "W" Frames, turn it inside out and wash off all the dirt with a garden hose or in a bucket. Squeeze the Bag gently until the rinse water is clear. If necessary, machine wash (Gentle Cycle only) the Bag using only cold water with **NO DETERGENT**. You may re-install the bag immediately or allow it to air dry (never machine dry the Filter Bag). Re-install the Bag on the "W" frames of the Bottom Lid Assembly, making sure that the "felt" (soft) side is facing in. To ensure a proper fit of the Filter Bag onto the Bottom Lid Assembly, locate the small Label near the Filter Bag's elastic bottom. Position the Filter Bag so that the small Label is at the center of either long side of the Bottom Lid. Then pull the elastic bottom over each Wire and slide the Filter Bag down along the Wires until the Bag reaches the Bottom Lid. At that point, the Filter Bag's elastic bottom should be stretched over the plastic ridges located at opposing ends of the short sides of the Bottom Lid. This holds the Filter Bag in place. Press down on top of the Filter Bag where each of the four "U" shaped slots on the Wire Frame are located. This will pull the Filter Bag corners to the corners of the Wire Frame. Re-install the Bottom Lid Assembly into the bottom of the cleaner. Be sure that the Filter Bag's fabric is not interfering with the locking of the Lock Tabs.



The cleaner's Filter Bag can filter out particles down to 20 times smaller than many main filters. This means that the fine particles such as algae and bacteria, invisible to the naked eye, which slip through the main filter and back into the pool to settle into the pores of the pool's surface, will be scrubbed loose and vacuumed up by the cleaner and retained in its Filter Bag. When the Filter Bag becomes saturated with debris, the flow of water through it becomes restricted and suction is reduced. Strong water flow is required to force the cleaner against the wall when climbing. A dirty Filter Bag also weighs the cleaner down, making it hard for the cleaner to climb due to the added weight and reduced water flow.

The cleaner's Filter Bag can filter out particles down to 20 times smaller than many main filters. This means that the fine particles such as algae and bacteria, invisible to the naked eye, which slip through the main filter and back into the pool to settle into the pores of the pool's surface, will be scrubbed loose and vacuumed up by the cleaner and retained in its Filter Bag. When the Filter Bag becomes saturated with debris, the flow of water through it becomes restricted and suction is reduced. Strong water flow is required to force the cleaner against the wall when climbing. A dirty Filter Bag also weighs the cleaner down, making it hard for the cleaner to climb due to the added weight and reduced water flow.



If the cleaner does not climb and reach the waterline to move left and right, as directed by the diagonally locked Floating Handle, it will not cover and clean the entire pool. Therefore, it is important to clean the Filter Bag thoroughly so that the fine particles that get trapped in the fibers of the Filter Bag are removed.

OPERATING INSTRUCTIONS



Temperature and chemical composition changes can greatly affect the buoyancy of your cleaner. Therefore, if you have previously installed floatation devices in your cleaner to assist its buoyancy, it may be necessary to remove the devices one by-one until proper buoyancy is restored.

BOTTOM LID ASSEMBLY

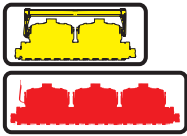

The Bottom Lid Assembly has several options that will permit you to control the way the cleaner operates. The bottom lid consists of six parts. **(1)** Two rollers are located adjacent to the inlets. This prevents the cleaner from being stuck on obstacles like drain covers. If they are not

needed, the rollers may be removed by removing a single phillips screw. **(2)** The inlet extensions will lower the suction point of the cleaner. The lower the suction point, the greater the suction. Your cleaner comes with two sets of inlet extensions, 1/8" and 1/4". When using the inlet extensions observe the cleaner's operation in the pool to see if any obstacles interfere with the extensions. **(3)** Your cleaner offers the best possible performance when it is virtually weightless in your pool. So, careful balancing of its weight is important. Generally, a new cleaner is very light when used for the first time. Careful removal of air trapped in the housing is critical. Additional floatation is typically not required on start-up. Most pool conditions allow your cleaner to effortlessly climb the pool walls and stairs up to the waterline. In some instances the pool environment (e.g., temperature, chemicals, water, etc.) may offset your cleaner's natural buoyancy. Therefore, four floats have been included in the packaging with your new cleaner to assist with its buoyancy. **(4)** Located on the inside of the bottom lid and near the suction inlet is the Suction Selector Switch. If the selector switch is moved towards the "LESS" markings the inlet flaps will be kept from fully opening. This will increase the suction power of the cleaner, but will also restrict larger debris from entering the filter.

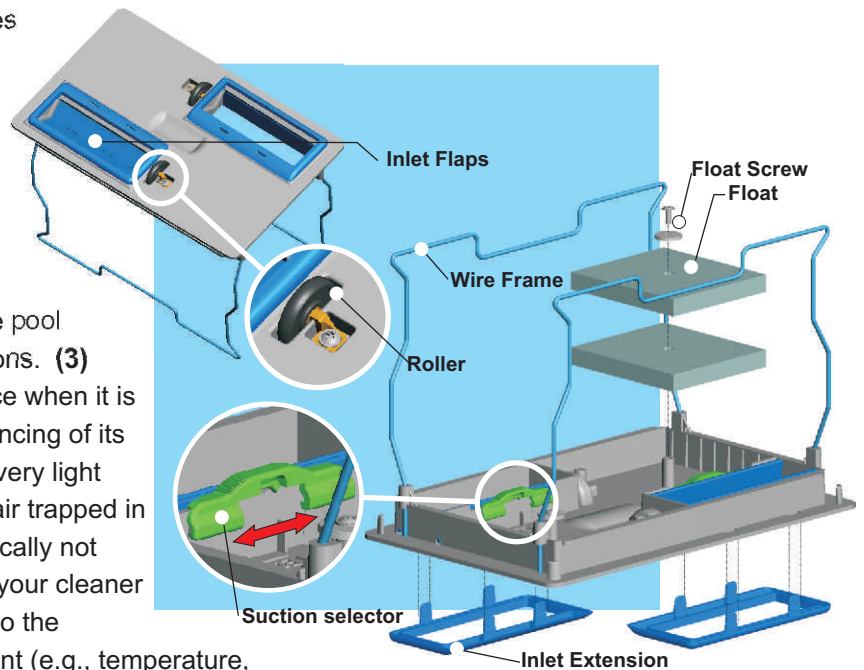

To Add Floatation: **(1)** Remove the two Screws from the "H"-Float. Then, place the "H"-Float, foam-side down, against the inside base of the Bottom Lid Assembly. Secure the "H"-Float with the two screws provided by fastening them from the outside of the Bottom Lid Assembly. This should provide adequate buoyancy. **(2)** Should your cleaner require more floatation, add the two remaining Pocket Floats. Pocket Floats do not require any screws or glue. Simply place them into the open rectangular cavities outside to the side of the Intake Flap housing..

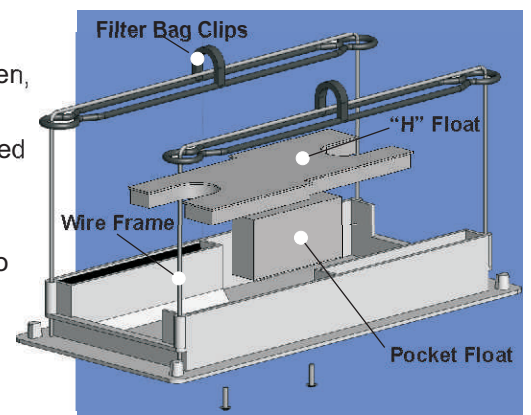

BEACH BOY (air sensor)



The DuraMax™ line of cleaners have a sensor that permits the use of these cleaners in zero-depth entry pools. If the Robot leaves the water for any reason, the Beach Boy System will detect the fault and will attempt to return the robot to safe operating water level (Back to the pool).

OPERATING INSTRUCTIONS

REMOTE CONTROL



The **DuraMax™** has the ability to adjust the cleaning pattern of your cleaner by adjusting the foam float located on the floating handle. The further from center the float is located the further the cleaner will turn. Alternatively, the closer the float is towards the center a smaller angle can be achieved. To make the cleaner turn right the float should be located on the left side. To make the cleaner turn left locate the float on the right side. Rotating the float from side to side will keep the Cable from tangling

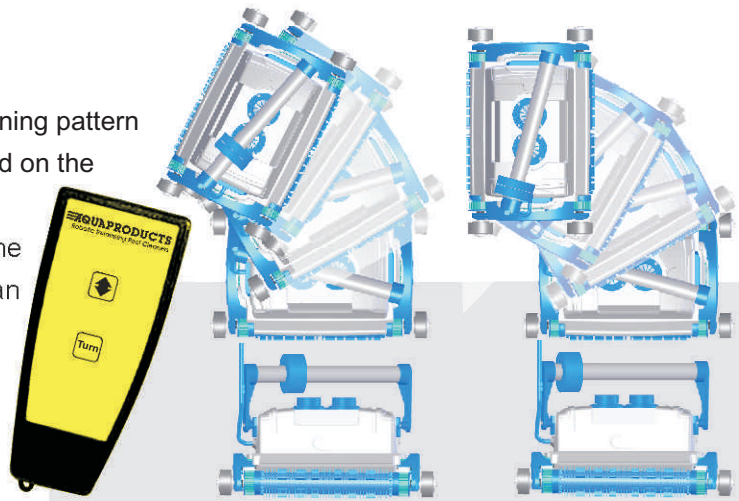

REMOTE CONTROL

When using the Remote Control, aim the Transmitter towards the Power Supply. Make sure the antenna on the transformer is fully raised for best performance. Pressing the up and down arrow button will cause the cleaner to reverse direction and the "Turn" Button will guide your cleaner either Left or Right depending in what direction unit is traveling for as long as the button is being pressed.



The **DuraMax™ Bi Turbo T2** has the ability to adjust the cleaning pattern of your cleaner by adjusting the timed cycle between turns. Button #1 on the Remote Control will change the direction of travel of the cleaner. Each time the Cleaner changes direction it will turn slightly to the right or left depending the direction of the units travel. You can direct the Cleaner where you desire by repeatedly making the Cleaner travel back and forth which will cause the unit to turn incrementally.

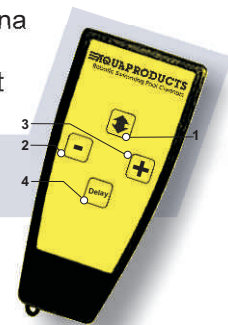

The Cleaner needs to be set up for your pool. The cleaning program needs to know where the half-way point is in the width of your pool to clean correctly. The Cleaner is setup to a default setting of 30 seconds. To see if this is the proper setting, place the cleaner in the pool and watch to see if the unit travels to the pools center. If you need to increase the time press the "+" Button (#3) once. If you need to decrease the time press the "-" Button (#2) once. Repeat this until the Cleaner is set properly.

You may set a one hour start time delay by pressing the "Delay" button (#4) on the remote. The cleaner will move for a short distance and then stop. This is to confirm that you have started the machine.



Your cleaner is equipped with a multi-directional wireless remote control. This feature will enable you to guide them to areas of the pool requiring additional cleaning, or for quick spot clean ups.

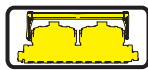

When using the Remote Control, aim the Transmitter towards the Power Supply. Make sure the antenna on the transformer is fully raised for best performance. Pressing buttons 2 and 3 will guide your cleaner either Left or Right for as long as the button is being pressed. When the button is released the machine will proceed stright ahead in the new direction. Pressing button 1 once will change the cleaner's direction to Forward or Reverse. Button 4 will turn your cleaner on for a short time then shutdown and restart in one hour. The Cleaner can operates in 2 modes. The default setting keeps the cleaner as a floor cleaning robot only. Program 2, (Trio does not have this option) allows the cleaner to clean both the walls and floor. To put the cleaner in this mode, turn the power supply on and set the 1-7 hour timer, then wait one second. Then press and hold the up and down arrow (button #1) for 1-3 seconds.

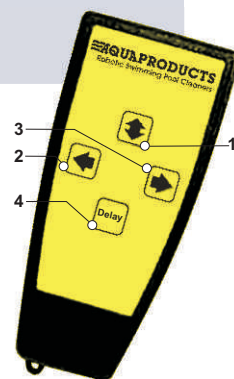

OPERATING INSTRUCTIONS

DRIVE TRACK AND BELT



With prolonged usage of the cleaner the Drive Tracks may stretch, or wear.. To maintain optimum performance they will require replacement. To access the gear assembly it is necessary to remove the cleaner's Side Plate.

- (1) Remove the Bumper wheel by removing the "C" clip and then the locking screw (FIG 3).
- (2) Turn the cleaner upside down and remove the Bottom Lid Assembly. Locate and remove the four screws that hold the Side Plate to the main body. The Side plate is now free and ready to be removed.
- (3) When the Side Plate is taken apart, you will notice 3 black bushings. It is a good idea to replace these Bushings as well when the Drive Tracks are replaced.
- (4) After the Drive Tracks and Bushings are replaced, reassemble the Side Plate as shown here. (FIG 4)

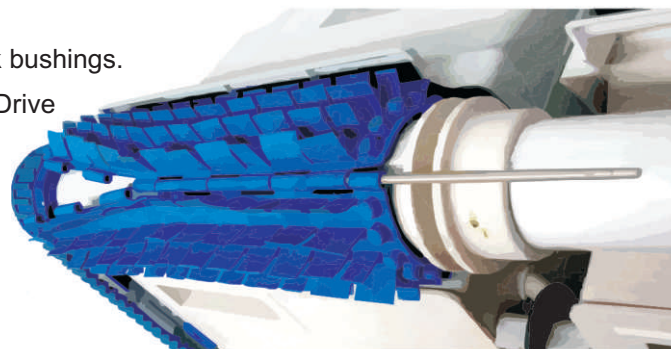
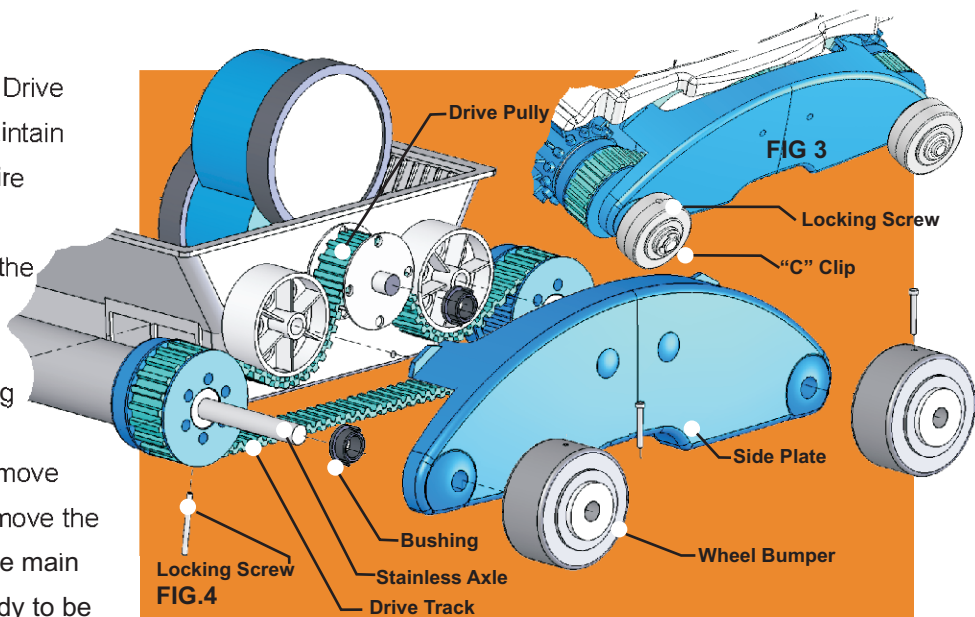

SUPER E-Z BRUSHES

Depending upon how frequently you use your cleaner it will be necessary to replace the brushes when they wear out. Using a pair of pliers, remove the stainless steel shaft. To make the installation of the new brushes easier, use a little hand soap on the stainless pin before installation of the new brushes.

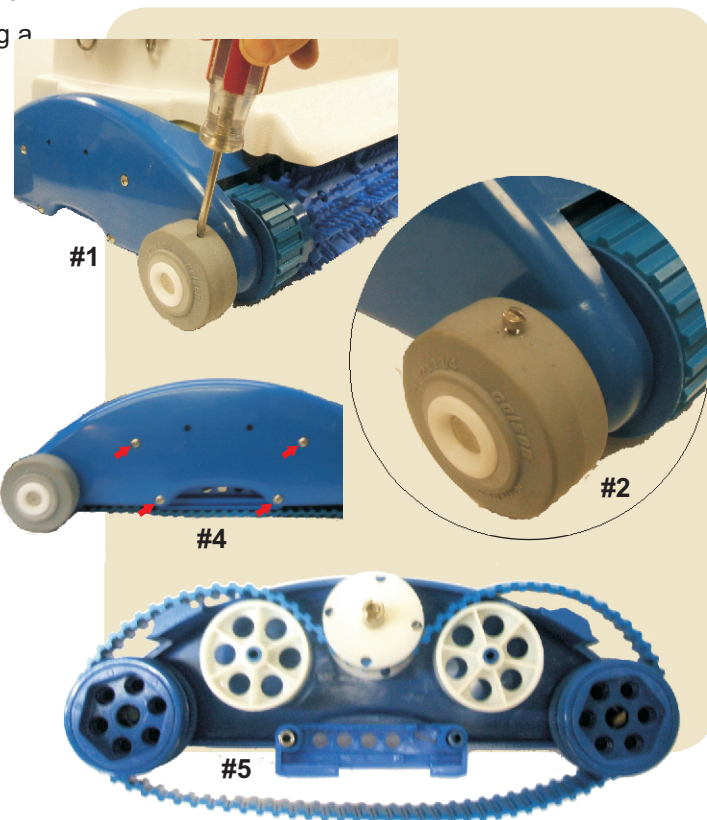

CHANGING DRIVE BELTS

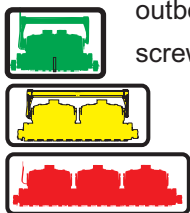

To remove the drive belts, locate the small hole on the outboard wheels (fig.#1) and remove with a slot screwdriver. Repeat for all four wheels. Then remove the bolts and nuts from the Side Plate (fig.#4) at four places. After you remove the Side Plate the interior assembly of the Drive Pulley, Idlers, and Wheel Tubes will fall onto the work surface. Take note on where the internal parts are located. Refer to picture #5 to see the way the Drive Belt is threaded through the Pulleys.

TROUBLESHOOTING GUIDE



The most common troubleshooting issues are described here. Should you wish a more detailed description of a procedure or have other troubleshooting issues please refer to the complete Troubleshooting Guide visit www.AquaProducts.com for the most up-to-date troubleshooting information.

Pumps Water, but Does Not Move or Moves Slowly

1. Remove any foreign matter that may be obstructing Drive Tracks.
2. Check Tracks. Make sure they have not slipped out of place and that they're not loose.
3. Observe Drive Pulley, if it is not moving contact Customer Service.

Does Not Clean Entire Pool (Misses Areas) or Does Not Climb Walls

1. *Make sure cleaner climbs walls up to the waterline and moves left or right before reversing
2. Floating Handle should be locked at an angle across the unit's body, and be sure that no water is present in the Floating Handle. If water is present, please contact Customer Service.
3. Clean Filter Bag thoroughly.
4. Install floatation to help the cleaner climb.
5. Operate the cleaner several cycles (2 To 3 hours depending upon model), Each time locking the Floating Handle in opposite directions and starting the cleaner in different areas of the pool.

Moves But Does Not Pick Up Dirt and Debris (Does Not Pump Water)

1. Remove Outlet Top by removing screws at top and clean any hair or debris on or around the propeller. When reassembling Outlet Top be careful not to over-tighten the screws.
2. Clean Filter Bag thoroughly.
3. Ensure that the Intake Valves on the underside of the Bottom Lid are free to open and close.

Gets Stuck On Ladders, Main Drains, Return Fittings, Lights, Stairs Or In Corners

1. Remove obstructions from pool walls and floor if possible.
2. Check scrubbing brushes for wear.
3. Add floatation.

Floating Cable Gets Wrapped Around the Cleaner

1. Make sure Floating Handle Is locked at an angle across the cleaner's body.
2. If your pool's main filter is on while you are using your cleaner, turn off the filter.
3. Remove any additional floatation that you may have added.
4. Reverse the diagonal direction of the Floating Handle with each use.
5. Before using the cleaner, spread the cable along the length of the pool.

Falls Or Flips Backward Off Of The Wall

1. Check pump motor operation.
2. Check the Floating Handle for water.
3. Make sure that the Floating Handle is locked in a diagonal position.
4. Remove any added floatation devices.
5. Make sure Filter Bag is thoroughly clean.

Debris Falls Out of Cleaner When Removing It From The Pool - Bottom Lid Does Not Close Properly

1. Make sure Filter Bag Is mounted properly onto the Bottom Lid Assembly.
2. Make sure Intake Valves on underside of your cleaner move freely to open and close.

Does Not Pump Water, and Does Not Move Or Power Supply Does Not Turn On

1. Check to see If electrical outlet has power.
2. Make sure Cable Plug fits tightly Into power supply.
3. If your Power Supply Is equipped with a safety reset button make sure that the power Switch is "ON" and that you press the safety reset button.
4. Check the fuse In the Power Supply. If necessary, replace with 5 AMP Slo Blow fuse.
5. Using a cotton swab dry any moisture within Fuse Holder and on fuse itself.
6. Check cables for possible cuts or damage.

**The DuraMax, and DuraMax Bi-Turbo should climb walls and scrub the waterline.*

TROUBLESHOOTING GUIDE



Before performing any troubleshooting maintenance procedures on your cleaner, it should be disconnected from the Power Supply (transformer) and the Power Supply should be unplugged from the electrical outlet to prevent the possibility of personal injury or damage to the cleaner.

Pumps Water, But Cleaner Moves Slowly or Does Not Move at All

Place cleaner upside down (on a non-abrasive surface so that it won't become scratched or scuffed) and unplug it from the Power Supply.

- ▼ Check for any debris such as hair, string, or leaves that may be obstructing the free movement of the Drive Pulley, Drive Rollers, or Drive Tracks.
- ▼ Check that the Drive Rollers and Drive Pulley are properly aligned and are taut, adjust or replace if necessary. Then, plug the cleaner into the Power Supply and turn it on outside the water (while still upside down), allowing it to run a maximum of 1 minute to check the following:
- ▼ Check that the Drive Pulley is turning. If it is not, grip one Wheel Tube with both hands and rotate it forward and reverse to see if the Drive Motor is connected to the Drive Pulley. If you have checked all of the suggestions and the problem still exists then please contact Customer Service.

Does Not Clean Entire Pool (Misses Areas) or Does Not Climb Walls

- ▼ Your cleaner is designed to clean the pool many times over within its recommended cleaning cycle (up to 3 hours) by cleaning one section at a time in a systematic pattern. If large portions of the pool are missed when the cleaning cycle is complete, then please check the following:
Be sure that the Power Supply is located in the center of one of the long sides of the pool. This will allow optimum use of the cleaner's Floating Cable's length. Make sure that the Floating Cable is untangled and spread out on the surface of the water.
- ▼ Clean the Filter Bag thoroughly so that the fine particles of dirt that get trapped within the fibers of the Filter Bag are removed. To test if the Filter Bag is inhibiting the cleaner's performance, simply remove the Filter Bag and operate the cleaner without it. If the cleaner then pumps water strongly, and climbs the walls properly, the Bag most likely requires a thorough cleaning
- ▼ You may need to add Floatation. Your cleaner needs to properly climb the walls and to move left or right scrubbing the waterline in order to properly clean the entire pool.

Note: When at the waterline your cleaner should have a portion of its Scrubbing Brushes out of the water. Should your cleaner not make it to the waterline during its cleaning cycle then the cleaner will be unable to move left or right at the waterline. It will then be unable to reach and clean all areas of the pool and may remain in one or two sections while missing others. Make sure that the Floating Handle is locked diagonally across the top of your cleaner's body.



- ▼ Shake the Handle. Listening for the presence of water. The Handle should be lightweight and airtight without water inside. If water is present, please contact Customer Service.
- ▼ Check that the Pump Motor is operating. Remove obstructions from your pool.
- ▼ Objects protruding from walls may impede the left/right movement of your cleaner when it is at the waterline causing the cleaner to remain in one or two sections while missing others. For optimal performance, it is recommended to remove objects from the pool walls when operating your cleaner. If some objects, such as ladders, can't be removed during your cleaner's cleaning cycle, place the cleaner in each of the 'separate' portions of the pool allowing each portion separate complete cleaning cycles. In this case, place the Power Supply at the farthest points of the pool during each cleaning cycle.
- ▼ Check that the Drive Tracks are properly aligned and are taut, adjust or replace if necessary.
- ▼ Check for excessive wear of the Scrubbing Brushes and replace if necessary. Note: Rubber Brushes begin to stiffen in water less than 70°F which lessens their ability to climb pool walls.

Check the surface of your pool walls. In rare instances (e.g., new pools) the pool walls may be slippery and require cleaning/brushing first. If algae has accumulated in your pool and there is a slick green or clear layer along the base of the walls, this impedes the climbing ability of your cleaner. We suggest you "Shock" your pool*, and then manually brush and vacuum the dead algae from all surfaces to "waste" (not through the main filter) to remove the bulk of the algae from the pool. If you use your cleaner to remove the dead algae be aware that the Filter Bag may clog quickly, requiring several cleaning cycles and thorough Filter Bag cleanings.



NOTE: Your cleaner's Brushes will become covered with algae. Thoroughly clean them to ensure traction for future use.*IMPORTANT: When shocking your pool water, remove your cleaner from the water for at least 24 hours to allow proper dilution before returning the cleaner to the pool. Otherwise premature discoloration and wear of plastic and rubber components will occur.

TROUBLESHOOTING GUIDE

If you use a non-chlorine solution (i.e. Baquacil) to clean your pool, a clear slick film may form along your pool's walls impeding the cleaner's ability to climb. We suggest adding 225 to 300 parts per million of Calcium Hardener to your pool water to combat the film built-up.

- ▼ If your pool is irregular in shape (T, L, freeform) or has large swim out areas your cleaner may not easily enter all pool areas in a standard cleaning cycle. To ensure cleaning of all areas, we suggest placing the cleaner in each of the 'separate' areas of the pool allowing a complete cleaning cycle for each area.

▼ Moves But Does Not Pick Up Dirt And Debris

Check the operation of the Pump Motor. While the cleaner is in the pool, with the Power Supply switched on, hold the cleaner's Floating Handle so the Outlet Top breaks the pool surface. Water should gush from the Outlet Top. If there is no water flow, or if it appears weak, proceed to the next step.

Using a screwdriver, remove the screws that secure the Outlet Top to the body and inspect the Propeller for clogs, hair or other debris which may keep it from spinning freely. If it appears to be frozen and no debris is blocking its movement, or if the Propeller moves freely when spun manually but not when the cleaner is turned on, or if the propeller is loose and wobbles when spun manually, contact Customer Support for assistance. If the Pump is operating properly replace the Outlet Top. Be careful not to over tighten and damage the plastic, then proceed to the next step.

- ▼ Clean the Filter Bag thoroughly so that the fine particles of dirt that get trapped within the fibers of the Filter Bag are removed.

Check the Intake Valve Flaps on the underside of your cleaner. The Flaps should open and close freely. Clean and free the Valve Flaps if necessary.

Gets Stuck On Ladders, Main Drains, Return Fittings, Lights, Stairs Or In Corners Cleaners have approximately one inch of clearance between the floor and its underside. The Brushes enable the cleaner to climb over obstacles like raised main drains, return filters, lights, and pop-up, in-floor systems, and climb up stairs in most pools. But, in some cases, the size or shape of these obstacles (i.e. lights, main drains) may stop the cleaner from moving by catching on the underside of the cleaner. Follow these recommendations to assist your cleaner with the following obstacles: Ladders, Return Fittings, Lane Hooks, Lighting Fixtures Objects protruding from walls may impede the left/right movement of your cleaner when it is at the waterline. For optimal performance, it is recommended to remove objects from the pool walls when operating your cleaner. The greater the number of objects on the pool walls, the greater the difficulty your cleaner will have covering the entire pool. One object (i.e. ladder) in pool may affect the overall cleaning cycle of your cleaner to a minor extent. Two or more objects in the pool positioned either directly opposite one another, or diagonally across from one another, will restrict your cleaner to primarily clean only one section of the pool on one side of the objects during its cleaning cycle. If these objects can not be removed then place the cleaner in each of the 'separate' areas of the pool, allowing each a separate complete cleaning cycle. It is best to place your cleaner at the farthest points of the pool at the beginning of each cleaning cycle. Return Fittings - Contact your Authorized Dealer for return fittings of the same diameter as your current fittings, yet with smaller extensions (under 1" height). This should provide the clearance needed for your cleaner to climb freely.



Note: The bottom step of a ladder may stop your cleaner from freely climbing and tilting 90° up the wall from the floor. This means the cleaner will remain in the forward mode, 'spinning its wheels', under the ladder, not allowing its internal incline sensors to detect the wall. Fortunately, your cleaner is equipped with a safety timer that will automatically reverse your cleaner after a period of time.

- ▼ Check the brushes to see they are plush and not worn. Should they require replacement, contact Customer Service. The replacement Brushes are a different style with a larger diameter, providing increased ground clearance and a faster speed to climb over obstacles.



Note: Incline Sensors - Always start your cleaner on a horizontal level surface (both Brushes touching the floor). Should your cleaner begin its cleaning cycle in an incline, the Incline Sensors within the Drive Motor may begin operating assuming that the incline angle is a level floor. When the cleaner does become level, the Incline Sensors will tilt and consider the floor to be the wall. This will offset its operation, causing the cleaner to remain in forward or Reverse positions for great lengths of time, resulting in insufficient cleaning

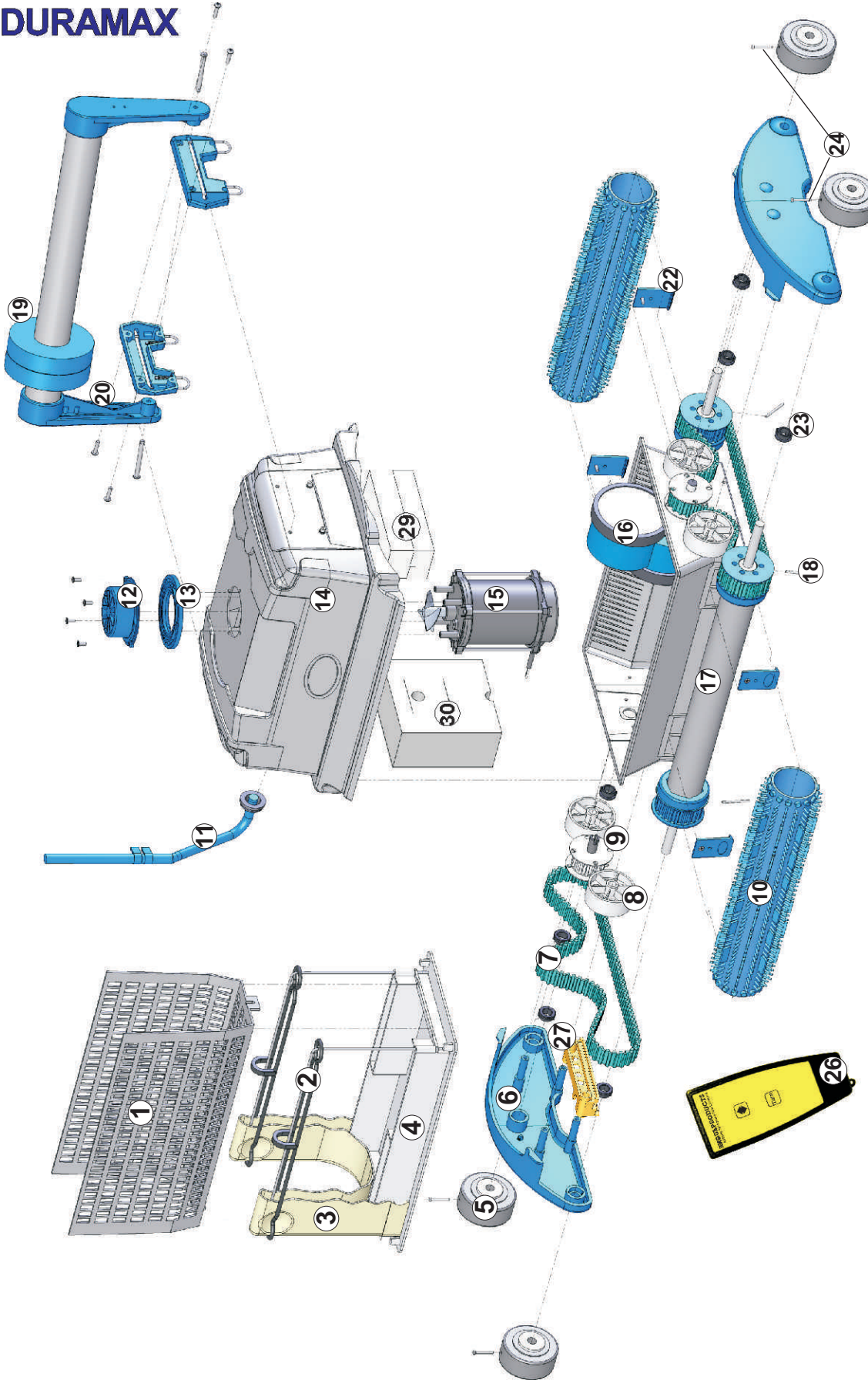

- | | | |
|----|----------------|-----------|
| 1 | Filter Screen | S5313 |
| 2 | Bag Clip | 8001 |
| 3 | Filter Bag | 8101 |
| 4 | Bottom Lid | A9201XC |
| 5 | 3" Wheel | S700031 |
| 6 | Side Plate | S5079BL2H |
| 7 | Drive Track | 3309 |
| 8 | Belt Tensioner | 3505 |
| 9 | Drive Pulley | A3606 |
| 10 | Brush | 3002BM |
| 11 | Cable Assy | A17121 |
| 12 | Outlet | 2230B1 |
| 13 | Bottom Outlet | 2250BL2 |
| 14 | Body | S22025W |
| 15 | Pump | A6011 |
| 16 | Drive Motor | A8557 |
| 17 | Tube Assy | A38220 |
| 18 | Locking Screw | 2251 |
| 19 | Handle Float | 3113 |
| 20 | Handle Assy. | A10211 |
| 22 | Lock Tab | 9204BL |
| 23 | Bushing | 26000BKT2 |
| 25 | Power Supply | 7198D |
| 26 | Remote Control | 220115C |
| 27 | Junction Box | A2416 |
| 28 | Bracket | S3387 |
| 29 | Pocket Float | 3101 |
| 30 | Body Float | 3109 |

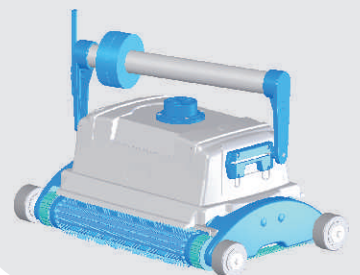



DURAMAX BiTurbo T2

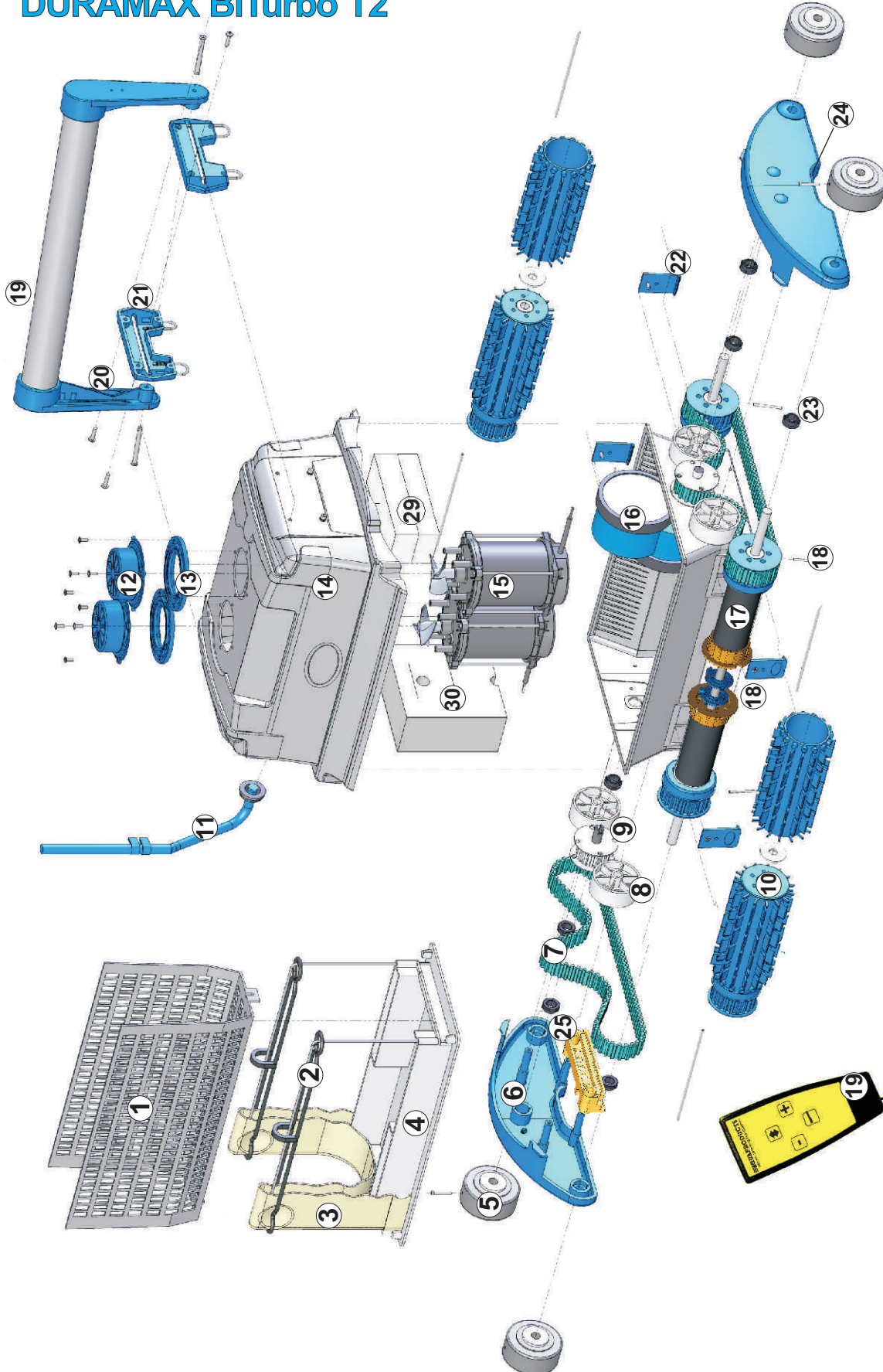

- 1 Filter Screen S5313
- 2 Bag Clip 8001
- 3 Filter Bag 8101
- 4 Bottom Lid A9201XC
- 5 3" Wheel S700031
- 6 Side Plate S5079BL2H
- 7 Drive Track 3309
- 8 Belt Tensioner 3505
- 9 Drive Pulley A3606
- 10 Brush 3002BM
- 11 Cable Assy 162120
- 12 Outlet 2230B1
- 13 Bottom Outlet 2250BL2
- 14 Body S22025W2H
- 15 Pump A6011
- 16 Drive Motor A8558
- 17 Wheel Tube A38224
- 18 Locking Screw 2251
- 19 Remote Control 220120C
- 20 Handle Assy. A10211
- 21 Handle Bracket S1100B2H
- 22 Lock Tab 9204B
- 23 Bushing 26000BKT2
- 25 Bracket S3387
- 26 Transformer A7166
- 27 Junction Box A2301
- 28 Junction Box A2416
- 29 Pocket Float 3101
- 30 Body Float 3109

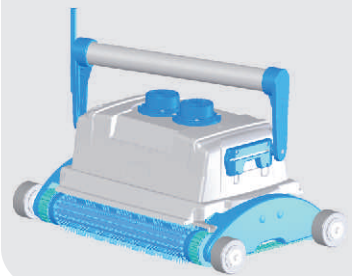

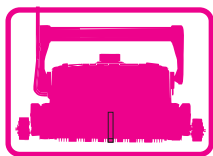

DURAMAX RC

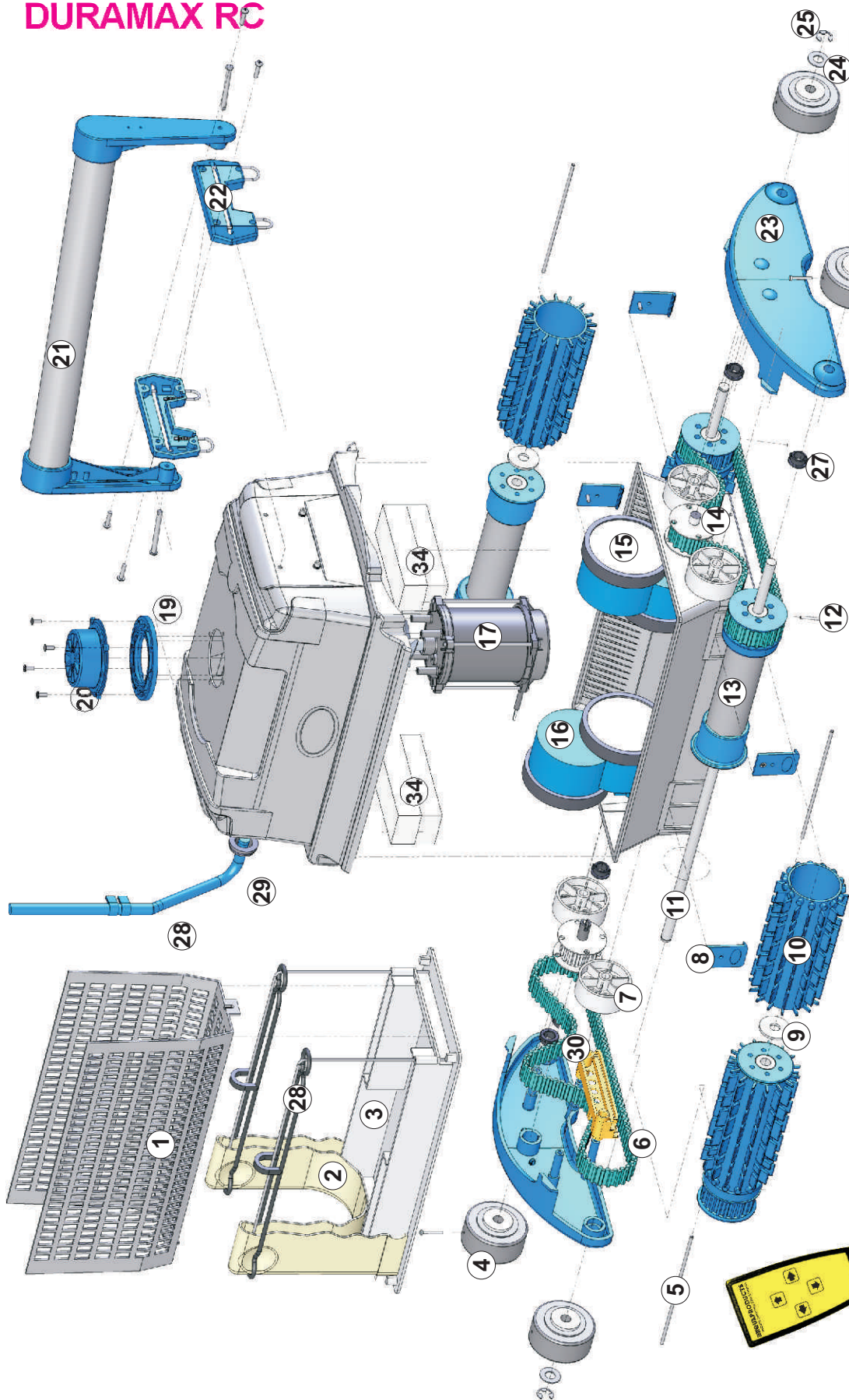

REPLACEMENT PARTS

1	Filter Screen	S5313
2	Filter Bag	8101
3	Bottom Lid	A9201XC
4	2.5" Wheel	A700021
5	Brush Pin	S30217
6	Drive Track	3309
7	Belt Tensioner	3505
8	Lock Tab	9204W
9	Washer	7109
10	Brush	S3016BI7
11	Axle	S342624
12	Lock Screw	2251
13	Wheel Tube Assy	A38221
14	Drive Pulley	A3606
15	Drive Motor Master	A8553
16	Drive Motor Slave	A8547
17	Pump Motor	A6011
18	Body	S22025W1H
19	Outlet Bottom	2250BL2
20	Outlet Top	2230B1
21	Floating Handle	A10212
22	Handle Bracket	9204B
23	Side Plate	S5079BL2H
24	Washer	3603
25	"C" Clip	11058
26	Remote	220120C
27	Bushing	2600BK-T2
28	Cable Assy.	A17121
29	Grommet	1626
30	Bracket	S3387
31	Power Supply	A7164
32	Junction Box	A2416
33	Junction Box	A2305
34	Pocket Float	3101





DURAMAX DUO Jr.

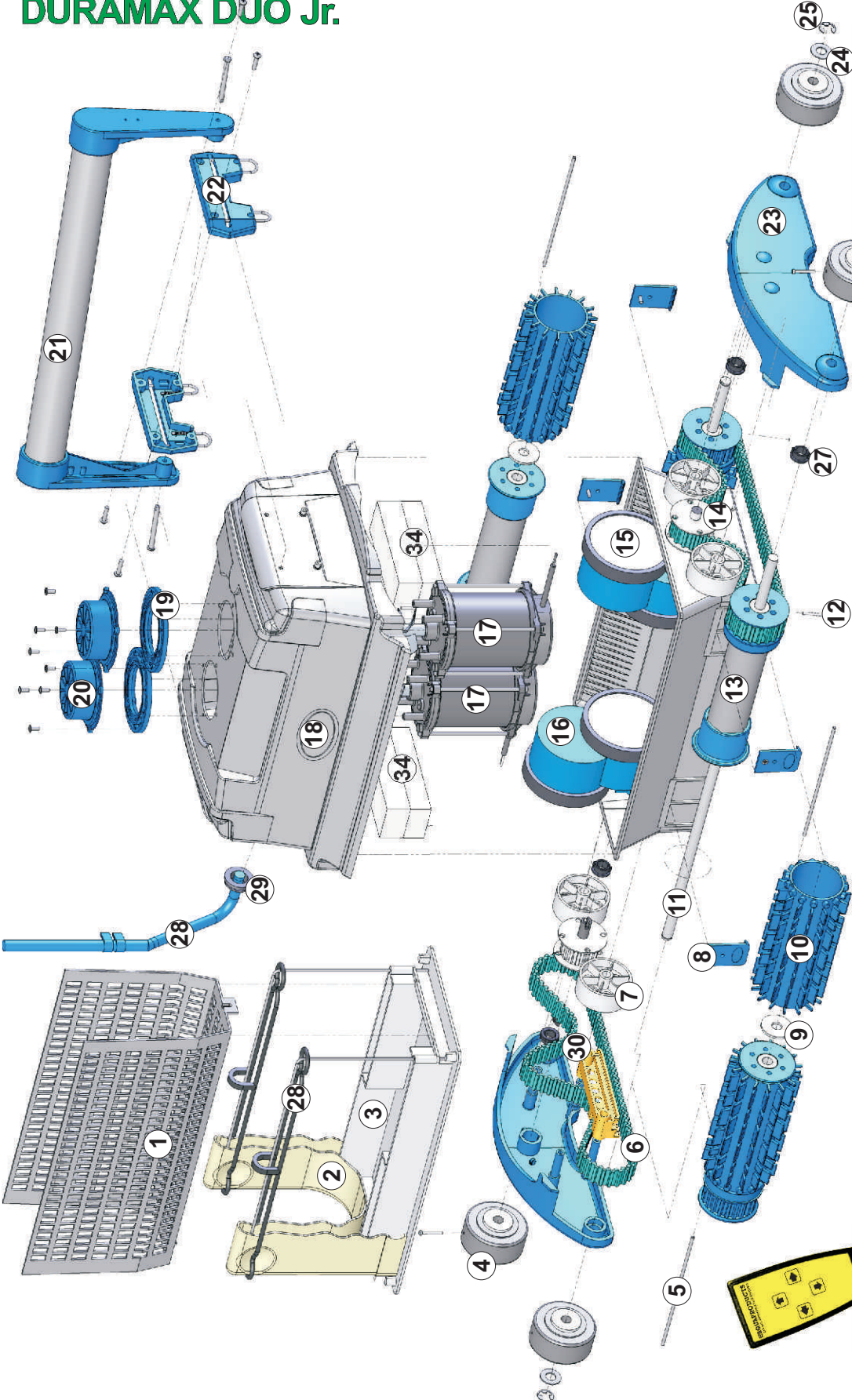

REPLACEMENT PARTS

1	Filter Screen	S5313
2	Filter Bag	8101
3	Bottom Lid	A9201XC
4	2.5" Wheel	A700021
5	Brush Pin	S30217
6	Drive Track	3309
7	Belt Tensioner	3505
8	Lock Tab	9204W
9	Washer	7109
10	Brush	S3016BI7
11	Axle	S342624
12	Lock Screw	2251
13	Wheel Tube Assy	A38221
14	Drive Pulley	A3606
15	Drive Motor Master	A8553
16	Drive Motor Slave	A8547
17	Pump Motor	A6011
18	Body	S22025W1H
19	Outlet Bottom	2250BL2
20	Outlet Top	2230B1
21	Floating Handle	A10212
22	Handle Bracket	9204B
23	Side Plate	S5079BL2H
24	Washer	3603
25	"C" Clip	11058
26	Remote	220120C
27	Bushing	2600BK-T2
28	Cable Assy.	162120
29	Grommet	1626
30	Bracket	S3387
31	Power Supply	A7166
32	Junction Box	A2416
33	Junction Box	A2301
34	Pocket Float	3101

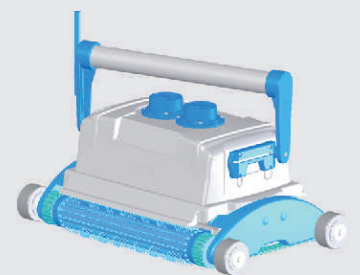

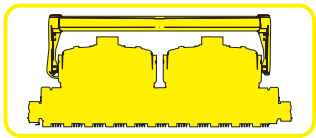

DURAMAX DUO

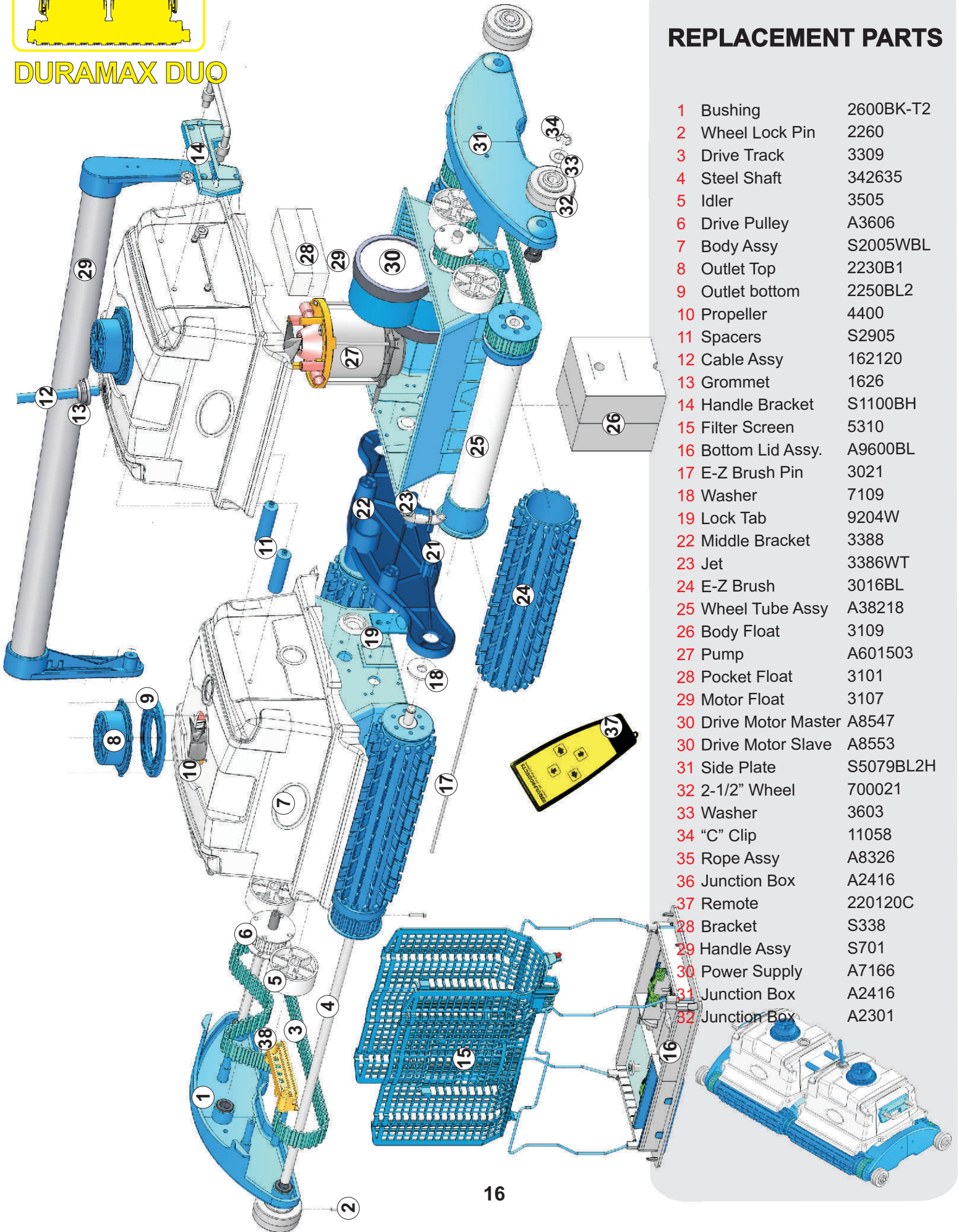

REPLACEMENT PARTS

1	Bushing	2600BK-T2
2	Wheel Lock Pin	2260
3	Drive Track	3309
4	Steel Shaft	342635
5	Idler	3505
6	Drive Pulley	A3606
7	Body Assy	S2005WBL
8	Outlet Top	2230B1
9	Outlet bottom	2250BL2
10	Propeller	4400
11	Spacers	S2905
12	Cable Assy	162120
13	Grommet	1626
14	Handle Bracket	S1100BH
15	Filter Screen	5310
16	Bottom Lid Assy.	A9600BL
17	E-Z Brush Pin	3021
18	Washer	7109
19	Lock Tab	9204W
22	Middle Bracket	3388
23	Jet	3386WT
24	E-Z Brush	3016BL
25	Wheel Tube Assy	A38218
26	Body Float	3109
27	Pump	A601503
28	Pocket Float	3101
29	Motor Float	3107
30	Drive Motor Master	A8547
30	Drive Motor Slave	A8553
31	Side Plate	S5079BL2H
32	2-1/2" Wheel	700021
33	Washer	3603
34	"C" Clip	11058
35	Rope Assy	A8326
36	Junction Box	A2416
37	Remote	220120C
28	Bracket	S338
29	Handle Assy	S701
30	Power Supply	A7166
31	Junction Box	A2416
32	Junction Box	A2301



DURAMAX TRIO

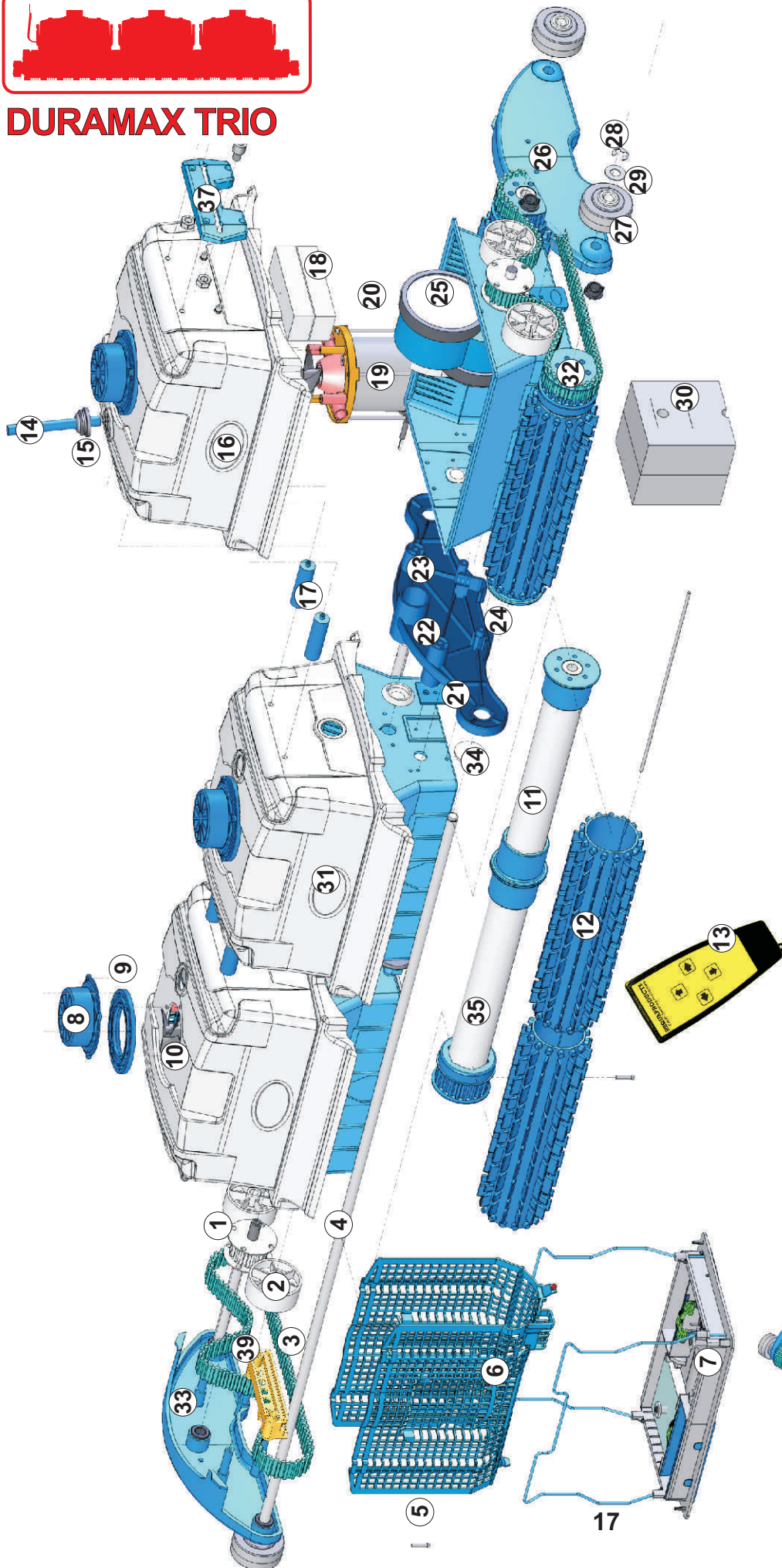

REPLACEMENT PARTS

1	Drive Pulley	A3606
2	Idler	3505
3	Drive Track	3309
4	Steel Shaft	S342652
5	Lock Screw	2251
6	Filter Screen	5310
7	Bottom Lid Assy	A9600BL
8	Outlet Top	2230B1
9	Outlet bottom	2250BL2
10	Propeller	4400
11	Wheel Tube	A38218
12	E-Z Brush	3016BL
	Lock Pin	3021
13	4 Way Remote	220120C
14	Cable Assy	164150
15	Grommet	1625
16	Body Assy.	S2005WBL
18	Pocket Float	1301
19	Pump	A601503
20	Motor Float	3107
21	Lock Tab	2004W
22	Middle Bracket	3388
23	Jet	3386WT
25	Drive Motor Master	A8553
	Drive Motor Slave	A8547
26	Side Plate	S5079BL2H
27	2-1/2" Wheel	700021
28	"C" Clip	11058
29	Washer	3603
30	Body Float	3109
31	Center Body Assy.	S2005WBL
32	Wheel Tube	A38219
33	Bushing	2600BK-T2
34	Washer	11004
35	Wheel Tube	A38219
36	Rope Assy	A8327
37	Handle Bracket	S1100BH
38	Junction Box	A2302
39	Bracket	S3387
40	Power Supply	A7168
41	Junction Box	A2416

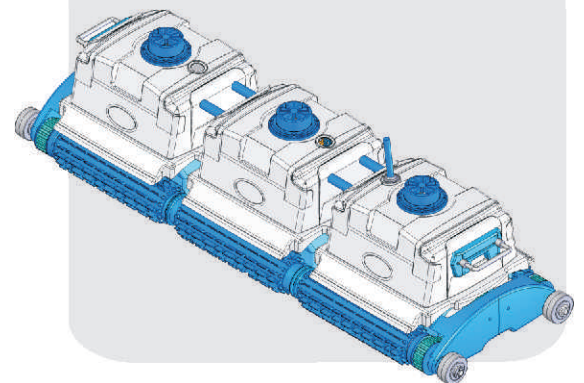

Commercial Warranty

Servicing

On a Yearly/Seasonal basis we recommend that you have your cleaner inspected by Aqua Products Inc. or one of its authorized Commercial Service Centers. This will help ensure that your cleaner will continue to provide you with years of trouble free operation. Contact our Commercial-Service Department toll-free at **1-888-AQUATECH (278-2832)** or e-mail **CommercialService@AquaProducts.com** to schedule inspection servicing, review warranty, or inquire about technical service issues. To service your cleaner properly, a Return Authorization Number must be assigned to your cleaner. To receive this number, please contact our customer service department.

NO UNITS CAN BE SERVICED WITHOUT A PRIOR RETURN AUTHORIZATION NUMBER FROM AQUA PRODUCTS. UNITS WITHOUT A PROPER RETURN AUTHORIZATION NUMBER WILL BE REFUSED.

Warranty

This robotic pool cleaner has been manufactured, tested and inspected in accordance with carefully specified engineering requirements. Aqua Products Inc. warrants that your robotic pool cleaner is free from defects in workmanship and materials under normal use and service, subject to qualifications, conditions and limitations as described below.

TO WHOM EXTENDED: This warranty extends to the first consumer purchaser only for the specified period from the date of the original purchase.

PARTS NOT COVERED BY WARRANTY: Wear and tear items, such as, drive tracks, brushes, and filter bags are not covered. These items require replacement in the ordinary course of use due to normal wear. Therefore, these parts are not covered by this warranty.

PREVENTATIVE MAINTENANCE: Your cleaner requires a minimum amount of preventative maintenance as outlined in your operator's manual. Failure to observe this will void the warranty.

UNAUTHORIZED REPAIR: Damage, defects, malfunctions or other failure caused by repair, which is done by anyone other than an authorized service representative of Aqua Products Inc., shall not be covered.

LEGAL LIMITATIONS: No agent, representative, dealer or employee of Aqua Products Inc. has the authority to increase or alter the obligations of this warranty.

TO VALIDATE THIS WARRANTY: The enclosed warranty registration card must be mailed within ten (10) days of purchase accompanied with a copy of the original proof of purchase or sales slip. No warranty service will be performed unless Aqua Products Inc. has received this material.

UNAUTHORIZED PARTS: The purchaser's use or assent to use, for repair or replacement, any counterfeit parts for Aqua Products pool cleaners automatically voids this warranty. A "counterfeit part" is defined as any component that uses any trademark or tradename of Aqua Products

or is confusing similar in appearance to any such trademark or tradename or otherwise infringes and intellectual property right of Aqua Products. Without limiting the generality of this definition, unauthorized components manufactured by other parties that use part numbers or packaging the same as or similar to those used by Aqua Products will be deemed to be counterfeit parts.

NOTE: This limited warranty is in lieu of all other express warranties, obligations or liabilities.

ANY IMPLIED WARRANTIES, OBLIGATIONS OR UTILITIES, INCLUDING BUT NOT LIMITED TO ANY IMPLIED WARRANTY OF MERCHANTABILITY, SHALL BE UNLIMITED IN DURATION TO THE PERIOD OF TIME OF THIS WRITTEN UNLIMITED WARRANTY. ANY ACTION FOR BREACH OF ANY WARRANTY HEREUNDER, INCLUDING BUT NOT LIMITED TO ANY IMPLIED WARRANTY OF MERCHANTABILITY, MUST BE BROUGHT WITHIN A PERIOD OF EIGHTEEN (18) MONTHS FROM DATE OF ORIGINAL PURCHASE. IN NO CASE SHALL AQUA PRODUCTS INC. BE LIABLE FOR ANY CONSEQUENTIAL DAMAGES FOR BREACH OF THIS OR ANY OTHER WARRANTY, EXPRESSED OR IMPLIED, WHATSOEVER.

Some states do not allow the exclusion or limitations of incidental or consequential damages, so the above exclusion may not apply to you. This limited warranty is valid and enforceable only in the United States of America on units owned and normally operated in the United States of America. This warranty gives you specific legal rights and you may also have other rights, which vary from state to state. Duration of Limited Warranty: Two (2) years on motors and electronics and one (1) year on plastic parts from original date of purchase. Subject to the warranty conditions above, during the twenty-four months from original date of purchase - twelve (12) months on plastic parts - Aqua Products Inc. shall make any necessary repairs, including parts and labor without charge, except for transportation costs, which shall be paid by purchaser.



AQUA PRODUCTS

The World's Leader In Robotic Pool Cleaning Solutions

