

Micro LED Accent

REMOTE LOW VOLTAGE TRANSFORMER REQUIRED
Compatible with magnetic and electronic transformers.

Type:

Project:

Specification

Light Source	C-Socket™ , Quick Change LED Module *
LED Rated Life	50,000 hours average **
Input Voltage	8 to 15 Vac/dc
Power Consumption	3.2 Watts
Standard LED Color	3000K +/- 175 CCT Typical
CRI	80 Typical
Available Materials	6061-T6 Aluminum, Brass, Copper
Lens Cover	Acrylic UV and shock resistant
Wiring	3 ft 18-2, Direct burial sunlight resistant
Fasteners	Stainless steel
Standard Mounting	1.5 inch PVC Post, Black ABS Cap, 1/2 NPS
Operating Temperature	-31F to 122F (-35C to 50C)
Maintenance	Field serviceable driver and LED module
Certification	UL1838  3096671

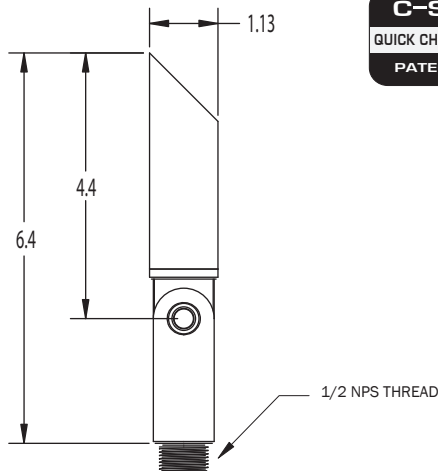

DIMENSIONS (INCHES)

* IES LM-80 Standard ensures led light source will provide lumen maintenance and color performance.

** LED life is defined as the time to 70% lumen maintenance (L70)

Accessories Ordered Separately See Accessories NOT SHOWN TO SCALE



Brass Stake

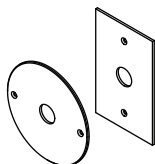

Cover Plate



Extension Riser
6, 12, 18, 24 inch



Surface Mount

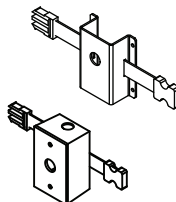

Tree Strap
Bracket or
Junction Box

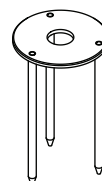

Spike Mount

Photometric

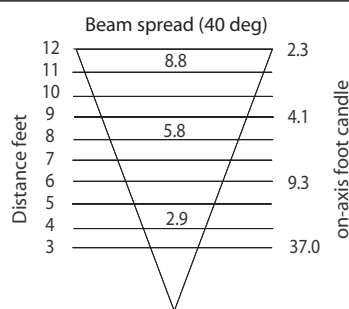
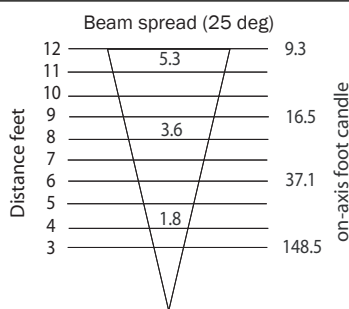
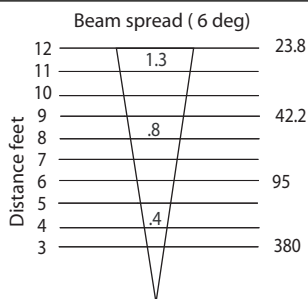

Ordering Matrix

XT					
Prefix	Material	LED Color	Driver Location	Beam Spread	Finish
AL - Aluminum	WW - Warm White 3000k	INT - Internal	N06 - Narrow 6deg	N - Natural (Brass and Copper Only)	
BR - Brass	NW - Neutral White 4000k	EXT - External	M25 - Medium 25deg	BK - Black Powder Coat	
CU - Copper	CW - Cool White 5500k		W40 - Wide 40deg	WT - White Powder Coat	
	AM - Amber		FL90 - Flood 90deg	BN - Brown Powder Coat	
	RD - Red			GN - Green Powder Coat	
	GN - Green			NK - Nickel (Brass Only)	
	BL - Blue			C - Custom	



2380 Camino Vida Roble, Ste. H, Carlsbad, CA 92011
760-431-8982 760-431-8090 Fax
www.dglights.com info@dglights.com

Document Number: S-XT
Released Date: 01-21-12