

- NOTES:
 1.) MOTOR TO BE SHIPPED CONNECTED FOR 230 VOLTS.
 2.) SHAFT EXTENSION TO BE 303 STAINLESS STEEL.

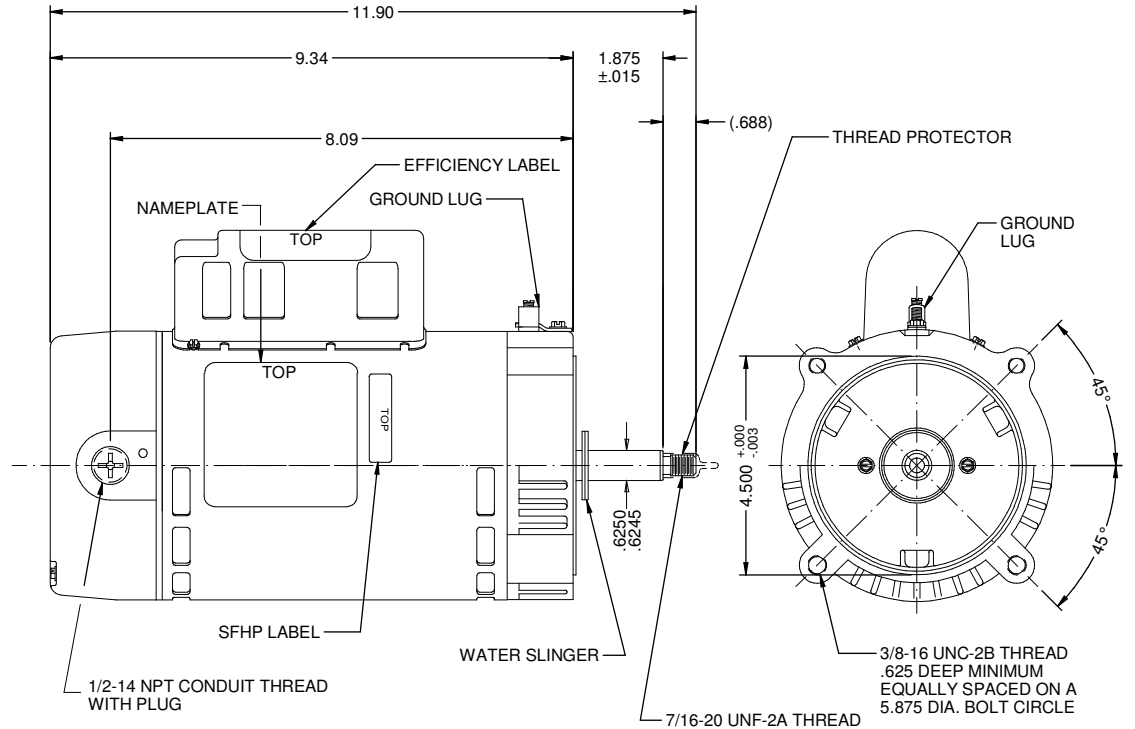
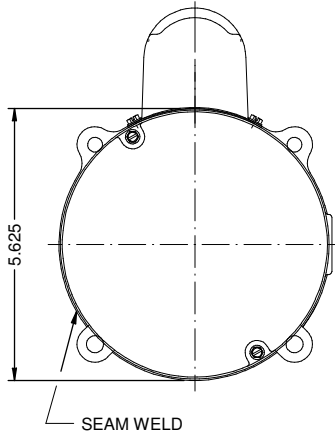

CAT. NO.	S.F.AMPS	S.F.	PROTECTOR	BEARING
ECT1052	1.60	4.0/8.0	AUTOMATIC	BALL-BALL

MODEL	REF	CUSTOMER	HP	VOLTS	AMPS	HZ	RPM	ROTATION	CUSTOMER PN
T55CXCLS-1391		POOL AFTERMARKET	1/2	230/115		60	3450	CCW DRIVE END	

REV E

SHEET NUMBER	REV	REVISION RECORD FOR: C5177-29			
1 OF 1	E	UPDATED BACKGROUND TO NIDEC			
REVISION DATE	27-MAR-12				
ISSUED BY	J.PATROCINIO	REVIEWED BY	J.I.SALAZAR	ENGINEER APPROVED	J.I.SALAZAR

INFORMATION DISCLOSED ON THIS DOCUMENT IS CONSIDERED PROPRIETARY AND SHALL NOT BE REPRODUCED OR DISCLOSED WITHOUT WRITTEN CONSENT OF NIDEC MOTOR CORPORATION

NIDEC MOTOR CORPORATION

ALL DIMENSIONS ARE FOR REFERENCE ONLY UNLESS TOLERANCE IS GIVEN

NIDEC MOTOR CORPORATION 27-Mar-12

TITLE	CODE	ITEM NO.	SIZE
ASSEMBLED VIEW	V01	772618	B