

9 LEADS TO EXTEND 4.000
+2.000, -0.000 INCHES BEYOND
TERMINAL COVER AND TUCKED
UNDER TERMINAL COVER. WRAP
WITH A CABLE TIE. LEADS TO BE
SKINNED .750

GROUND LUG

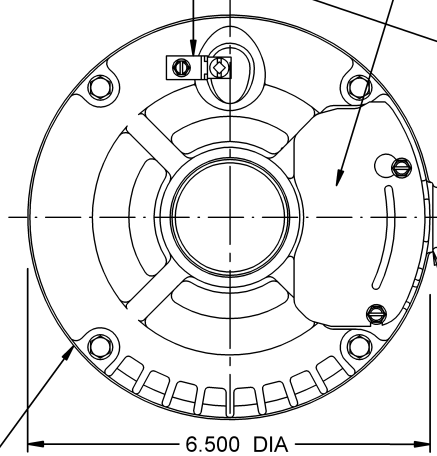

SEAM WELD

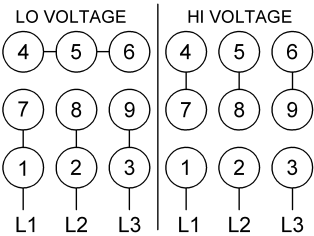

TO REVERSE ROTATION, INTERCHANGE
ANY TWO LINE LEADS.

WITH ABC PHASE SEQUENCE

PHASE A - LINE 1

PHASE B - LINE 2

PHASE C - LINE 3

ROTATION: CW LEAD END

NOTES:

1.) MOTOR TO BE SHIPPED CONNECTED FOR 230 VOLTS(LO VOLTS)

2.) SHAFT EXTENSION 303 STAINLESS STEEL.

1/2-20 UNF-2A RH THREAD

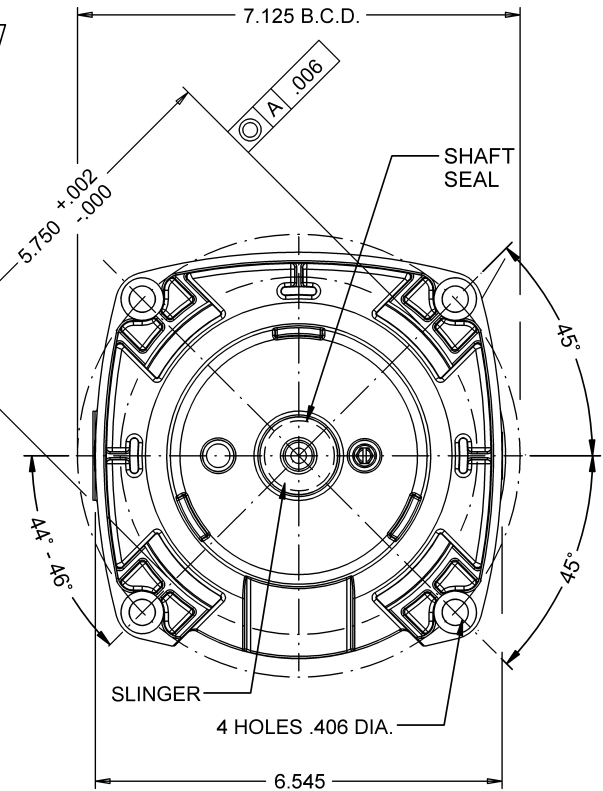
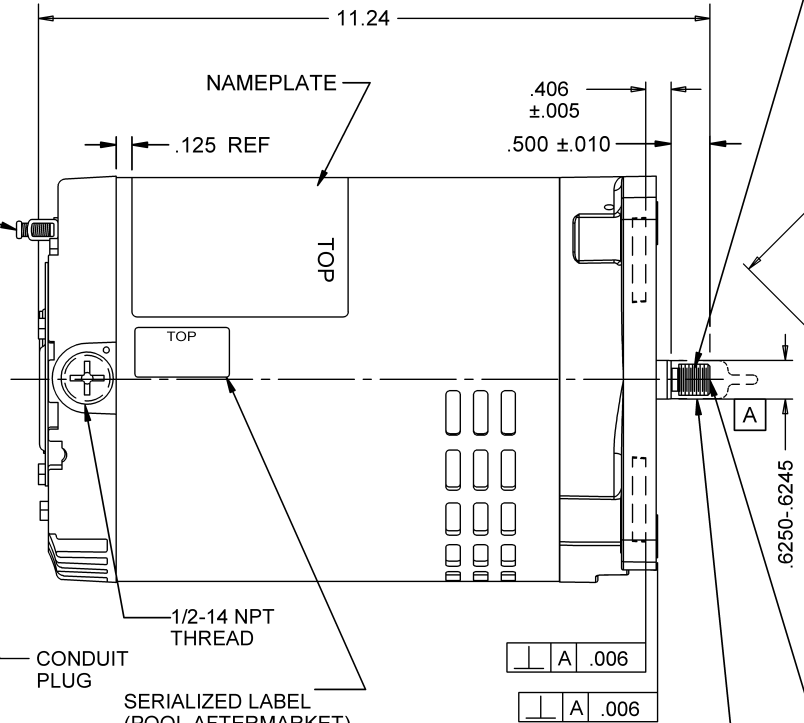

1/4-20 UNC 2B, LH
INTERNAL THRD.
.625 IN. DEEP MIN.

MODEL	REF	CUSTOMER	HP	VOLTS	AMPS	HZ	RPM	S.F.	S.F. AMPS
P63GEJ-4515		POOL AFTERMARKET	1/2	208-230/460		60/50	3450/2850	1.90/1.00	2.9-2.6/1.3
REVISION RECORD FOR: C7458-16								ROTATION	
SHEET NUMBER: 1 OF 1, REV: B, ADDED LABEL SERIALIZED & NOTE.								CUSTOMER PN	
REVISION DATE: 24-APR-13								CW LEAD END REV	
ISSUED BY: R. MORALES, REVIEWED BY: J. SCHRADER, ENGINEER APPROVED: J. SCHRADER								EH491	
INFORMATION DISCLOSED ON THIS DOCUMENT IS CONSIDERED PROPRIETARY AND SHALL NOT BE REPRODUCED OR DISCLOSED WITHOUT WRITTEN CONSENT OF NIDEC MOTOR CORPORATION								NIDEC MOTOR CORPORATION	
ALL DIMENSIONS ARE FOR REFERENCE ONLY UNLESS TOLERANCE IS GIVEN								TITLE	
ASSEMBLED VIEW								CODE	ITEM NO.
								V01	770418
								SIZE	B