

# iAquaLink™ 2.0

## Web Connect Device

For use with AquaLink® RS for Systems with Rev R Firmware or later

For use with PDA for Systems with Rev 6.0 Firmware or later.

For use with AquaLink Z4 Systems

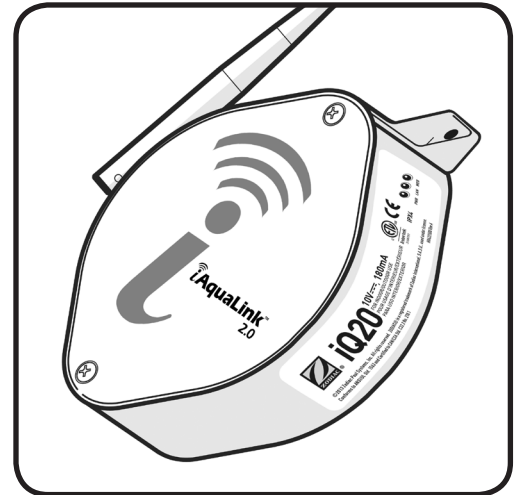

## **WARNING**

**FOR YOUR SAFETY - This product must be installed and serviced by a contractor who is licensed and qualified in pool equipment by the jurisdiction in which the product will be installed where such state or local requirements exist. The maintainer must be a professional with sufficient experience in pool equipment installation and maintenance so that all of the instructions in this manual can be followed exactly. Before installing this product, read and follow all warning notices and instructions that accompany this product. Failure to follow warning notices and instructions may result in property damage, personal injury, or death. Improper installation and/or operation will void the warranty.**

**Improper installation and/or operation can create unwanted electrical hazard which can cause serious injury, property damage, or death.**

## **ATTENTION**

This device complies with part 15 of the FCC Rules. Operation is subject to the following two conditions: (1) This device may not cause harmful interference, and (2) this device must accept any interference received, including interference that may cause undesired operation.

**NOTE:** This equipment has been tested and found to comply with the limits for a Class B digital device, pursuant to part 15 of the FCC Rules. These limits are designed to provide reasonable protection against harmful interference in a residential installation. This equipment generates, uses and can radiate radio frequency energy and, if not installed and used in accordance with the instructions, may cause harmful interference to radio communications. However, there is no guarantee that interference will not occur in a particular installation. If this equipment does cause harmful interference to radio or television reception, which can be determined by turning the equipment off and on, the user is encouraged to try to correct the interference by one or more of the following measures:

- Reorient or relocate the receiving antenna.
- Increase the separation between the equipment and receiver.
- Connect the equipment to an electrical source on a circuit different from that to which the receiver is connected.
- Consult the dealer or an experienced radio/TV technician for help.

**Modifications made to this equipment, which are not authorized by the manufacturer, may void the user's authority to operate this equipment.**



## Table of Contents

**NOTE** Some of the features described in this Manual DO NOT apply to all AquaLink RS models.

<b>Section 1. Important Safety Instructions .....</b>	<b>6</b>	8.10 Two Speed Operation (*Not Available for Export Models*) .....	20
<b>Section 2. Overview of the iAquaLink 2.0 Web Connect Device.....</b>	<b>7</b>	<b>Section 9. System Setup .....</b>	<b>21</b>
2.1 System Overview .....	7	9.1 System Setup Screen .....	21
2.2 iAquaLink Apps and Web Interface.....	7	9.2 Label Auxiliary Functions .....	21
<b>Section 3. Home Screen .....</b>	<b>8</b>	9.3 Color Lights .....	22
3.1 Navigation Bar .....	8	9.4 ESP Link (Seasonal Adjust) .....	22
<b>Section 4. Using the Menu Screen .....</b>	<b>9</b>	9.5 Set Dimmers .....	23
4.1 Menu Screen.....	9	9.6 OneTouch.....	23
4.2 To Set Up Date/Time.....	9	9.7 Spa Remotes .....	24
4.3 Schedule .....	9	9.8 Device Runtime.....	25
4.4 Set Temperature (For Pool and Spa Only System).....	10	9.9 Maintain Temp.....	26
4.5 Customize Home .....	11	9.10 RS InterLink .....	26
4.6 Lockouts and Password.....	12	9.11 Freeze Protection.....	26
4.7 AquaPure® .....	13	9.12 Assign JVs .....	27
4.8 Program Group .....	14	9.13 Dusk Setup .....	27
<b>Section 5. Using the OneTouch™ Menu ....</b>	<b>15</b>	9.14 All Off Time .....	28
5.1 OneTouch.....	15	9.15 Pump Lockout .....	28
5.2 All Off .....	15	9.16 Daylight Savings Time (DST).....	28
5.3 Spa Mode.....	15	9.17 Product Information.....	29
5.4 Clean Mode.....	15	9.18 Air Temperature .....	29
<b>Section 6. Using the Help Menu.....</b>	<b>16</b>	9.19 Temperature Calibrate .....	29
6.1 Help Menu.....	16	9.20 Degrees C/F.....	29
6.2 Help Sensors .....	16	9.21 In-Floor Cleaning .....	30
6.3 Help Remotes .....	16	9.22 Clear Memory .....	30
6.4 Help Errors.....	16	9.23 Cancel Delay.....	30
6.5 iAquaLink Status.....	16	<b>Section 10. Heat Pump Setup .....</b>	<b>31</b>
<b>Section 7. Using the Status Menu .....</b>	<b>16</b>	10.1 Solar Priority/Heat Pump Priority .....	31
7.1 Equipment Status .....	16	10.2 Heat Pump (Heat Mode).....	31
<b>Section 8. Using Other Devices On/Off.....</b>	<b>17</b>	10.3 Heat Pump (Chiller Mode) .....	32
8.1 Filter Pump .....	17	<b>Section 11. Variable Speed Pump Setup.....</b>	<b>32</b>
8.2 Variable Speed.....	17	11.1 To Select the Pump/Model .....	33
8.3 Spa.....	18	11.2 To Set Up the Pump Application .....	33
8.4 Pool Heat .....	18	11.3 To Set Up MIN/MAX Parameters .....	34
8.5 Spa Heat (Dual Equipment).....	18	11.4 To Set Up the Priming Speed.....	34
8.6 Solar Heat .....	18	11.5 To Set Up the Priming Duration Time.....	34
8.7 Auxiliary Equipment .....	19	11.6 To Assign a Pump Speed to an AUX.....	34
8.8 Using Color Lights.....	19	11.7 To Set Up Pump Speed .....	34
8.9 TEMP1 / TEMP2 (Pool or Spa Only) .....	20	11.8 To Re-label the Speed Preset.....	35
		11.9 Default Preset Speed Labels .....	35
		11.10 Variable Speed Pump Detail Operation .....	37
		<b>Section 12. Sprinkler System Setup.....</b>	<b>38</b>

12.1 Running the Sprinkler System .....38

12.2 Programming Sprinkler System .....39

**Section 13. ChemLink™ Setup ..... 41**

13.1 To Set Up the ChemLink .....41

13.2 To Configure the ORP Controller .....41

13.3 To Configure the pH Controller .....43

13.4 Manual Feed Activation.....46

**Section 14. Glossaries ..... 47**

14.1 Safety Delays and Lockouts .....47

14.2 Special Auxiliary Labels .....47

14.3 Controller Messages .....48

**Section 15. iAquaLink Menu Flow Chart ..... 50**

<b>EQUIPMENT INFORMATION RECORD</b>	
<b>DATE OF INSTALLATION</b>	_____
<b>INSTALLER INFORMATION</b>	_____
<b>INITIAL PRESSURE GAUGE READING (WITH CLEAN FILTER)</b>	_____
<b>PUMP MODEL</b>	_____
<b>HORSEPOWER</b>	_____
<b>FILTER MODEL</b>	_____
<b>SERIAL NUMBER</b>	_____
<b>CONTROL PANEL MODEL</b>	_____
<b>SERIAL NUMBER</b>	_____
<b>NOTES:</b>	_____
	_____
	_____

## Section 1. Important Safety Instructions

### READ AND FOLLOW ALL INSTRUCTIONS

All electrical work must be performed by a licensed electrician and conform to all national, state, and local codes. When installing and using this electrical equipment, basic safety precautions should always be followed, including the following:

#### DANGER

To reduce the risk of injury, do not remove the suction fittings of your spa or hot tub. Never operate a spa or hot tub if the suction fittings are broken or missing. Never replace a suction fitting with one rated less than the flow rate marked on the equipment assembly.

#### WARNING

Prolonged immersion in hot water may induce hyperthermia. Hyperthermia occurs when the internal temperature of the body reaches a level several degrees above the normal body temperature of 98.6°F (37°C). The symptoms of hyperthermia include dizziness, fainting, drowsiness, lethargy, and an increase in the internal temperature of the body. The effects of hyperthermia include: 1) unawareness of impending danger; 2) failure to perceive heat; 3) failure to recognize the need to exit spa; 4) physical inability to exit spa; 5) fetal damage in pregnant women; 6) unconsciousness resulting in a danger of drowning.

#### WARNING

##### To Reduce the Risk of Injury -

- a) The water in a spa should never exceed 104°F (40°C). Water temperatures between 100°F (38°C) and 104°F (40°C) are considered safe for a healthy adult. Lower water temperatures are recommended for young children and when spa use exceeds 10 minutes.
- b) Since excessive water temperatures have a high potential for causing fetal damage during the early months of pregnancy, pregnant or possibly pregnant women should consult a physician before using a spa or hot tub, and should limit spa water temperatures to 100°F (38°C). Water temperature in excess of 38°C (100°F) may be injurious to your health.
- c) Before entering a spa or hot tub, the user should measure the water temperature with an accurate thermometer since the tolerance of water temperature-regulating devices varies.
- d) The use of alcohol, drugs, or medication before or during spa or hot tub use may lead to unconsciousness with the possibility of drowning.
- e) Obese persons and persons with a history of heart disease, low or high blood pressure, circulatory system problems, or diabetes should consult a physician before using a spa.
- f) Persons using medication should consult a physician before using a spa or hot tub since some medication may induce drowsiness while other medication may affect heart rate, blood pressure, and circulation.

#### WARNING

**Risk of electric shock** - Install the power center at least five (5) feet (1.52m) from the inside wall of the pool and/or hot tub using non-metallic plumbing. Canadian installations must be at least three (3) meters from the water.

Children should not use spas or hot tubs without adult supervision.

Do not use spas or hot tubs unless all suction guards are installed to prevent body and hair entrapment.

People using medications and/or having an adverse medical history should consult a physician before using a spa or hot tub.

**⚠ WARNING**

People with infectious diseases should not use a spa or hot tub.

To avoid injury, exercise care when entering or exiting the spa or hot tub.

Do not use drugs or alcohol before or during the use of a spa or hot tub to avoid unconsciousness and possible drowning.

Do not use a spa or hot tub immediately following strenuous exercise.

Prolonged immersion in a spa or hot tub may be injurious to your health.

Do not permit any electric appliance (such as a light, telephone, radio, or television) within 5 feet (1.52m) of a spa or hot tub.

The use of alcohol, drugs or medication can greatly increase the risk of fatal hyperthermia in hot tubs and spas.

**⚠ WARNING**

To avoid injury ensure that you use this control system to control only packaged pool/spa heaters which have built-in operating and high limit controls to limit water temperature for pool/spa applications. This device should not be relied upon as a safety limit control.

**⚠ WARNING**

A terminal bar marked "GROUND" is provided within the power center. To reduce the risk of electrical shock which can cause serious injury or death, connect this terminal bar to the grounding terminal of your electric service or supply panel with a continuous copper conductor having green insulation and one that is equivalent in size to the circuit conductors supplying this equipment, but no smaller than no. 12 AWG (3.3mm<sup>2</sup>). In addition, a second wire connector should be bonded with a no. 8 AWG (8.4mm<sup>2</sup>) copper wire to any metal ladders, water pipes, or other metal within five (5) feet (1.52 m) of the pool/spa. In Canada the bonding wire must be minimum 6 AWG (13.3mm<sup>2</sup>).

**⚠ CAUTION**

A ground-fault circuit-interrupter must be provided if this device is used to control underwater lighting fixtures. The conductors on the load side of the ground-fault circuit-interrupter shall not occupy conduit, boxes, or enclosures containing other conductors unless the additional conductors are also protected by a ground-fault circuit-interrupter. Refer to local codes for complete details.



**Attention installer:** Install to provide drainage of compartment for electrical components.

## SAVE THESE INSTRUCTIONS

## Section 2. Overview of the iAquaLink 2.0 Web Connect Device

Welcome, and thank you for purchasing the iAquaLink 2.0 Web Connect Device!

The iAquaLink 2.0 Web Connect Device connects an AquaLink System to the Internet through your existing residential internet service.

Follow these instructions to operate the iAquaLink Web Connect Device on any device with access to the web.

### 2.1 System Overview

The iAquaLink 2.0 Web Connect Device can be used with most existing AquaLink control systems, however, the firmware in the power center may need to be updated to at least the revision level shown below:

AquaLink RS - requires revision R or newer.

AquaLink PDA - requires revision 6.0 or newer

AquaLink Z4 - all revisions will work

### 2.2 iAquaLink Apps and Web Interface

The iAquaLink 2.0 Web Connect Device must be installed prior to using the iAquaLink Web Interface and registration of the product.

If you are installing the device yourself, please follow the online installation and registration instructions at [www.iAquaLink.com](http://www.iAquaLink.com) and refer to the Quick Start Guide (P/N H0364300) and the Installation Manual (P/N H0364100).

For additional assistance, contact our Technical Support Department at 1-800-822-7933.

### Mobile Smart Device Apps

#### IMPORTANT

Prior to accessing the Smart Device App and Web Browser Interface, make sure the installation and registration of the iAquaLink Web Connect Device has been completed successfully.

The smart device apps offer basic automation solutions to control the pool and spa features anytime, anywhere.

Free iAquaLink smart device apps are available for devices such as Android®, iPhone®, iPad®, iPod Touch®, or any other HTML5 enabled device.

### To download your App:

- Go to iTunes App Store<sup>SM</sup> and search Zodiac® iAquaLink, for iPhone, iPad, or iPod Touch.
- Go to the Android Market and search Zodiac iAquaLink, for any Android device.

For instructions on how to use the smart device app, see the Welcome Brochure (P/N H0369500) included in your iAquaLink package.

### Web Browser Interface

Using your personal computer or laptop, you can use the iAquaLink web interface to program, customize, control, and configure every device and feature available with your AquaLink control systems.

**NOTE:** The Web Browser Interface is not available for use with the AquaLink Z4 controller.

### How to Access the Web Browser Interface:

- Go to [www.iAquaLink.com](http://www.iAquaLink.com) and login to enter the "Welcome to iAquaLink Owner's Center".
- Select the "Locations" tab to display the iAquaLink Owner's Center. If your device is not listed, click "Add Location" and follow the online instructions.
- Once your device is added, click on it to access the HOME screen of your iAquaLink Web Interface.

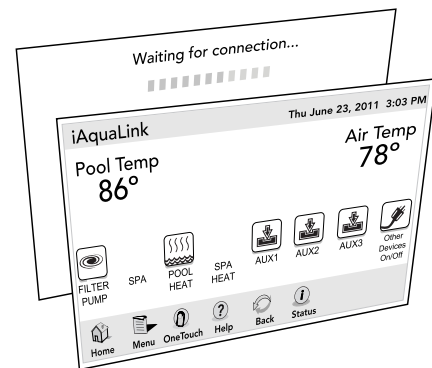

## Section 3. Home Screen

This screen is the starting point for each session, providing access to the main navigation bar.

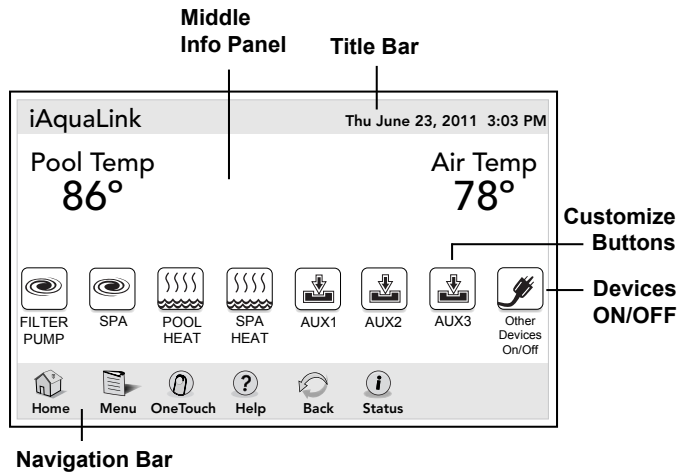

### 3.1 Navigation Bar

The navigation bar displays the following links:

- HOME** Returns the user to the HOME screen.
- MENU** Displays the main menu setup and programming.
- ONETOUCH** Turns on/off preset mood/scene settings.
- HELP** Displays the service and equipment information.
- BACK** Returns the user to the previous screen.
- STATUS** Displays information about the equipment.

## Section 4. Using the Menu Screen

### 4.1 Menu Screen

The MENU screen provides access to the main links to program, setup, schedule, and customize your pool/spa system.

## To Display the Menu Screen

HOME > MENU

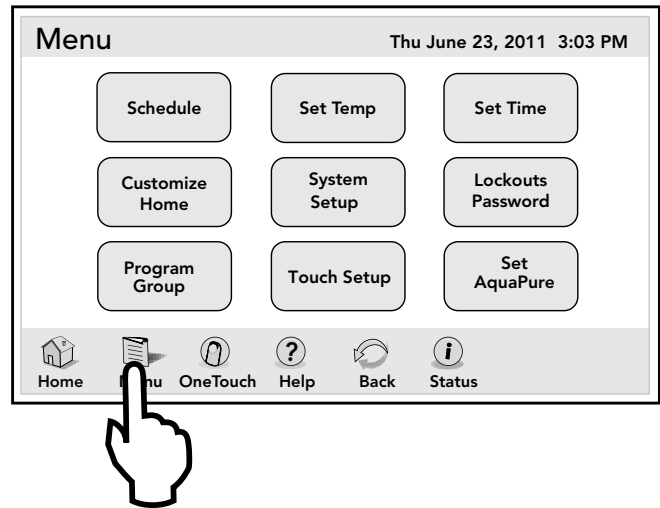

### 4.2 To Set Up Date/Time

The DATE/TIME screen allows the current date and time to be entered.

#### CAUTION

Make sure DATE and TIME are set up correctly before programming and scheduling any devices.

### Date

MENU > SET DATE/TIME

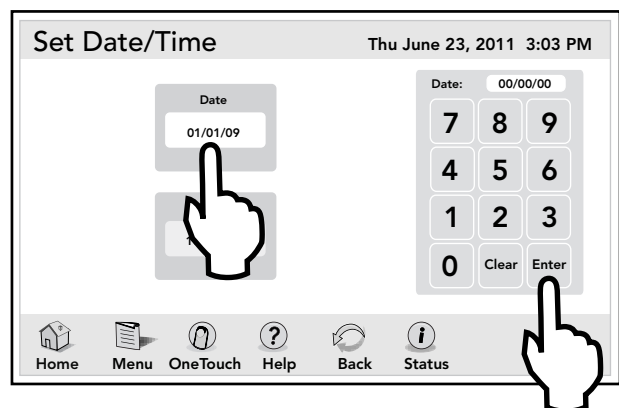



## Time

### MENU > SET DATE/TIME

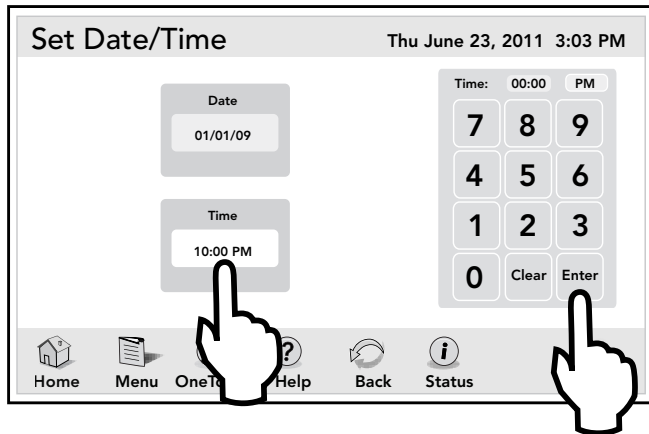

## 4.3 Schedule

### CAUTION

Make sure DATE and TIME are set up correctly before programming and scheduling any devices.

The SCHEDULE screen allows ON and OFF times to be programmed for any circuit (equipment) controlled by the iAquaLink.

The circuit can be scheduled to turn ON or OFF all days, weekends, weekdays, or any specific day of the week. Circuits are not listed in the SCHEDULE box until a START and STOP time are entered.

### MENU > SCHEDULE

The SCHEDULE screen displays each circuit schedule, START and STOP time, along with run days.

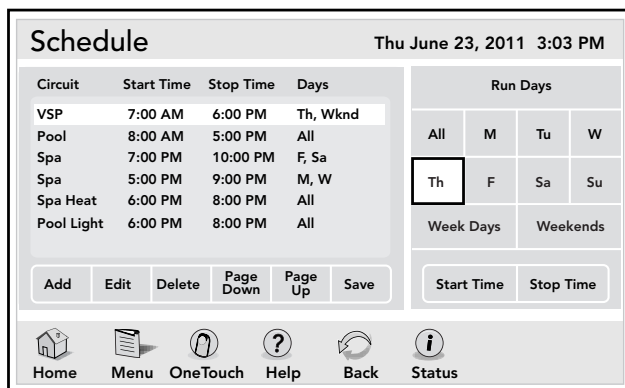

### Adding Devices to the Circuit List

Adding new devices to the circuit list on the SCHEDULE screen is a two-step procedure.

#### First Step - Selecting and adding the new device

### MENU > SCHEDULE > ADD

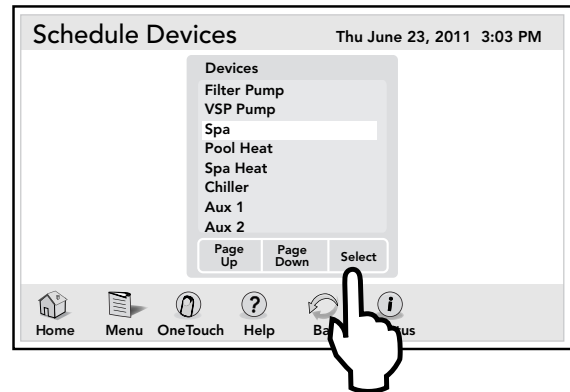

**NOTE** Only one item can be selected at a time.

#### Second Step - Programming the new device

### MENU > SCHEDULE > EDIT > SAVE

Enter the run day for the new device and click SAVE

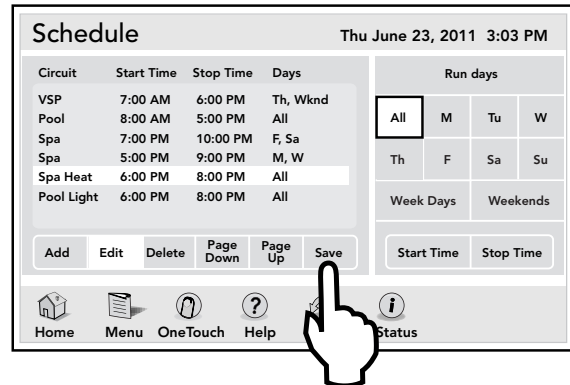

### Deleting Devices from the Circuit List

### MENU > SCHEDULE > DELETE

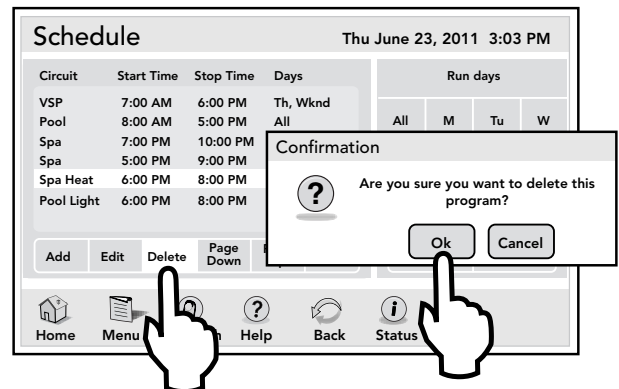

## ON/OFF Times

MENU > SCHEDULE > EDIT > START TIME/STOP TIME

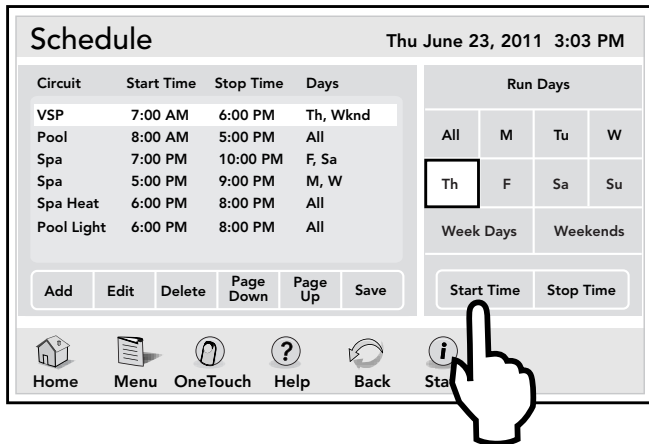

After setting all schedules click ENTER to store.

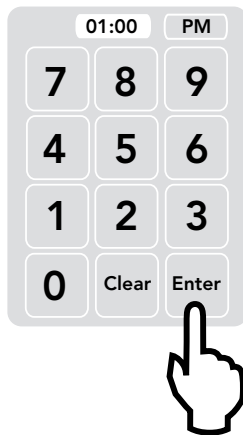

### 4.4 Set Temperature (For Pool and Spa Only System)

The SET TEMPERATURE allows to preset the pool and spa thermostats.

The default POOL temperature is 80°F (27°C). The default SPA temperature is 102°F (39°C).

Pool and Spa heat temperatures can be adjusted between 34°F (1°C) through 104°F (40°C).

**NOTE** If you enter temperatures outside this range, an invalid entry message will be displayed.

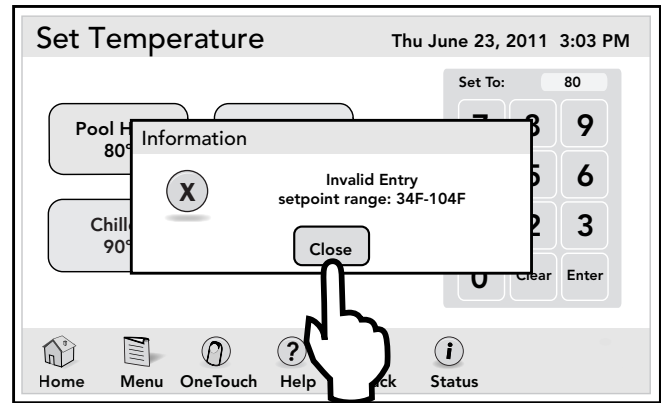

### Pool Heat

MENU > SET TEMP > POOL HEAT

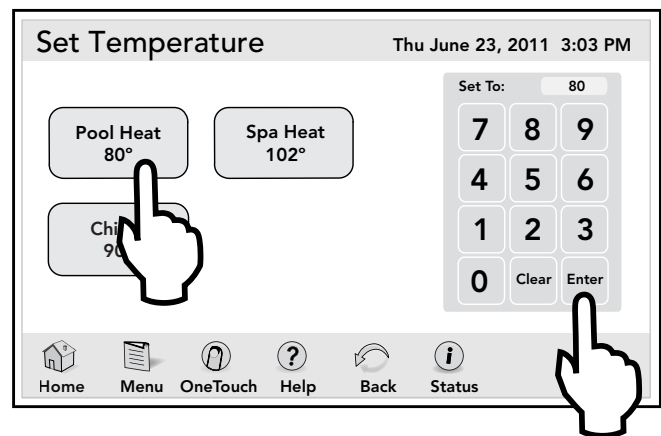

### Spa Heat

MENU > SET TEMP > SPA HEAT

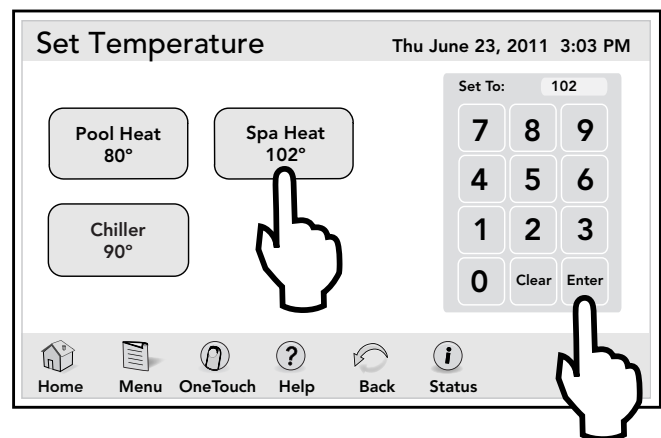

## Chiller

**NOTE** To use this feature, a Jandy® Heat Pump/Chiller model must be installed. If not installed, the chiller button will not be displayed.

### MENU > SET TEMP > CHILLER

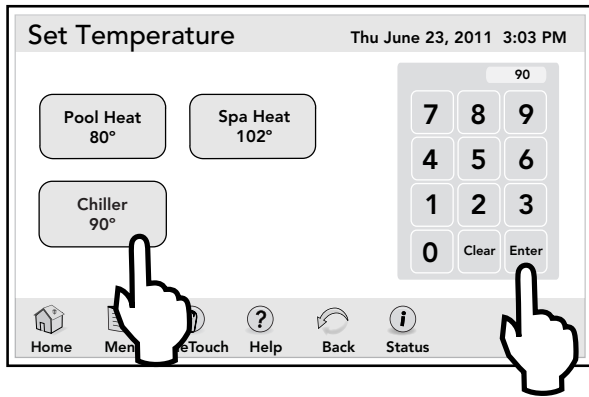

## 4.5 Customize Home

The CUSTOMIZE HOME screen is used to link and label the icons of the HOME screen to general items, auxiliaries, and OneTouch™ settings.

### MENU > CUSTOMIZE HOME

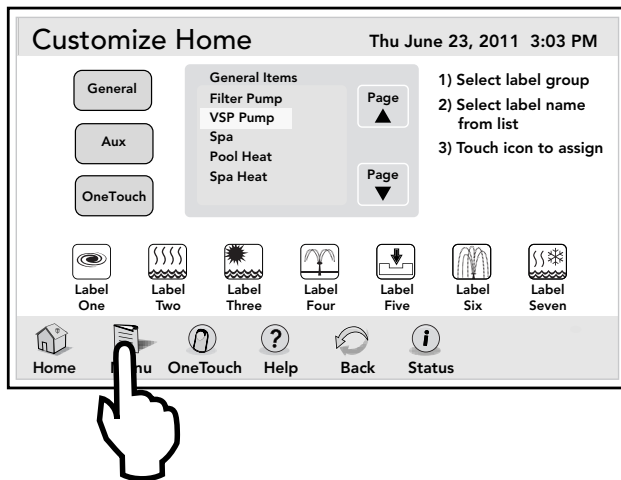

### Customize General, Aux and OneTouch Items

The customization of the icons on the HOME screen is a three-step procedure:

- Select a group, either GENERAL, AUX or ONETOUCH.
- Select an item in the list.
- Click an icon to assign.

### MENU > CUSTOMIZE HOME

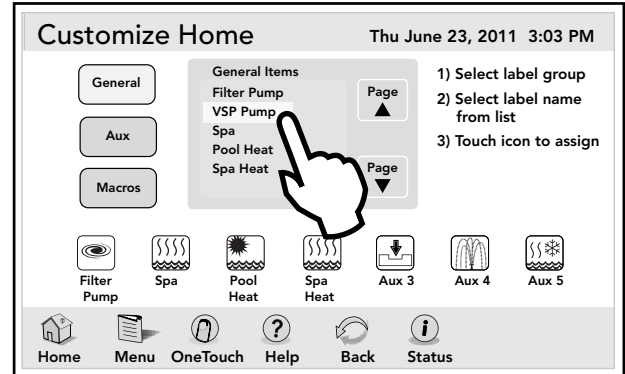

Click an unassigned icon. The label of the icon should reflect the selected item.

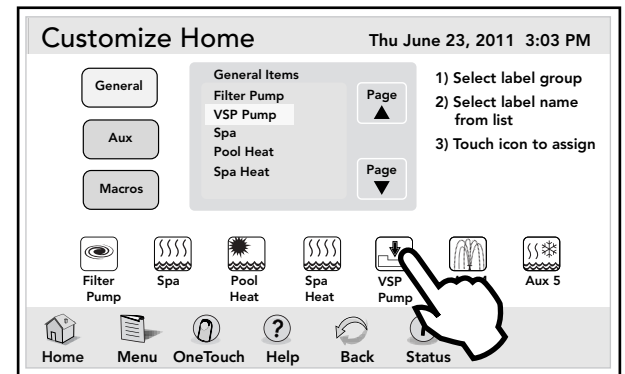

**NOTE:** OneTouch items are not available for use with the AquaLink Z4 controller.

## 4.6 Lockouts and Password

The LOCKOUTS PASSWORD screen prevents changes to specific AquaLink RS operations.

### To Lockout Devices

When SYSTEM feature is on "LOCK", changes to program and system setup items are prevented. When SPALINK® RS and SPA SWITCH features are on "LOCK", all control from the SpaLink RS and Spa Side Switch are prevented.

When DEVICE feature is on "LOCK", the selected device cannot be controlled manually. However, the device can be controlled by a program.

## MENU &gt; LOCKOUTS PASSWORD

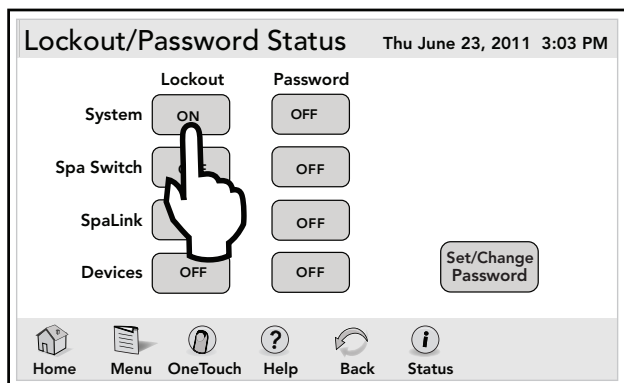

Click the PASSWORD button on the desired item to turn it ENABLE or OFF.

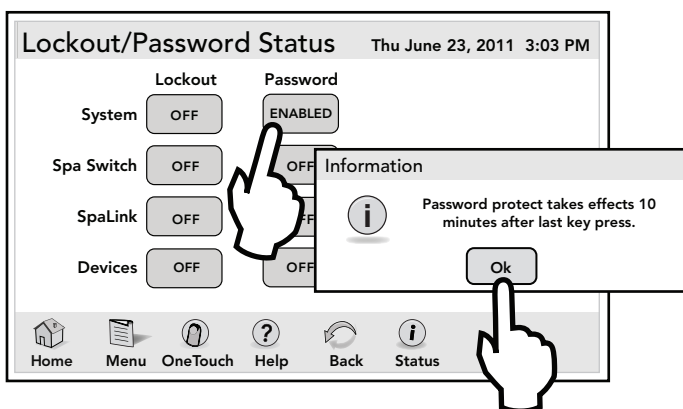

### To Set Lockout Password

With LOCKOUT PASSWORD, the user may restrict access to programs, temperature settings, group settings, and system setup. One practical use of this feature might be to allow an owner to restrict the control of equipment located at a rental property.

**NOTE** Password must be a four (4) digit number and the same password is used for System, Programs, Spa Side Switch, SpaLink® and Devices.

## MENU &gt; LOCKOUTS PASSWORD &gt; SET/CHANGE PASSWORD

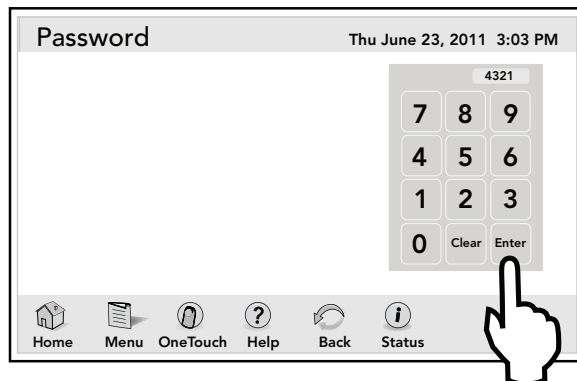

### How to Use the System when a Password is Enabled

If a password is enabled for the system and a user tries to access: Set Temperature, Set Time, Programs, Program Groups, or System Setup, a Password Entry Screen will appear to allow the user to continue with their selection.

If a password is enabled for a device, and a user tries to access that device from a OneTouch™ control panel, a password entry screen will appear to allow the user to continue with their selection.

If a password is enabled and entered for a SpaLink or a Spa Side Remote and a user tries to use either of those devices, the units will not respond.

To enable any of these devices, click the LOCKOUT PASSWORD button in the MENU screen. Choose the equipment and click the PASSWORD button in the LOCKOUT/PSWD STATUS screen and enter the current password.

The system will accept a default password of 1234.

**NOTE** Once a password has been entered, you can access the device or menu item. If you do not press any keys for 10 minutes, then you will be required to enter the password when you try to access the device or menu item.

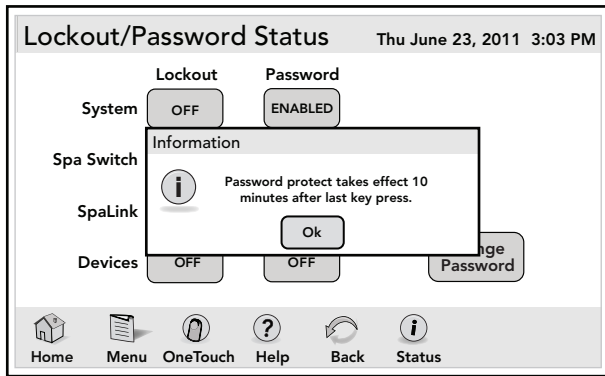

If a password is forgotten, consult your dealer for instructions.

Passwords will only be applied if the PASSWORD PROTECT item is set to ENA and a PASSWORD is entered. Password protecting the system, programs, or devices does not require LOCKOUTS to be set for those devices.

#### 4.7 AquaPure®

**NOTE** This equipment may not be part of your system. Please check with your installer.

The AquaPure chlorine generator system exclusively communicates with the AquaLink RS system. The SET CHLORINE PRODUCTION screen shown below will display the percentage of chlorine output.

The AquaLink RS system when interfaced with AquaPure chlorine generator system or PureLink™ allows set points for pool and spa chlorine production.

**NOTE** When the Chlorine Generator output percentage is set to a value greater than 0 and the filter pump is on, the system salinity level and output percentage will appear on the equipment status screen.

#### MENU > SET AQUAPURE > SET CHLORINE PRODUCTION

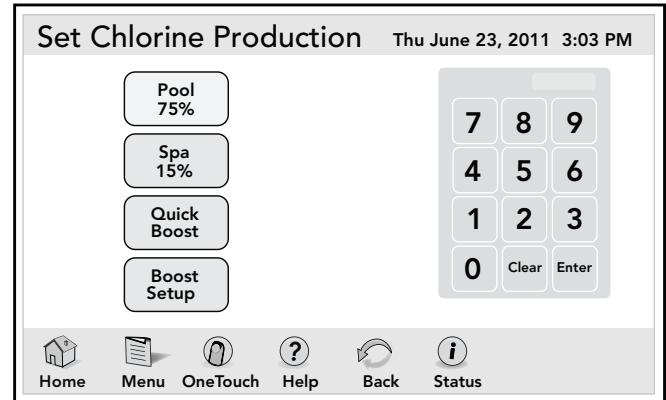

#### To Set Up Pool/Spa

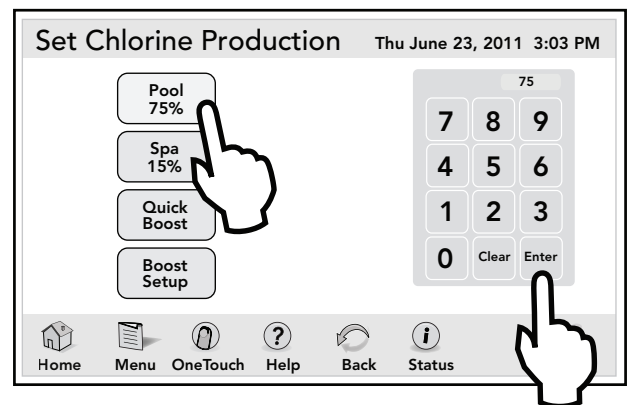

#### To Set Up Quick Boost

Click the QUICK BOOST button to display the AQUAPURE BOOST menu.

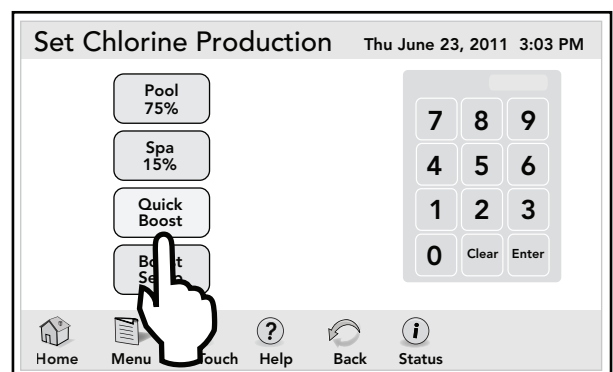

Click the START button to operate the AquaPure chlorinator.

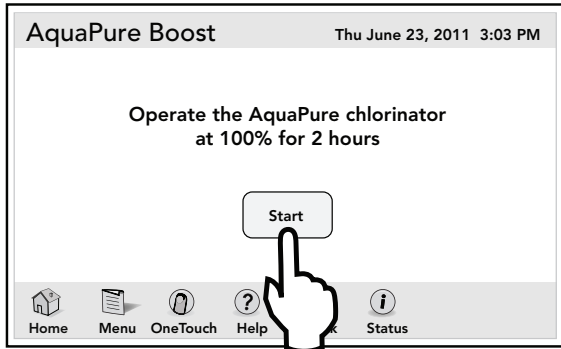

**To Pause, Restart and Stop Quick Boost**  
**MENU > SET AQUAPURE > SET CHLORINE PRODUCTION > QUICK BOOST**

**NOTE** This screen will appear on the iAquaLink when the AquaPure® chlorinator starts operating.

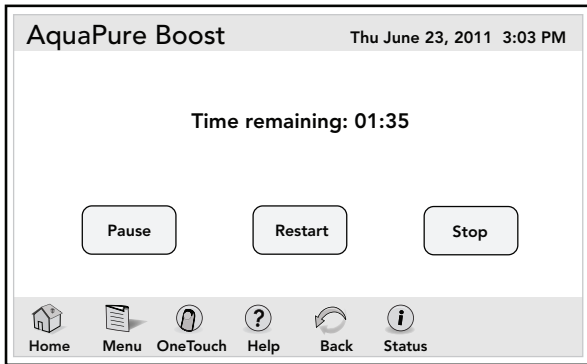

**Boost Setup**

The MODE selection is only available if the DIP switch S1-3 is in the ON position (Spillover mode).

**NOTE** All DIP switches are located on the left side of the AquaLink RS power center bezel.

**MENU > SET AQUAPURE > SET CHLORINE PRODUCTION > BOOST SETUP**

If selecting MODE, click the MODE button and choose either pool or spillover.

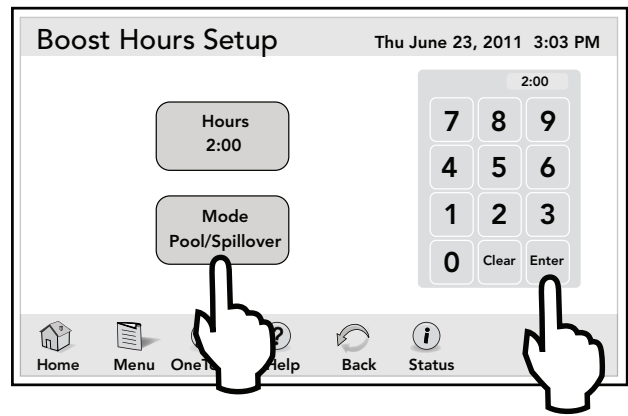

**4.8 Program Group**

PROGRAM GROUPS are useful for changing between specific settings for summer, winter, or vacation. The iAquaLink will store on/off times for equipment in each group.

Use the PROGRAM GROUP menu to switch between program group A and program group B. Group A is the default. Confirm you are in the right program group before programming equipment.

**MENU > PROGRAM GROUP**

On the MENU screen, click the PROGRAM GROUP button to display the PROGRAM GROUP screen.

**A and B Groups**

**MENU > PROGRAM GROUP > GROUP A/GROUP B**

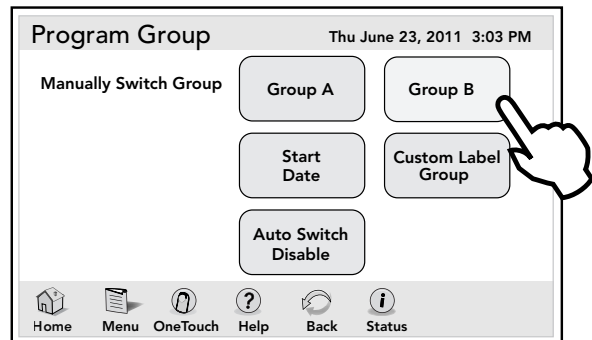

## Program Auto Switch

If you want the Program Groups to switch automatically, select a group and enter new date.

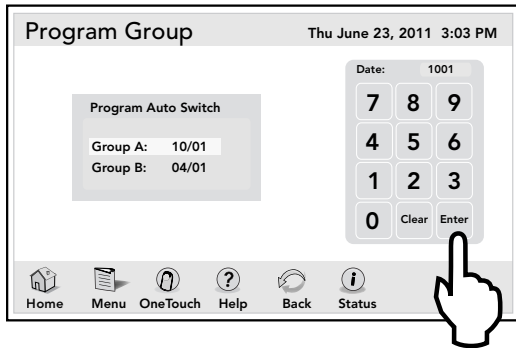

## Custom Label Group

The names of the PROGRAM GROUPS can be customized using the CUSTOM LABEL screen.

**MENU > PROGRAM GROUP > CUSTOM LABEL GROUP**

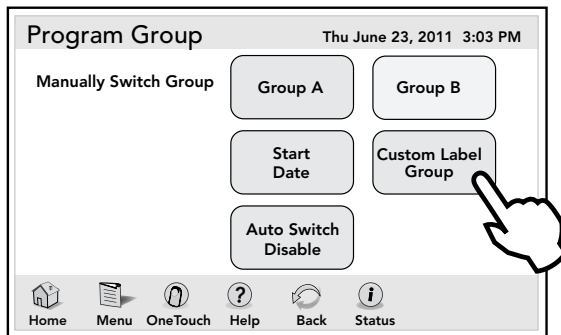

## Section 5. Using the OneTouch™ Menu

### 5.1 OneTouch

Each OneTouch setting will allow the user to run multiple devices and heat the water to preset temperatures with the click of one button.

**HOME > ONETOUCH**

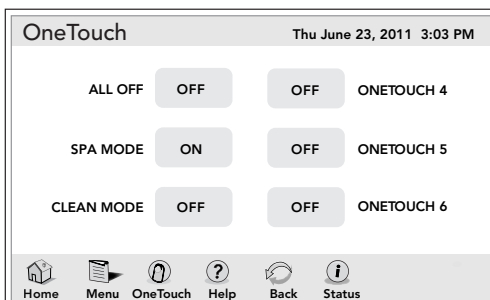

### 5.2 All Off

The ALL OFF mode will turn off equipment that has been turned on by any means (unless in use by Maintain function).

**HOME > ONETOUCH > ALL OFF**

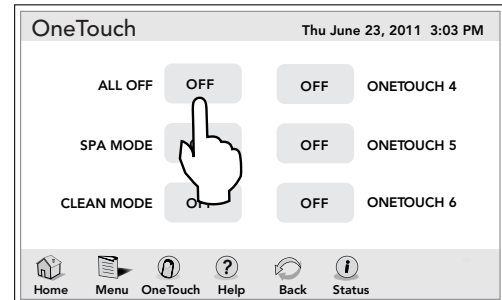

### 5.3 Spa Mode

**HOME > ONETOUCH > SPA MODE**

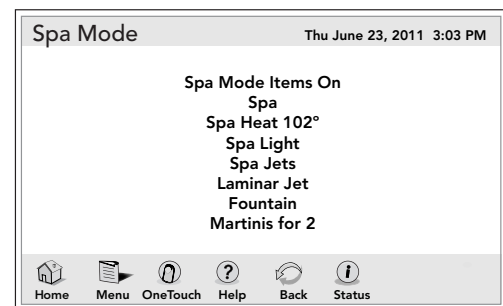

### 5.4 Clean Mode

The CLEAN MODE, when selected, will turn on the filter pump only.

If the DIP switch S1-1 is in the ON position, the CLEAN MODE will turn on the FILTER PUMP followed by the CLEANER PUMP after a three (3) minute delay.

**NOTE** All DIP switches are located on the left side of the AquaLink RS power center bezel.

**HOME > ONETOUCH > CLEAN MODE**

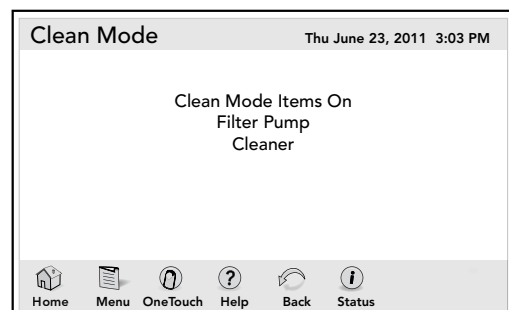

## Section 6. Using the Help Menu

### 6.1 Help Menu

The HELP menu displays service information about your local service provider as entered in the PRODUCT INFORMATION system setup section.

See Section 9.17, "Product Information".

The HELP menu screen also provides diagnostic system information such as connection of devices, operation state of sensors, and errors of the system, if any.

HOME > HELP

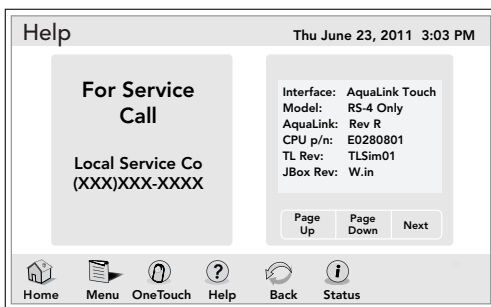

### 6.2 Help Sensors

This screen displays the operation state of the sensors.

HOME > HELP > HELP SENSORS

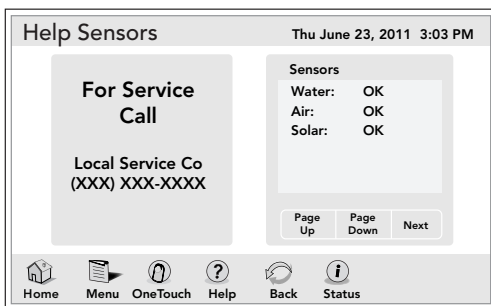

### 6.3 Help Remotes

This screen lists all the equipment available through the RS485 Network.

HOME > HELP > DIAGNOSTICS > NEXT

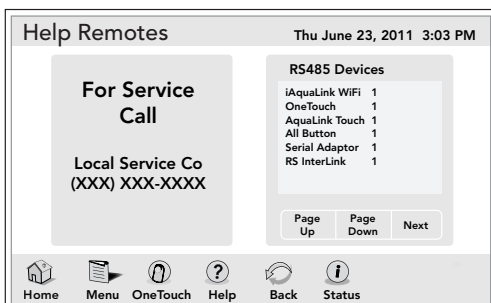

### 6.4 Help Errors

The ERRORS screen lists all equipment with faults.

HOME > HELP > ERRORS

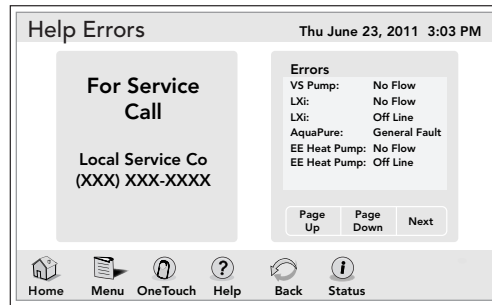

### 6.5 iAquaLink Status

The iAquaLink status screen monitors network information.

HOME > HELP > IAQUALINK STATUS

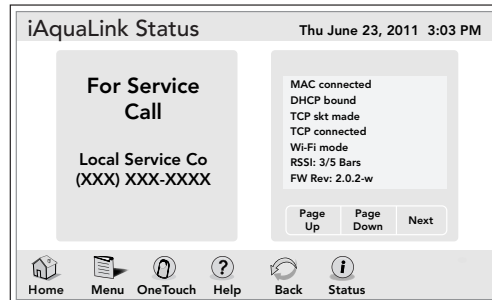

## Section 7. Using the Status Menu

### 7.1 Equipment Status

HOME > STATUS

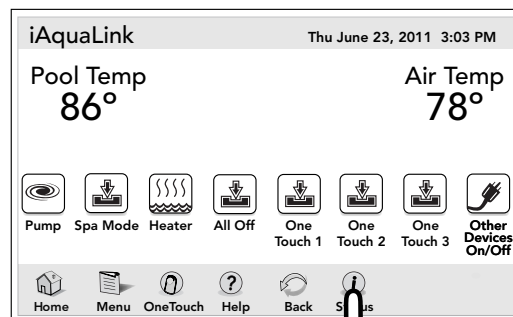



The EQUIPMENT STATUS screen provides the current status of all equipment.

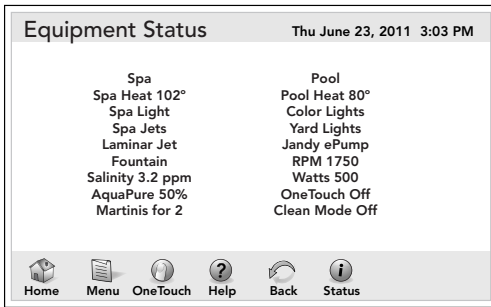

**NOTE** The EQUIPMENT STATUS screen will timeout after approximately 25 seconds at which time the previous screen will be displayed.

## Section 8. Using Other Devices On/Off

Use this menu to manually turn on or off any equipment.

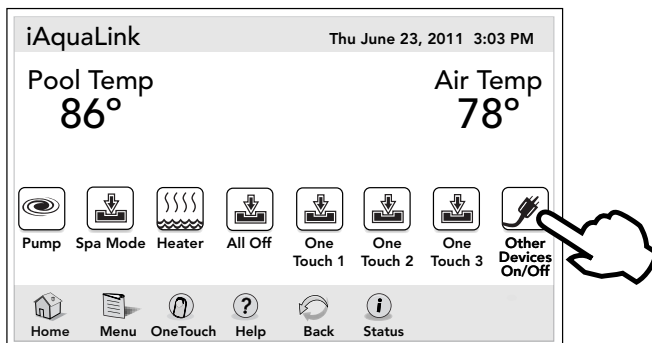

HOME > OTHER DEVICES ON/OFF

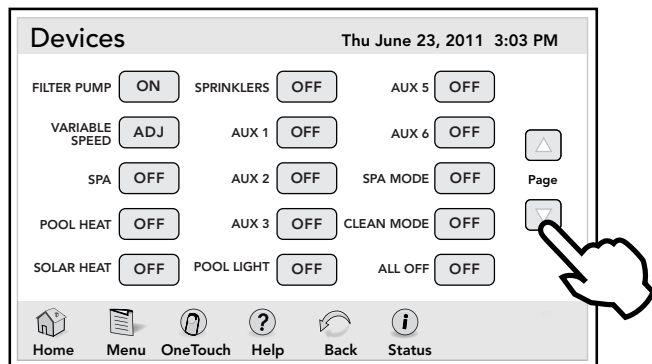

## 8.1 Filter Pump

The FILTER PUMP selection turns the main filtration pump on or off for circulation to the pool. The filter pump also activates if the spa is turned on, if the pool cleaner is turned on, or if the spa spill-over effect is activated.

The main filtration pump circulates the pool or spa water through the filter and heater. The pump must be on if you want to display the pool temperature, or if you want to heat the pool.

HOME > OTHER DEVICES ON / OFF > FILTER PUMP

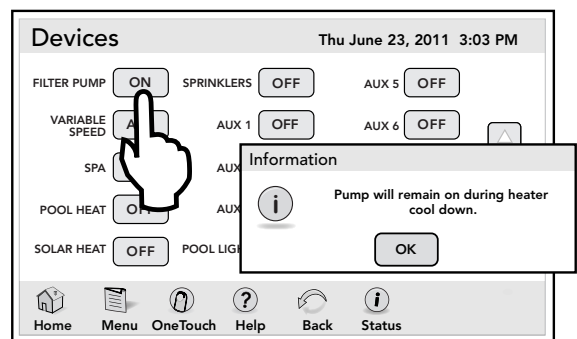
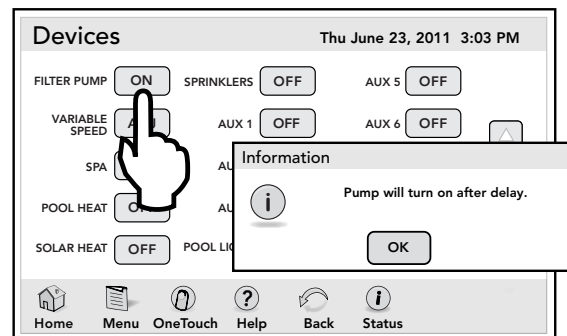

## 8.2 Variable Speed

**NOTE** This equipment may not be part of your system. Please check with your installer.

HOME > OTHER DEVICES ON / OFF > ADJ

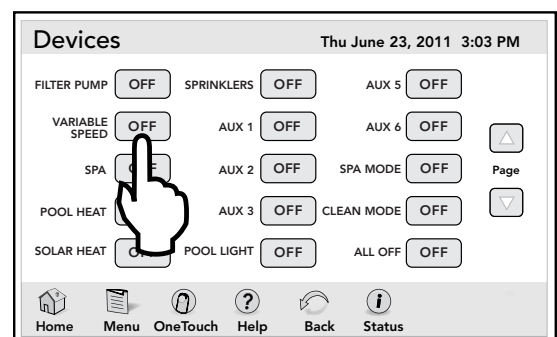

## 8.3 Spa

The SPA switches water circulation from the pool to spa (pool/spa combination models only). Turning on the spa also activates the filter pump (after a delay for valve rotation) and deactivates the pool cleaner if it is on.

Activation takes place after a 30 seconds delay (while valves are turning).

HOME > OTHER DEVICES ON / OFF > SPA

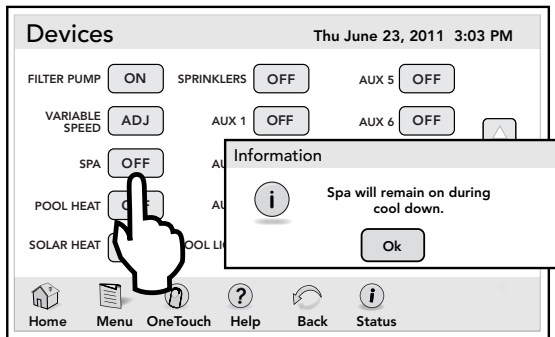
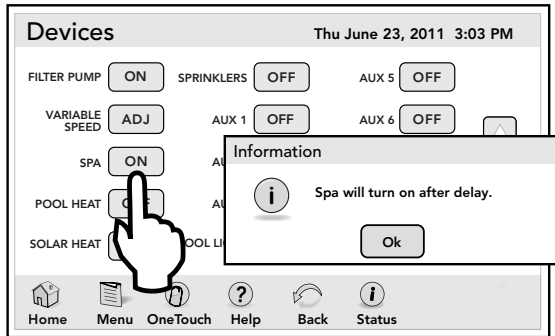

## 8.4 Pool Heat

The POOL HEAT selection enables the heater for the pool. The POOL HEAT uses the setting from SET TEMP menu and also gives you the option to increase or decrease the pool heater temperature.

HOME > OTHER DEVICES ON / OFF > POOL HEAT

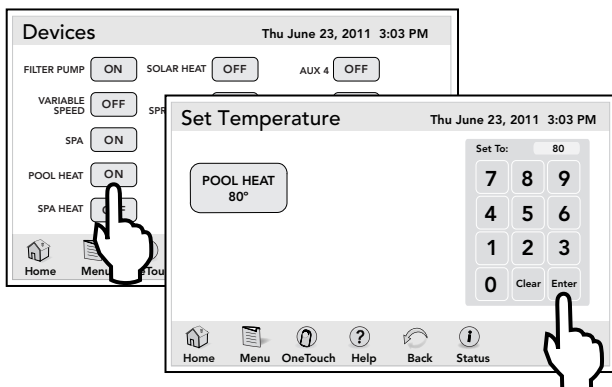

The default pool temperature is 80°F (27°C).

The pool and spa heat temperatures can be adjusted between 34°F (1°C) through 104°F (40°C).

**NOTE** If you enter temperatures outside this range, an invalid entry message will be displayed.

## 8.5 Spa Heat (Dual Equipment)

This feature is also available on the HOME screen for pool and spa systems.

The SPA HEAT enables the heater for the spa. The SPA HEAT uses the setting from SET TEMP menu and also gives you the option to adjust the spa temperature.

HOME > OTHER DEVICES ON / OFF > SPA HEAT

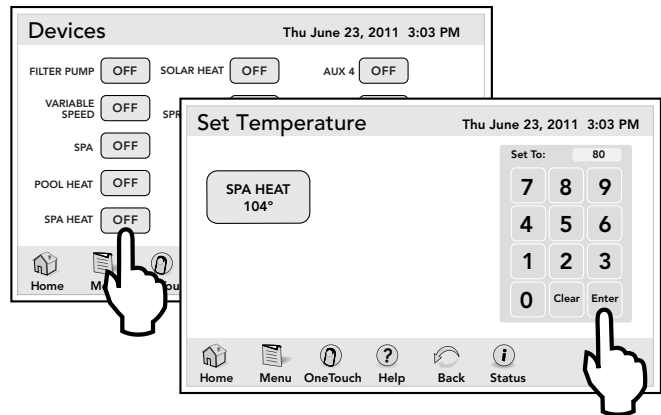

The default spa temperature is 102°F (39°C).

The pool and spa heat temperatures can be adjusted between 34°F (1°C) through 104°F (40°C).

**NOTE** If you enter temperatures outside this range, an invalid entry message will be displayed.

## 8.6 Solar Heat

**NOTE** If a Heat Pump is properly connected to this system, HEAT PUMP will appear on the screen in place of SOLAR HEAT.

The SOLAR HEAT selection controls solar heating. A solar heating system and optional solar sensor are required for SOLAR HEAT selection to operate.

## HOME &gt; OTHER DEVICES ON / OFF &gt; SOLAR HEAT

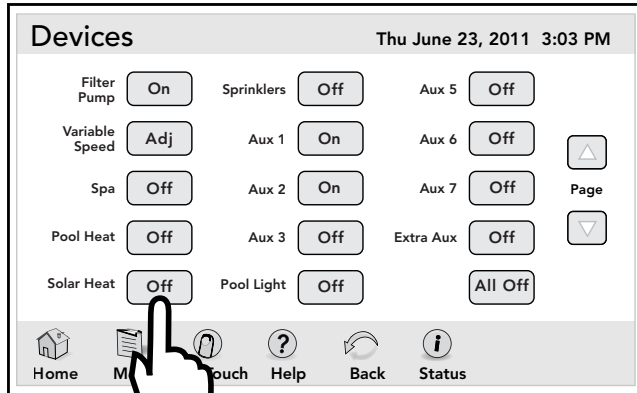

**NOTE** If a solar sensor is not installed, EXTRA AUX replaces SOLAR HEAT and may be used to control an auxiliary piece of equipment (see the following Section 9.7, "Auxiliary Equipment" to turn on or off EXTRA AUX).

For solar heating to take place, the SOLAR HEAT (DEVICES ON/OFF) must be enabled and the filter pump must be on.

Solar temperature must be at least 5°F/5°C above the water temperature and the water must be cooler than the thermostat setting.

## 8.7 Auxiliary Equipment

The AUX modes control each of the auxiliary devices. To assign a different name to an auxiliary device, use the SYSTEM SETUP and LABEL AUX screen.

## HOME &gt; DEVICES &gt; AUX3

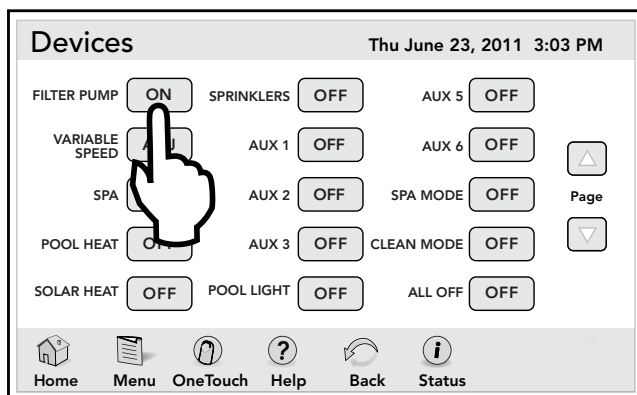

## 8.8 Using Color Lights

**NOTE** Prior to setting the color of the light, the light must be assigned and controlled by an auxiliary (for example, AUX 1). Please note that the auxiliary control can be custom labeled.

## HOME &gt; OTHER DEVICES ON/OFF &gt; AUX1 &gt; SET COLORS

### IMPORTANT Information

Do not activate this feature unless you are certain that color lights are installed on your system

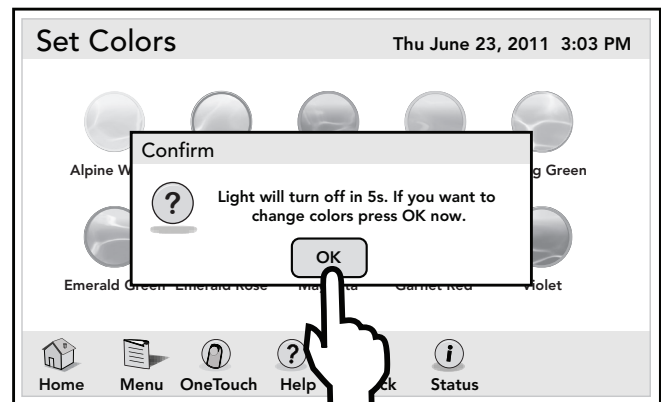
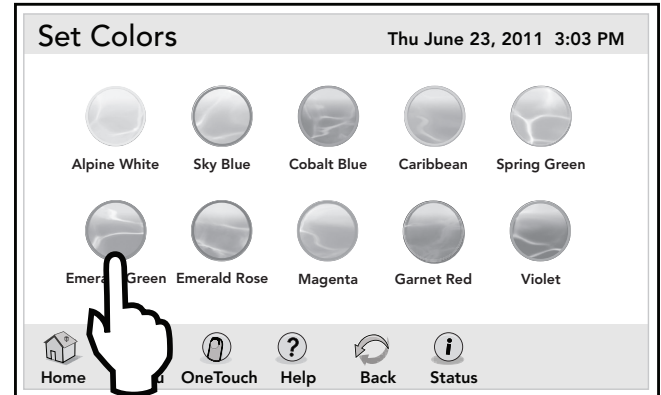

**NOTE** When a pool or spa light is turned ON manually, by the OneTouch™ control panel, or by a program, the last used color will automatically be chosen unless you press SELECT to change the color.

If you press the BACK key when in the EQUIPMENT ON/OFF menu, the light will turn on the *last* selected color. If the SELECT key or the BACK key is not pressed, and if it has been 15 seconds since the UP/DOWN keys have been pressed, then the most recently selected color will be selected again.

## 8.9 TEMP1 / TEMP2 (Pool or Spa Only)

TEMP1 is the priority temperature. It must be set higher than TEMP2, and it overrides TEMP2 whenever it is enabled.

Set temperature for TEMP1 before setting temperature for TEMP2.

### To Set Up TEMP1

**NOTE** The valid temperature setpoint range is between 34° - 104°F (1°C - 40°C). If you enter a value outside this range, an invalid entry message will appear on screen.

HOME > OTHER DEVICES ON / OFF > DEVICES > TEMP1

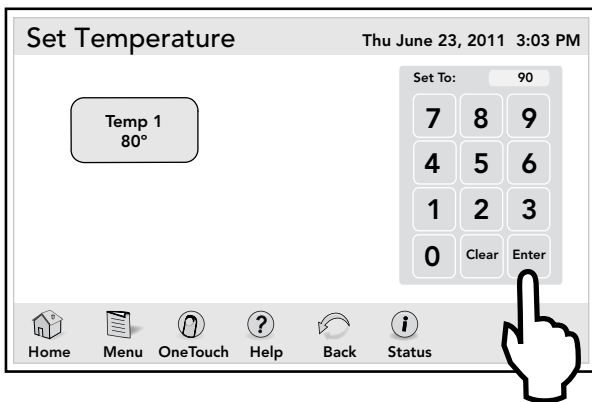
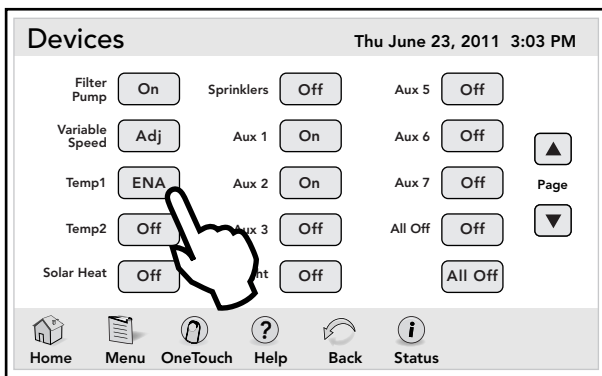

### To Set Up TEMP2 (For Pool and Spa Only System)

The TEMP2 is the maintenance (low) temperature. It must be set lower than TEMP1.

If TEMP2 is on and TEMP1 is activated, TEMP2 will turn off. When TEMP1 is turned off again, TEMP2 will reactivate.

**NOTE** The valid temperature setpoint range is between 34° - 104°F (1°C - 40°C). If you enter a value outside this range, an invalid entry message will appear on screen.

HOME > OTHER DEVICES ON / OFF > DEVICES > TEMP2

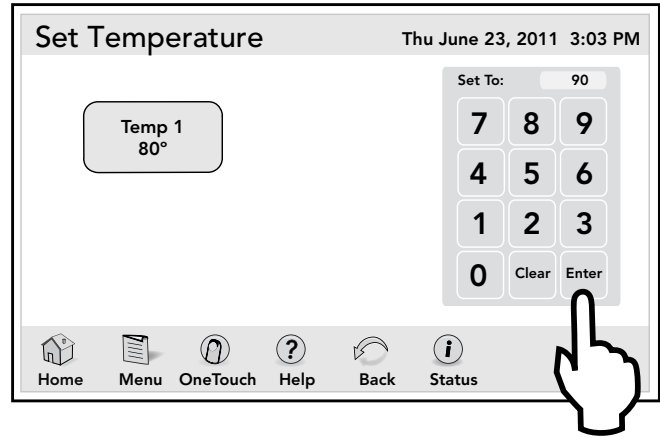

## 8.10 Two Speed Operation (\*Not Available for Export Models\*)

**NOTE** This equipment may not be part of your system. Please check with your installer.  
- Optional TWO SPEED RELAY required.

**NOTE** In order to label AUX2 as LOW SPEED, it is required to have the DIP switch S1-2 turned in the ON position.

**NOTE** All DIP switches are located on the left side of the AquaLink RS power center bezel.

- **For Pool and Spa Combination Units**

If your control is a Pool and Spa combination with a 2-speed filtration pump, the control will operate as follows: High Speed (Filter Pump) must be on before Low Speed. Filter pump button, as well as the Spa button, turns it to High Speed. Low Speed (AUX 2) button toggles back and forth from low to high.

- **For Pool or Spa Only Units**

To use High/Low Speeds, Filter Pump turns on High Speed, AUX 2 turns on Low Speed. Whatever mode last used is the OFF button. To toggle, click whichever speed is not on.

- **For Dual Equipment Units**

AquaLink RS 2/6 operates the same as the Pool/Spa Only units; i.e., Filter Pump turns on HIGH SPEED and AUX 2 turns on LOW SPEED. The mode last used is the OFF button. To toggle, click whichever speed is not on. 2-speed works only on spa filter pump.

## • Two Speed Programming for All Units

When programming HIGH and LOW Speeds to operate together, think of HIGH SPEED (Filter Pump) as total duration of filtration time, then set Low Speed (AUX 2) to operate within that duration. For example, if you want High Speed on for 2 (two) hours and Low Speed for 10 hours, program the Filter Pump (High Speed) from 8 AM to 8 PM and Low Speed from 10 AM to 8 PM.

**NOTE** It is not necessary to program both HIGH and LOW Speeds, even with a combo control system. If only LOW SPEED is programmed, HIGH SPEED will turn on at the LOW SPEED on time to prime the pump. After three (3) minutes the system will switch to LOW SPEED for the remainder of its programmed time.

## HIGH Speed Filtration Pump

HOME > OTHER DEVICES ON / OFF > FILTER PUMP/ SPA

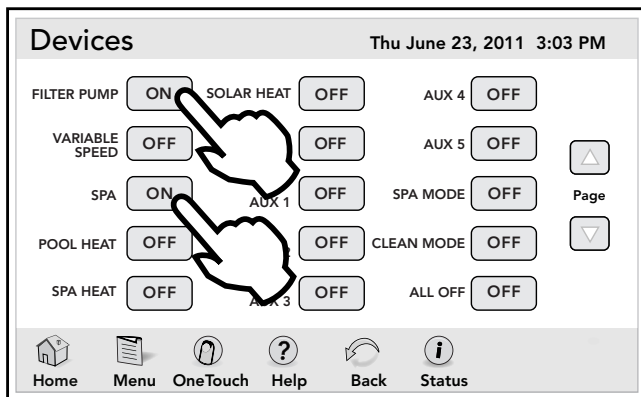

## Low Speed Filtration Pump

HOME > OTHER DEVICES ON / OFF > AUX 2

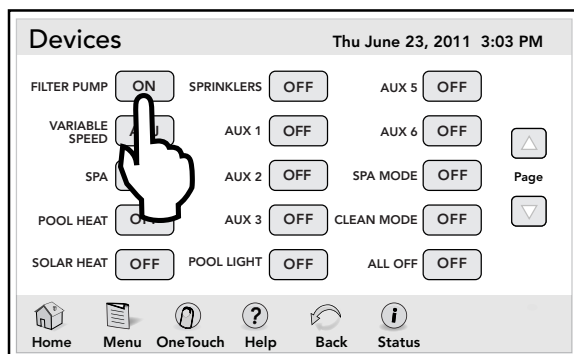

## Section 9. System Setup

### 9.1 System Setup Screen

The SYSTEM SETUP menu screen allows you to configure pool/spa equipment, devices and iAquaLink features. For the following equipment, see their corresponding section.

See Section 10, "Heat Pump Setup".

See Section 11, "Variable Speed Pump Setup".

See Section 12, "Sprinkler System Setup".

See Section 13, "ChemLink™ Setup".

**NOTE** Some equipment may not be part of your system. Please check with your installer.

MENU > SYSTEM SETUP

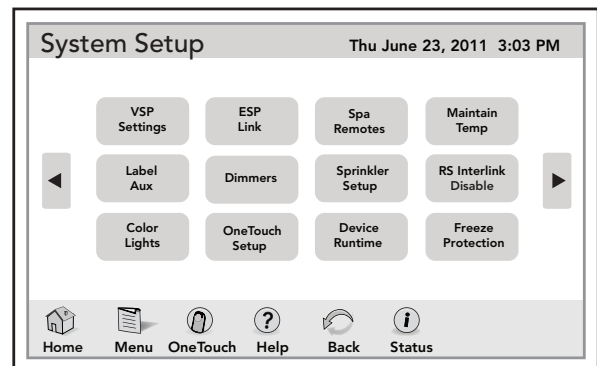

### 9.2 Label Auxiliary Functions

The LABEL AUX menu allows custom naming of auxiliary equipment. For example, you can set the display to read Pool Light JL instead of AUX 4.

MENU > SYSTEM SETUP > LABEL AUX

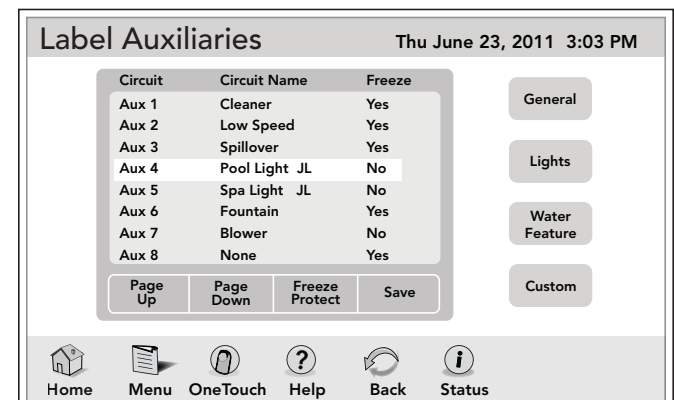

**NOTE** Please be aware that if the label NOT USED in the GENERAL LABEL menu is used on an AUX relay, the relay will not engage.

On the LABELS screen, click the label of your choice and click SELECT.

Use the CUSTOM screen to assign your own labels.

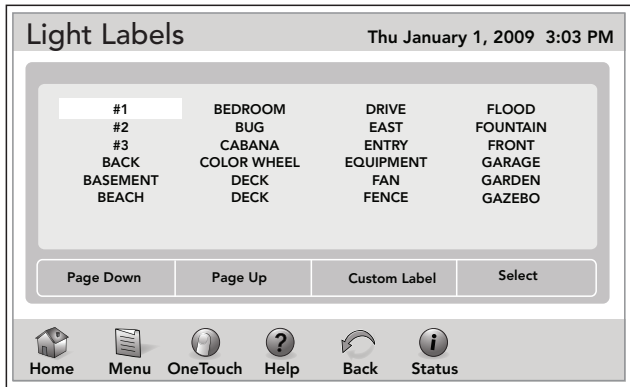
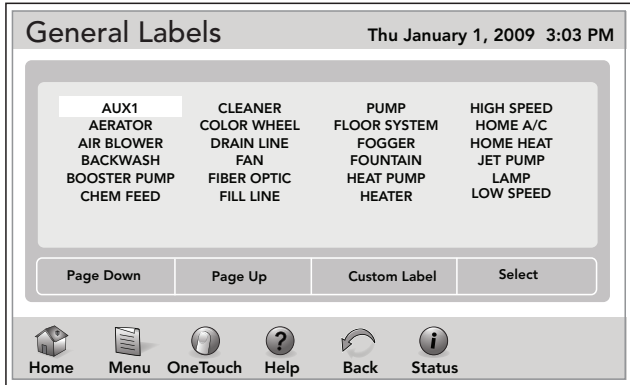

### 9.3 Color Lights

The COLOR LIGHTS screen is used to select the color light type (Jandy Colors, Jandy® LED Light, SAM®/SAL®, or Color Logic®), and to assign the color light to an available auxiliary relay.

**MENU > SYSTEM SETUP > COLOR LIGHTS**

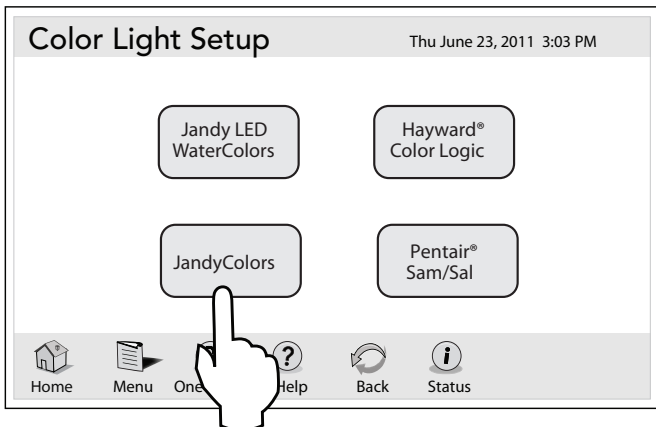

Click your choice of color light type to display the COLOR LIGHT ASSIGN AUX screen. This screen shows a list of available auxiliaries.

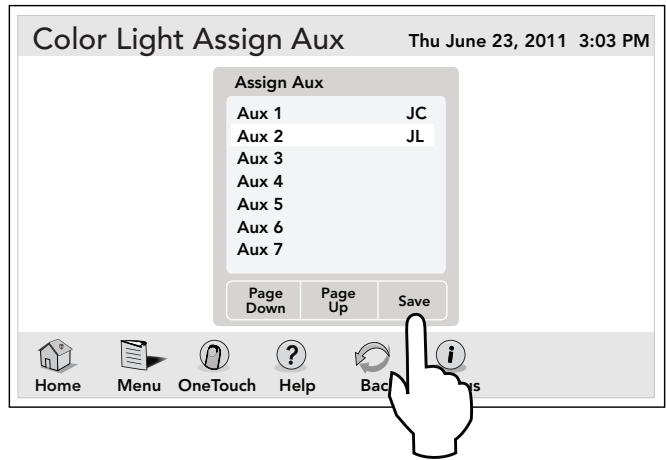

Click an auxiliary to be assigned to a color light. "JC" will appear next to the AUX if a Jandy Colors has been assigned.

"JL" will appear next to the AUX if a Jandy LED Light has been assigned. "SL" will appear next to the AUX if a SAM/SAL Light has been assigned. "CL" will appear next to the AUX if a Color Logic Light has been assigned. If the AUX is touched again, while on the same selected item, the "JC", "JL", "SL", or "CL" will disappear meaning that a color light is no longer being controlled by the auxiliary.

### 9.4 ESP Link (Seasonal Adjust)

The SEASONAL ADJUST menu is a feature that will automatically adjust filtration cycles, chlorine levels, water leveling, and sprinkler times based on the seasons.

**NOTE** The table below shows the various default seasonal adjust values and their respective adjustable range.

	DEFAULT ADJUST VALUE	ADJUSTABLE RANGE
FILTRATION	1 hour	0.5 hr, 1 hr, 1.5 hrs, 2 hrs
CLEANER	1 hour	0.5 hr, 1 hr, 1.5 hrs, 2 hrs
AQUAPURE®	15%	10%, 20%
SPRINKLERS	5 minutes	1 - 10 minutes
FILL LINE	5 minutes	not adjustable

## MENU &gt; SYSTEM SETUP &gt; ESP LINK &gt; SEASONAL ADJ

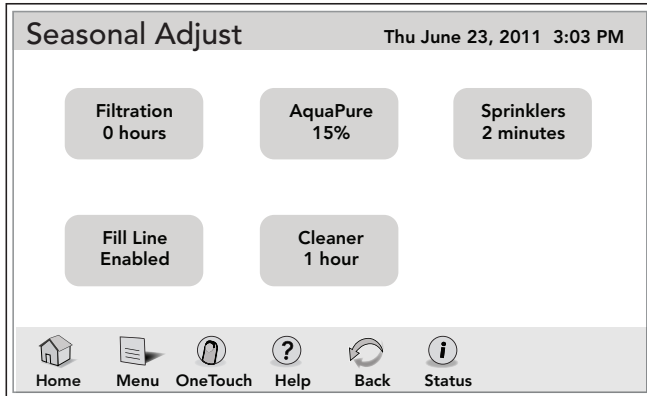

The following example shows how the feature operates when the FILTRATION ADJUSTMENT value has been set to one (1) hour.

In our example we will assume that a program for the FILTER PUMP is entered in the month of March, with the program parameter shown.

- When the month changes from April to May, one (1) hour is added to the OFF time.
- When the month changes from June to July, another one (1) hour is added to the OFF time.
- When the month changes from August to September, one (1) hour is subtracted from the OFF time.
- When the month changes from September to October, another one (1) hour is subtracted from the OFF time.
- When the month changes from November to December, another one (1) hour is subtracted from the OFF time.
- When the month changes from February to March, one (1) hour is added to the OFF time and we are back where we started.

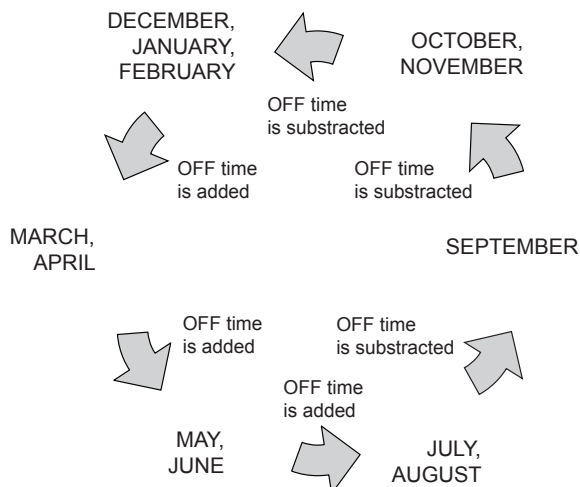

## 9.5 Set Dimmers

This menu is used to assign an auxiliary to control a dimmable light. A light dimming relay must be installed in order for your light(s) to be dimmable.

**NOTE** An optional Light Dimming Relay must be installed and only 120 VAC lighting (or suitable transformer-driven incandescent lights) can be dimmed.

## MENU &gt; SYSTEM SETUP &gt; DIMMERS &gt; AUX

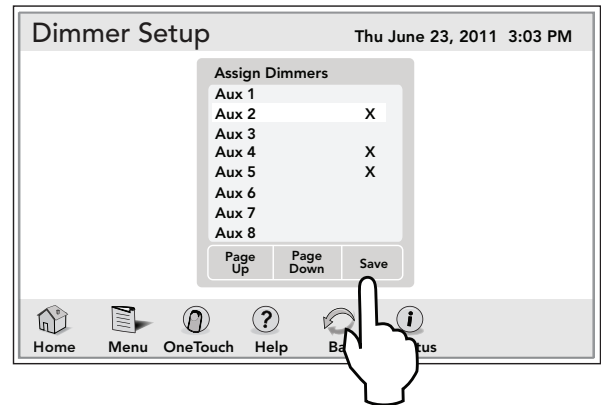

## 9.6 OneTouch™

This screen allows custom configuration of the six (6) OneTouch buttons. Each setting allows for an independent thermostat setting. OneTouch settings can also be assigned to any SpaLink® button.

## MENU &gt; SYSTEM SETUP &gt; ONETOUCH SETUP

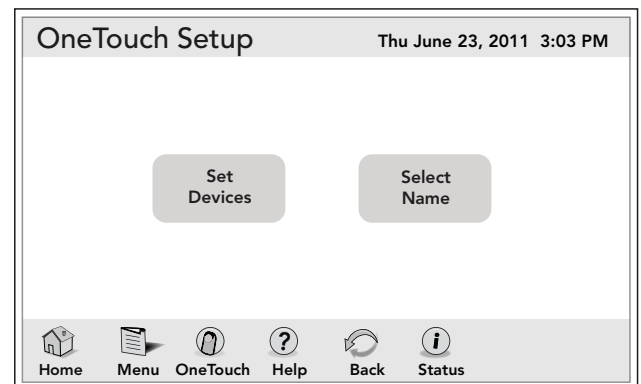

MENU > SYSTEM SETUP > ONETOUCH SETUP > SET DEVICES

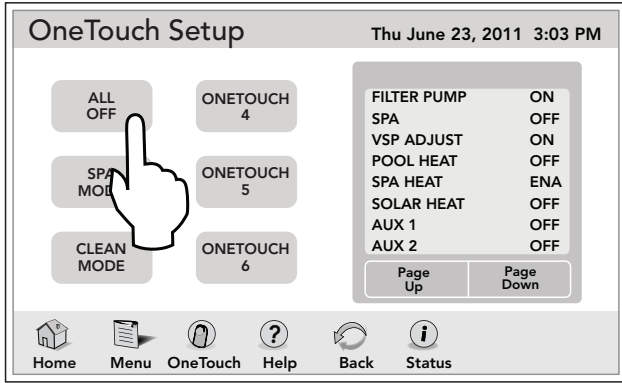

To change the settings in the device list:

- Click a device, this will be highlighted and will be either turned ON/ENA or OFF, depending on your selection.
- The POOL HEAT or SPA HEAT gives you the option to change the SET TEMP settings when turned ON. You may want to change the temperature on the SET TEMP screen or just click ENTER to proceed with the preset temperature.

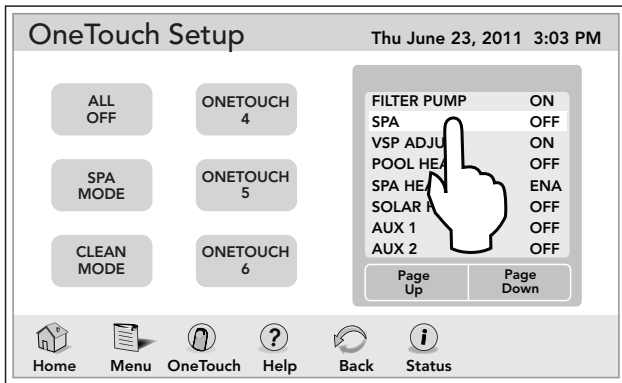

On the ONETOUCH SETUP menu, click the SELECT NAME button to display the menu shown below.

On this screen, you can assign a label to any of the six (6) ONETOUCH buttons as follows:

- Click the ONETOUCH™ button to be assigned.
- In the label list, click a label of your choice and it will be highlighted, then click the SELECT button to assign.

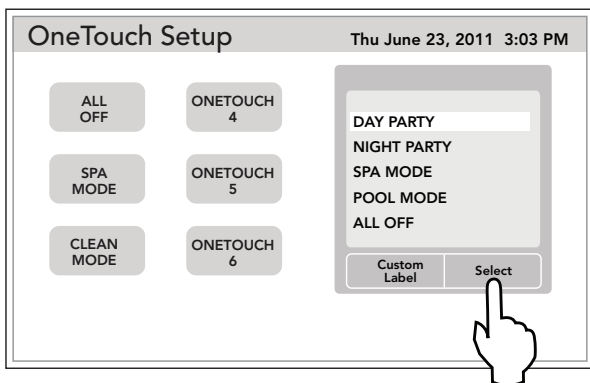

If you want to customize a label:

- Click the ONETOUCH button to be assigned.
- In the label list, click the CUSTOM LABEL button to display the CUSTOM screen.
- On the CUSTOM screen, enter your customized label and click SAVE.

**NOTE** The customized label will be assigned to ONETOUCH button but will not added to label list.

- Repeat this procedure to assign devices to the rest of ONETOUCH buttons.

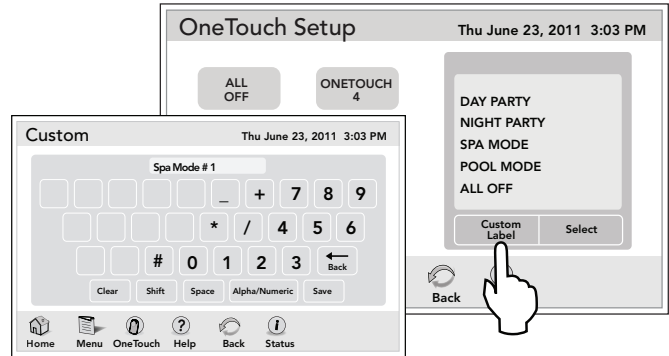

### 9.7 Spa Remotes

The SPA REMOTES SETUP is used to set up the 4-Function Spa Switch or the 8-Function SpaLink®.

MENU > SYSTEM SETUP > SPA REMOTES

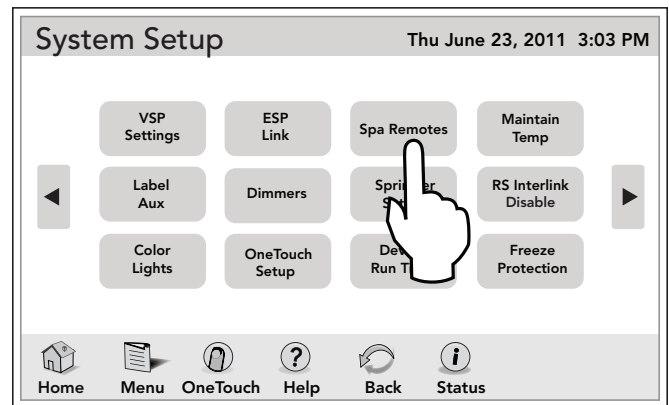

The 4 Function Spa Switches are spa, spa heat, aux1 and aux2. Write down the spa side switch button assignments to label the buttons on the switch with the label pack provided.



MENU > SYSTEM SETUP > SPA REMOTES

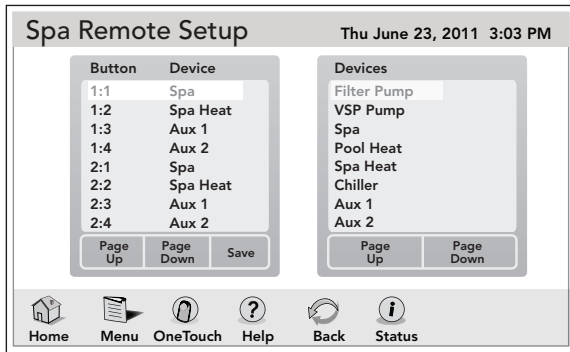
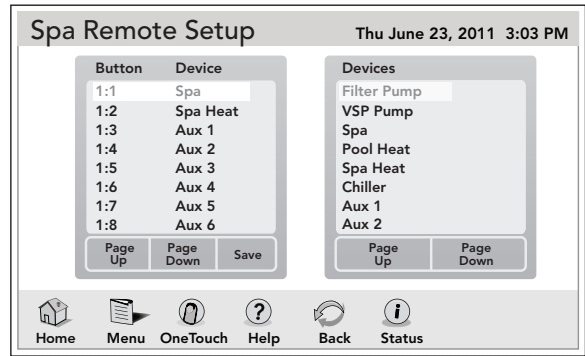
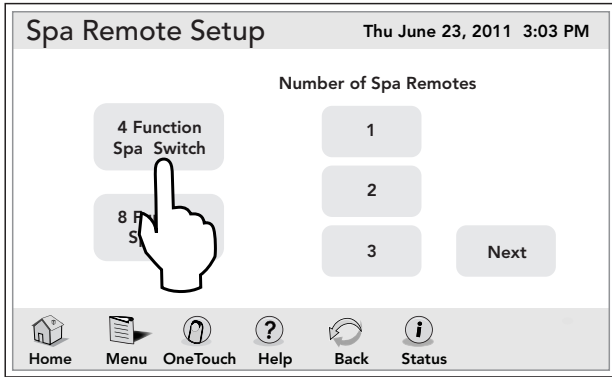

9.8 Device Runtime

The DEVICE RUNTIME menu is used to assign a runtime for a device or auxiliary.

When the device is turned on from the OTHER EQUIPMENT ON/OFF menu, it will run for the duration specified on the DEVICE RUNTIME menu.

**NOTE** A device runtime can be assigned to SPA, AUX1 - AUX31, EXTRA AUX, and macros ONETOUCH1 - ONETOUCH6 from a minimum of one (1) minute to a maximum of five (5) hours.

The default runtime of 30 minutes will be displayed.

SpaLink® Setup

The 8 Function SpaLink are spa, spa heat, aux1, aux2, aux3, aux4, aux5, and aux6.

You can now assign a OneTouch™ macro setting to any button on the SpaLink remote. Write down your SpaLink button assignments so that you can label the buttons on the switch with the label pack provided.

MENU > SYSTEM SETUP > SPA REMOTES

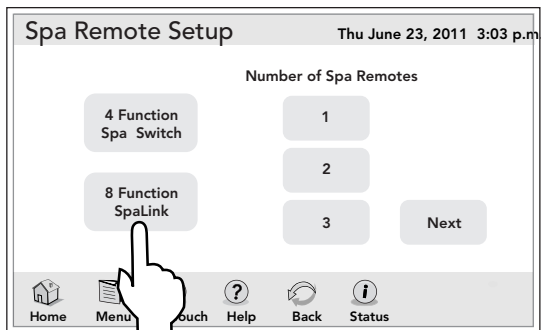

MENU > SYSTEM SETUP > DEVICE RUNTIME

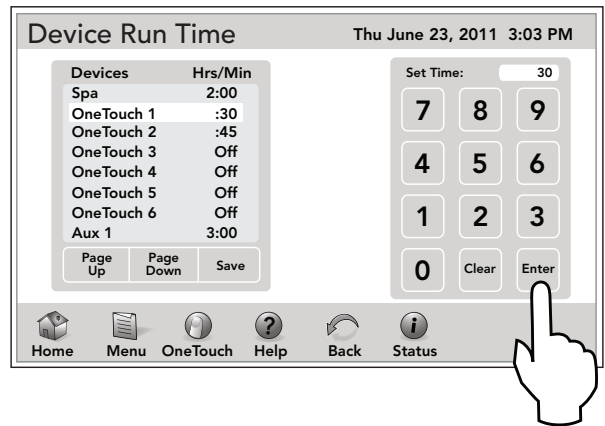

## 9.9 Maintain Temp

**NOTE** Maintain Temp is designed to operate outside (before or after) the normal filtration pump times.

The MAINTAIN TEMP menu provides the ability to specify how often the filter pump is turned on to sample the water temperature. This feature allows for the sampling interval to be set to one (1), two (2), or four (4) hours. The default value will be two (2) hours.

Note that the MAINTAIN TEMP will run the pump for the chosen body of water to keep the water at the desired temperature, if this function is ON and the heater/chiller (if installed) is enabled. The system will automatically turn on the pump every couple of hours for just enough time to test the water temperature.

If the temperature meets the set point, the pump will return to off. If the temperature needs to be adjusted, the pump will stay on and the heater/chiller will operate long enough to bring the water to the set temperature.

**MENU > SYSTEM SETUP > MAINTAIN TEMP**

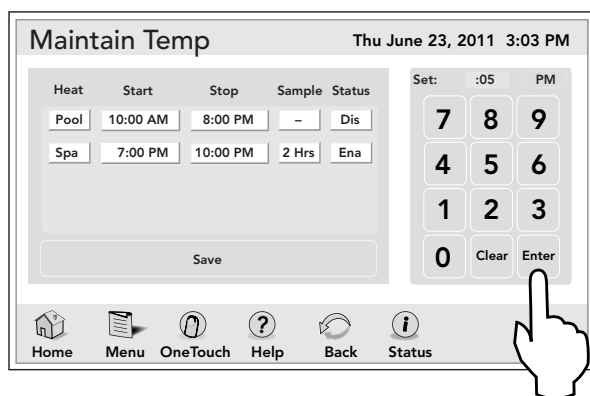

Schedule the MAINTAIN TEMP as follows:

- On the MAINTAIN TEMP screen, click the START time of the selected equipment, and use the numeric keypad to enter the new time.
- To set the stop time, click the STOP time of the selected equipment and use the numeric keypad to enter the new time.
- To set the sample time, click the SAMPLE time of the selected equipment and use the numeric pad to enter the new sampling interval.
- Click the ON/OFF button to enable or disable the MAINTAIN TEMP schedule of the selected equipment.

## 9.10 RS InterLink

**NOTE** This equipment may not be part of your system. Please check with your installer.

The RS InterLink menu allows a single controller to access two (2) main power centers on the AquaLink RS system.

For ease of operation, it is suggested that each power center be given a custom product name that would allow a user to identify to which power center the controller is connected. During operation, this name will appear on the iAquaLink Date/Time screen.

**NOTE** The RS InterLink feature must be enabled before it may be accessed on the OTHER EQUIPMENT ON/OFF screen.

**MENU > SYSTEM SETUP > RS INTERLINK**

**NOTE** You can create a custom label for the power center. The factory default name for the power center(s) is labeled as "Power Center B". When labeling remember you are creating a label for the power center to which you will be switching.

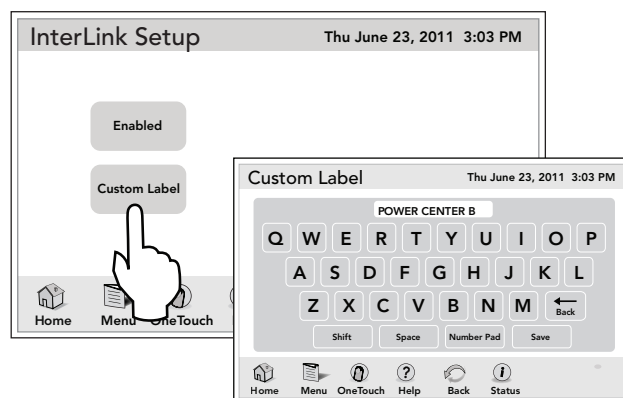

## 9.11 Freeze Protection

**NOTE** By factory default the filter pump circuit is freeze protected and cannot be removed from the freeze protection.

Use Freeze Protection menu to assign freeze protection to your pool and spa equipment. When a piece of equipment is assigned to freeze protection, it will turn on when the iAquaLink detects freezing conditions. The main filter pump is freeze-protected as a default.

Activation temperature can be adjusted between 34°F (1°C) and 42°F. Default freeze protection activation temperature is 38° F (3°C) and will deactivate within two degrees..

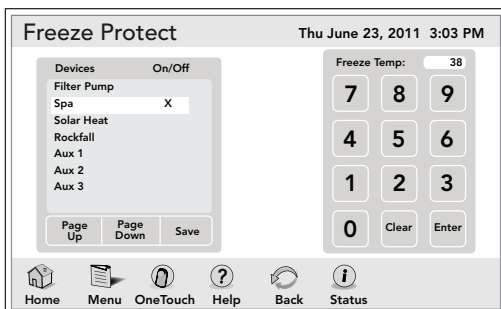
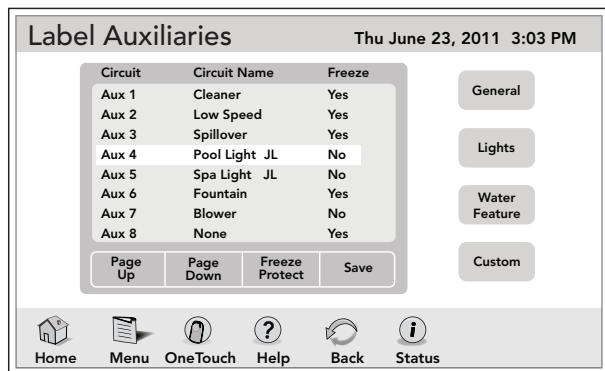
**MENU > SYSTEM SETUP > FREEZE PROTECT****MENU > SYSTEM SETUP > LABEL AUX**

Select any piece of equipment in the DEVICE list and change the temperature using the numeric keypad. Once the temperature is set, click the ENTER button to move to the next screen to assign freeze protection to a selected piece of equipment.

**NOTE** The filter pump is always assigned to freeze protection.

**IMPORTANT****Information on Freeze Protection**

Freeze protection is intended to protect equipment and plumbing for short periods of freezing only. It does this by activating the filtration pump and circulating the water to prevent freeze inside equipment or plumbing. Freeze protection does **not** guarantee that equipment will not be damaged by extended periods of freezing temperatures or power outages. In these conditions, the pool and spa should be shut down completely (e.g. drained of water and closed for the winter) until warmer weather exists.

**9.12 Assign JVA's**

The ASSIGN JVA's menu allows Jandy® Valve Actuators (JVAs) to be assigned to any auxiliary button. This means that whenever you press that auxiliary button, a valve turns. On pool/spa combination models, there are commonly two (2) extra JVAs that can be assigned to auxiliary buttons: the Cleaner JVA and the Solar JVA.

On pool/spa only models, there are four (4) JVAs that can be assigned to auxiliary buttons. The installer must set these JVAs for this feature to operate correctly. Assigning JVAs lets the owner control certain features like diverting water to a waterfall or bank of spa jets.

Multiple JVAs can be assigned to one (1) auxiliary button without extra hardware.

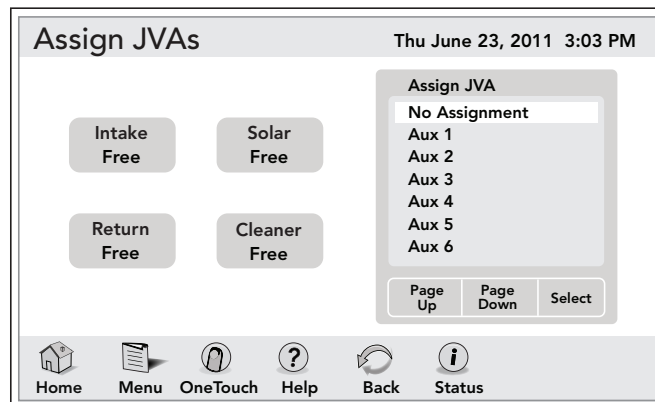
**MENU/HELP > SYSTEM SETUP > ASSIGN JVAs**

Click the JVA button you wish to assign and Click SAVE

**NOTE** If a solar sensor is installed, the solar JVA will automatically be assigned and will be marked as USED.

**9.13 Dusk Setup**

The DUSK SETUP screen is used to set a device to automatically turn on after sunset.

On the DUSK SETUP screen, you can set the duration, a time adjust value if you live between major city selections or in a heavily shaded area, and set specific devices.

**NOTE** Time and Date must be correct.

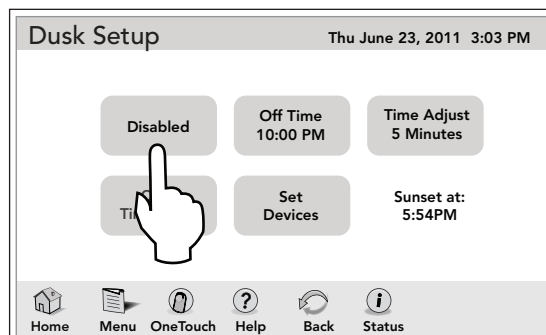
**MENU > SYSTEM SETUP > DUSK SETUP**

### Dusk Setup Off Time

On the DUSK SETUP screen, click the OFF TIME button and enter the desired time.



### MENU > SYSTEM SETUP > ALL OFF TIME

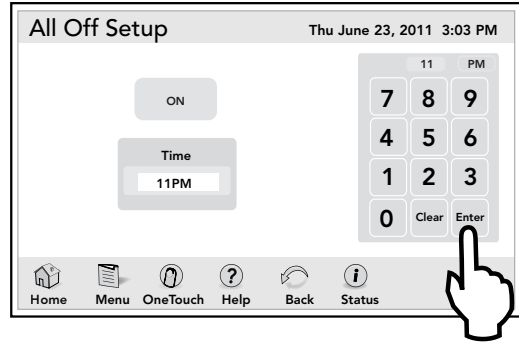

**NOTE** With this feature you can only set the hour value of the time - no minutes. The minutes will always be zero (0).

### City/Time Zone

#### MENU > SYSTEM SETUP > DUSK SETUP > CITY/TIME ZONE



### Assign Devices

#### MENU > SYSTEM SETUP > DUSK SETUP > SET DEVICES

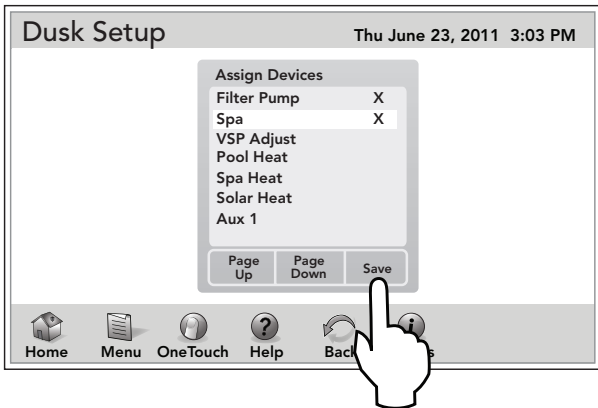

### 9.14 All Off Time

The ALL OFF TIME is used to direct the system to turn everything off at a specific time everyday.

### 9.15 Pump Lockout

The PUMP LOCKOUT menu allows you to enable (pump off) or disable (pump stays on) when valves are rotating from pool to spa.

#### MENU > SYSTEM SETUP > PUMP LOCKOUT

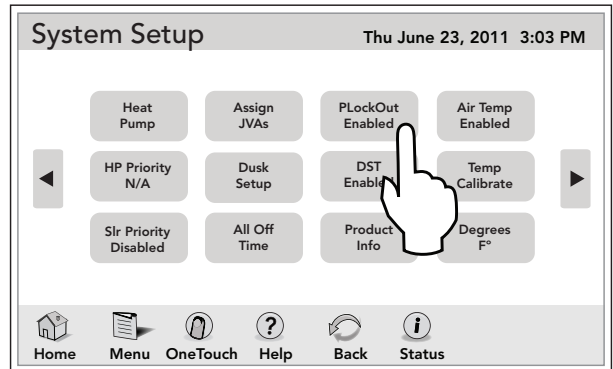

### 9.16 Daylight Savings Time (DST)

**NOTE** The factory default is ENABLED for the DST switching.

The DAYLIGHT SAVINGS menu enables the automatic adjustment for DST.

## MENU &gt; SYSTEM SETUP &gt; DST

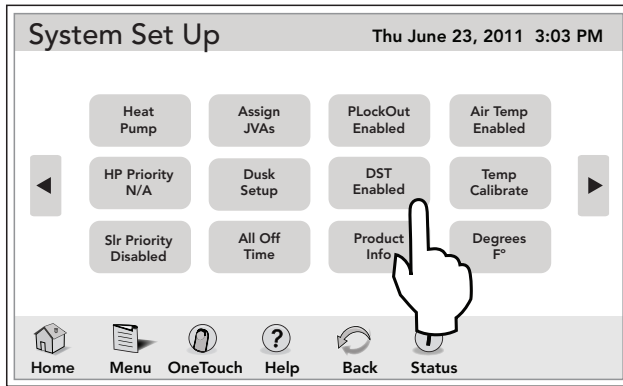

## 9.17 Product Information

The PRODUCT INFO screen is used to enter a custom product name, local service company name and telephone number.

## MENU &gt; SYSTEM SETUP &gt; PRODUCT INFO

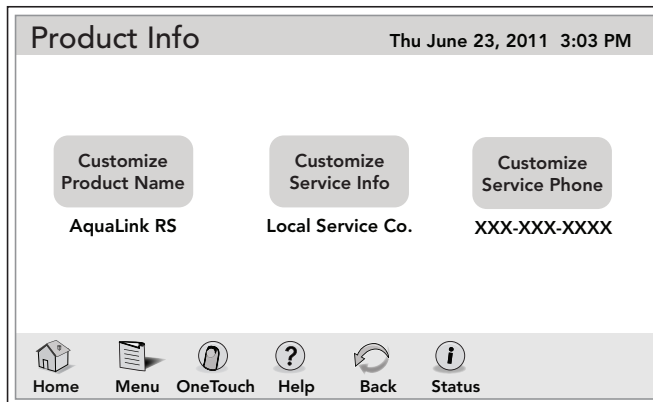

## Customize Product and Service Info

## SYSTEM SETUP &gt; PRODUCT INFO &gt; CUSTOM LABEL

See Section 4.9, "Custom Label".

## Customize Service Phone

## SYSTEM SETUP &gt; PRODUCT INFO

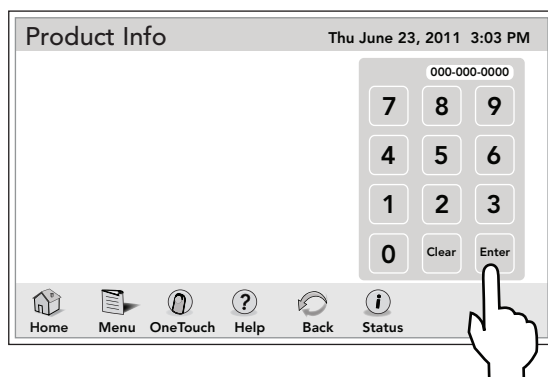

## 9.18 Air Temperature

Use the Air Temperature menu to turn the air temperature display on or off.

## MENU &gt; SYSTEM SETUP &gt; AIR TEMP

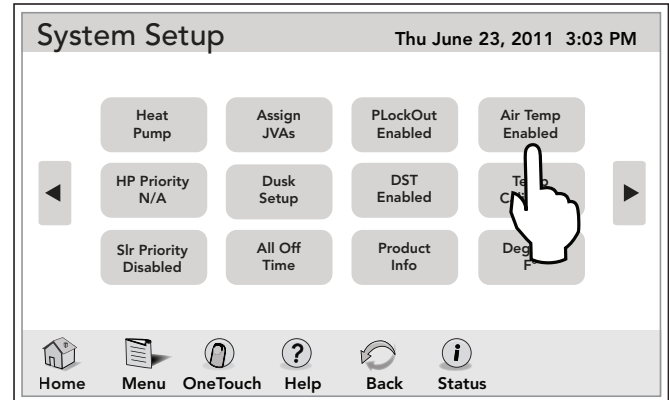

## 9.19 Temperature Calibrate

This menu allows adjustment of the temperature that is displayed on the iAquaLink. The temperature can only be adjusted up four (4) degrees Fahrenheit or down four (4) degrees Fahrenheit.

## MENU &gt; SYSTEM SETUP &gt; TEMP CALIBRATE

**NOTE** If the temperature is off by more than four (4) degrees, contact your local service representative.

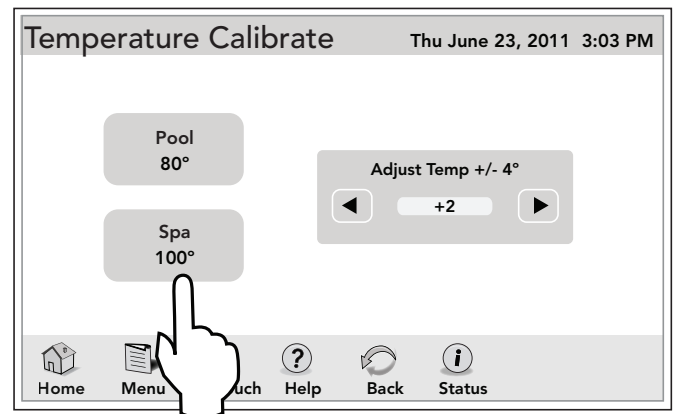

## 9.20 Degrees C/F

The Degrees C/F menu allows you to change the iAquaLink temperature display from Fahrenheit to Celsius or vice versa. When changing from Fahrenheit to Celsius, you will have to re-enter the temperature settings.

MENU > SYSTEM SETUP > DEGREES

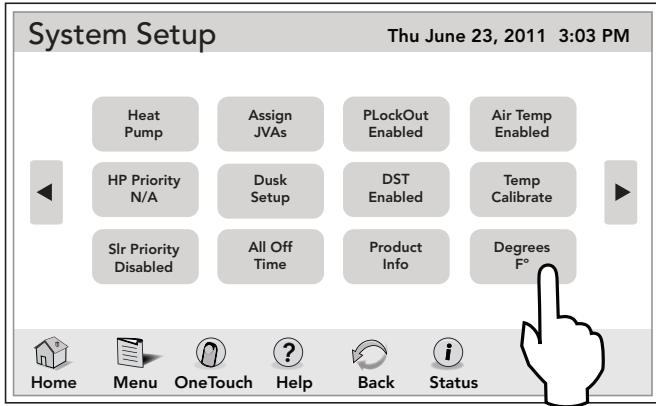

9.21 In-Floor Cleaning

This menu is used to enable or disable the automatic in floor cleaning feature. When enabled, the AquaLink RS rotates the in-floor Jandy® valve actuators (JVAs) every 20 minutes. In-floor cleaning only works when the filter pump is on.

**NOTE** If activated this circuit will utilize the solar JVA relay socket and circuit to control the in-floor valve unless a solar sensor is installed, then the circuit reverts to AUX 3.

MENU > SYSTEM SETUP > IN-FLOOR

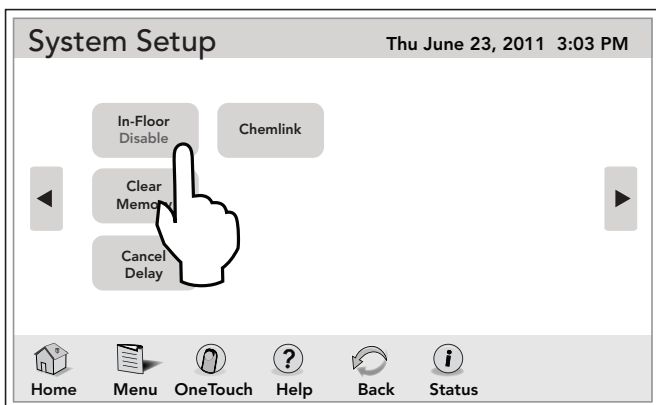

9.22 Clear Memory

The CLEAR MEMORY menu will clear all stored values from the AquaLink RS memory. All settings will be reset to their default settings.

Stored values include auxiliary labels, all programs, freeze protection settings, remote settings, and thermostat settings. The time and date will not be cleared.

MENU > SYSTEM SETUP > CLEAR MEMORY

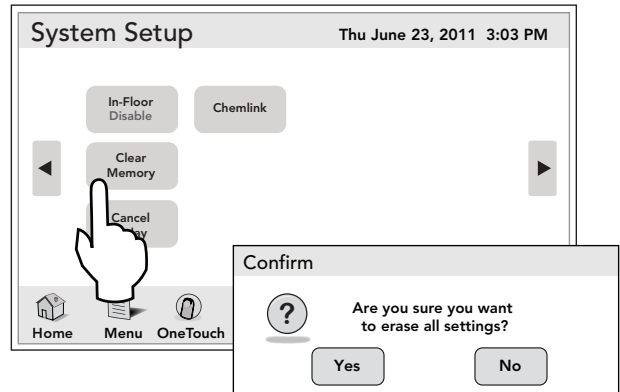

9.23 Cancel Delay

**NOTE** This feature is for use by service personnel only.

MENU > SYSTEM SETUP > CANCEL DELAY

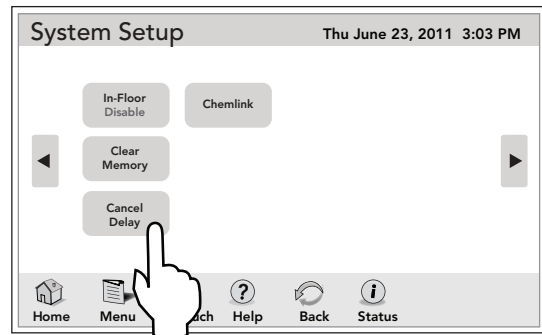

**NOTE** CANCEL DELAY should only be used by authorized service personnel. It should not be used during normal system operation.

## Section 10. Heat Pump Setup

### 10.1 Solar Priority/Heat Pump Priority

The SOLAR PRIORITY/HEAT PUMP menu allows the system to use SOLAR HEAT/HEAT PUMP primarily. If Solar Heat is no longer available, the system will automatically switch to the alternate heat source.

**MENU > SYSTEM SETUP > SOLAR PRIORITY**

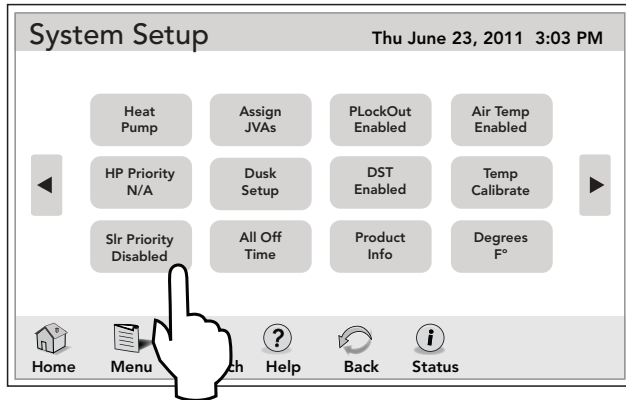

When solar and heater are enabled the solar will heat the water until either the thermostat setting has been reached or solar heat is no longer available. If the solar panel is not hot enough, solar heat will shut off and the other heat source (usually gas heater) will take over to bring the water up to the thermostat setting. This menu is used to ENABLE or DISABLE the solar priority.

**NOTE** Depending on the position of DIP switch S2-1 and the presence of a solar or heat pump sensor, SOLAR PRIORITY or HEAT PUMP PRIORITY may be displayed on the SYSTEM SETUP menu. It is not possible to have both SOLAR PRIORITY and HEAT PUMP PRIORITY displayed on SYSTEM SETUP MENU at the same time. It is one or the other.

### 10.2 Heat Pump (Heat Mode)

**NOTE** This equipment may not be part of your system. Please check with your installer.

The HEAT MODE selection controls the heat pump operation.

#### Heat Pumps are Controlled by Extra Aux/Solar Boost Relay

In order to use the heat pump, the filter pump must be turned on and the heat pump must be in HEAT MODE, and the switch on the heat pump on the equipment pad must also be set to HEAT MODE.

**NOTE** HEAT PUMP takes the place of EXTRAUX or SOLAR HEAT. It is not possible to have any two (2) of these on the EQUIPMENT ON/OFF menu at the same time.  
To operate the HEAT PUMP in this type of configuration, set the DIP switch S2-1 to ON and connect the HEAT PUMP temperature sensor to the SOLAR SENSOR input.

#### Heat Pumps Controlled by the RS485 Interface

In order to use the heat pump, the filter pump must be turned on and the heat pump must be in the HEAT MODE.

**NOTE** In this configuration, it is possible to have the HEAT PUMP and SOLAR HEAT on the DEVICES ON/OFF at the same time.

**NOTE** If both HEAT PUMP and SOLAR HEAT are to be controlled by the system then set the DIP switch S2-1 to OFF and connect the SOLAR SENSOR to the SOLAR SENSOR input.

**NOTE** If SOLAR HEAT is not to be controlled by the system then set the DIP switch S2-1 to ON and connect the HEAT PUMP temperature sensor to the SOLAR SENSOR input.

**MENU > SYSTEM SETUP > HEAT PUMP**

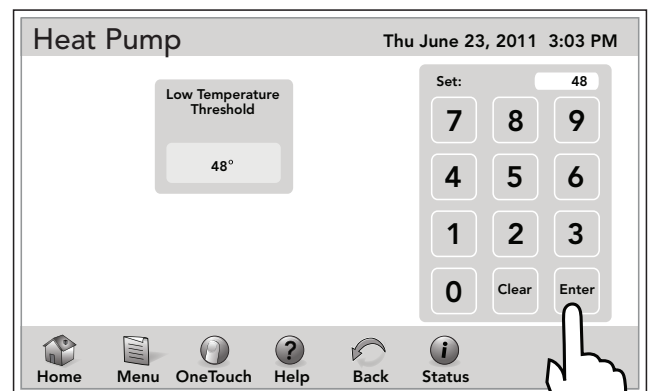
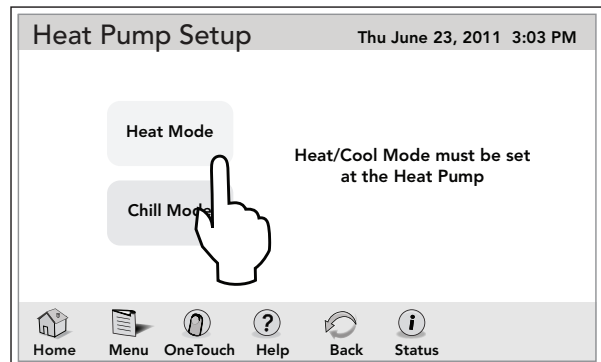

### 10.3 Heat Pump (Chiller Mode)

**NOTE** This equipment may not be part of your system. Please check with your installer.

The CHILLER selection controls the chilling operation of the heat pump.

#### Heat Pumps (Chiller) Controlled by the Extra Aux/Solar Boost Relay

In order to use the chiller mode of the heat pump, the filter pump must be turned on and the heat pump must be in CHILLER MODE, and the switch on the heat pump on the equipment pad must also be set to CHILLER MODE.

**NOTE** CHILLER takes the place of EXTRA AUX or SOLAR HEAT. It is not possible to have any two (2) of these on the DEVICES ON/OFF menu at the same time. To operate the HEAT PUMP in this type of configuration, set the DIP switch S2-1 to ON and connect the HEAT PUMP temperature sensor to the SOLAR SENSOR input.

#### IMPORTANT Information on Chiller

You must manually change the setting at your heat pump from Heat to Chiller.

#### Heat Pumps (Chiller) Controlled by the RS485 Interface

The CHILLER selection controls the chilling operation of the heat pump. In order to use the chiller mode of the heat pump, the filter pump must be turned on and the heat pump must be enabled. The heat pump will switch to chill automatically when the water temperature rises above the chiller temperature set point.

**NOTE** In this configuration, it is possible to have HEAT PUMP/CHILLER and SOLAR HEAT on the EQUIPMENT ON/OFF at the same time.

**NOTE** If both HEAT PUMP/CHILLER and SOLAR HEAT are to be controlled by the system then set the DIP switch S2-1 to OFF and connect the SOLAR SENSOR to the SOLAR SENSOR input.

**NOTE** If SOLAR HEAT is not to be controlled by the system then set the DIP switch S2-1 to ON and connect the HEAT PUMP temperature sensor to the SOLAR SENSOR input.

**NOTE** If the water temperature is greater than the chiller temperature setpoint then CHILLER is displayed on the EQUIPMENT ON/OFF screen. Otherwise HEAT PUMP is displayed.

### CHILL Mode

#### MENU > SYSTEM SETUP > HEAT PUMP

**NOTE** The system will force the Chiller set point to always be at least five (5) degrees Fahrenheit higher than the heater set point.

**NOTE** If the end time of an enabled program overlaps the start time of a second enabled program, the second program will be delayed until the first program completes, and the master valve will remain activated between programs.

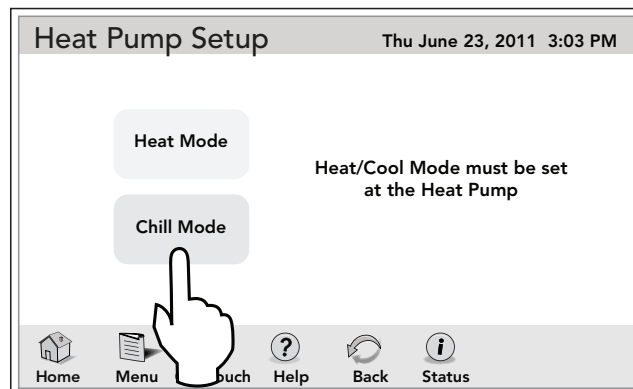

## Section 11. Variable Speed Pump Setup

**NOTE** This equipment may not be part of your system. Please check with your installer.

A VARIABLE SPEED PUMP can be programmed to run at any one (1) of its eight (8) speeds.

Power to the variable speed pump is switched on/off by a relay. You will need to set a program time for the relay, and for any speeds that you wish to run during the pump's on cycle.

In the example shown below the variable speed pump is used for pool filtration, so it will be powered from the FILTER PUMP relay. Therefore, to program the variable speed pump you must first set a program time for the FILTER PUMP relay, then you need to program the desired pump speeds to turn on/off during the FILTER PUMP cycle.

If you do not program any speeds to run during the filtration cycle, then by default the variable speed pump will run at the POOL speed setting during its filtration cycle.



Example:

1. The total length of the filtration cycle is to be from 8am to 5pm. So program the FILTER PUMP to turn on at 8am and to turn off at 5pm.
2. To run the variable speed pump at the SPEED3 setting from 8am to 1pm, select VSP SPD1 PGM, then select SPEED3, program it to turn on at 8am and off at 1pm.
3. To run the variable speed pump at the SPEED4 setting from 1pm to 5pm, select VSP SPD1 PGM, then select SPEED4, program it to turn on at 1pm and off at 5pm.

	ON	OFF	DESCRIPTION
FILTER PUMP	8AM	5PM	Total duration of filtration cycle
SPEED3	8AM	1PM	Pump runs at the SPEED3 setting
SPEED4	1PM	5PM	Pump runs at the SPEED4 setting

The VAR SPEED PUMP menu is used to select the variable speed pump type (Jandy® ePump™, Pentair® IntelliFlo® VF, Pentair IntelliFlo VS, or Pentair IntelliPro® VS) and to select the various pump settings. To interface the IntelliPro VS, select IntelliFlo VS.

## 11.1 To Select the Pump/Model

MENU > SYSTEM SETUP > VSP SETUP > PUMP/MODEL

Pump/Model	Application	Min	Max	Priming Speed	Priming Duration
1 Jandy ePump	Filtration	400 RPM	3450 RPM	2500 RPM	:05
2 IntelliFlo VS	Aux Pump	900 RPM	3000 RPM	2500 RPM	:05
3 IntelliFlo VF	Not Installed	N/A	N/A	N/A	N/A

Save Restore Spd Defaults Speed Setup

In the PUMP MODEL list, select the variable speed pump type and click the SELECT button to save it.

Select VSP Thu June 23, 2011 3:03 PM

Pump Model

- ePump
- IntelliFlo VS
- IntelliFlo VF

Select

Home Menu OneTouch Help Back Status

## 11.2 To Set Up the Pump Application

The iAquaLink can control up to four (4) variable speed pumps. In the PUMP SETUP menu the user can select each pump (1-4) and configure how the pump(s) are to be used. For example, if the pump is to be used for pool/spa filtration, then you would select FILTRATION as the pump application. If the pump is to be used for a water feature, then you would select AUX. PUMP as the pump application. The default setting is NOT INSTALLED.

COMBO	POOL SPA ONLY	DUAL EQUIPMENT
FILTRATION	FILTRATION	POOL PUMP
AUX. PUMP	AUX. PUMP	SPA PUMP
NOT INSTALLED	NOT INSTALLED	AUX. PUMP
		NOT INSTALLED

If the system is not going to control a variable speed pump, then leave the application set to NOT INSTALLED. If the system is going to control a variable speed pump, then you would set the application accordingly.

In the example below we are telling the system that it will be controlling one (1) variable speed pump.

MENU > SYSTEM SETUP > VSP SETUP > APPLICATION

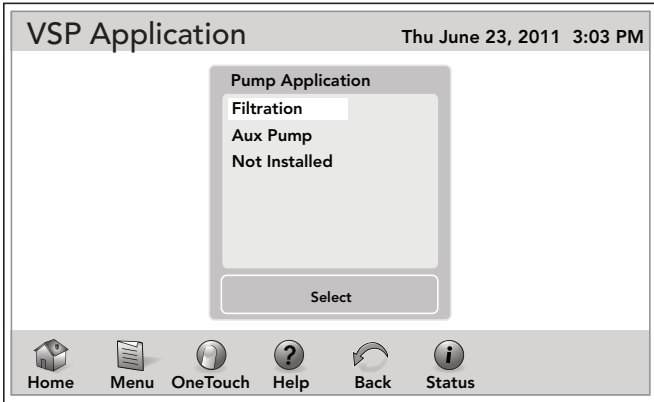

11.3 To Set Up MIN/MAX Parameters

This menu allows the user to set a global minimum and maximum speed or flow for the indicated pump. The SCALE setting is fixed to RPM for the Jandy® ePump™ and the Pentair® IntelliFlo® VF. The SCALE setting is fixed to GPM for the Pentair IntelliFlo VF.

MENU > SYSTEM SETUP > VSP SETUP > MIN/MAX

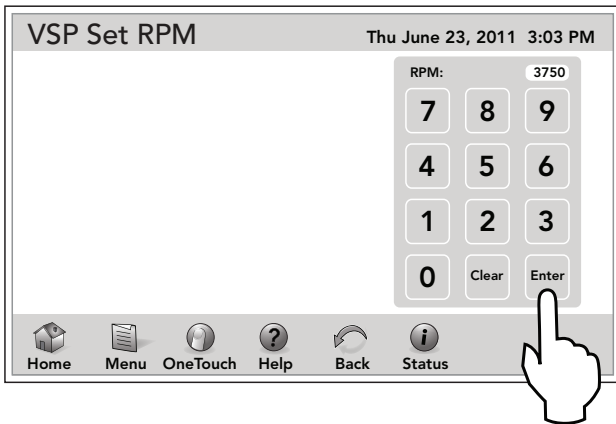

11.4 To Set Up the Priming Speed

MENU > SYSTEM SETUP > VSP SETUP > PRIMING SPEED

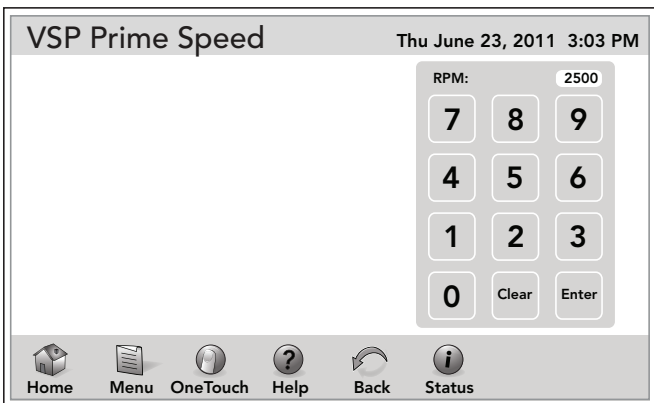

11.5 To Set Up the Priming Duration Time

MENU > SYSTEM SETUP > VSP SETUP > PRIMING DURATION

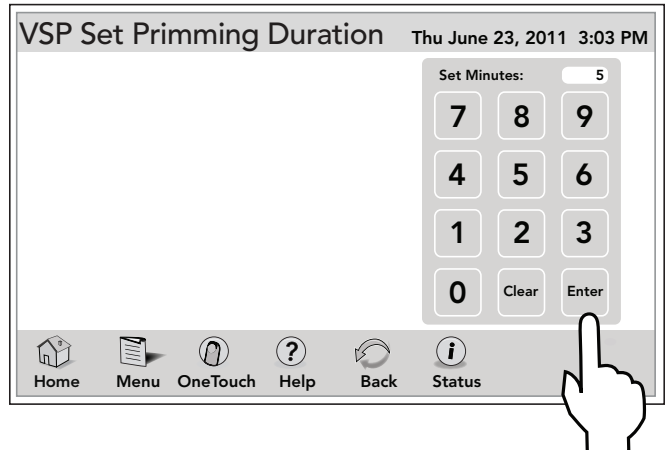

11.6 To Assign a Pump Speed to an AUX

MENU > SYSTEM SETUP > VSP SETUP

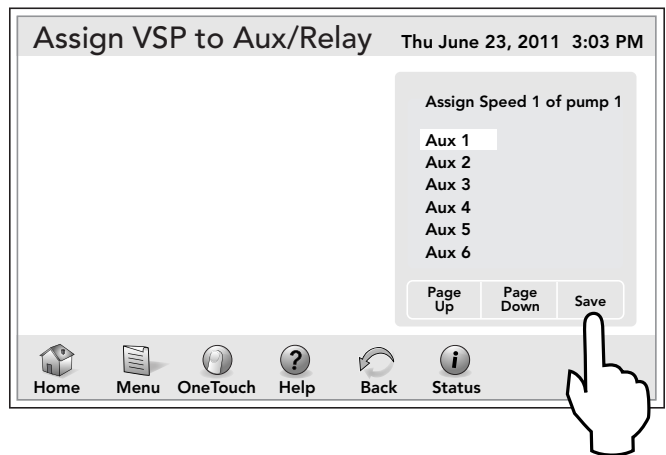

11.7 To Set Up Pump Speed

There are eight (8) default speed presets for each variable speed pump.

## MENU &gt; SYSTEM SETUP &gt; VSP SETUP &gt; SPEED SETUP

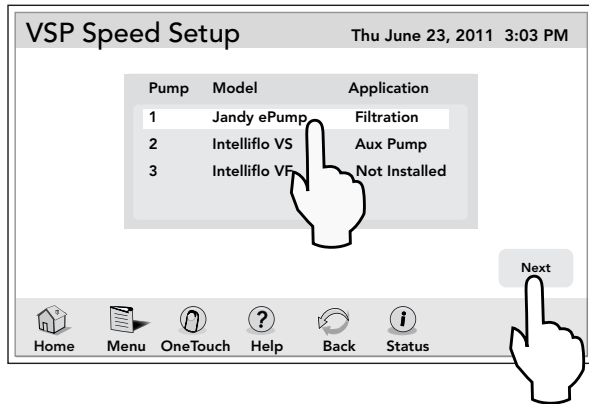

Select the pump/model and click the NEXT button to display the eight (8) speed VSP SETUP screen.

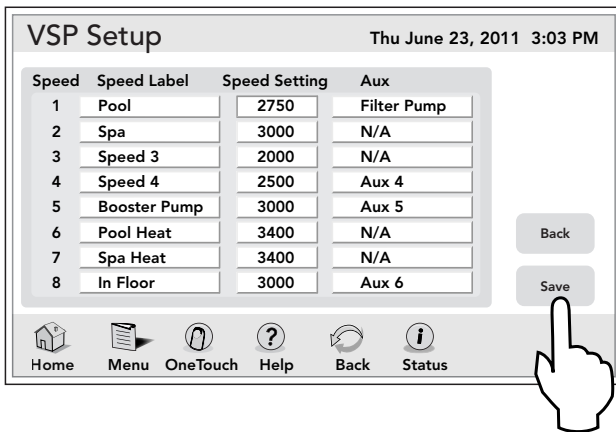

## 11.8 To Re-label the Speed Preset

Each of the eight (8) speed presets has a label and each of those labels can be changed from the default value.

MENU > SYSTEM SETUP > VSP SETUP > SPEED SETUP > NEXT > SELECT LABEL > SAVE

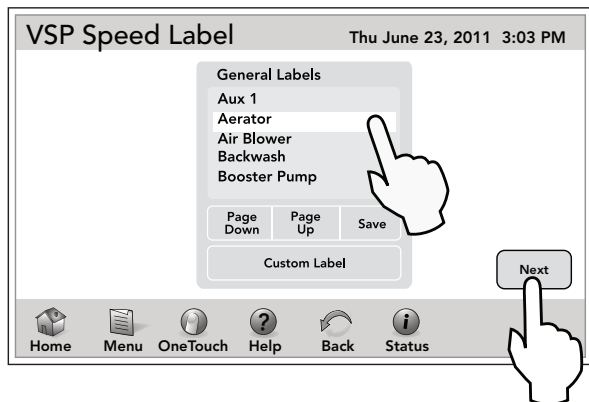

## 11.9 Default Preset Speed Labels (RS Combo and RS only)

When a pump is configured for FILTRATION, the speed presets will be labeled as shown in the table below. The presets can be relabeled.

DEFAULT Labels when Pump is configured for FILTRATION			
PRESET #	POOL/SPA COMBO	POOL/SPA ONLY	SPEED (RPM)
1	POOL	POOL	1725
2	SPA	SPEED2	2750
3	SPEED3 or CLEANER (if DIP S1-1 is on)	SPEED3 or CLEANER (if DIP S1-1 is on)	2750
4	SPEED4 or SPILLOVER (if DIP S1-3 is on)	SPEED4	2750
5	POOL HEAT	TEMP1	2250
6	SPA HEAT	TEMP2	2250
7	SOLAR HEAT (if DIP S1-7 is off) or HEATPUMP (if DIP S1-7 is on) or SPEED7	SOLAR HEAT (if DIP S1-7 is on) or HEATPUMP (if DIP S1-7 is on) or SPEED7	2750
8	INFLOOR	INFLOOR	2750

### Preset 1:

The default label for preset #1 is POOL. This label is tied to the pool filtration mode. Anytime the pool pump is supposed to turn on, this preset is selected.

### Preset 2:

On combo systems the default label for preset #2 is SPA. This label is tied to the spa filtration mode, anytime the spa pump is supposed to turn on, this preset is selected.

### Preset 3:

On combo systems, if DIP switch S1-1 is ON, the default label for this preset is CLEANER. Anytime the cleaner mode is turned on the pump will run at the preset settings.

On a combo system, if DIP switch S1-1 is OFF, then the default label for this preset is SPEED3.

### Preset 4:

If DIP switch S1-3 is ON, the default label for this preset is SPILLOVER. Anytime the spillover mode is turned on, the pump will run at the preset settings.

If DIP switch S1-3 is OFF, then the default label for this preset is SPEED4.

### Preset 5:

On pool/spa combo systems the default label is POOL HEAT. When the pool heater is enabled the pump will run at this speed.

On pool/spa only systems the default label is TEMP1. When the pump is running and the heater set point TEMP1 is enabled, then the pump will run at this preset.

### Preset 6:

On pool/spa combo systems the default label is SPA HEAT. When the system is in the SPA mode and the SPA HEATER is enabled then the pump will run at this speed.

On pool/spa only systems the default label is TEMP2. When the pump is running and the heater set point TEMP2 is enabled, then the pump will run at this preset.

### Preset 7:

If the system is in the SOLAR HEAT mode or the HEAT PUMP mode then the pump will run at this preset speed. If the system is not configured for solar heat or a heat pump then the default label will be SPEED7.

### Preset 8:

When the In-Floor clean mode is enabled and the pump is running, it will be running at this preset speed.

## Default Preset Speed Labels (Dual Equipment)

When a pump is configured to be either a POOL PUMP or a SPA PUMP, the speed presets will be labeled as shown in the table below. The presets can be relabeled but the operation of the speeds may be changed by doing so.

DEFAULT Labels and Speeds when Pumps are configured as POOL PUMP and SPA PUMP (Dual Equipment Systems)			
PRESET #	POOL PUMP	SPA PUMP	SPEED
1	POOL	SPEED1	1725
2	SPEED2	SPA	2750
3	SPEED3 or CLEANER (if DIP S1-1 is on)	SPEED3	2750
4	SPEED4	SPEED4	2750
5	POOL HEAT	SPEED5	2250
6	SPA HEAT	SPA HEAT	2250
7	SOLAR HEAT (if DIP S1-7 is off) or HEATPUMP (if DIP S2-7 is on) or SPEED7	SPEED7	2750
8	INFLOOR	SPEED8	2750

### Preset 1:

On a dual equipment system when a pump is configured as a POOL PUMP, the default label for preset #1 is POOL. This label is tied to the pool filtration mode. Anytime the pool pump is supposed to turn on, this preset is selected.

On a dual equipment system when a pump is configured as a SPA PUMP, the default label for preset #1 is SPEED1.

### Preset 2:

On a dual equipment system when a pump is configured as a SPA PUMP, the default label for preset #2 is SPA. This label is tied to the spa filtration mode. Anytime the spa pump is supposed to turn on, this preset is selected.

On a dual equipment system when a pump is configured as a POOL PUMP, the default label for preset #2 is SPEED2.

**Preset 3:**

For the pool pump, if DIP switch S1-1 is ON, then the default label for this preset is CLEANER. Anytime the cleaner mode is turned on the pump will run at the speed setting of this preset. If DIP switch S1-1 is OFF, then the default label for this preset is SPEED3.

For the spa pump the default label is SPEED3.

**Preset 4:**

The default label is SPEED4.

**Preset 5:**

For the pool pump the default label is POOL HEAT. When the pool heater is enabled the pump will run at this speed.

For the spa pump the default label is SPEED5.

**Preset 6:**

For the pool pump the default label is SPEED6.

For the spa pump the default label is SPA HEAT. When the spa heater is enabled the pump will run at this speed.

**Preset 7:**

For the pool pump, if the system is in the SOLAR HEAT mode or the HEAT PUMP mode then the pump will run at this preset speed. If the system is not configured for solar heat or a heat pump then the default label will be SPEED7.

For the spa pump the default label is SPEED7.

**Preset 8:**

For the pool pump, when the In-Floor clean mode is enabled and the pump is running, it will be running at this preset speed.

For the spa pump the default label is SPEED8.

## 11.10 Variable Speed Pump Detail Operation

### Filtration Mode

#### a) Manual Operation

**Setting speeds by turning ON auxiliaries that have speeds assigned to them.**

1. The pump is set to the speed that is assigned to the auxiliary. The exception to this rule will be when the pool/spa heater, solar heat, or heat pump is ON. To protect the heater, solar panels, or heat pump we do not allow the user to select a lower speed than the heater and solar speed settings while they are ON.
2. If you have several auxiliaries ON, that have speeds assigned, and you then turn OFF one of the auxiliaries, the pump will be set to the highest speed that is assigned to any of the auxiliaries that are ON.

### Adjusting speeds from the “Other Devices” screen.

1. On this screen, you can adjust the pump to the desired speed, however the pump will only stay at the speed for that manual ON time. The manual adjust pump speeds are temporary and are not saved when the pump is turned off. The pump will return back to the default values once it is turned on again.

#### b) Programmed Operation

The pump will go to the speed programmed. However, if the pool/spa heater, solar heat, or heat pump is on, the pump will not go any lower than the pool/spa heater, solar heat, or heat pump speed setting.

#### c) Freeze Protection

In the freeze protect mode the pump will turn ON and be set to at least the freeze protect speed. If the filter pump speed is higher than the freeze protect speed, then the pump will run at the filtration speed. Also, if speeds have been assigned to auxiliaries and if those auxiliaries are freeze protected, the pump will be set to the highest of the speeds.

## Auxiliary Pump Mode

#### a) Manual Operation

**Setting speeds by turning ON auxiliaries that have speeds assigned to them.**

1. The speed assigned to the auxiliary that was pressed takes precedence. For example, if the pump is at 3000 RPM, and then AUX 1 is pressed, the pump will switch to the speed that is assigned to AUX 1 regardless of whether the speed is higher or lower than the speed that the pump is currently running at. So, referring to the table below, if all of the auxiliaries are OFF and then AUX 3 is turned ON the pump will go to 3000 RPM. Then if AUX 2 is turned ON the pump switches to 2000 RPM.
2. However, if you have several auxiliaries ON and all of them have a speed assigned to them, what speed does the pump go to when you turn OFF one of the auxiliaries? The pump will switch to the highest speed that is assigned to the auxiliaries. For example, referring to the table below, if all 3 auxiliaries are ON and the pump is at 1000 RPM, what speed will the pump go to when AUX 1 is turned OFF? The answer is 3000 RPM, the highest speed that is assigned to the auxiliaries that are ON.

AUX #	SPEED ASSIGNED TO AUX
1	1000 RPM
2	2000 RPM
3	3000 RPM

**Setting speeds from the VSP Adjust/Set Speed menu (accessed from the other devices screen).**

1. Regardless of what speed is ON, the pump will switch to the speed depending on which one of the 8 buttons on this screen is pressed.

**b) Programmed Operation**

**Programming pump SPEEDS.**

1. The pump will go to the speed that is being turned ON by the program regardless of what the speed currently is. If a program time ends and there are other programs overlapping, the pump will go to the highest programmed speed.

**Programming AUXILIARIES that have speeds assigned to them.**

1. The pump will go to the speed that is assigned to the auxiliary that is being turned ON, regardless of the current speed. If several programs are overlapping for auxiliaries that have speed assigned to them, the pump will operate at the speed of the auxiliary that was most recently turned ON.
2. If several programs are overlapping for auxiliaries that have speeds assigned to them, and then one of the programs end, then the pump will switch to the highest speed of all the auxiliaries that are ON.

**Section 12. Sprinkler System Setup**

**NOTE** This equipment may not be part of your system. Please check with your installer.

In addition to the individual sprinkler programming, the user may enable or disable all sprinkler programs, cancel sprinkler programs for 24 hours, or manually start one or more sprinkler programs.

**12.1 Running the Sprinkler System**

**NOTE** If there are no sprinkler programs set to ON, then SPRINKLERS does not appear in the DEVICES list.

HOME > OTHER DEVICES ON / OFF > SPRINKLERS

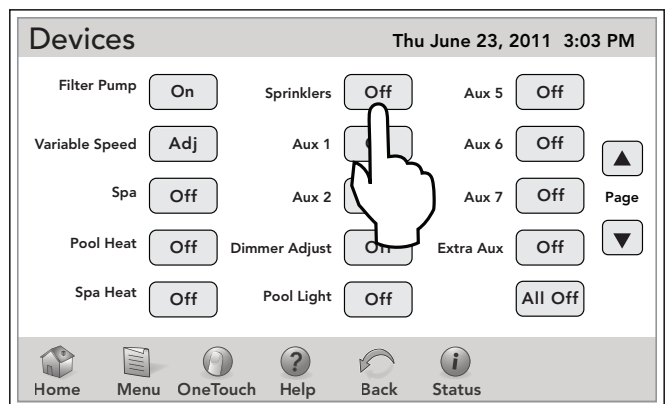

## Cancel Today - 24 Hour Sprinkler Delay

This feature is used to disable the sprinklers for a period of 24 hours. All pending programs are canceled and the system enters the delay state. After 24 hours the system returns to the ENA state.

The 24-hour time delay is reset each time CANCEL TODAY is selected.

**NOTE** This feature may also be used to quickly turn off all sprinkler valves.

OTHER DEVICES ON / OFF > SPRINKLERS > CANCEL TODAY

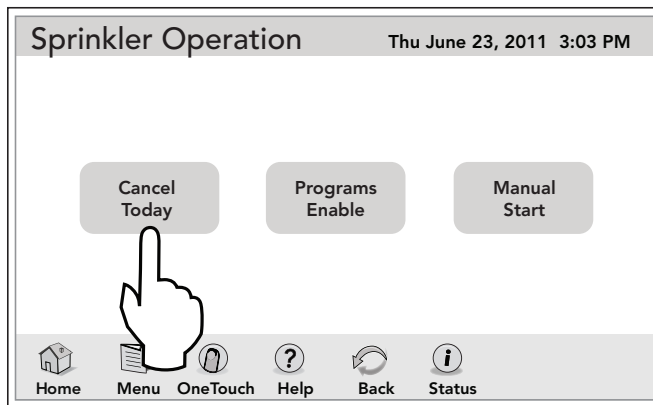

## Enabling the Sprinkler System

To automatically run programs at their start times, the sprinkler control system must be in the enabled state.

OTHER DEVICES ON/OFF > SPRINKLERS > PROGRAMS

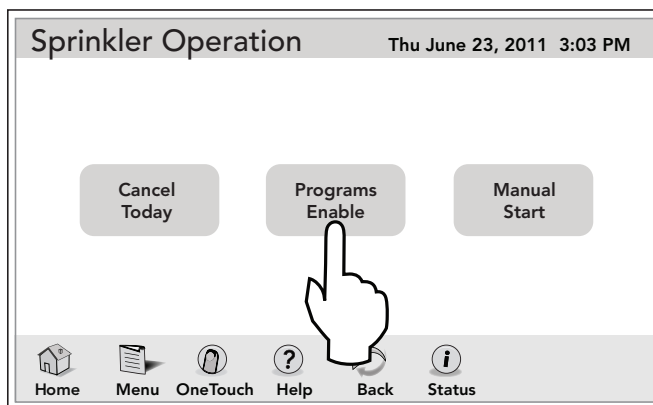

## Manually Starting a Sprinkler Program

Selecting MANUAL START presents the user with a screen providing the option to start all enabled programs, or any individual enabled program, or a single valve.

SPRINKLERS > SPRINKLER OPERATION > MANUAL START

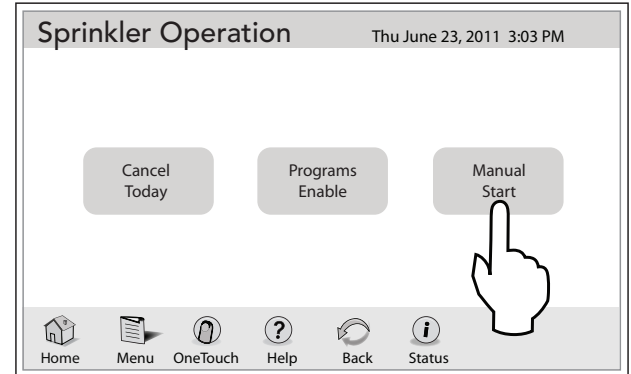

Continue on the screen shown below and click the desired PROGRAM # and click the START button. The program is started immediately and runs to completion unless interrupted by the user.

If ALL PROGRAMS is selected, all enabled programs are run in succession, in numerical order. The sprinkler system enters ENA state at the end of manually started programs.

**NOTE** If a program is not set to ON, it does not appear in the MANUAL START list.

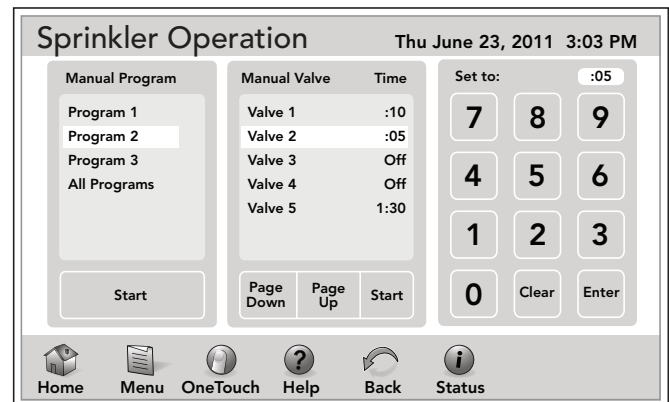

### Disabling the Sprinkler System

When the sprinkler control system is disabled, all running programs are canceled and no programs will run, regardless of their individual ON/OFF setting.

**OTHER DEVICES ON/OFF > SPRINKLERS > PROGRAMS**

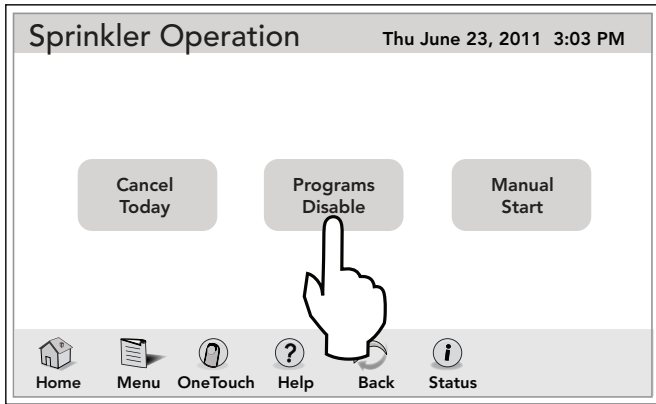

**NOTE** This equipment may not be part of your system. Please check with your installer.

### 12.2 Programming Sprinkler System

The AquaLink RS offers a versatile, easy to use features to program your sprinkler system. Up to three (3) programs can be scheduled with different Run Days, Start Times and Set Durations.

### MENU > SYSTEM SETUP > SPRINKLER SETUP

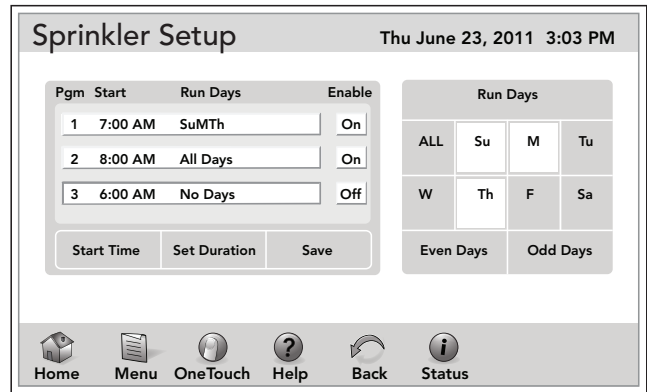

### To Set Up the Water Days

You can choose All to run the program all week long, Even Days, Odd Days or select the desired day(s) to run the enable programs.

On the SPRINKLER SETUP screen, enable the program # by touching the ON button.

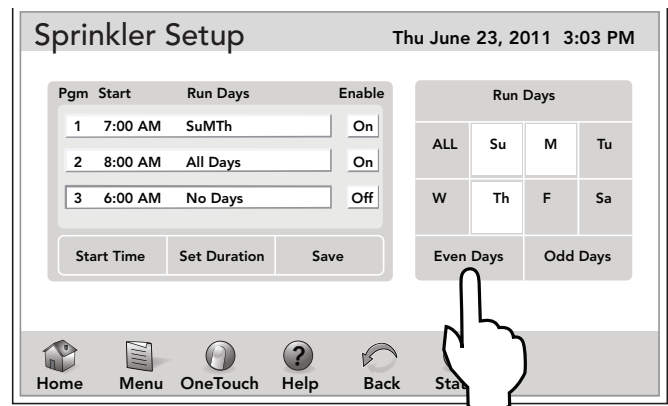

### To Set Up the Sprinklers Program Start Time Menu

On the SPRINKLER SETUP screen, click the START TIME button to display the numeric keyboard. Enter the start time and click the ENTER button to save it.



## Section 13. ChemLink™ Setup

The ChemLink controller automatically monitors and maintains both the sanitizer and the pH balance in swimming pools, spas, or any circulating water system that requires water chemistry management.

### 13.1 To Set Up the ChemLink

**NOTE** Check with the installer before making changes to the SYSTEM SETUP.

#### SYSTEM SETUP > SET CHEMLINK > CHEMLINK

As shown below, the CHEMLINK setup screen provides links to set up the ORP/pH balances, ORP/pH manual feeds, and level switch. Also, provides the current values for the ORP and pH levels.

If only one chemLink is present in the system, the CHEMLINK setup screen is displayed automatically.

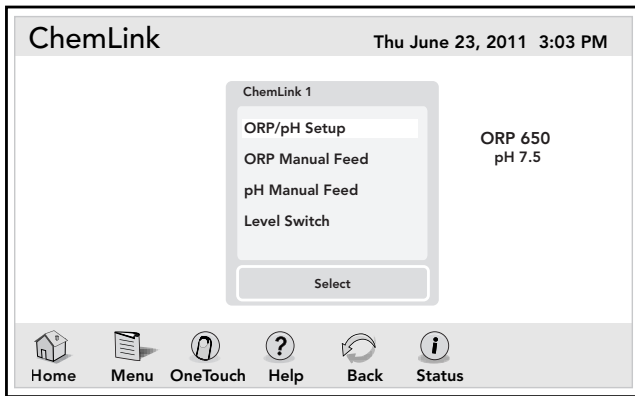

If more than one chemlink is present, the screen will display the links for additional chemlinks. To continue, click the button of the chemlink to be configured.

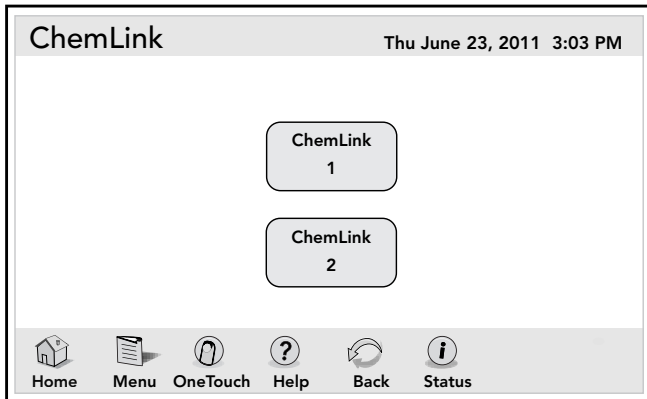

### 13.2 To Configure the ORP Controller

#### SYSTEM SETUP > SET CHEMLINK > CHEMLINK > ORP/PH SETUP

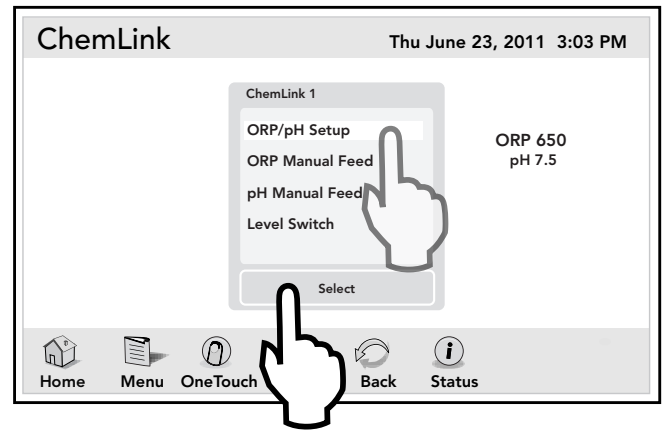

#### ORP Feeder Type

Depending on your installation, the iAquaLink may display the following feeders:

- NONE - Default setting.
- SALT - For salt water chlorinators.
- ERO LP - Non typical application.
- MBV - Non typical application.
- ERO HP - Non typical application.
- LIQUID - For liquid peristaltic pumps.
- GRAN - For Polaris® G1000 dichlor feeders.

#### SYSTEM SETUP > SET CHEMLINK > CHEMLINK > ORP/PH SETUP > SELECT FEEDER

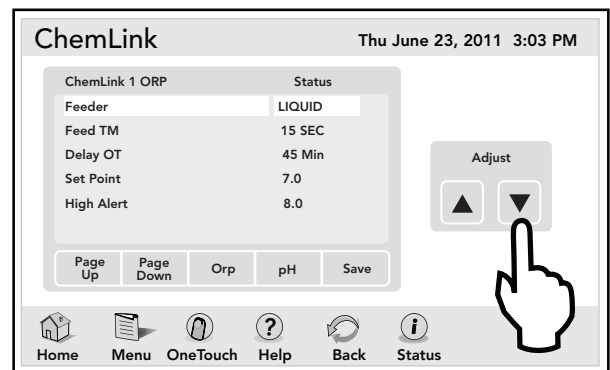

### ORP Feeder Times

The feeders times, sets the amount of time the controller activates the feeder per dose.

SYSTEM SETUP > SET CHEMLINK > CHEMLINK > ORP/PH SETUP

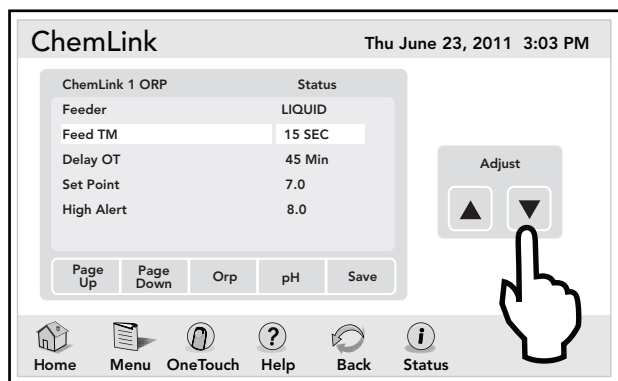

Type	ERO LP/MBV/ERO HP	Liquid
Default	Do not use	30 Sec
Range		.05 Sec to CONT

### ORP Delay On Time

SYSTEM SETUP > SET CHEMLINK > CHEMLINK > ORP/PH SETUP

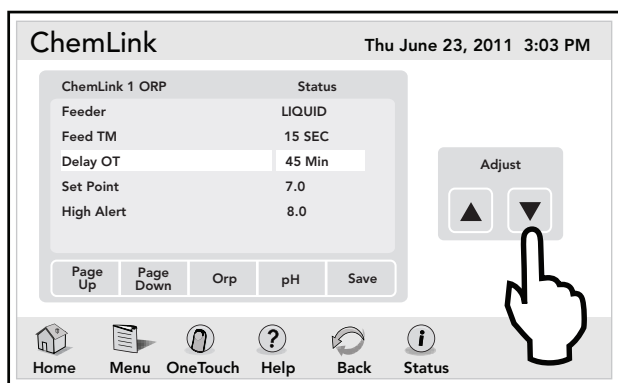

Type	Salt	ERO LP/ MBV/ ERO HP	Liquid	Gran
Default	Overfeed Off	Do not use	10 Min	30 Min
Range			1-99 Min	1-99 Min

OVERFEED: Salt only. Will alarm and not feed if ORP has activated for too long, preventing damage to the cell.

FEED DELAY: Sets the amount of time the controller waits to dose the pool again.

### ORP Setpoint

This setting specifies the level of sanitizer to be maintained.

SYSTEM SETUP > SET CHEMLINK > CHEMLINK > ORP/PH SETUP

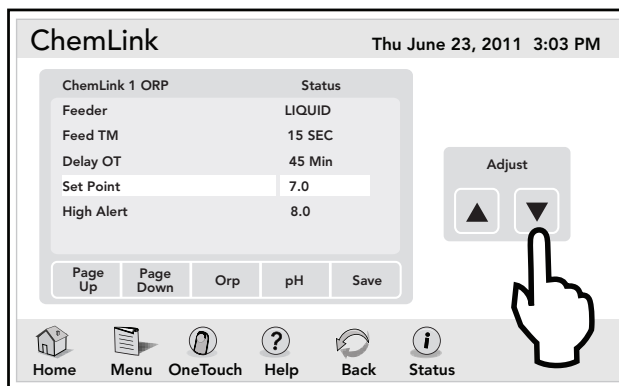

Default	650
Range	200 to 900

### ORP Alarm - High Alert

The high alert alarm sets an alarm to deactivate the controller in the event of an ORP reading that is out of high range. This could be an indication of a mechanical malfunction in the feeding system.

SYSTEM SETUP > SET CHEMLINK > CHEMLINK > ORP/PH SETUP

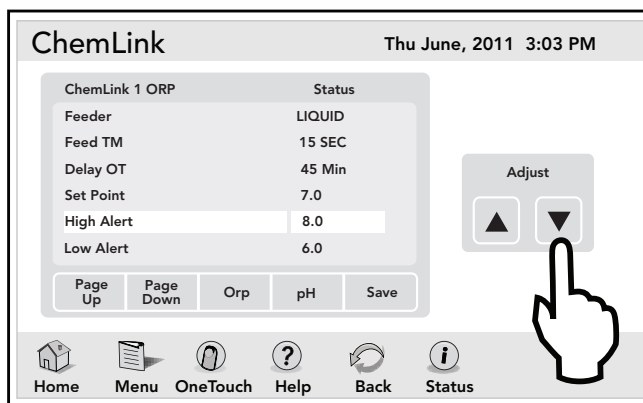

Default	950
Range	350 to 950

## ORP Alarm - Low Alert

The low alert alarm sets an alarm to deactivate the controller in the event of an ORP reading that is out of low range. This could be an indication of a mechanical malfunction in the feeding system.

**SYSTEM SETUP > SET CHEMLINK > CHEMLINK > ORP/PH SETUP**

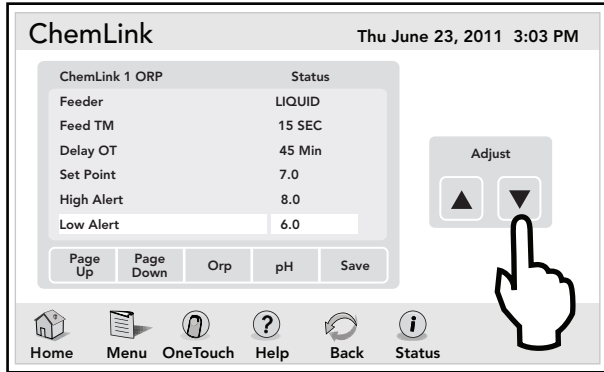

Default	100
Range	100 to 650

## Wait or Stop pH

**SYSTEM SETUP > SET CHEMLINK > CHEMLINK > ORP/PH SETUP > WAIT PH**

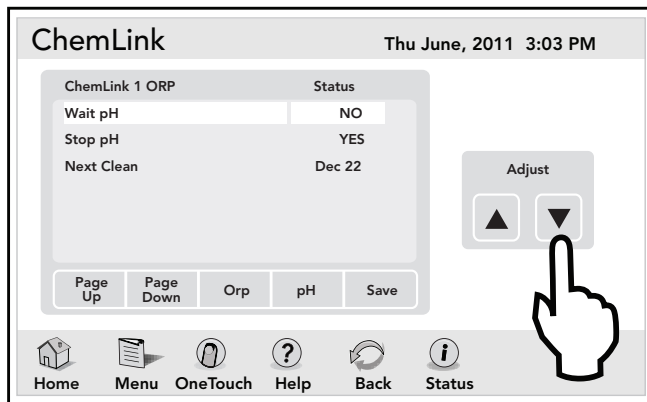

Wait for pH:

- YES= ORP will not feed at the same time as pH.
- NO= ORP will feed regardless of when pH feeds.
- Default= YES

Stop for pH:

- YES= ORP will not feed if the pH is out of range.
- NO= ORP will feed regardless of pH.
- Default= YES

## ORP Next Cleaning

Manually set reminder to clean the ORP sensor. Enter Month, then Year for automatic reminder.

- Default - JAN 01 (essentially OFF).

**SYSTEM SETUP > SET CHEMLINK > CHEMLINK > ORP/PH SETUP > NEXT CLN**

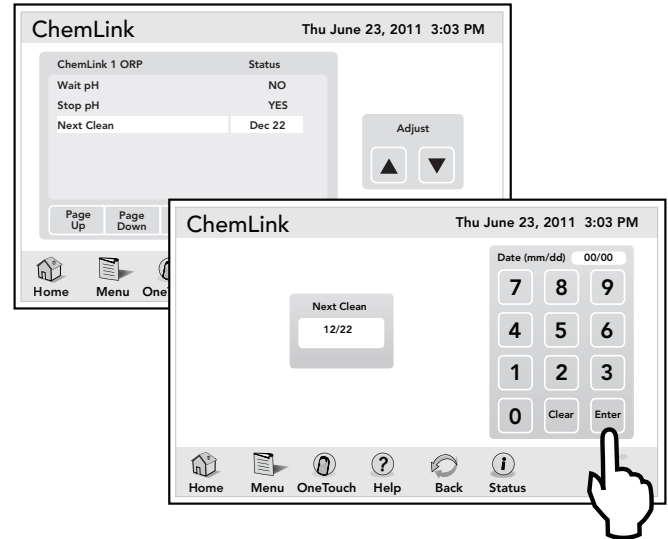

## 13.3 To Configure the pH Controller

On the CHEMLINK™ setup screen, click the pH button to display the CHEMLINK pH setup screen. This screen provides the current settings for the pH levels.

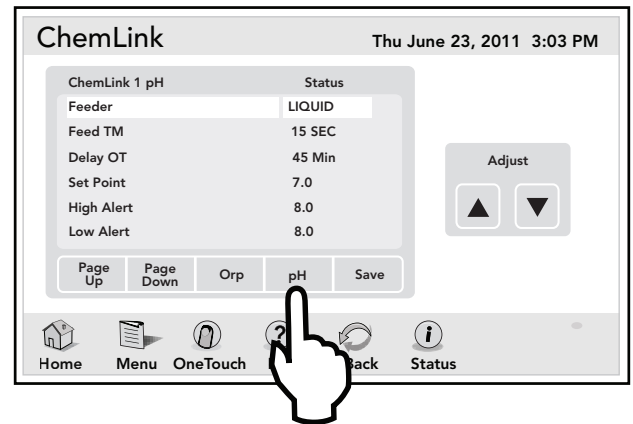

## pH Feeder Type

Depending on your installation, the iAquaLink may display the following feeders:

- NONE - Default setting.
- ERO LP - Non typical application.
- MBV - Non typical application.
- ERO HP - Non typical application.
- GRAN - Non typical application.
- LIQUID - For liquid peristaltic pumps.

**SYSTEM SETUP > SET CHEMLINK™ > CHEMLINK > ORP/PH SETUP > FEEDER**

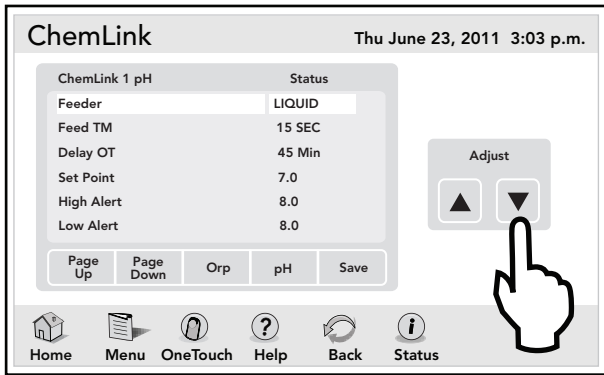

Type	ERO LP/MBV/ERO HP	Liquid
Default	Do not use	30 Sec
Range		.05 Sec to CONT

**pH Setpoint**

This setting specifies the level of sanitizer to be maintained.

**SYSTEM SETUP > SET CHEMLINK > CHEMLINK > ORP/PH SETUP**

**pH Feeder Times**

The feeder times sets the amount of time the controller activates the feeder per dose.

**SYSTEM SETUP > SET CHEMLINK > CHEMLINK > ORP/PH SETUP**

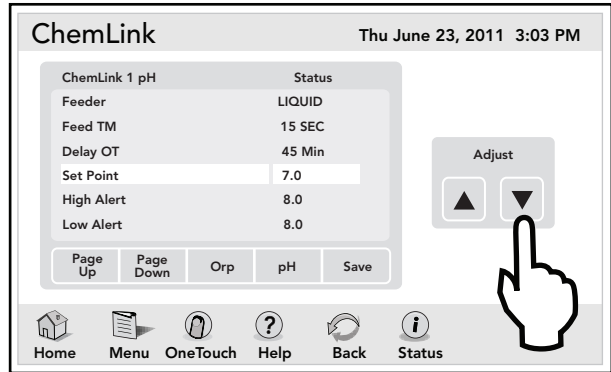

Default	7.5
Range	7.0 to 8.2

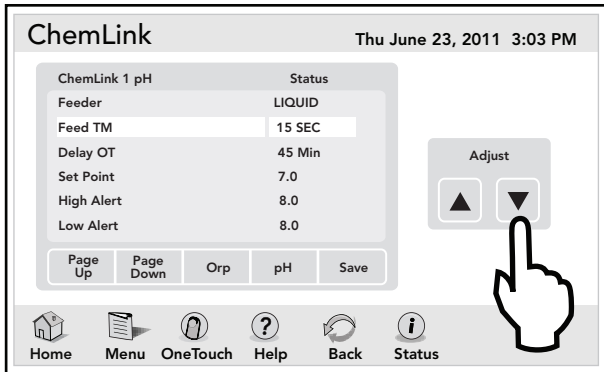

**pH Alarm - High Alert**

The high alert alarm sets an alarm to deactivate the controller in the event of a pH reading that is out of high range. This could be an indication of a mechanical malfunction in the feeding system.

**SYSTEM SETUP > SET CHEMLINK > CHEMLINK > ORP/PH SETUP**

Type	ERO LP/MBV/ERO HP	Liquid
Default	Do not use	30 Sec
Range		.05 Sec to CONT

**pH Delay On Time**

The delay on time sets the amount of time the controller waits to dose the pool again.

**SYSTEM SETUP > SET CHEMLINK > CHEMLINK > ORP/PH SETUP > WAIT PH**

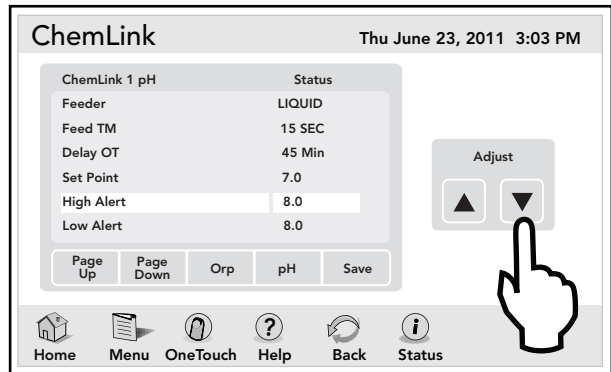

Default	8.4
Range	7.5 to 8.4

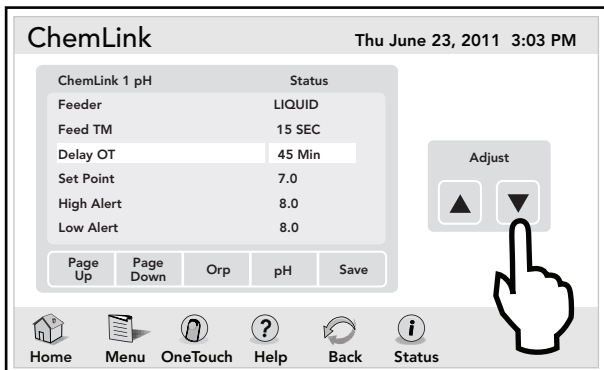

### pH Alarm - Low Alert

The low alert alarm sets an alarm to deactivate the controller in the event of a pH reading that is out of low range. This could be an indication of a mechanical malfunction in the feeding system.

**SYSTEM SETUP > SET CHEMLINK™ > CHEMLINK > ORP/PH SETUP**

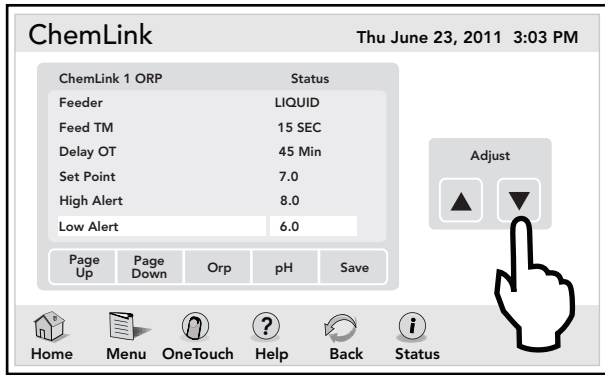

Default	6.8
Range	6.8 to 7.4

### pH Acid or Base Feed

**SYSTEM SETUP > SET CHEMLINK > CHEMLINK > ORP/PH SETUP**

- DEFAULT - Acid.
- ACID - Feeds acid to lower the pH.
- BASE - Feeds base material to raise the pH.

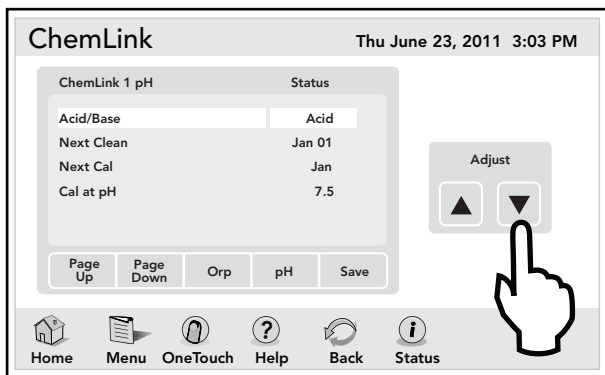

### pH Next Cleaning

Manually set reminder to clean the pH sensor. Enter Month, then Year for automatic reminder.

- DEFAULT - JAN 01 (essentially OFF)

**SYSTEM SETUP > SET CHEMLINK > CHEMLINK > ORP/PH SETUP**

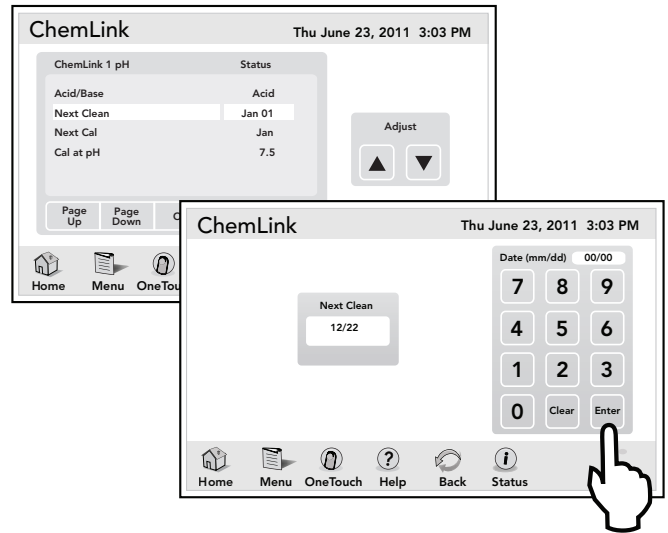

### pH Next Calibration

Manually set reminder to clean the pH sensor. Enter Month, then Year for automatic reminder.

- DEFAULT - JAN 01 (essentially OFF)

**SYSTEM SETUP > SET CHEMLINK > CHEMLINK > ORP/PH SETUP**

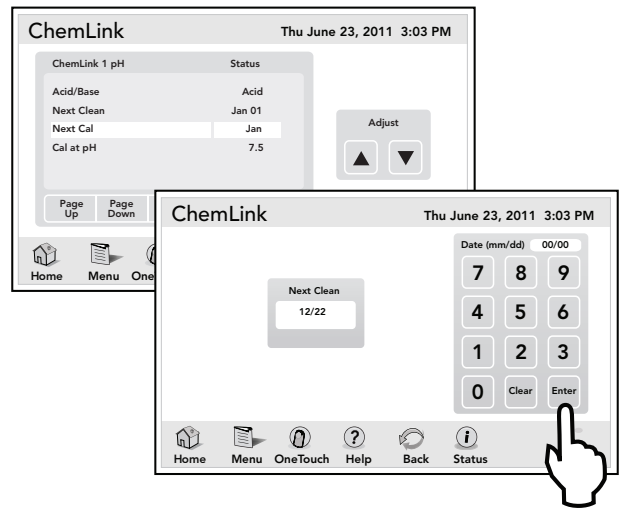

### pH Calibration

This is calibration for pH reading. You can enter the actual pH here to adjust sensor reading.

- DEFAULT - 7.5

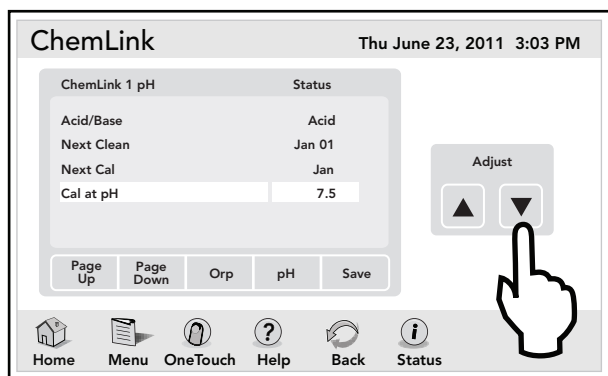

### To Enable the ChemLink™ Feeder Tank Level Switch

This feature allows the use of an external, tank-mounted level switch to indicate when a liquid tank is empty to prevent the dry feeding of a peristaltic pump.

These switches are an after-market product and not available through Jandy. There are only provisions for one (1) switch. The switch must be normally closed (NC).

On the CHEMLINK setup screen, select the LEVEL SWITCH entry.

An 'X' on the display indicates the Level Switch is enabled.

Click the LEVEL SWITCH again to disable it.

### 13.4 Manual Feed Activation

#### To Perform an ORP Manual Feed

SYSTEM SETUP > SET CHEMLINK > CHEMLINK > ORP/PH SETUP

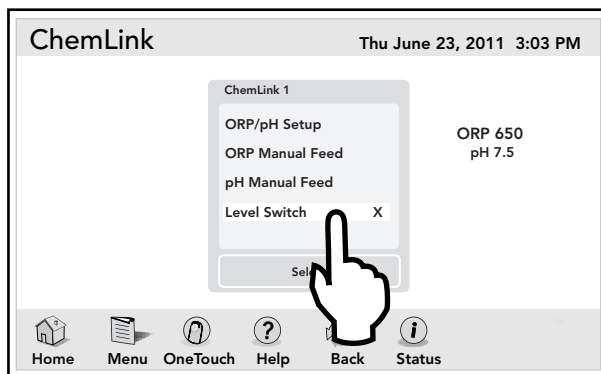
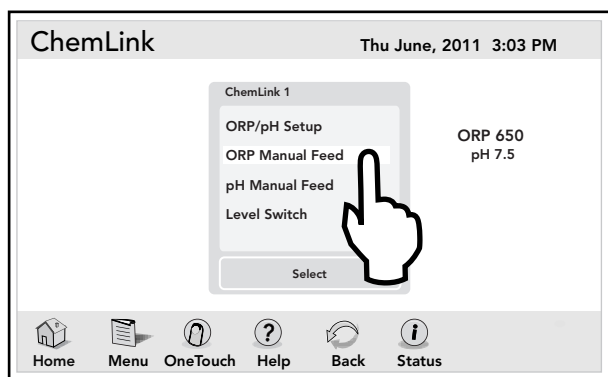

#### To Perform a pH Manual Feed

SYSTEM SETUP > SET CHEMLINK > CHEMLINK > ORP/PH SETUP

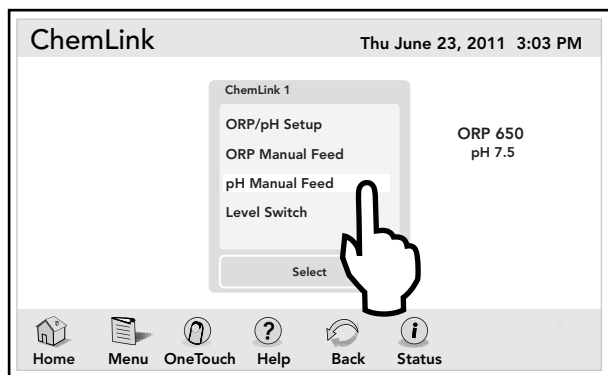

## Section 14. Glossaries

### 14.1 Safety Delays and Lockouts

#### Lockouts

Any device can be locked out. This will prevent the locked out device from being turned on manually. However, the device will turn on/off when it is being controlled by a program.

#### Pool/Spa Switching Filter Pump Delay

The filter pump turns off while valves rotate between pool and spa to prevent damage to the pool equipment. The valves take 35 seconds to rotate between pool and spa; the filter pump will activate as soon as the valves have finished turning.

#### Heater Cool Down Delay

When the system is heating (water is circulating to the spa) and the Spa button is pressed, the system will remain in Spa Mode for five (5) minutes, and will continue to circulate the water. This delay allows water to cool the heater down by circulating water through it, preventing equipment damage.

#### Heater Start-up

The heater will only come on if the water is circulating (e.g., filter pump is on and has been circulating for 15 seconds) to the corresponding body of water (e.g., spa for spa heater) and the actual water temperature is below the temperature you set with TEMP SET in the Menu. If these conditions are not met, the heater will be enabled (ready to go), but will not fire.

#### Heater "Short Cycling" Prevention

When the heater is activated and the desired temperature is reached, heater will turn off and remain off for three (3) minutes, even if the temperature falls below the desired temperature. This feature prevents heater short cycling (i.e., heater turning off and on in rapid succession).

#### Cleaner Lockout

The pool cleaner will only activate if the system is in pool mode (i.e., water circulating to pool). The pool cleaner requires that water is circulating to the pool in order for it to operate. Return to pool mode to activate the cleaner.

#### Spillover Lockout

The spillover will only activate if the system is in pool mode (i.e., water circulating to pool). The spillover requires that water is circulating to the pool in order for it to operate. Return to pool mode to activate the spillover. Also, if the pool cleaner is on, it will turn off during spillover operation.

#### Spillover

When DIP Switch S1-3 is in the ON position, the Aux. 3 relay socket is activated and the return valve actuator turns. The spillover is disabled while the spa is on. A message is displayed when spillover is turned on while in spa mode (water circulation is to spa). The spillover requires that water circulation is to pool in order to operate. The spillover will activate when the system switches back to pool mode.

#### Enabled

When activated allows the function to work.

#### Disabled

When activated does not allow the function to work.

### 14.2 Special Auxiliary Labels

#### Spare AUX

With DIP switch S1-6 turned **OFF**, the spare auxiliary socket is energized in "Pool Mode" and off in "Spa Mode". With DIP switch **ON**, the spare auxiliary socket is energized in the "Spa Mode" and off in the "Pool Mode". Operates only with Pool/Spa combination units.

#### Extra AUX

System features (for example, light dimming, software labeling, and timed aux) can be assigned to the extra AUX button. Only freeze protection cannot be assigned to the extra auxiliary.

#### Air Blower

When an AUX button labeled "Air Blower" is pressed, it will turn on the air blower for 30 minutes, then automatically turn it off. An air blower may be programmed like any other auxiliary, except that you can program only the **ON** time. The air blower will turn on at the programmed **ON** time, and turn off 30 minutes later.

This is to protect the blower motor from overheating during extended operation. To change the **ON** time from the default value of 30 minutes, refer to the **DEVICE RUNTIME** feature.

### Fill Line

When an AUX button labeled “Fill Line” is pressed, it will turn on the fill line for 30 minutes, and then automatically turn it off. A fill line may be programmed like any other auxiliary, except that you can program only the **ON** time. The fill line will turn on at the programmed **ON** time, and turn off 30 minutes later. This is to avoid overfilling the pool. Choose the appropriate number of “fill” programs during the week to keep your pool at the appropriate level. To change the **ON** time from the default value of 30 minutes, refer to the **DEVICE RUNTIME** feature.

## 14.3 Controller Messages

### CLEANER CANNOT BE TURNED ON WHILE SPA IS ON

This message is displayed if the pool cleaner is activated when in spa mode (i.e., water is circulating to spa). The pool cleaner requires that water be circulating to the pool in order for it to operate. Return to pool mode to activate the cleaner.

### CLEANER CANNOT BE TURNED ON WHILE SPILLOVER IS ON

The return valve has been rotated to the spa position to give the spa spillover effect.

### FREEZE PROTECT

This message indicates that freezing conditions have been detected by the freeze protection sensor, and that equipment assigned to freeze protection (e.g., filter pump) are active.

See Section 9.11, “**Freeze Protection**”.

**NOTE** If a freeze protected Auxiliary is turned off during freeze protection, a message will be displayed indicating that item is off but will turn on in X amount of minutes. The minutes will vary depending on how long freeze mode has been active from 1 to 15 minutes.

### SENSOR OPEN

This error message indicates that the sensor is not installed properly or is malfunctioning. Call your pool service person to resolve this problem.

**NOTE** If the message reads **WATER TEMP OPEN**, the heater will not fire. If message **AIR TEMP OPEN** is displayed, freeze protection will not operate correctly.

### POOL HEATER ENABLED

This message indicates that the pool heater is ready to use but is not actually firing. The filter pump must be on, and the water temperature must be below the setting for the heater to fire.

### PUMP WILL REMAIN ON WHILE SPILLOVER IS ON

This message is displayed when you attempt to turn off the filter pump while a spa spillover is on. Since the filter pump is necessary for spillover operation, the pump will remain on until the spillover is turned off.

### PUMP WILL TURN OFF AFTER COOL DOWN CYCLE

This message indicates that the filter pump is circulating water to cool down the heater. The filter pump will continue to run for five (5) minutes to protect the heater from damage, whenever the heater has fired and has been off for less than five (5) minutes.

### PUMP WILL TURN ON AFTER DELAY

This message is displayed during pool/spa switching. The AquaLink RS waits 35 seconds while the valves turn from pool position to spa position (or vice-versa) before activating the filter pump.

### SERVICE MODE

This message indicates that the Controller has been locked out from the power center and is not operational. Service mode is used by the pool service person to aid them in servicing the pool. The Controller will not be functional until the switch at the power center is moved back to **AUTO** mode.



## SENSOR SHORT

This error message indicates that the sensor is not installed properly or is malfunctioning. Call your pool service person to resolve this problem.

**NOTE** If the message reads WATER TEMP SHORT, the heater will not fire. If the message AIR TEMP SHORT is displayed, freeze protection will not operate correctly.

## SPA WILL TURN OFF AFTER COOL DOWN CYCLE

When the system is in Spa Mode (water is circulating to the spa) and the Spa button is pressed to switch water circulation to the pool, the system will not switch to Pool Mode for five (5) minutes, and will continue to circulate the water [if the heater has fired and has been off for less than five (5) minutes]. This delay allows water to cool the heater down by circulating water through it, preventing equipment damage.

## TIMED AUX ON, WILL TURN OFF AFTER 30 MINUTES

This message indicates that a timed auxiliary (usually a blower) has been activated and will turn off after 30 minutes. Some labels (e.g., blower, fill line) have a built-in 30 minute shut off.

## TIMEOUT MODE

This message indicates that the Controller has been locked out from the Power Center and is not operational. TIME OUT mode is used by the pool service person to aid them in servicing the pool. The Controller will not be functional for three (3) hours, or until the switch at the power center is turned back to AUTO mode.

## SPILLOVER DISABLED WHILE SPA IS ON

This message is displayed when the spa spillover is pressed while in spa mode (water circulation is to spa). The spillover requires that water circulation is to pool in order to operate. The spillover will activate when the system switches back to pool mode.

# Section 15. iAquaLink Menu Flow Chart

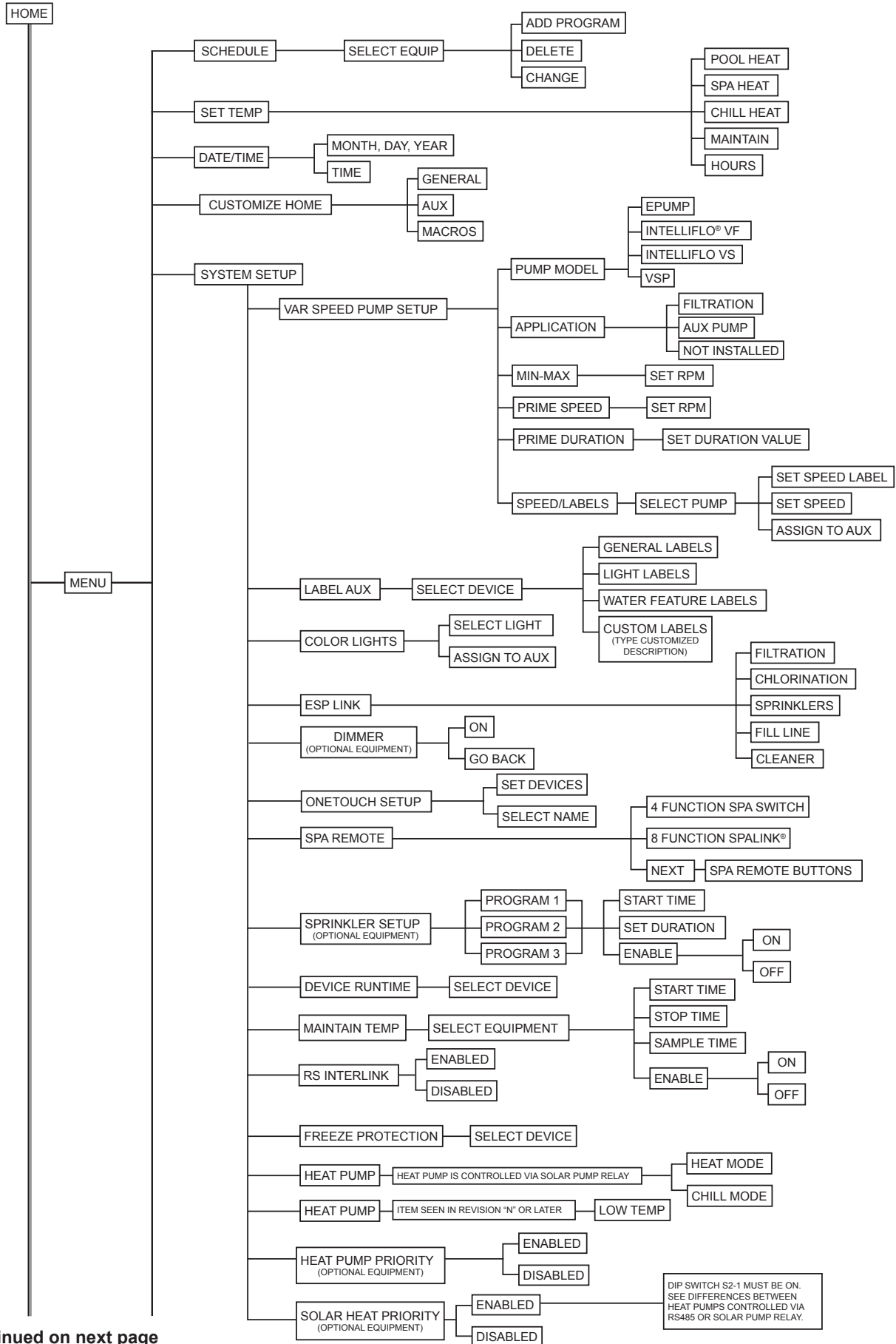

Continued on next page

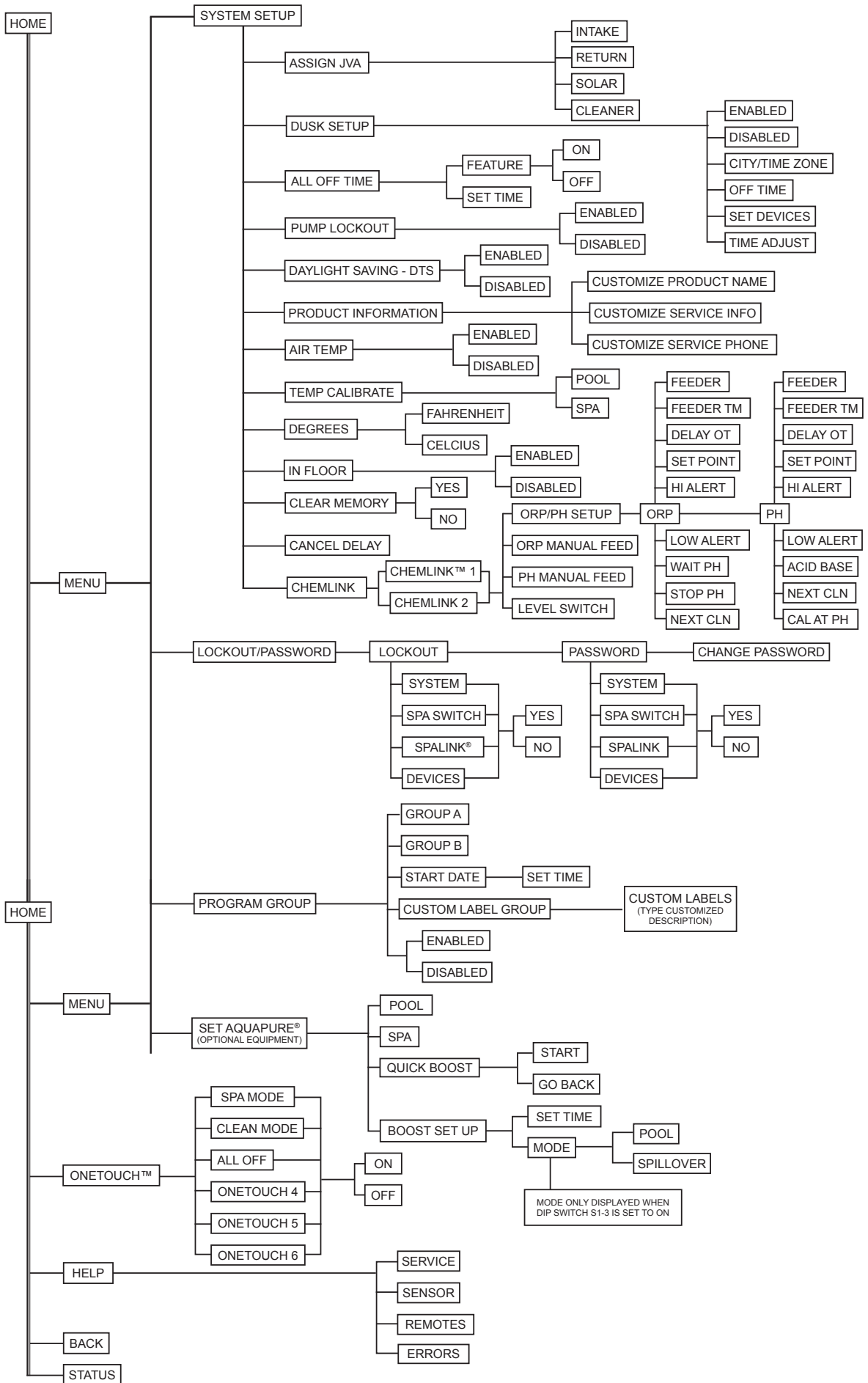

**Zodiac Pool Systems Canada, Inc.**

2115 South Service Road West, Unit 3 Oakville, ON L6L 5W2  
1.888.647.4004 | [www.ZodiacPoolSystems.ca](http://www.ZodiacPoolSystems.ca)

**Zodiac Pool Systems, Inc.**

2620 Commerce Way, Vista, CA 92081  
1.800.822.7933 | [www.ZodiacPoolSystems.com](http://www.ZodiacPoolSystems.com)

**Zodiac Group Australia,**

ABN 87 002 641 965,  
219 Woodpark Rd,  
Smithfield NSW 2164, Australia

*ZODIAC® is a registered trademark of Zodiac International, S.A.S.U., used under license.  
All trademarks referenced herein are the property of their respective owners.*

©2013 Zodiac Pool Systems, Inc. H00433600 Rev A

