

This Quick Start Guide is to help you quickly install your system. Be sure to read all **WARNINGS** in the complete installation manual.

! WARNING

To prevent risk of electrical shock which can result in severe injury or death, ENSURE that the AquaLink® system is OFF before proceeding with installation.

FOR YOUR SAFETY - This product must be installed and serviced by a contractor who is licensed and qualified in pool equipment by the jurisdiction in which the product will be installed where such state or local requirements exist, the maintainer must be a professional with sufficient experience in pool equipment installation and maintenance so that all of the instructions in this manual can be followed exactly. Before installing this product, read and follow all warning notices and instructions that accompany this product. Failure to follow warning notices and instructions may result in property damage, personal injury, or death. Improper installation and/or operation will void the warranty. Improper installation and/or operation can create unwanted electrical hazard which can cause serious injury, property damage, or death. Turn off power at the main circuit feeding the AquaLink power center to disconnect the power center from the system.

Installation manual (H0433500) and owners manual (H0433600), available online at www.iAquaLink.com or by calling:
USA: 1-800-822-7933 | CANADA: 1-888-647-4004 | AUSTRALIA: 1800-688-552

1 Wire iAquaLink™ to the AquaLink Automation system.

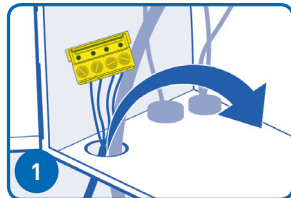

1 Ensure all power to AquaLink is OFF, then remove the dead panel. Pass the iAquaLink cable through the low voltage raceway of the AquaLink.

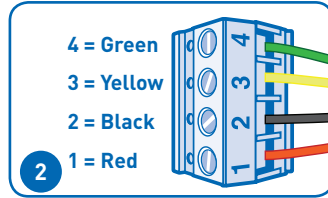

2 Connect iAquaLink to the RS485 4-wire connector on the power center board of the AquaLink.

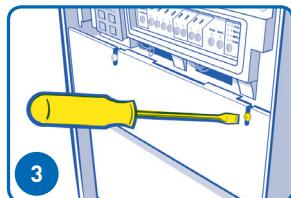

3 Reinstall the dead panel (and/or close doors if applicable) to ensure high-voltage areas are secured.

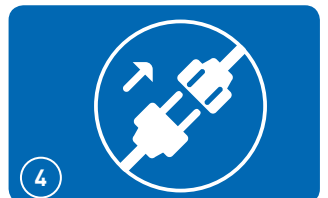

4 Restore power to the AquaLink system.

2 Start WiFi Setup Mode

! CAUTION

This step will clear Wi-Fi settings memory

Remove the device lid by removing the two screws on the cover. To clear any previous WiFi settings, toggle the WiFi-Wired switch. Then, set the switch to the desired mode. Proceed to step 3A or 3B to reprogram the WiFi settings.

i See Helpful Hints #2 for more info

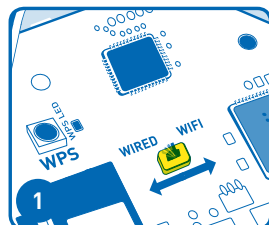

3 Connect iAquaLink to the home network - There are 3 ways to do this:

3A. WiFi - Hotspot Method



1 After clearing the WiFi settings and with the Wired/WiFi switch set to WiFi, use a smartphone or WiFi enabled device to go to WiFi settings. Connect to the network labeled iAquaLink.



2 Some devices will automatically re-redirect you to the Log In Screen. If not, open a browser and go to zodiac.com

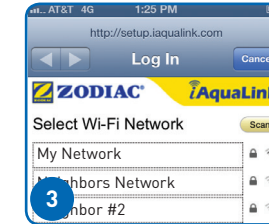

3 iAquaLink will display the networks it detects, as well as signal strength. Select the network iAquaLink should use.

i If prompted for a password, enter the password for the home network (caps sensitive).

i iAquaLink will disconnect from the smartphone at this point.

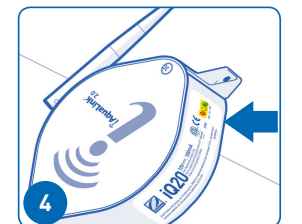

4 Within 2 minutes, the yellow LED should stop blinking. When the green LED illuminates, the iAquaLink is connected.

i See Helpful Hints #1 for more info

3B. WiFi - WPS Method

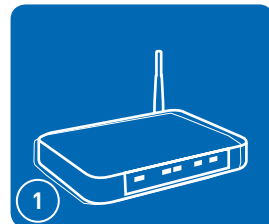

1 Push the WPS Button on the pool owner's router. To find it, look for the symbol.

i See Helpful Hints #6 for more info

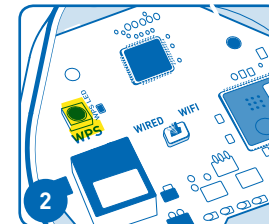

2 After clearing the WiFi settings and with the Wired/WiFi switch set to WiFi, press and release the WPS button and wait for the small yellow LED, next to the WPS button to start blinking slowly.

The yellow "LAN" LED on the outside of the device will temporarily turn off.

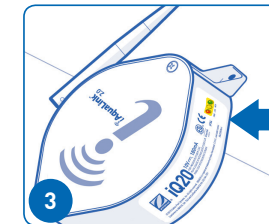

3 Within 2 minutes, the yellow "LAN" LED will illuminate. When the green LED illuminates, the iAquaLink is connected.

i See Helpful Hints #1 for more info

3C. Wired: Ethernet Method*

* To prevent potential Ethernet signal interference, order and install part# R0616800. (Does not apply to wi-fi installations).

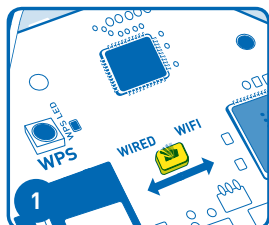

1 Confirm that the internet connection switch is set to the *Wired* position.

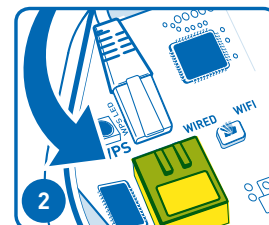

2 Connect the ethernet cable into the ethernet port on the iAquaLink.

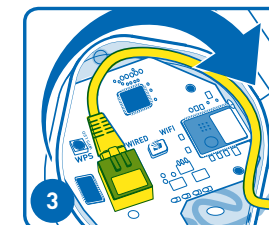

3 Wrap the cable as shown inside the device and use the break-away as an exit hole. Replace the rubber gasket and cover.

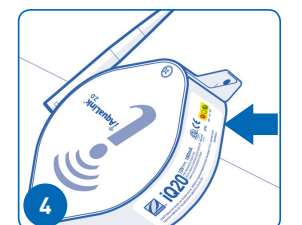

4 Within 2 minutes, the yellow LED should stop blinking. When the green LED illuminates, the iAquaLink is connected.

4 Set up User Account and add the location to the account.

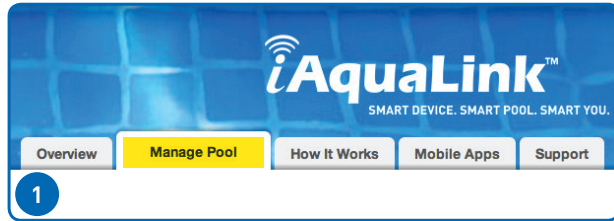

From iAquaLink.com under the **Manage Pool** tab, the pool owner should create a user account with their email address and a password. Then they should sign in to their user account.

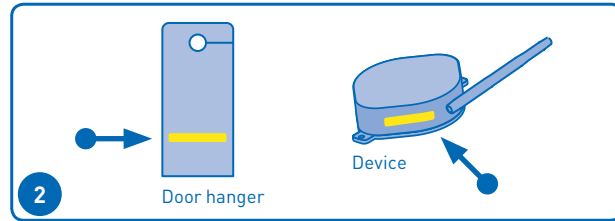

After signing in, to add the device to the user account, click **Add Location**. Enter the iAquaLink device number found on the door hanger or the device itself.

To add the iAquaLink device to an account, you must be connected to the web through the same router the iAquaLink device is connected to.

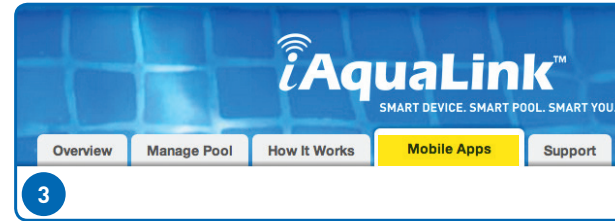

To download the App, go to iAquaLink.com and select **Mobile Apps** - this may appear as a drop-down menu on some devices. It will display links for the appropriate apps for the device. The "Web Application" provides the app experience without downloading or installing a native app.

i Helpful Hints



What the LEDs mean

Red = Power
 Yellow - Slow Flashing = Searching for Network
 Yellow - Solid = Connected to Network
LED's may flicker—this is normal.
 Green = Connected to Internet

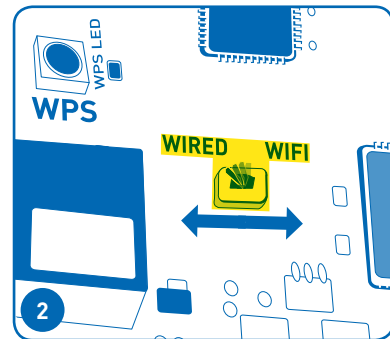

Restarting WiFi setup mode

The iAquaLink will start WiFi setup mode when the WiFi-Wired switch is set to WiFi and its memory has been cleared. To clear the memory, toggle the switch and leave it in the WiFi position.

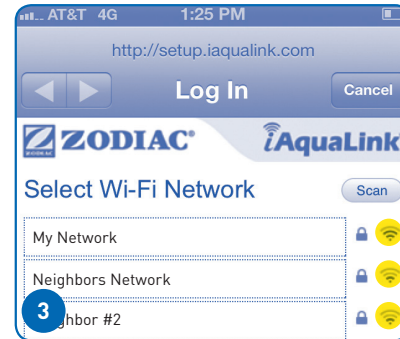

Evaluating WiFi signal strength

An easy way to evaluate the signal strength between the iAquaLink and the home router, is by using the Hotspot method. This method allows the installer to scan networks, and shows a signal strength indicator. This can be a helpful tool to evaluate the final mounting location of the iAquaLink device. See Section 3A of this manual.

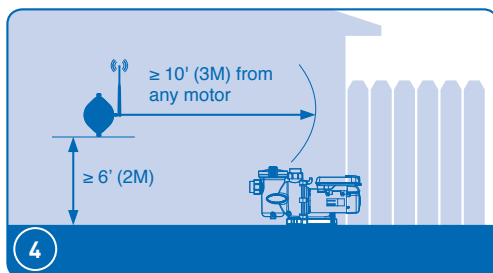

For best reception (Wi-Fi installs only)

- Always mount the iAquaLink™ device with the antenna on the right side, pointing up toward the sky
- Mount the antenna at least 6 ft. (2m) high and 10 ft. (3m) from any electric motor.
- Attach the Web Connect Device as close to the home's router as possible

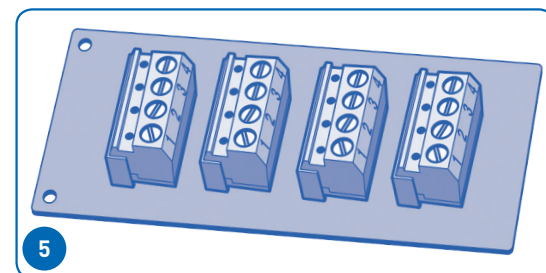

When and how to use a 6584 multiplex board

If you have more than two sets of wires that need to be connected to any single RS-485 four wire connector, install a 6584 Multiplex board. For installation instructions see instruction sheet included with 6584.



WPS Helpful Hints

- Some brands use other names (like Quick Setup) or other icons (such as padlock or similar) for WPS.
- Some routers may have WPS disabled, which may require using the hotspot method (4A).
- The hotspot method (4A) is recommended for Apple routers



Quick Start Guide



IMPORTANT | IMPORTANT | IMPORTANTE
 Give doorhanger directly to pool owner or hang on door

iAquaLink™ 2.0

How It Works



INTERNET

