



POOL SUPPLY UNLIMITED

SAFETY COVER MEASUREMENT FORM

Our Safety Covers Are **CERTIFIED-SAFE!** Most **OTHERS ARE NOT!**

The following four pages should be filled out as completely and accurately as possible in order to assure the Certified-SAFE Safety Cover is made to fit properly.

It is always best if you can send to us a sketched drawing of your pool and the five foot area directly around the edge of your pool. If you would like to send us a digital image or two of your pool area, just email them to the sales@poolsupplyunlimited.com.



You may return this form to us via:

Mail:

Pool Supply Unlimited
c/o Safety Covers
1426 East Spruce Street
Ontario, CA 91761

Email: sales@poolsupplyunlimited.com

Fax: 888-648-5677

Have Cover Questions? Call 888-836-6025
Hours: 6AM – 6PM Pacific

Ship To:
 NAME _____
 STREET _____
 CITY/STATE _____
 PHONE # _____ ZIP _____
 E-MAIL _____



888-836-6025 - sales@poolsupplyunlimited.com

ORDER *QUOTE* DATE _____

COVER MODEL

- | | |
|---|--|
| <input type="checkbox"/> MERLIN | <input type="checkbox"/> ARCTIC ARMOR |
| <input type="checkbox"/> SMARTMESH | <input type="checkbox"/> PREMIUM MESH |
| <input type="checkbox"/> DURA-MESH | <input type="checkbox"/> SUPER MESH |
| <input type="checkbox"/> CLASSIC-MESH | <input type="checkbox"/> STANDARD MESH |
| <input type="checkbox"/> SOLID SAFETY COVER | <input type="checkbox"/> ULTRA LIGHT SOLID |
| <input type="checkbox"/> POOLTUX | <input type="checkbox"/> EMPEROR SOLID |
| <input type="checkbox"/> ROYAL MESH | <input type="checkbox"/> KING SOLID |
| <input type="checkbox"/> KING99 MESH | |
| <input type="checkbox"/> COMMERCIAL MESH | |

COMPLETE THE SECTIONS WHICH APPLY, OTHERWISE LEAVE BLANK.
 SKETCH IN STEP LOCATION AND DIMENSIONS.
 (SIZE AND LOCATION)
 DIRECTION IS DETERMINED BY STANDING IN SHALLOW END.

POOL CORNER TYPE & SIZE

IF POOL CORNERS ARE GREATER THAN 2' RADIUS OR DIAGONAL. PLEASE SPECIFY THE TYPE AND SIZE.

ANCHOR/DECK TYPE

- CONCRETE
 WOOD DECK
 PAVERS

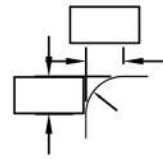

DIAGONAL DISTANCE (INCHES)
 RADIUS (INCHES)

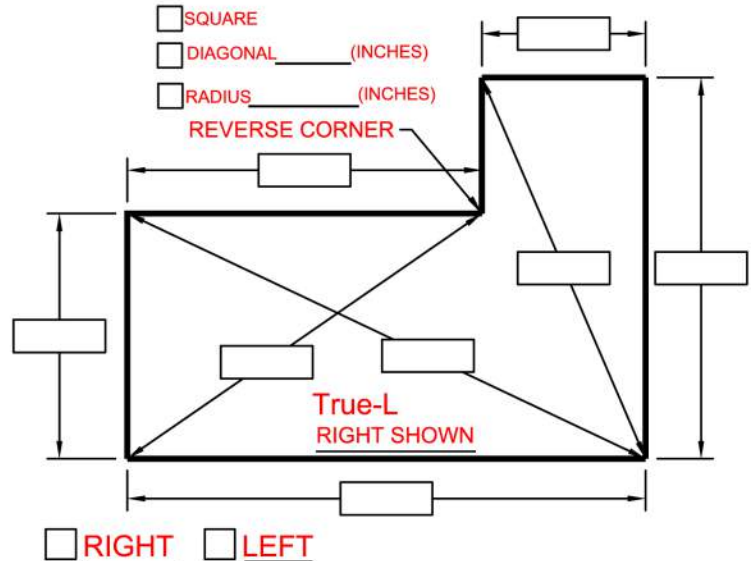
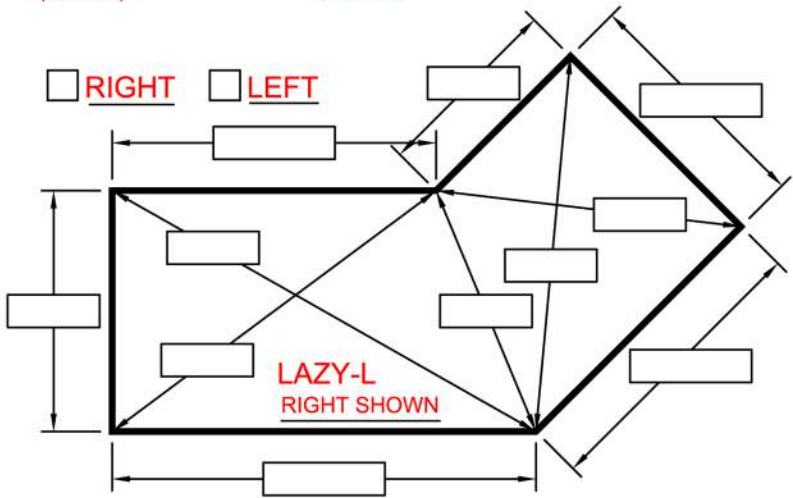
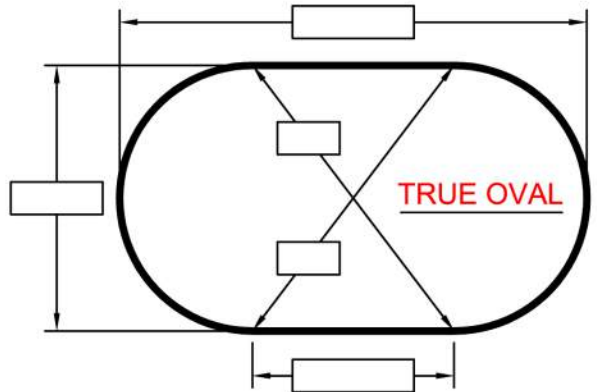
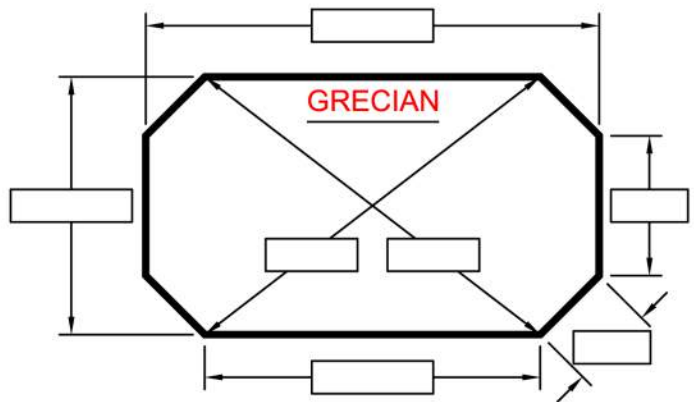
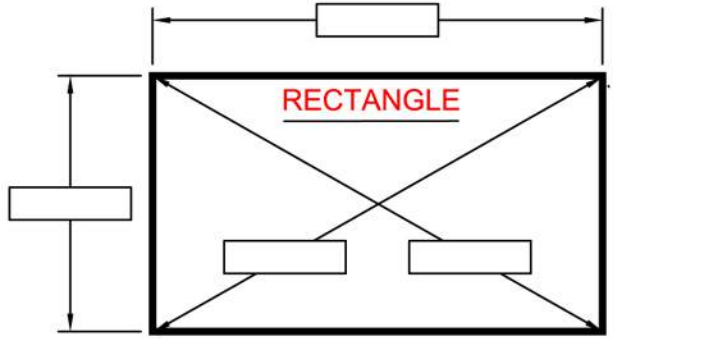

1. Begin with a freehand sketch indicating inside pool dimensions. The sketch should include pool orientation and the "A-B" line location. Include deck area, and any obstructions within 3' of the waterline.

A photo of the pool is needed when rocks, spas or anything out of the ordinary exists. It's recommended to take pictures of the numbered points at obstructions.

2. Establish two points, "A-B" with "A" on the left as shown. The "A-B" line must be 3' away from the pool and 2/3 the length of the pool; 20'-25' is typical (show this on the sketch). To mark "A-B" points on deck - use chalk marks, on ground - use stakes in the dirt. Do not remove the "A-B" points until the measurements have been confirmed and approved. NOTE: The "A-B" line must never cross the pool line and should be approximately 3' away from the pool at the closest point (4' to 5' away from pools over 44' long).

3. Using chalk, mark and number points along the inside edge of the pool at approximately 2' intervals. Number all corner points, ladders, handrails, grabrails, slide legs, rocks, spillways, spa walls separating spa and pool, fill spout and dive stand. 1' intervals should be used in small or tight radius areas. At least 3 points along straight walls.

4. Measurements are now taken from point "A" to #1, then point #2, and all the way around the pool. Then measure from point "B" to same point #1 and then #2, as you did for point "A". Measurements are listed in column format as shown.

5. Take measurements between two known points to determine length and width cross dimensions of the pool. Cross dimensions to any raised beam obstacles are recommended.

NO.	A	B
1	25'-2"	20'-8"
2	26'-10"	19'-3"
3	28'-5"	18'-6"
4	30'-4"	17'-11"
5		
6	CONTINUE	CONTINUE
7	CONTINUE	CONTINUE
8	CONTINUE	CONTINUE
9	CONTINUE	CONTINUE
10		
11		
12		
13		
14		
15		
16		
17		
18	↓	↓
19		
20		

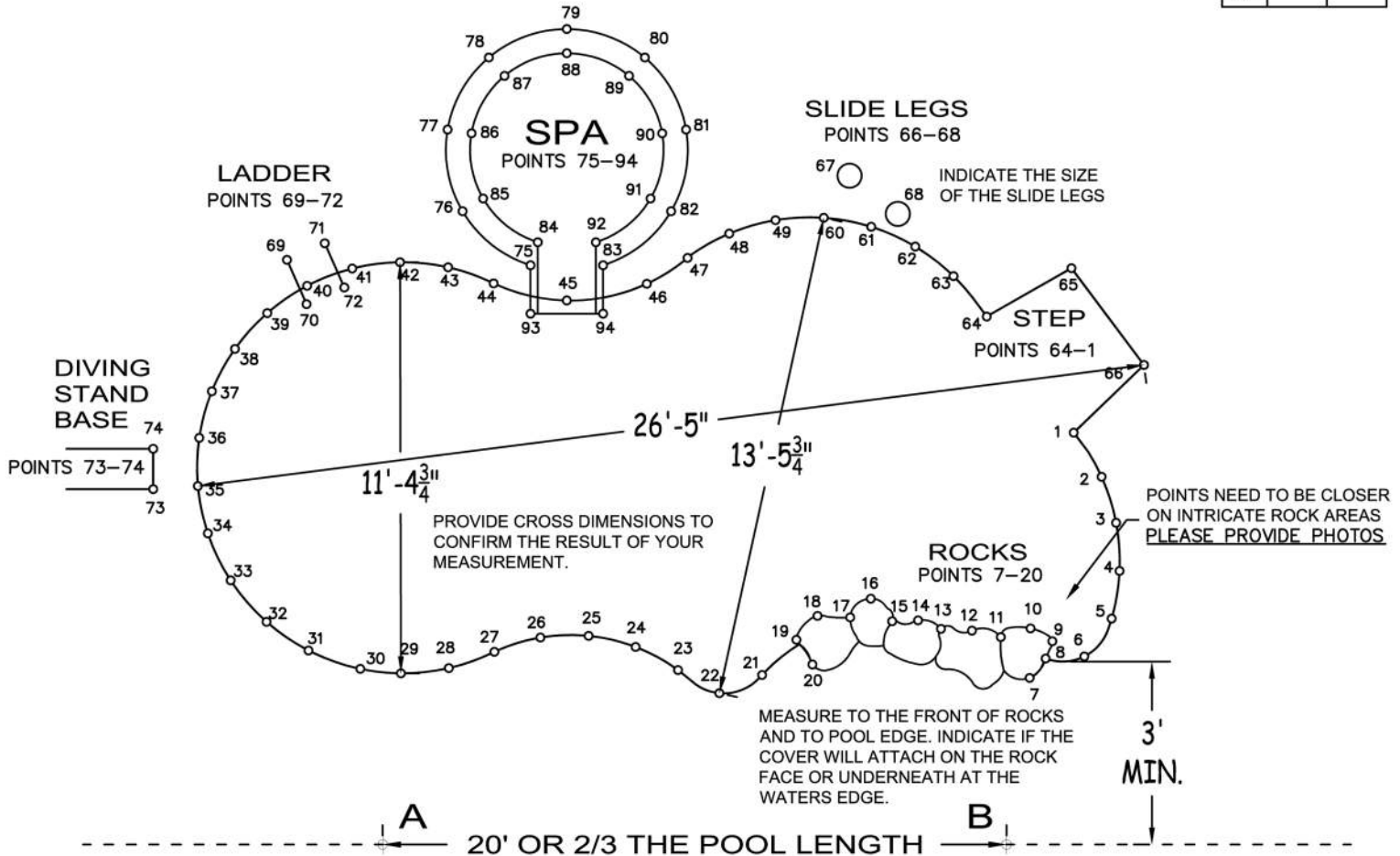

NOTE: MAKE SURE THE A-B LINE IF EXTENDED IS NOT CROSSING THE PERIMETER OF THE POOL.

NAME _____ DISTANCE FROM "A" TO "B" _____



	A	B
1		
2		
3		
4		
5		
6		
7		
8		
9		
10		
11		
12		
13		
14		
15		

	A	B
16		
17		
18		
19		
20		
21		
22		
23		
24		
25		
26		
27		
28		
29		
30		

	A	B
31		
32		
33		
34		
35		
36		
37		
38		
39		
40		
41		
42		
43		
44		
45		

	A	B
46		
47		
48		
49		
50		
51		
52		
53		
54		
55		
56		
57		
58		
59		
60		

	A	B
61		
62		
63		
64		
65		
66		
67		
68		
69		
70		
71		
72		
73		
74		
75		

	A	B
76		
77		
78		
79		
80		
81		
82		
83		
84		
85		
86		
87		
88		
89		
90		

	A	B
91		
92		
93		
94		
95		
96		
97		
98		
99		
100		
101		
102		
103		
104		
105		

	A	B
106		
107		
108		
109		
110		
111		
112		
113		
114		
115		
116		
117		
118		
119		
120		

CROSS DIMENSIONS #1: FROM POINT # _____ TO POINT # _____ LENGTH _____
 CROSS DIMENSIONS #2: FROM POINT # _____ TO POINT # _____ LENGTH _____
 CROSS DIMENSIONS #3: FROM POINT # _____ TO POINT # _____ LENGTH _____
 CROSS DIMENSIONS #4: FROM POINT # _____ TO POINT # _____ LENGTH _____

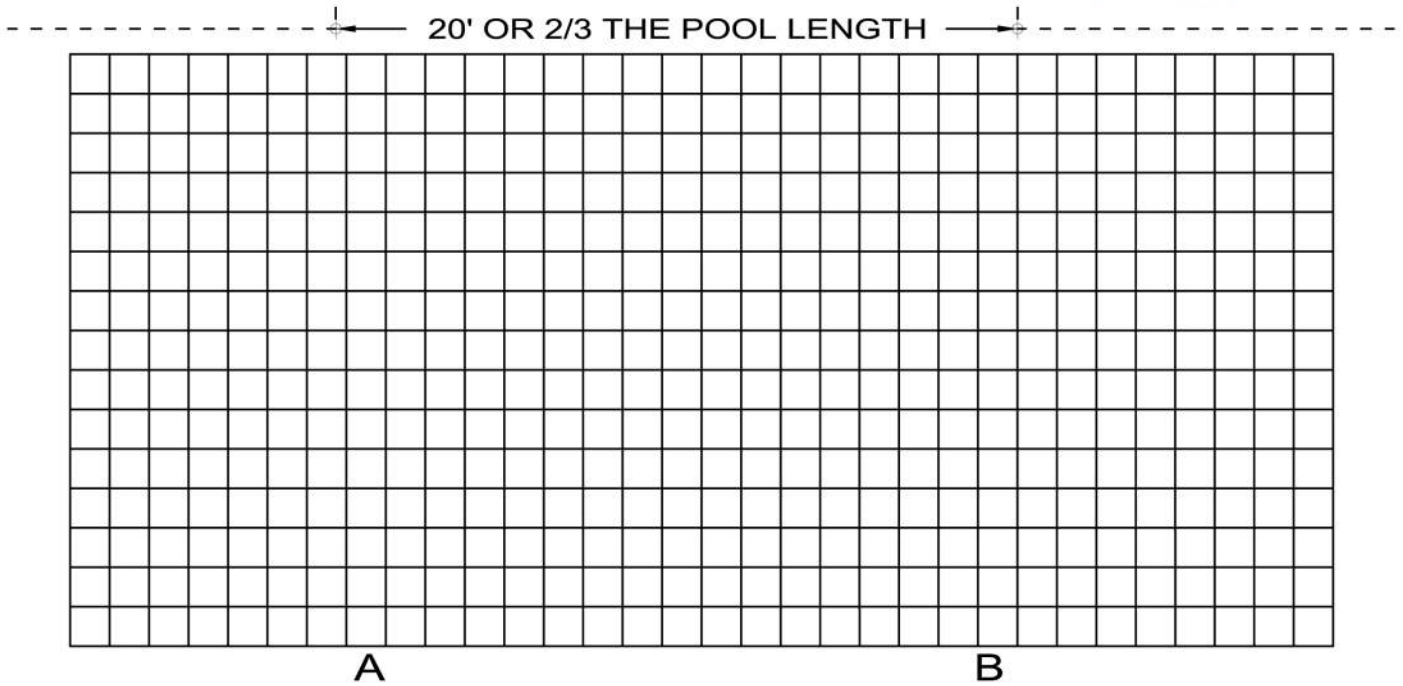

1. Non-Removable handrails, grabrails, or ladders:
 Pt # _____ to Pt # _____
 Distance back from pools edge: _____
 Distance over waters edge: _____

2. Raised rail sockets or fill spout:
 Pt # _____ to Pt # _____
 Distance back from pools edge: _____
 Height of rail socket or fill spout: _____

3. Dive stand:
 Pt # _____ to Pt # _____
 Distance back from pools edge: _____
 Is a Y-strap required? _____

4. Dive rock: (Please Supply Photo)
 Pt # _____ to Pt # _____
 Distance back from pools edge: _____
 Distance over waters edge: _____

5. Slide legs or slide base:
 Pt # _____ to Pt # _____
 Distance back from pools edge: _____
 Size of slide legs or slide base: _____

6. Decking type & quantity:
 Which type of material is your deck made of:
 Concrete: _____
 Pavers: _____
 Wood: _____

What is beyond your decking? _____

How wide is your decking? _____
 If less than 3' RDM's may be required

7. Grass area: (Please Supply Photo)
 Pt # _____ to Pt # _____
 Distance back from pools edge: _____

8. Coping:
 Is the coping rough and requiring extra padding and if so please choose one:
 Loose: _____ (2' x 20' sections)
 Replaceable: _____
 Sewn on: _____

9. Rock formation: (Please Supply Photo)
 Pt # _____ to Pt # _____
 Distance back from pools edge: _____
 Distance over waters edge: _____

*Are the rocks strong enough for the cover to attach w/spring clips and i-bolts? _____

11. Spa: (Please Supply Photo)
 Pt # _____ to Pt # _____
 Is spa going to be covered? _____
 Is separate cover required? _____
 Is spa raised above deck? _____
 If Yes, how high? _____
 *Spa's raised over 16" will be designed as a separate cover.
 Does spa have a spillway? _____
 If Yes, please locate between points.
 Are there any specific spa cover design instructions? _____
 Please specify, _____

