

DURO-SPRING BASE:



Part # DSS6 (Duro-Spring base, 6' jig & hardware)

Part # DSS8 (Duro-Spring base, 8' jig & hardware)

See page 117 for paver jig info.

Compatible with Epoxy Mounting Kit Part # EPX-7

FEATURES:

- Active Base - Spring Feature is Derived from Both Base & Board
- Powder Coated Steel Base
- Weight Limit = 250 lbs.
- Available in 6' or 8' Set-Ups
- 3 Hole Drill Pattern
- Refer to Board Chart on Pg. 7
- Refer to Available Base Colors on Pg. 7

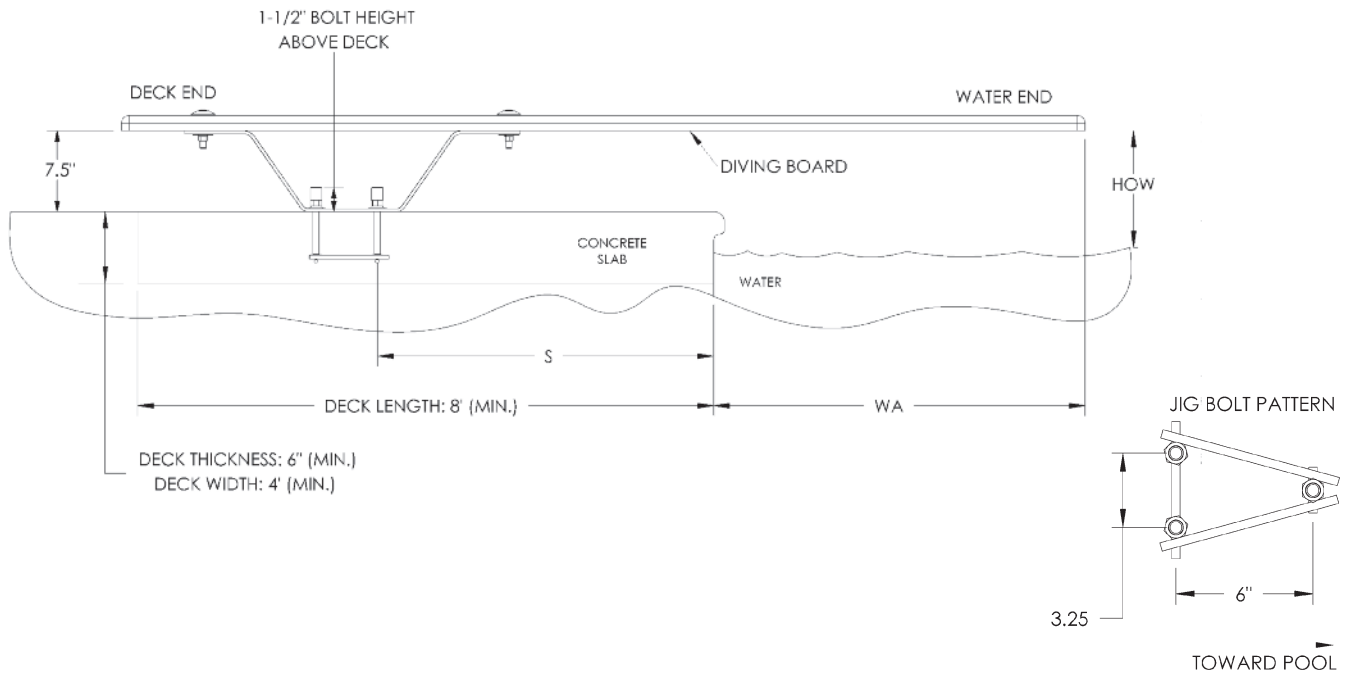

IMPORTANT:

THESE DIMENSIONS ARE ACCURATE ONLY FOR VERTICAL POOL WALLS, **TYPICALLY GUNITE CONSTRUCTION**, WITH LESS THAN A 3' RADIUS TO THE POOL FLOOR.

DUE TO THE VARYING SIZES OF OTHER POOLS, **TYPICALLY VINYL LINER CONSTRUCTION**, PLEASE CONTACT CUSTOMER SERVICE FOR PROPER JIG PLACEMENT.

1-800-737-5386

DURO-SPRING PART #	NOMINAL BOARD LENGTH	ANSI/POOL TYPE	DISTANCE FROM WATER'S EDGE TO FORWARD JIG BOLT (S)	DISTANCE FROM END OF BOARD TO FORWARD JIG BOLT	MIN. OVERHANG PLUS OR MINUS 3" (WA)	MAX HEIGHT OF BOARD ABOVE WATER (HOW)
DSS6	6'	I	27"	45"	18"	20"
DSS6	6'	II	27"	45"	18"	20"
DSS6	6'	III	21"	45"	24"	26"
DSS6	6'	IV	15"	45"	30"	30"
DSS6	6'	V	9"	45"	36"	40"
DSS8	8'	I	NOT ALLOWED			
DSS8	8'	II	NOT ALLOWED			
DSS8	8'	III	39.75"	63.75"	24"	26"
DSS8	8'	IV	33.75"	63.75"	30"	30"
DSS8	8'	V	27.75"	63.75"	36"	40"

DURO-SPRING BASE (DSS6):

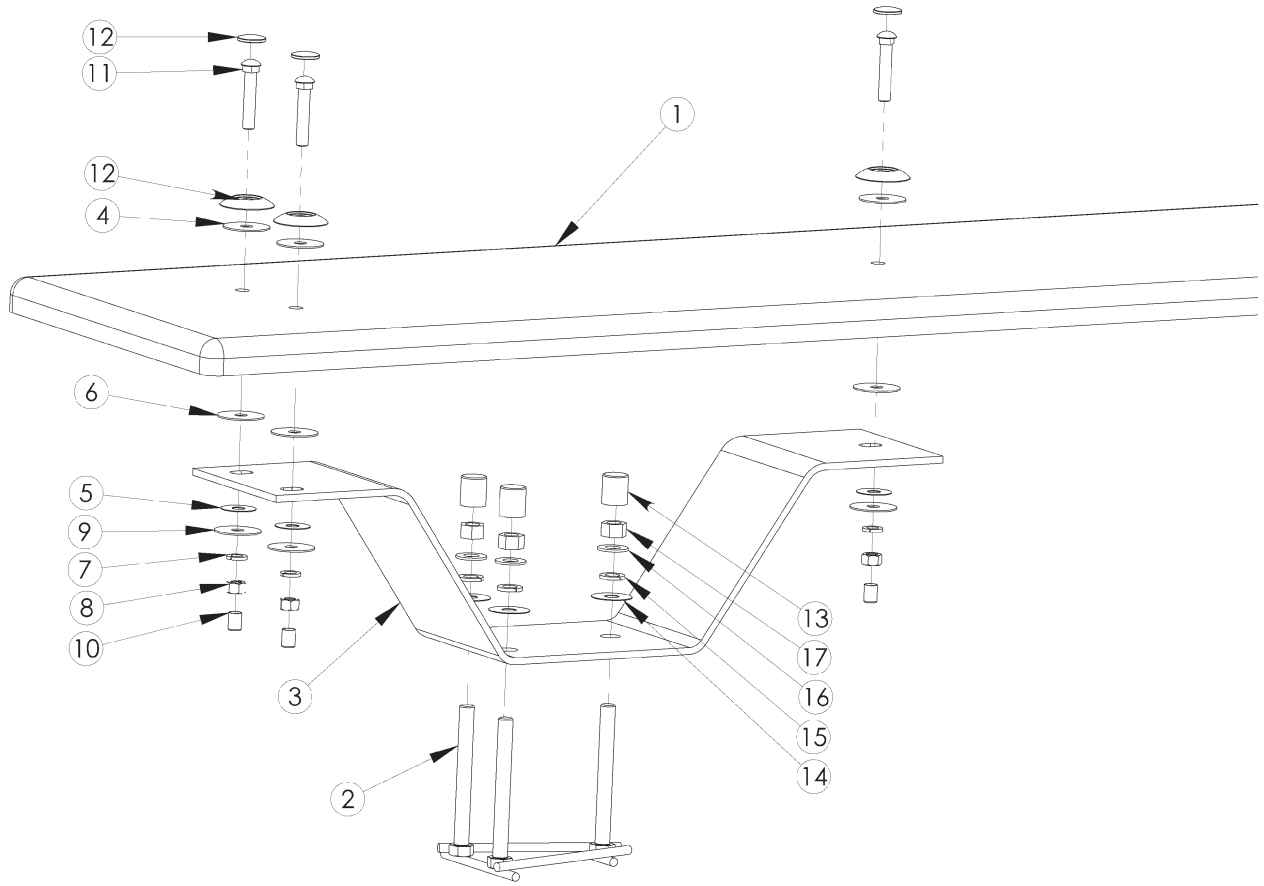

DRAWING REPRESENTS THE FOLLOWING PART NUMBERS:

DSS6 (shown)
DSS8

ITEM #	COMPONENT	DESCRIPTION	KITS – QTY. COUNTS		
			DS-M	DS-BK	DURO-SPRING
1	DS6WW	6' Duro-Spring White w/ White Top Tread & Hdw Kit			1
2	DS-J	Duro-Spring Mounting Jig			1
3	DSS6	6' Duro-Spring Jump Stand			1
4	H-1/2 BLK WASH	1/2 x 2" Black Rubber Washer	3		
5	H-1/2 NYLON WAS	1/2" Flat Washer Nylon	3		
6	H-1/2 RED WASH	1/2 x 2" Red Rubber Washer	3		
7	H-SS 1/2 LOC WA	1/2 Lock Washer S.S.	3		
8	H-SS 1/2 H NUT	1/2"- 13 Hex Finish Nut S.S.	3		
9	H-SS 1/2 F WAS	1/2 USS Flat Washer S.S.	3		
10	H-1-1/2 WHT CAP	.750 x 1-1/2 White UV Nut Cap	3		
11	H-SS 3 C BOLT	1/2-13 x 3" Carriage Bolt S.S.	3		
12	H-WHT WAS/CAP	I.F. White Washer/Cap	3		
13	H-1x1-1/2 W CAP	1" I.D.x 1-1/2" Long White UV		3	
14	H-5/8 RD WASH	5/8 x 1-3/4" Round Nylon Washer		3	
15	H-SS 5/8 F WASH	5/8" USS Flat Washer S.S.		3	
16	H-SS 5/8 LOC WAS	5/8 Split Lock Washer S.S.		3	
17	H-SS 5/8 H NUT	5/8-11 Hex Finish Nut S.S.		3	
18*	H-ANTI-SEIZE	Packet of Anti Seize Lubricant (not shown)	1		

DS-M:
Board to Base Mounting Hardware

DS-BK:
Base to Jig Mounting Hardware

* not pictured

NOTES:
DSS6 diving board shown in exploded view for illustration purposes. Must be purchased separately.

Check your local electrical code requirements for bonding requirements.