

U-STANDARDS BASE:



FEATURES:

- Passive Base - Spring Feature is Derived from Board Only
- Available in 6 Powder Coated Finishes
- Available in 3 Thermo Plastic Coated Finishes
- Weight Limit = 250 lbs.
- Available in 6', 8', 10', or 12' Set-Ups
- 2 Hole Drill Pattern 12" on center
- Refer to Board Chart on Pg. 7

- Part # DBU12049 (12" U style)
 Part # DBU14049 (14" U style; Also available in .065" #DBU14065)
 Part # DBU18049 (18" U style; Also available in .065" #DBU18065)
 Part # DBU24049 (24" U style; Also available in .065" #DBU24065)

U-Stand sets 4" into the deck.

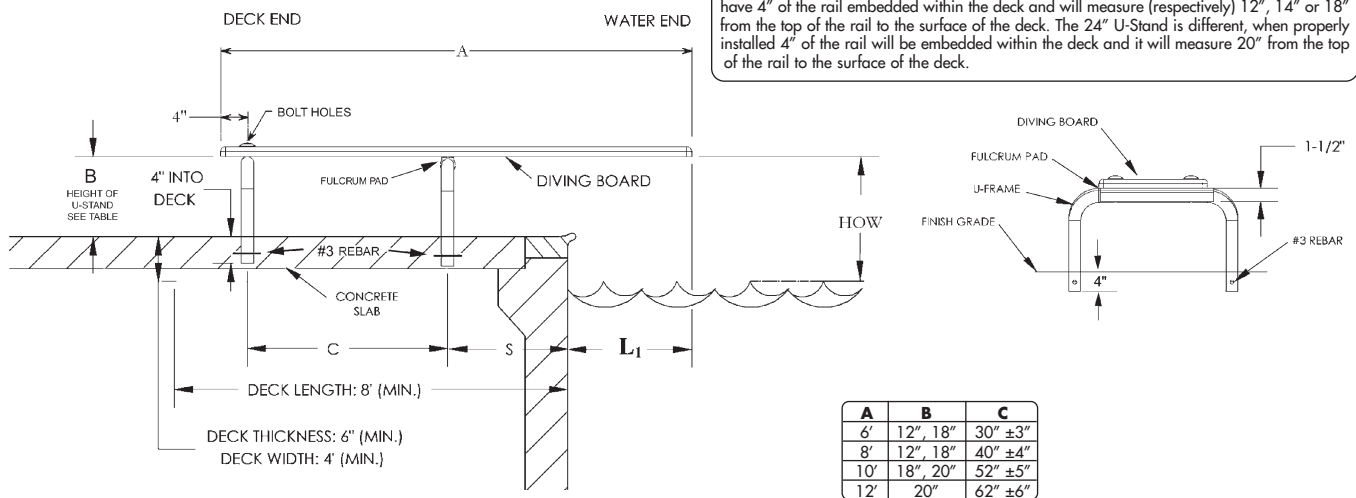

IMPORTANT NOTICE: When properly installed, Inter-Fab's 12", 14", and 18" U-Stands will have 4" of the rail embedded within the deck and will measure (respectively) 12", 14" or 18" from the top of the rail to the surface of the deck. The 24" U-Stand is different, when properly installed 4" of the rail will be embedded within the deck and it will measure 20" from the top of the rail to the surface of the deck.

A	B	C
6'	12", 18"	30" ±3"
8'	12", 18"	40" ±4"
10'	18", 20"	52" ±5"
12'	20"	62" ±6"

IMPORTANT: THESE DIMENSIONS ARE ACCURATE ONLY FOR VERTICAL POOL WALLS, **TYPICALLY GUNITE CONSTRUCTION**, WITH LESS THAN A 3' RADIUS TO THE POOL FLOOR. DUE TO THE VARYING SIZES OF OTHER POOLS, **TYPICALLY VINYL LINER CONSTRUCTION**, PLEASE CONTACT CUSTOMER SERVICE FOR PROPER PLACEMENT. **1-800-737-5386**

U-STANDARDS PART # (Note: there are several sizes available for each pool type)	NOMINAL BOARD LENGTH	ANSI/POOL TYPE	DISTANCE FROM WATER'S EDGE TO FORWARD U-STAND (S)	DISTANCE FROM END OF BOARD TO FORWARD U-STAND	MIN. OVERHANG PLUS OR MINUS 3" (WA)	MAX HEIGHT OF BOARD ABOVE WATER (HOW)
DBU12049	6'	I	18.25"	36.25"	18"	20"
DBU12049	6'	II	18.25"	36.25"	18"	20"
DBU12049 or DBU14049 or DBU18049	6'	III	12.25"	36.25"	24"	26"
DBU12049 or DBU14049 or DBU18049	6'	IV	6.25"	36.25"	30"	30"
DBU12049 or DBU14049 or DBU18049	6'	V	Not recommended. Call customer service for more information.			
	8'	I	NOT ALLOWED			
DBU12049	8'	II	32"	50"	18"	20"
DBU12049 or DBU14049 or DBU18049	8'	III	26"	50"	24"	26"
DBU12049 or DBU14049 or DBU18049	8'	IV	20"	50"	30"	30"
DBU12049 or DBU14049 or DBU18049	8'	V	14"	50"	36"	40"
	10'	I	NOT ALLOWED			
	10'	II	NOT ALLOWED			
DBU18049 or DBU24049	10'	III	37.5"	61.5"	24"	26"
DBU18049 or DBU24049	10'	IV	31.5"	61.5"	30"	30"
DBU18049 or DBU24049	10'	V	25.5"	61.5"	36"	40"
	12'	I	NOT ALLOWED			
	12'	II	NOT ALLOWED			
	12'	III	NOT ALLOWED			
	12'	IV	NOT ALLOWED			
DBU24	12'	V	40"	76"	36"	40"

U-STANDARDS BASE (DBU12049):

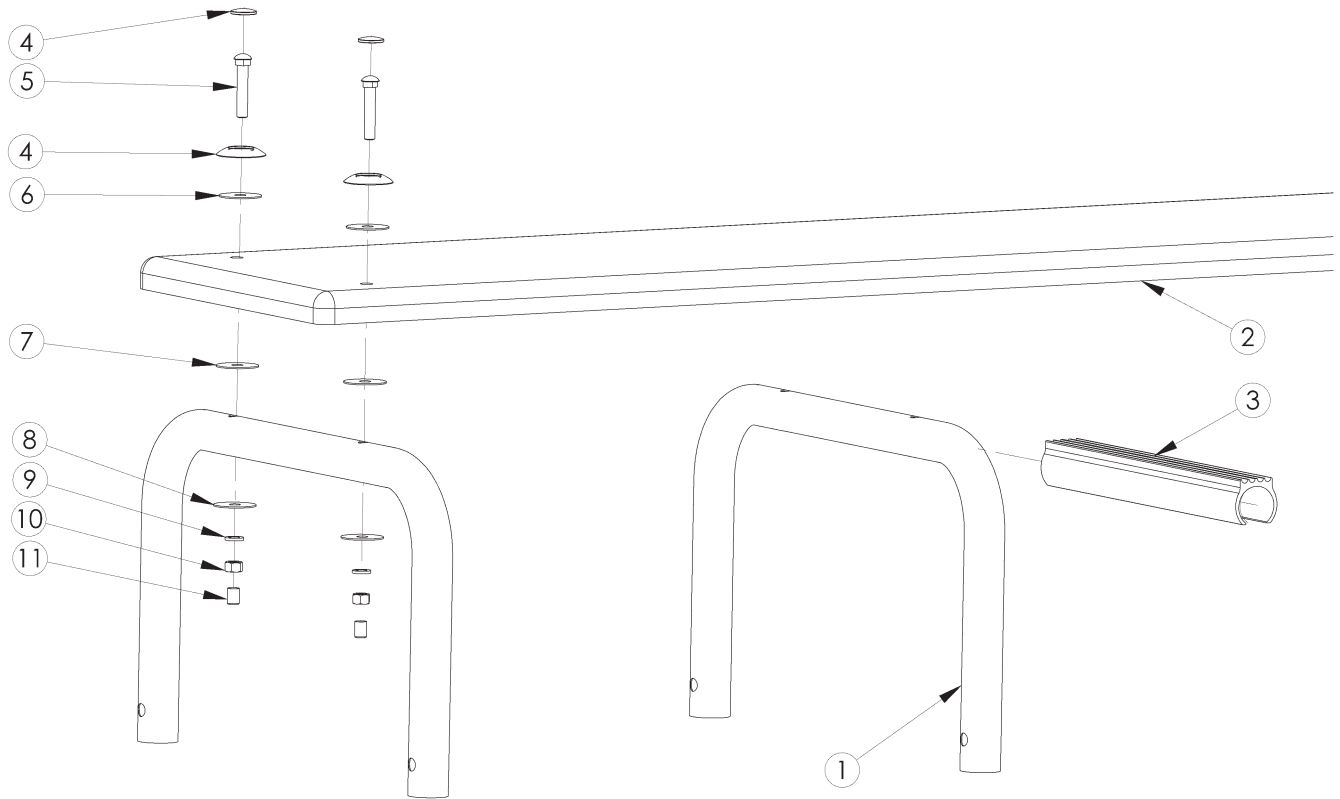

DRAWING REPRESENTS THE FOLLOWING PART NUMBERS:	
	DBU12049 (shown)
	DBU14049
	DBU14065
	DBU18049
	DBU18065
	DBU24049
	DBU24065

Check your local electrical code requirements for bonding requirements.

ITEM #	COMPONENT	DESCRIPTION	KITS - QTY.	
			DB-TB-M	U-STAND
1	DBU12049	12" U Style Diving Standards		2
2	DB6WW	6' Duro-Beam White w/White Top Tread & Hdw Kit		1
3	FC	Fulcrum Cover For U-Standard Base		1
4	H-WHT WAS/CAP	I.F. White Washer/Cap	2	
5	H-SS 5 C BOLT	1/2-13 x 5 Carriage Bolt S.S.	2	
6	H-1/2 BLK WASH	1/2 x 2" Black Rubber Washer	2	
7	H-1/2 RED WASH	1/2 x 2" Red Rubber Washer	2	
8	H-SS 1/2 F WAS	1/2 USS Flat Washer S.S.	2	
9	H-SS 1/2 LOC WA	1/2 Lock Washer S.S.	2	
10	H-SS 1/2 H NUT	1/2"- 13 Hex Finish Nut S.S.	2	
11	H-1-1/2 WHT CAP	.750 x 1-1/2 White UV Nut Cap	2	
12*	H-ANTI-SEIZE	Packet of Anti Seize Lubricant (not shown)	1	

* not pictured

NOTES:

DB6WW diving board shown in exploded view for illustration purposes. Must be purchased separately. Other diving board options available.

DB-TB-M:
Board to Base Mounting Hardware