

## AUSTRALIAN RETURN FITTING WITH ADJUSTABLE EYEBALL 1" KNOCK-IN

### FEATURES

Knocks into 1" pipe, no glue necessary

Self-leveling for out-of-square pipes

Flange camouflages pipe and surface construction variations

Adjustable eyeball available in three orifice sizes (1", 3/4", 1/2")

Manufactured from engineered polymer UV-resistant polypropylene material







500 per case

Additional orifice size suffix: 3/4"-B, 1/2"-C (i.e. 501B = white 3/4" orifice)



Part # 5xx

### STANDARD COLORS

	101		104
	102		105
	103		108

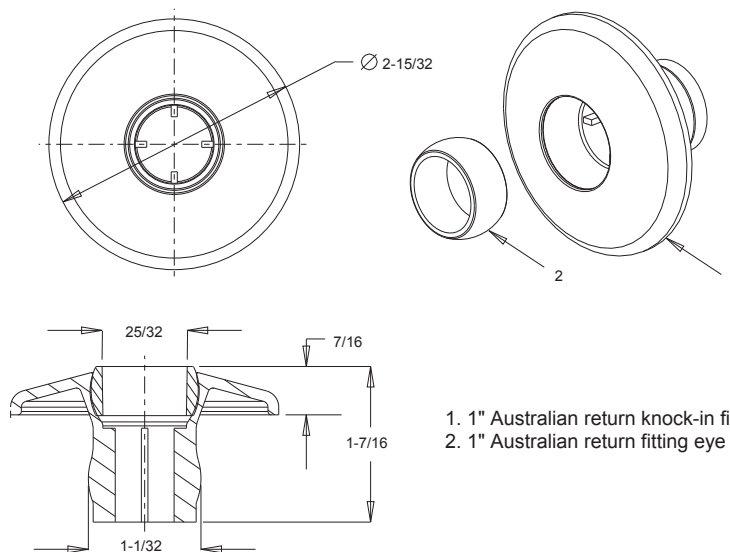

1. 1" Australian return knock-in fitting
2. 1" Australian return fitting eye ball