

Waterway OASIS Pool Control Wi-Fi Operation Instructions

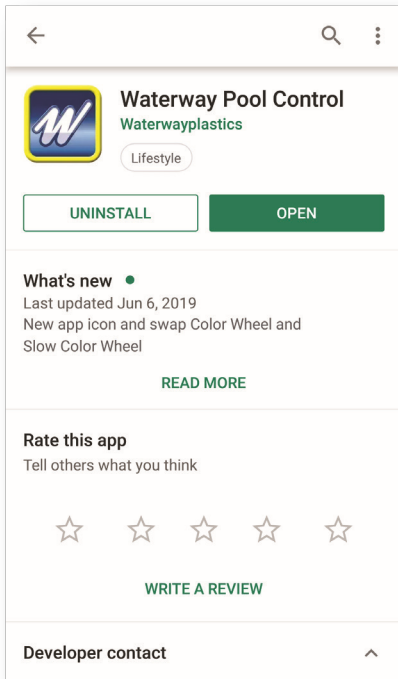

1

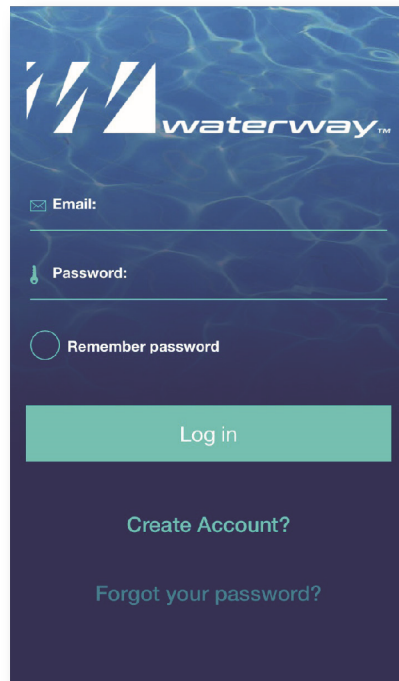

2

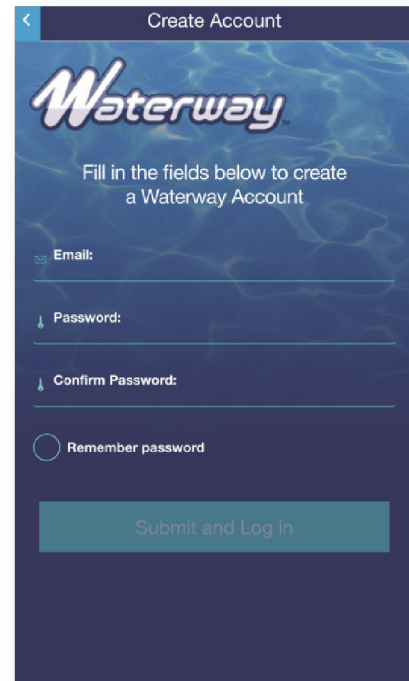

3

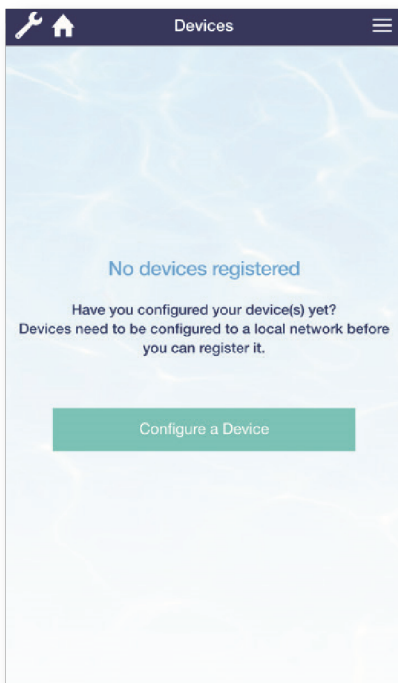

4

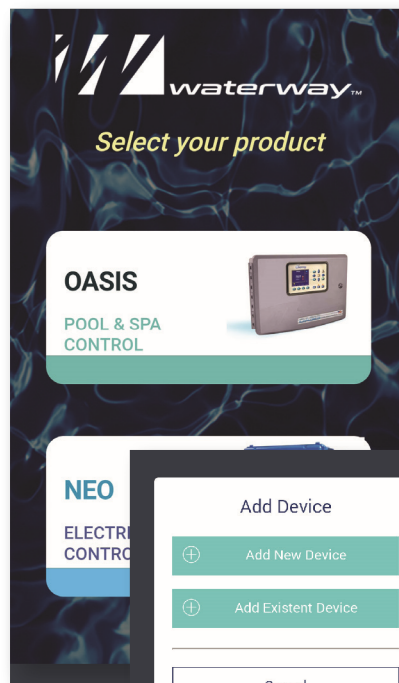

5

For Homeowner/Installer

1. Download and install the app from the App Store or Google Play.
Note: Any users who want to control this same pool need to login with this same email address and password.
2. Select **Create Account**.
3. Enter your email address, password, confirm your password and select **Submit**.
4. Select on **Configure Device**.
5. Select **OASIS**, then select **Add New Device**.

NOTE: If a new network has recently been installed, delete the current Device and reconfigure using 'Add New Device' to connect to the new network.

continued...

Waterway OASIS Pool Control Wi-Fi Operation Instructions

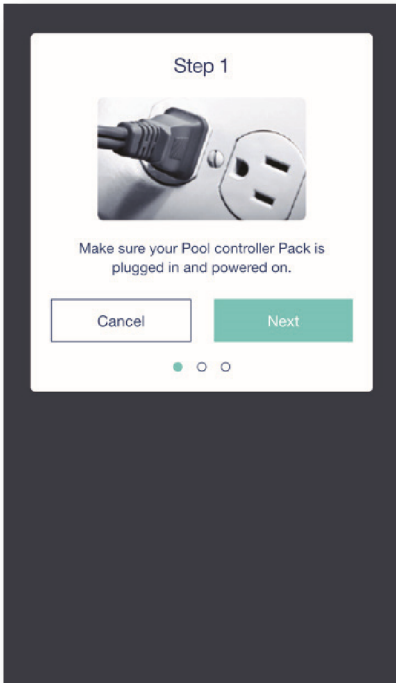

6

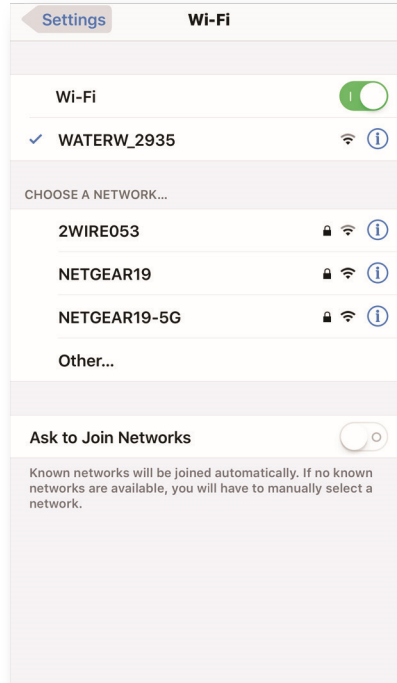

7

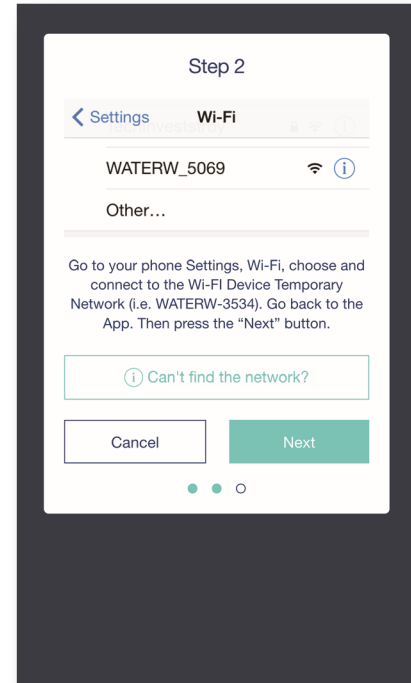

8

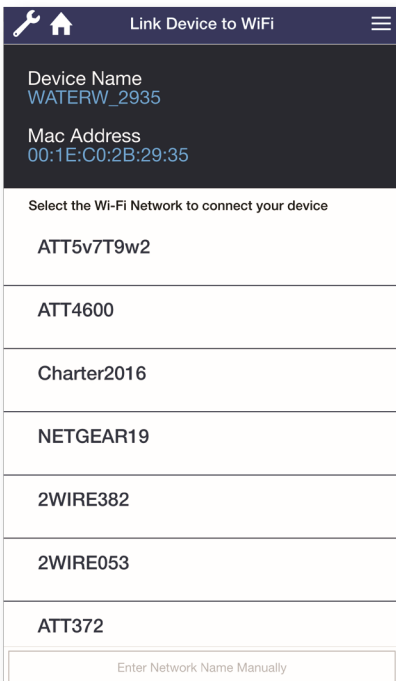

9

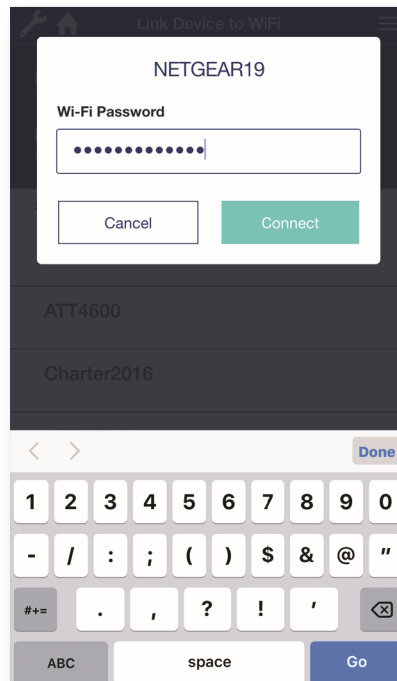

10

6. Make sure your Pool Control is powered on and select **Next**.
7. Go to your phone setting, **Wi-Fi**, and connect to the **Waterway Wi-Fi network**. For example: 'WATERW-XXXX'.
8. Go back to the app, select **Next**.
9. Select your 2.4 Ghz home network from the list (if your network name is not listed, it can be entered manually).
10. Enter your home network password and select **Connect**.

Waterway OASIS Pool Control Wi-Fi Operation Instructions

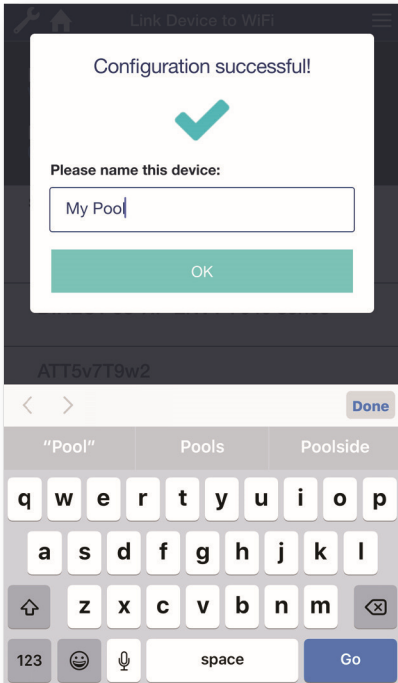

11

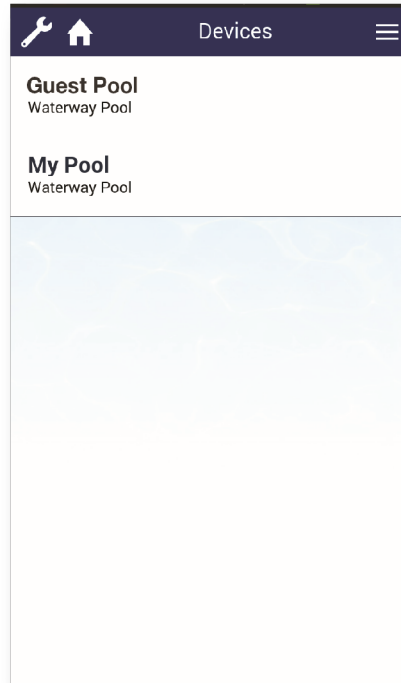

12

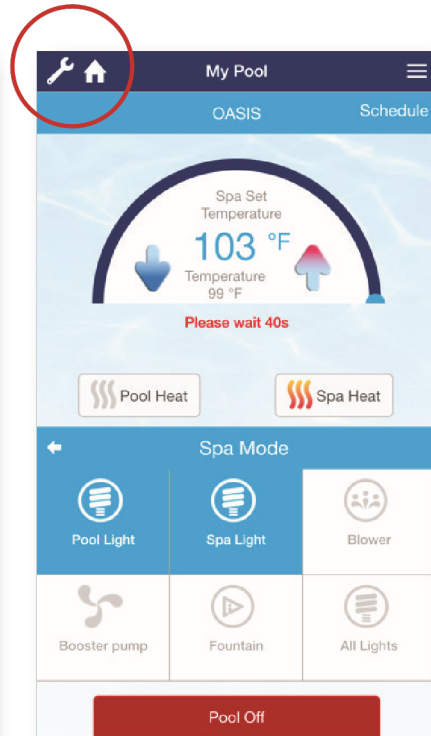

13

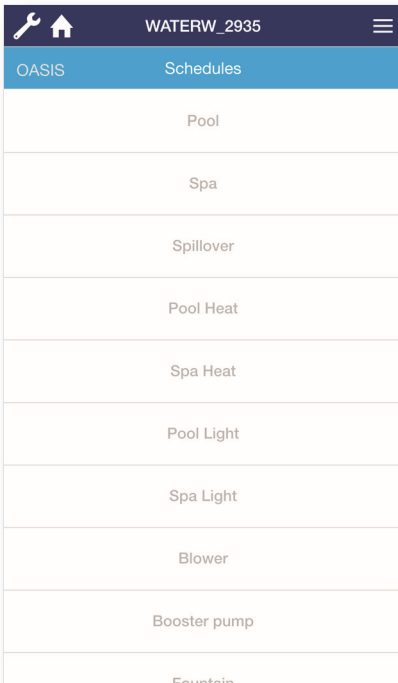

14

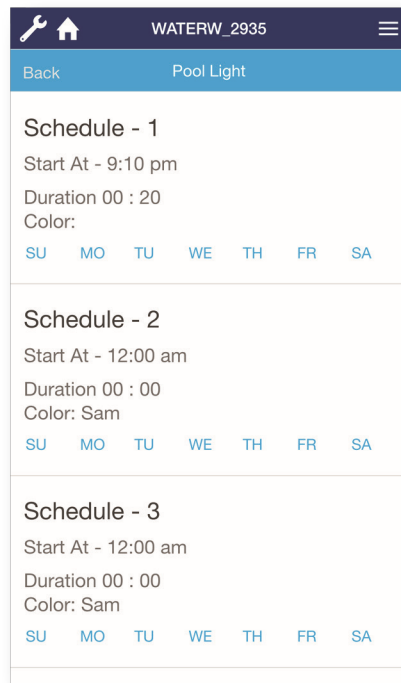

15

11. Then the device will configure and connect to your 2.4 Ghz home Wi-Fi network and the Web. Type a name for the device and select **OK**.

12. Select a device from the list, for example: **My Pool**

13. Now you can control your pool from anywhere in the world using your smart phone. You can set the temperature, heating operation mode and turn the light ON/OFF. In order to access the application menu select the **wrench icon** in top left corner. 

14. To access Scheduling select **Schedules**. Select pool function that you would like to schedule, for example: **Pool Light**.

15. You may program up to 4 schedules for selected functions.

continued...

Waterway OASIS Pool Control Wi-Fi Operation Instructions

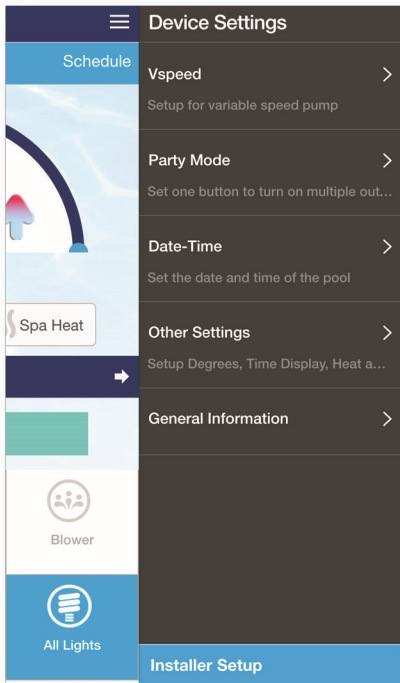

16

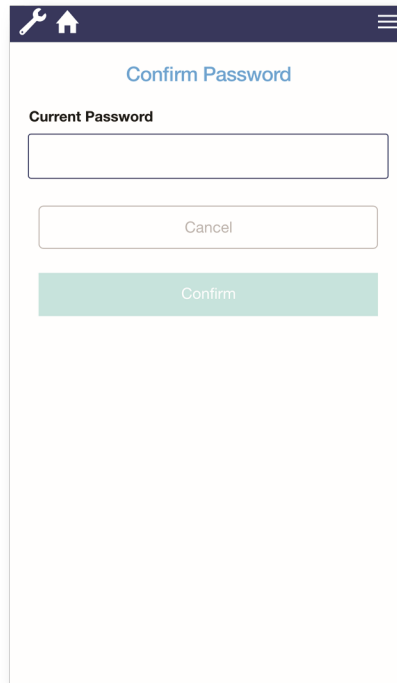

17

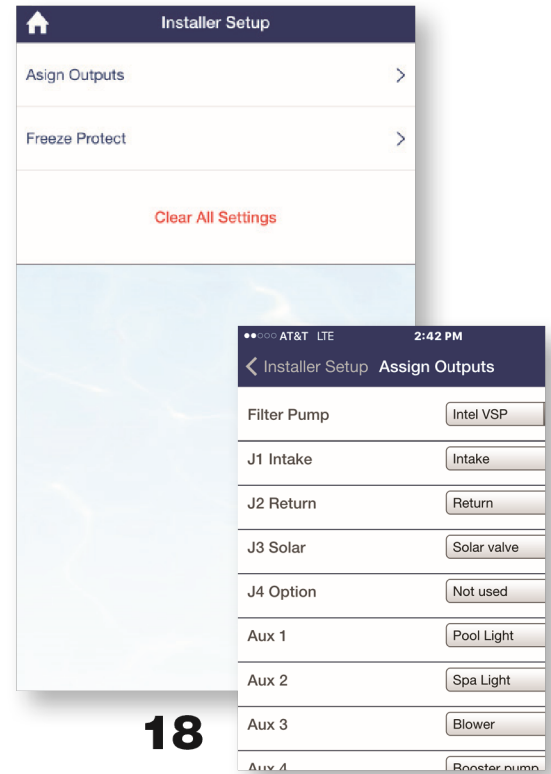

18

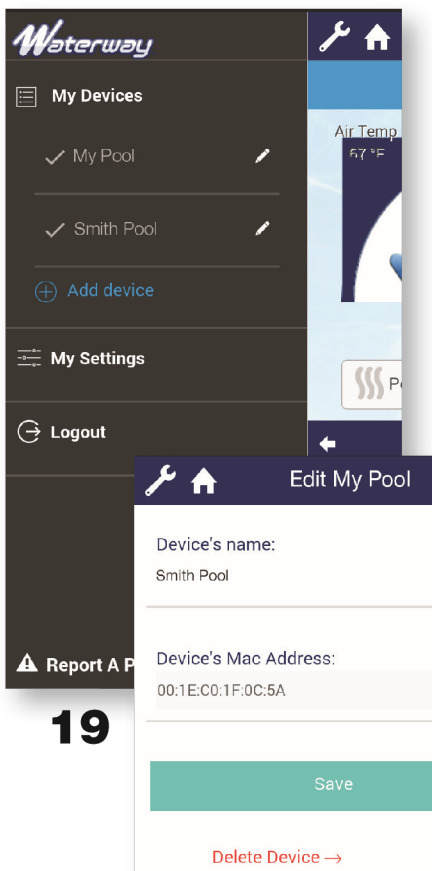

19

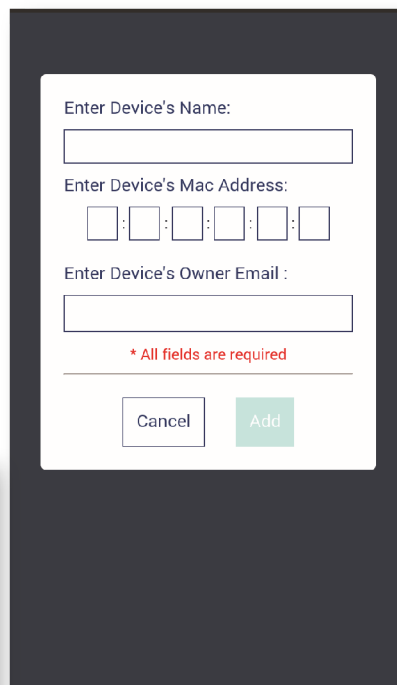

20

For the Installer

- To access device settings select the **menu icon** in the top right corner. To access **Installer Setup** select the icon  at the bottom of the screen.
- Enter password: **waterway2016** in the **Current Password** box.
- Installer Setup.** Select **Assign Output** to configure output.

To Monitor Client Pool

- Start the Waterway app from the installer phone. Select the **wrench icon**. Select **Add Device** and **Add Existent Device** (See #5). You will need the MAC Address of the client pool. From the client mobile app select the **pencil icon**  next to the selected device to see MAC address.
- Enter the new device's name, the MAC address and Device Owner Email. Select **Add**.



2200 East Sturgis Road, Oxnard, CA 93030 • Phone 805.981.0262 • Fax 805.981.9403
www.waterwayplastics.com • waterway@waterwayplastics.com