

Owners Manual



⚠ WARNING

This equipment must be installed and serviced by a qualified technician. Improper installation can create electrical hazards which could result in property damage, serious injury or death. Improper installation will void the warranty.



Notice to Installer

This manual contains important information about the installation, operation and safe use of this product. Once the product has been installed **this manual must be given to the owner/ operator of this equipment.**

Table of **Contents**

WATERCO TRIMLINE CARTRIDGE FILTERS ----- 01
INSTALLATION ----- 01
START UP PROCEDURE ----- 02
MAINTENANCE ----- 02
CLEANING ----- 03
FLOW DIAGRAM ----- 03
TROUBLESHOOTING GUIDE ----- 04
SPARE PART LIST ----- 05

WATERCO TRIMLINE CARTRIDGE FILTERS

The Waterco Trimline Cartridge Filters do not require a media such as sand or D.E powder to operate, instead the filter contains a cartridge element which is easily removed to clean or replace.

All Trimline Cartridge Filters are ideal for use in swimming pool and spas. The Trimline Cartridge Filters is also ideal for use when backwashing is impractical.

INSTALLATION

Remove the cartridge filter from the carton and install the pressure gauge into the threaded port on the filter lid provided. Using Teflon, wrap once around the brass pressure gauge thread in a clockwise direction and screw into the threaded lid port.

⚠ CAUTION

Hand tighten the pressure gauge into the lid only for sealing.

Place the Trimline Cartridge Filter into the required position. Ensure that it is on a flat level surface and is aligned with the pump.

The Trimline Cartridge Filter has marked inlet and outlet ports.

Ensure that the pipe extending from the pump outlet is connected to the Trimline Cartridge Filter marked inlet.

Screw the supplied half barrel unions and tails onto the inlet and outlet before gluing the UPVC piping onto the filter.

⚠ CAUTION

Use only the recommended glue for the connection pipes and fittings.

Cut and fit the pipe and fittings onto the Trimline Cartridge Filter and the pump. **REFER** to Pump Installation Manual for correct pump plumbing procedures.

It is **best practice** to fit all the cut pipe and fittings onto the filtration system **before** gluing; this will ensure that the system has **been aligned** correctly.

Glue the pipe and fittings onto the pump, filter and pool return lines and **allow** the glue to set for **24 hours** before commissioning the system.

It is **advisable** to bolt the filter down to the floor where the filter is located. This will prevent the filtration plumbing from **working with dyna bolts loose** with the expansion and operation of the filter during regular cycles. It will also help to prevent unnecessary stress on the plumbing while unscrewing the filter lid lock ring.

START UP PROCEDURE

The Trimline Cartridge Filter is a simple and effective unit which will provide years of trouble free service if the following maintenance procedures are maintained.

To start up the filtration system either from new or after cleaning is exactly the same.

1. Ensure that all valves installed before or after the filter are open.
2. Ensure that the filter is plumbed correctly. Pipe from pump outlet must be attached to the filter inlet port.
3. Loosen the air bleed screw on top of the filter lid.
4. Prime the swimming pool pump.
(Refer to the pump installation and operation manual).
5. Turn on the swimming pool pump and allow the pump to run until all the air has been expelled from the filter vessel. Water will run from the air bleed screw.
6. Tighten the air bleed screw.
7. The filter is primed and ready for operation.

In some cases this may be required to be done a few times before the unit will remain primed and be fully operational.

⚠ CAUTION

Do not stand over the lid whilst adjusting the air bleed to purge the system of air. Injury may occur if air bleed valve comes loose.

MAINTENANCE

To ensure that you get maximum life from your Trimline Cartridge Filter you will need to maintain the filter regularly.

When the filter is first started and has been purged of air, note the pressure on the pressure gauge. This is what is known as the filter operation pressure and it is important that you be aware of this figure.

All filtration systems will operate at different pressures depending on the pool hydraulics.

You will need to clean the filter cartridge (element) once the pressure gauge has reached 50 kPa above the operating pressure.

The Trimline Cartridge Filter has a maximum operating pressure of 350 kPa (for moulded PP housing).

EXAMPLE: Filter operates normally at 60 kPa needs to be cleaned at 110 kPa.

CLEANING

1. Unscrew the filter's lid lock ring and remove the lid off the filter tank. In some cases where pressure has built up you will need to release air from the tank using the air bleed screw before removing the lid.
2. Remove the cartridge element from the filter tank.
3. Using a garden type hose clean the surface of the pleated elements. Make sure to clean between the pleats.
4. Place the cartridge back into the filter tank ensuring that it is seated correctly.
5. Place the lid onto the tank and screw the lock ring down.
6. Ensure to place the lid o-ring on the lid before you start up the filter.
7. Refer to the start up procedure to re commence operation.

⚠ CAUTION

Do not over tighten the lid lock ring.

It is suggested that you should periodically remove the cartridge filter element and soak it over night in a suitable cartridge cleaning compound. This will remove any debris not removed by hosing down of the element.

Some swimming pool stores offer a cartridge cleaning service using the correct solutions otherwise you may wish to use Waterco Cartridge cleaning solution. Directions of use are on the product.

The cleaning time depends upon the swimming pool condition and use. Intervals between cleaning the element should not exceed a period of 12 months in any instance.

FLOW DIAGRAM



TROUBLESHOOTING GUIDE

SYMPTOMS	POSSIBLE PROBLEMS/ SOLUTIONS
Water is not clear	Insufficient disinfectant level.
	Incorrect pool chemistry.
	Heavy bathing and/ or dirt loads.
	Incorrect flow.
	Insufficient running times. (Increase pump run time.)
	Filter is dirty. (Clean per instructions.)
	Hole in filter element.
Low water flow	Check strainer baskets for debris.
	Check for air leaks on suction side.
	Check for restrictions or blockage in either suction or return lines.
	Filter needs to be cleaned or replaced.
	Pool water level too low.
	Pump not primed.
	Pump impeller vanes blocked.
	Strainer baskets not being used and/ or not being cleaned regularly.
Pump operating under speed (low voltage).	
Short filter cycles	Presence of algae, check disinfectant content.
	Check pH and total alkalinity.
	Pump output exceeds design flow rate of filter, check pump performance.
	Ineffective cleaning, check conditions, replace filter cartridge.
High pressure on start-up	Small eyeball fitting in Pool/ Spa.
	Partially closed valve on return line.
	Too large of pump, check selection.
Dirt returns to pool	Hole in filter cartridge, replace filter cartridge.
	Worn o-ring seal inside filter, replace o-ring.

HEAD LOSS CURVE : TRIMLINE CARTRIDGE FILTER

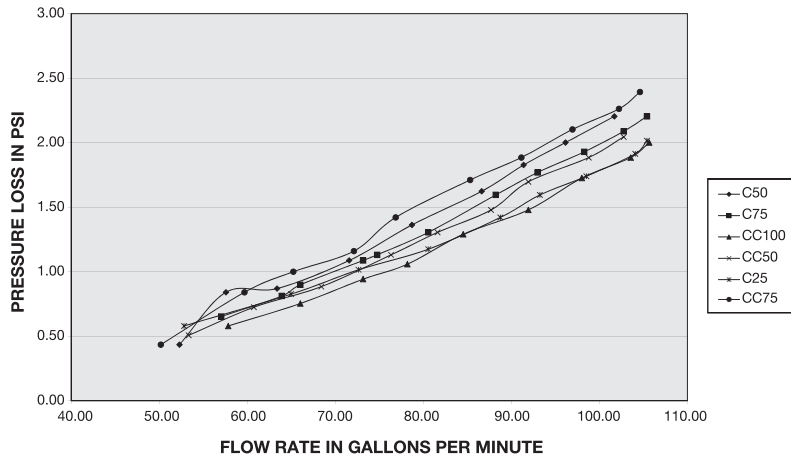

SPARE PART LIST

ITEM	QTY	NAME	PART/DRG NO.	DESCRIPTION
1	2	Air Relief Valve With O-ring	620221	-
2	1	TCF Lock Ring	62024BLK	-
3	1	Lid	620251-0501	-
4	1	O-ring	62026	-
5	1	Air Bleed	W02547	C25
	1		W02548	CC50
	1		W02549	C50 , CC75
	1		W02550	C75 , CC100
6	1	Caetridge Element	62040	C25
	1		62042	C50
	1		62044	C75
	1		62048	CC50
	1		62049	C75
	1		62050	CC100
7	1	Body	W02541PEW	C25
	1		W02542PEW	CC50
	1		W02543PEW	C50 , CC75
	1		W02544PEW	C75 , CC100
	1		W02541S	C25
	1		W02542S	CC50
	1		W02543S	C50 , CC75
1	W02544S	C75 , CC100		
8	2	O-ring	W02280	-
9	2	Tail End	W2648BLK	50 X 40
10	2	Lock Nut	W02647BLK	-

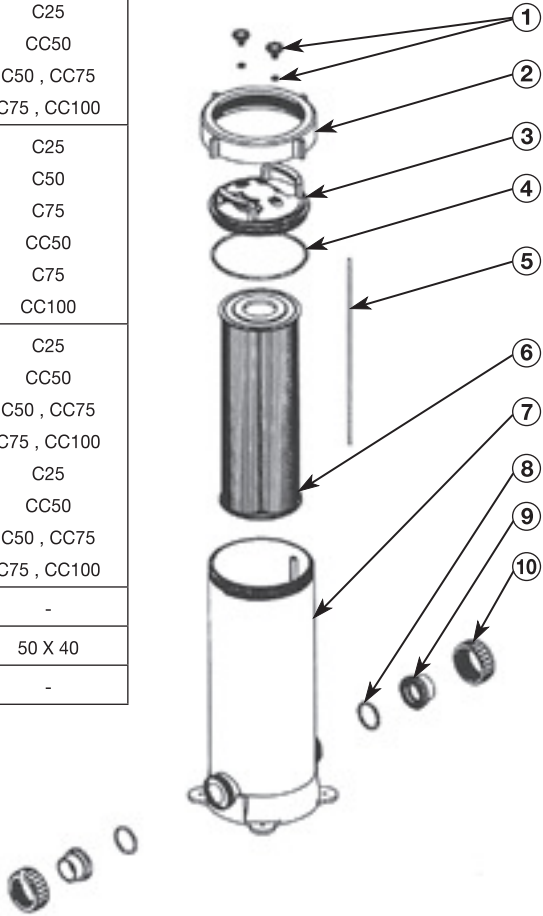

OFFICES - AUSTRALIA

NSW - SYDNEY
(HEAD OFFICE)
Tel: +61 2 9898 8600

QLD - BRISBANE
Tel: +61 7 3299 9900

VIC/TAS - MELBOURNE
Tel: +61 3 9764 1211

WA - PERTH
Tel: +61 8 9273 1900

SA/NT - ADELAIDE
Tel: +61 8 8244 6000

ACT DISTRIBUTION
Tel: +61 2 6280 6476

OFFICES - OVERSEAS

WATERCO (EUROPE) LIMITED
Sittingbourne, Kent, UK
Tel: +44 (0) 1795 521 733

WATERCO FRANCE
Saint Priest, France
Tel: +33 4 72 79 33 30

WATERCO (USA) INC
Augusta, Georgia, USA
Tel: +1 706 793 7291

WATERCO CANADA
Longueuil, Quebec, Canada
Tel: +1 450 748 1421

WATERCO (NZ) LIMITED
Auckland, New Zealand
Tel: +64 9 525 7570

WATERCO © LIMITED
Guangzhou, China
Tel: +86 20 3222 2180

WATERCO (FAR EAST) SDN BHD
Selangor, Malaysia
Tel: +60 3 6145 6000

PT WATERCO INDONESIA
Jakarta, Indonesia
Tel: +62 21 4585 1481

WATERCO SINGAPORE INTL PTE LTD
Nehsons Building, Singapore
Tel: +65 6344 2378

WATERCO

Waterco Limited ABN 62 002 070 733

