

# Pool Breakdown

## St. Kitts 24' Round 54"

### NB19724

<b><u>FEATURES:</u></b> Round Size: 24' Depth: 54" 60 Year Warranty	<b><u>STRUCTURE COMPOSITION:</u></b> Resin top rail Resin verticals Steel bottom rails Steel stabilizers Steel bottom plates Steel vertical end caps Resin top connector & skirt
---	---

	Qty	Carton #	Carton Content Description
<input type="checkbox"/>	1	<b>5-9924-827 (PC2066)</b>	ST. KITTS – STEEL FRAME PACK
<input type="checkbox"/>	1	<b>5-9816-726 (PC2057)</b>	ST. KITTS – TOP RAIL PACK
<input type="checkbox"/>	1	<b>5-9999-116 (PC2076)</b>	ST. KITTS – TOP CONNECTOR PACK
<input type="checkbox"/>	1	<b>5-9116-826 (PC2040)</b>	ST. KITTS – VERTICAL SKIRT PACK
<input type="checkbox"/>	1	<b>5-9716-726 (PC2048)</b>	ST. KITTS – VERTICAL PACK
<input type="checkbox"/>	1	<b>5-0569-024 (PC2020)</b>	ST. KITTS – SIDEWALL CARTON
<input type="checkbox"/>	1	<b>BS 04243 (NA324)</b>	ST. KITTS – SKIMMER ASSEMBLY

# Carton Breakdown

## St. Kitts 24' Round 54"

### NB19724

Key	Qty	Item #	Mfg Part #	Part Description	
FRAME CARTON # 5-9924-827 (PC2066)					
<input type="checkbox"/>	1	11	NPB5239	583-1005	STABILIZER RAIL, LARGE DIA.
<input type="checkbox"/>	2	11	NBP5240	583-1004	STABILIZER RAIL, SMALL DIA.
<input type="checkbox"/>	3	16	NBP5252	580-1343	BOTTOM CONNECTOR
<input type="checkbox"/>	4	16	NBP5253	580-2375	VERTICAL END CAP
<input type="checkbox"/>	5	40	NBP5200	545-1001	PLASTIC COPING, 24"
<input type="checkbox"/>	6	16	NBP5243	589-1222	BOTTOM RAIL
<input type="checkbox"/>	11	160	NBP5207	330-1127	SHEET METAL SCREW, #10 x ½"
<input type="checkbox"/>	12	16	NBP5256	580-1460	VERTICAL TAB
<input type="checkbox"/>	13	16	NBP5257	330-1075	#14 x ½" SCREW
<input type="checkbox"/>	---	1	-----	573-3772	POOL PARTS LIST
<input type="checkbox"/>	---	1	-----	573-3774	POOL INSTALLATION INSTRUCTIONS
<input type="checkbox"/>	---	1	-----	-----	WARRANTY CARD
<input type="checkbox"/>	---	1	-----	573-3169	"SAFETY FIRST" BOOKLET
TOP RAIL CARTON # 5-9816-726 (PC2057)					
<input type="checkbox"/>	14	16	NBP5258	587-1741	TOP RAIL
TOP CONNECTOR CARTON # 5-9999-116 (PC2076)					
<input type="checkbox"/>	15	16	NBP5259	340-2746	TOP CONNECTOR
VERTICAL SKIRT CARTON # 5-9116-826 (PC2040)					
<input type="checkbox"/>	16	16	NBP5260	340-2747	VERTICAL SKIRT
<input type="checkbox"/>	16a	16	NBP5218	510-1001	#10 x 1-½" SCREW

# Carton Breakdown

## St. Kitts 24' Round 54"

### NB19724

	Key	Qty	Item #	Mfg Part #	Part Description
<b>VERTICAL CARTON # 5-9716-726 (PC2048)</b>					
<input type="checkbox"/>	17	16	NBP5261	341-1508	VERTICAL
<b>SIDEWALL CARTON # 5-0569-024 (PC2020)</b>					
<input type="checkbox"/>	28	1	PC2020	5-0569-024	SIDEWALL
<input type="checkbox"/>	29	1	NBP5212	535-1442	PROTECTIVE STRIP
<input type="checkbox"/>	30	27	NBP5213	321-1029	1/4-20 HEX FLANGE LOCKNUT
<input type="checkbox"/>	31	27	NBP5213	330-1280	1/4-20 x 1/2" GRADE 5 HEX HEAD BOLT
<input type="checkbox"/>	---	1	-----	573-3498	SAFETY VIDEO
<input type="checkbox"/>	---	1	-----	560-1055	WARNING SIGN DECAL
<b>SKIMMER CARTON # BS 04243 (NA324)</b>					
<input type="checkbox"/>	---	1	NA324	BS 04243	WIDE MOUTH SKIMMER & RETURN INLET

# St. Kitts 24' Round 54"

## NB19724

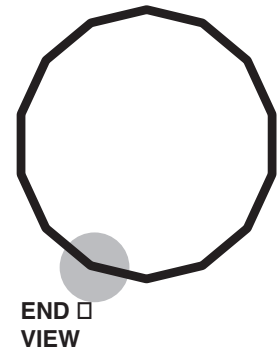
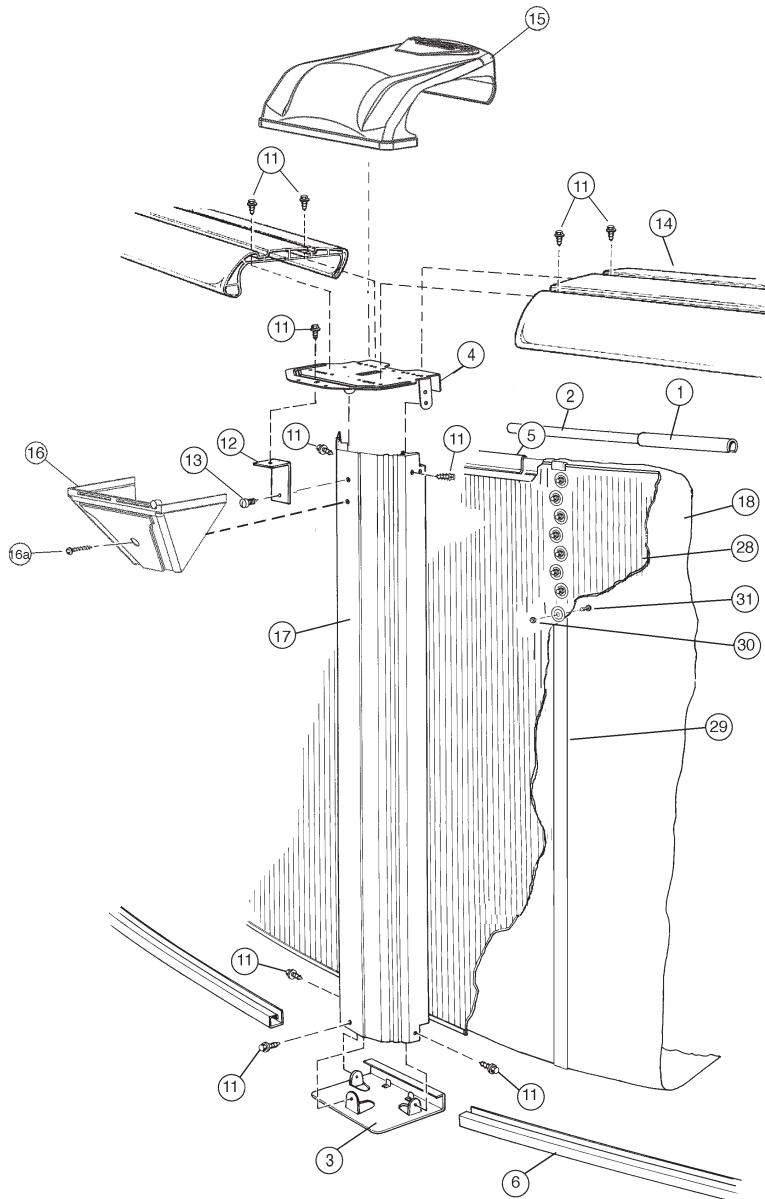

Key #	Part Description	Item #
1	Stabilizer Rail, large dia.	NBP5239
2	Stabilizer Rail, small dia.	NBP5240
3	Bottom Connector	NBP5252
4	Vertical End Cap	NBP5253
5	Plastic Coping, 24"	NBP5200
6	Bottom Rail	NBP5243
11*	Sheet Metal Screw, #10 x 1/2"	NBP5207
12	Vertical Tab	NBP5256
13	#14 x 1/2" Screw	NBP5257

Key #	Part Description	Item #
14	Top Rail	NBP5258
15	Top Connector	NBP5259
16	Vertical Skirt	NBP5260
16a	#10 x 1-1/2" Screw	NBP5218
17	Vertical	NBP5261
28	Sidewall	PC2020
29	Protective Strip	NBP5212
30	1/4-20 Hex Flange Locknut	NBP5213
31	1/4-20 x 1/2" Grade 5 HH Bolt	NBP5213

\* Screws are available at most hardware stores