

Pretium GLX STR  
PPREGLX-CH52SSSTSSFBO  
Channel Lock

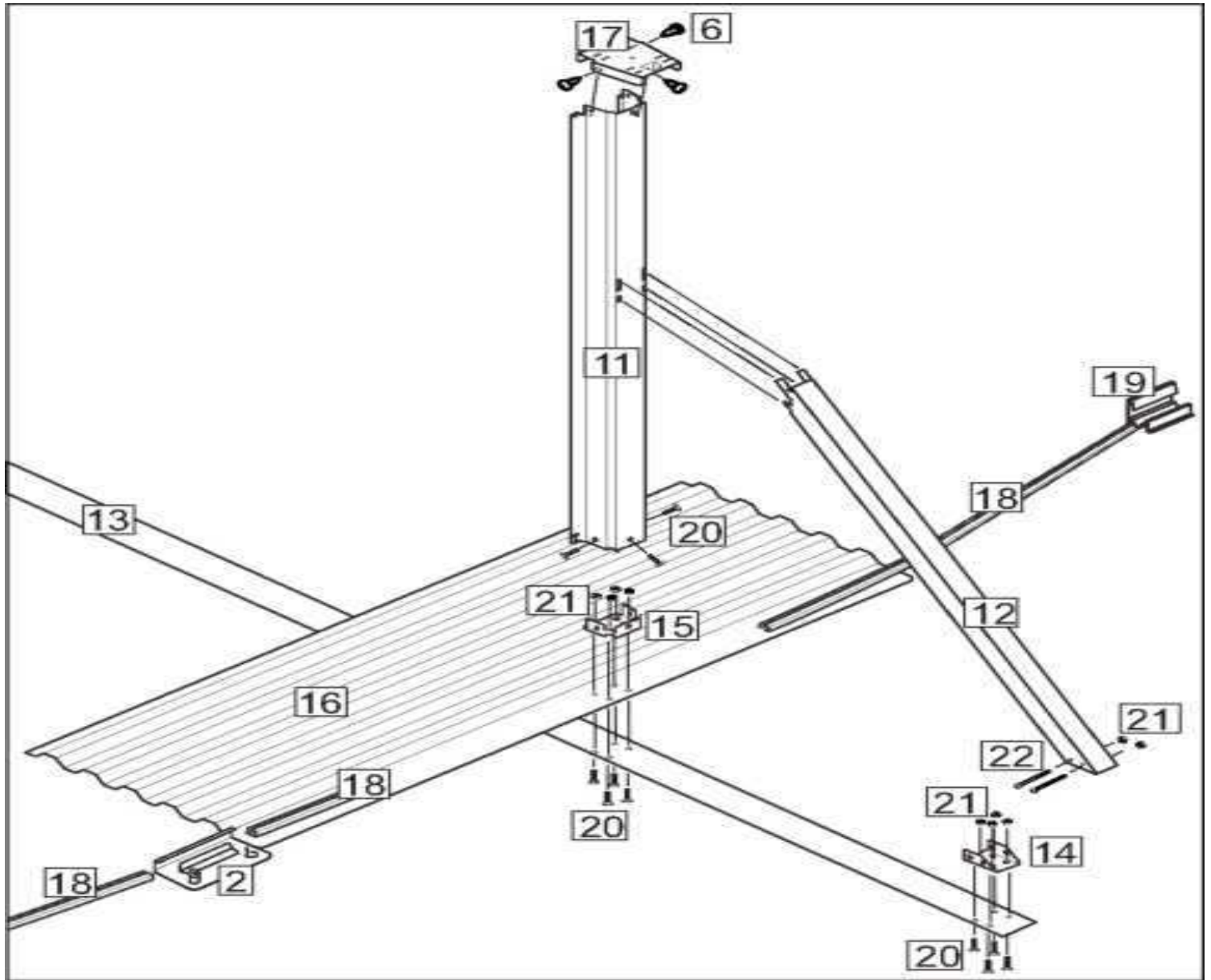

**Product Description:****Pretium GLX Oval**

Revised Sept.2014

**Product Code:****PPREGLX-CH52SSSTSSFBO**

INDEX#	DESCRIPTION	PARTS#	LENGTH	Quantity required for installation (by pool size)				
				1218	1224	1524	1530	1833
7	Top Ledge Curve	1450872	45-15/32"	8	8			
7	Top Ledge Curve	1450873	56-27/32"			8	8	10
7	Top Ledge Trans	1450874	47"		4			
7	Top Ledge Trans	1450875	58-1/4"	4		4	4	4
7	Top Ledge Str Side	1450876	47-1/4"		4	2		
7	Top Ledge Str Side	1450877	58-3/4"				4	4
1	Upright	1440512	51-1/2"	10	10	10	10	12
4	Top Plate	1320102		10	10	10	10	12
17	SideTop Plate	1320160		2	6	4	6	6
2	Bottom Plate	1320101		10	10	10	10	12
n/a	Slotted tube Connector (steel)	1470108		10	10	10	10	12
n/a	Slotted tube Connector - side (resin)	1470087		2	6	4	6	6
n/a	Round Coping	1382480	47"	13	16	17	20	23
19	Rail Support	1490494			4	2	4	4
5	Slotted tube	1470096	44"	8	8			
5	Slotted tube	1470097	55-1/2"			8	8	
5	Slotted tube (Yellow)	1470098	55-1/4"	4				6
5	Slotted tube(Green)	1470100	55-1/2"			4	8	12
5	Slotted tube (Blue)	1470104	44-1/8"		4			
5	Slotted tube (White)	1470105	44-1/8"		4	2		
18	Bottom Rail	1460048	44-5/8"	8	8			
18	Bottom Rail	1460049	56"			8	8	
18	Bottom Rail (Yellow)	1460050	56"	4				6
18	Bottom Rail (Orange)	1460052	56-1/4"			4	4	8
18	Bottom Rail (Blue)	1460138	44-5/8"		4			
18	Bottom Rail (Green)	1255624					4	4
18	Bottom Rail (White)	1254424	44-5/8"		4	2		
9	Ledge cover	1490837		12	16	14	16	18
10	Ledge cover - lower, round end only	1490849		10	10	10	10	12
10	Ledge cover - lower, for buttress only	1490850		2	6	4	6	6
3,6,8	Hardware Pack (Qty. - 59)	1184299						1
3,6,8	Hardware Pack (Qty. - 77)	1184300		2	2	2	2	1
3,6,8	Hardware Pack (Qty. - 29)	1184298						1
	Screw #12-5/8	1184105		154	154	154	154	165
n/a	DVD	36877		1	1	1	1	1
11	Upright	1440514		2	6	4	6	6
12	Diagonal	1440349		2	6	4	6	6
16	Hold Down Plate	1320162		2	6	4	6	6
14	Diagonal Bracket	1320152		2	6	4	6	6
15	Oval bottom Plate	1320154		2	6	4	6	6
	Hardware Pack	1184292		1	3	2	3	3
6	Self tapping screw 12 1/2'	1183273		20	60	40	60	60
21	Flange nut 1/4-20'	1184052		27	81	54	81	81
20	Bolt 1/4x20 x 3/4'	1184275		23	69	46	69	69
22	Bolt 1/4x20 x 2 1/4'	1184276		5	15	10	15	15
13	Strap Section	1510132		1	3			
13	Strap Section	1510133				2	3	
13	Strap Section	1510134						3
	Wall			1	1	1	1	1
	Wall joiner bar	11823		2	2	2	2	2