

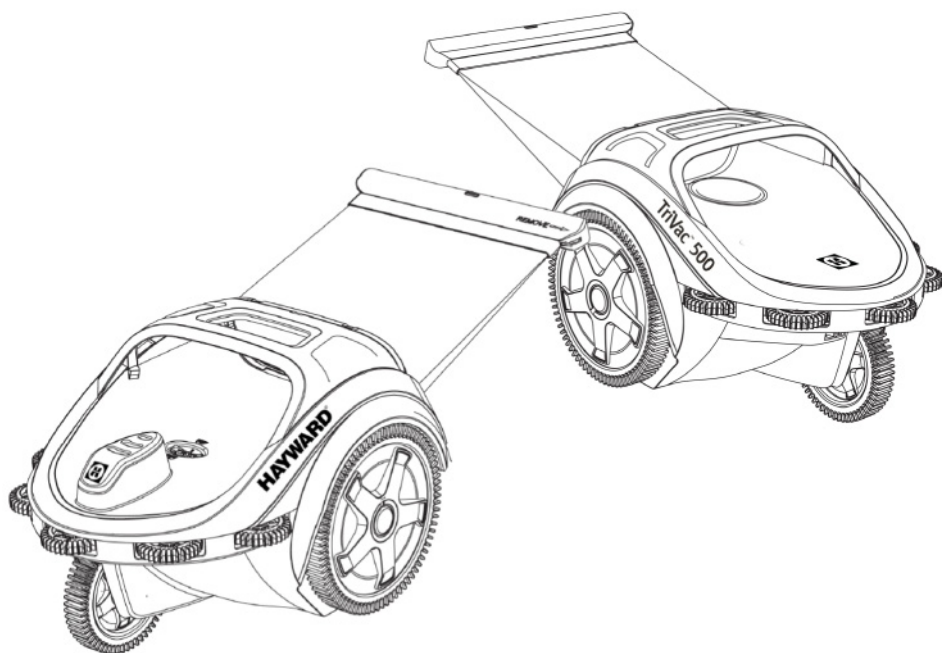

TriVac 500 and 700 Pressure Pool Cleaner owners manual



Hayward Pool Products
620 Division Street | Elizabeth, NJ 07201
www.Hayward-Pool.com

SAFETY FACTS

DO NOT use to remove large debris in new pools.

REMOVE the cleaner before chemically shocking your pool

DO NOT swim with cleaner

Store the cleaner in a shaded safe area

Hoses must be stored straight. **DO NOT** coil the hose

Keep away from childrens and pets

REMOVE cleaner when performing backwash

REMEMBER safety first

TOOLS

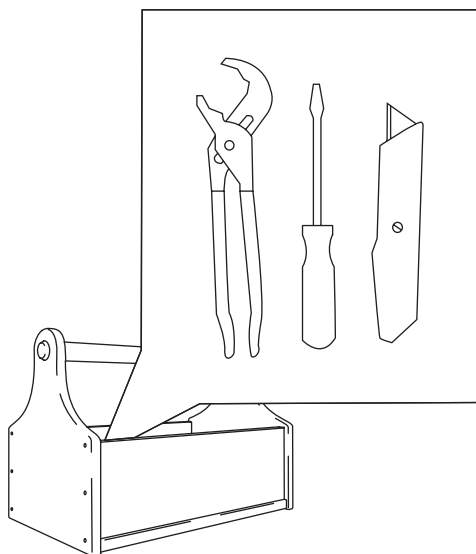

LEGEND



Tip



Filtration pump



Pool chemicals



Warning



Booster pump

CARTON CONTENTS

TriVac 500 or TriVac 700

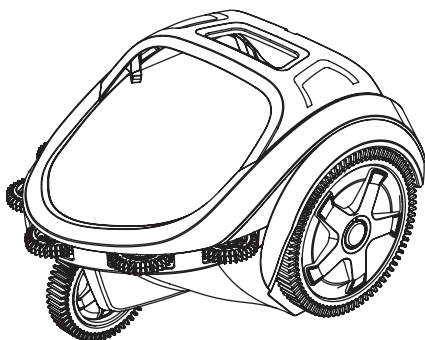

1x

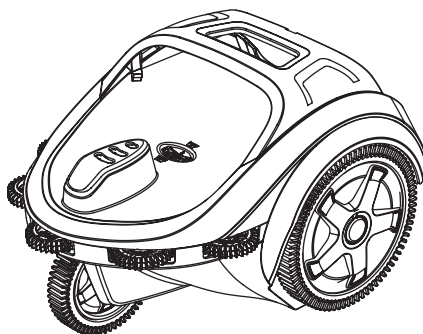

1x

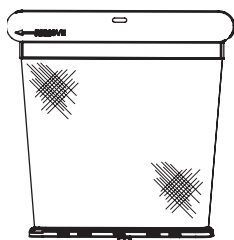

1x

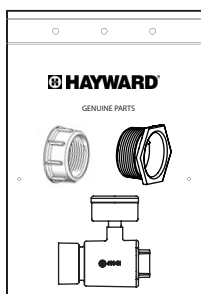

1x

TriVac 500 and 700

WALL CONNECTION

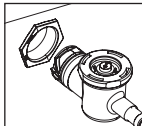

CLEANER SIDE

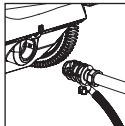

1x Main hose section

1x Cleaner connector hose and sweep tail

PREPARING THE POOL

Manually remove very large and excessive debris from pool (ie. post storm, spring cleaning / pool opening situations).

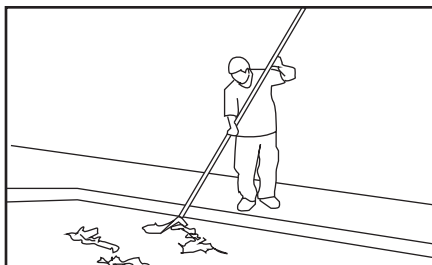

Perform a backwash, clean your filter, skimmer baskets and pump basket.

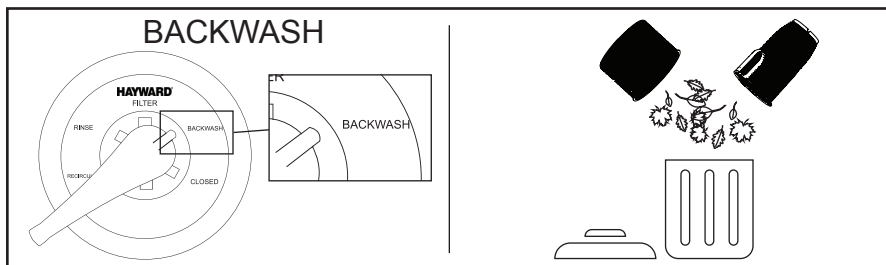

POOL CHEMICALS



pH : 7.2 - 7.6

Chlorine : 0.5 - 1.5 P.P.M

Total Alkalinity : 80 - 150 P.P.M

DEDICATED RETURN LINE

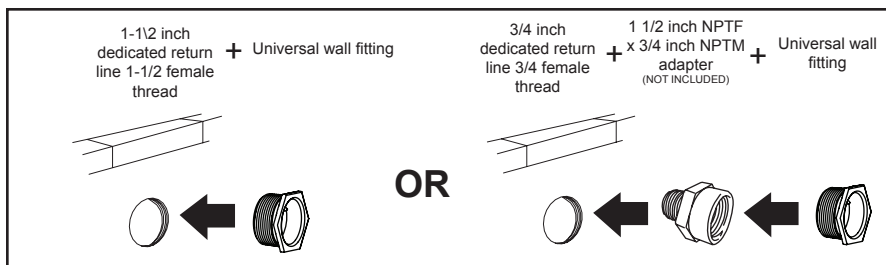

CONNECTING THE TRIVAC

INSTALLING WALL FITTING

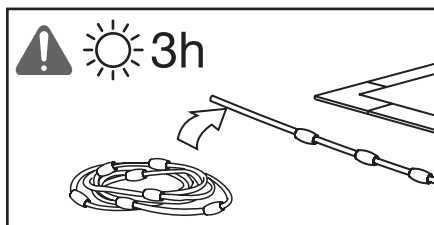

Lay the hose straight for 3 hours
OR run on bottom mode for a full
cleaning cycle.

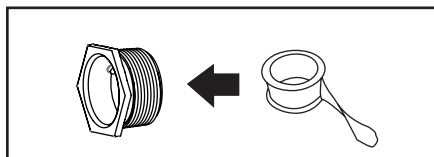

When installing or re-
installing the universal
wall fitting use Teflon tape
on its plastic threads.

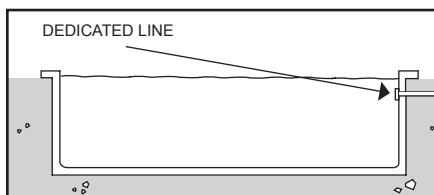

Remove plug or existing universal
wall fitting from previously installed
pool cleaner (if any).

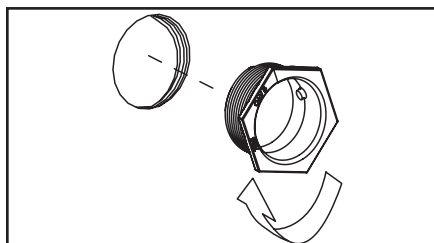

Screw the universal wall fitting into
the dedicated line.
(see p.4)

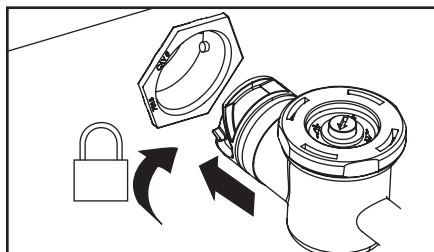

Connect pressure hose with the wall
quick connect

SIZING PRESSURE HOSE

Sizing the hose should be performed without the last section.

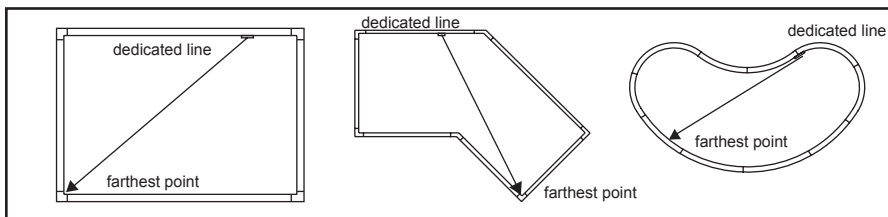
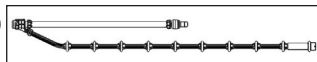

Connect the hose to wall connector

Pull main hose to farthest point of the pool.

Extend hose to furthest part of pool.

Measure to 3-4 feet over the edge of the pool and mark hose.

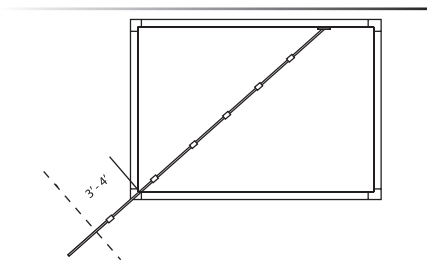

Cut the excess length. For every 2 feet of hose removed, one float should be removed starting with the closest from the cutting area. All the remaining floats should remain at same position

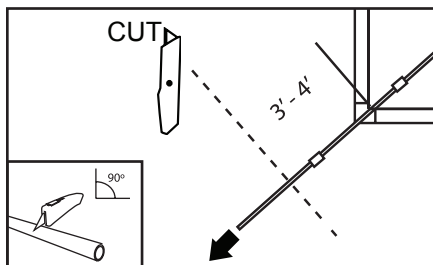

DO NOT cut the sweep hose

Assembling cleaner connector hose with sweep tail to main pressure hose

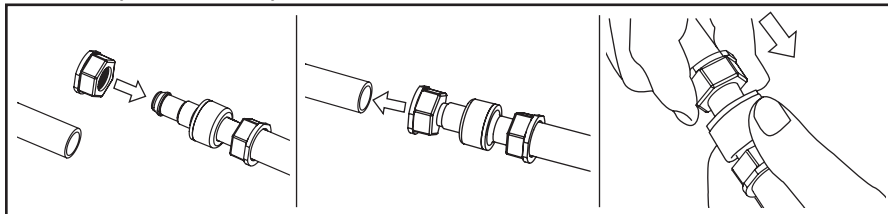
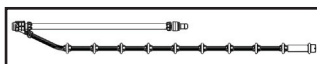

DEBRIS BAG

ATTACHING DEBRIS BAG

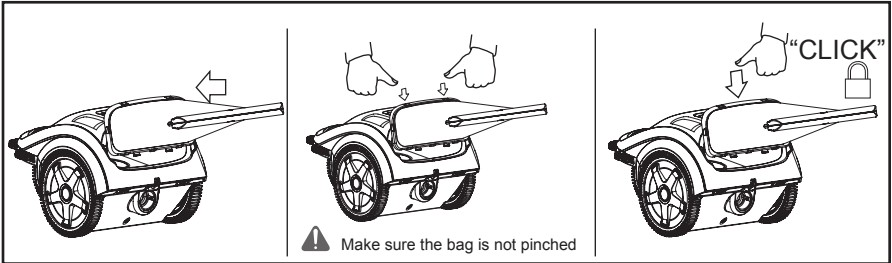

REMOVING DEBRIS BAG

Pull the top of the debris bag frame back and then up.

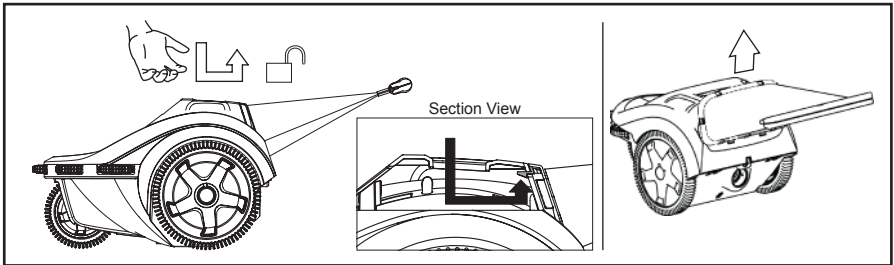

CLEANING DEBRIS BAG

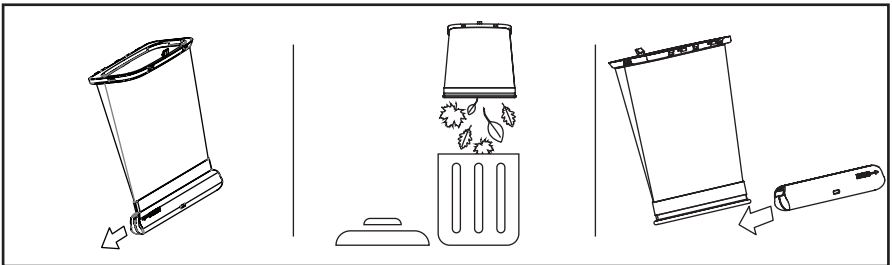

Full debris bag can reduce cleaner performance.



if you allow the bag to dry it will be easier to remove the debris

SETTING PRESSURE



Too much pressure will cause poor cleaning and premature wear of cleaner parts.

Low pressure will affect cleaner's performance and cleaning capability



BACKWASH

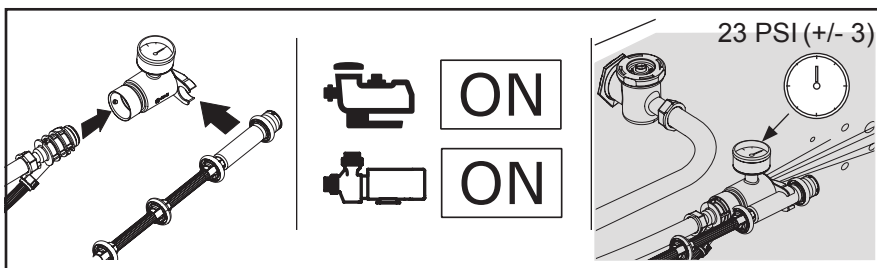
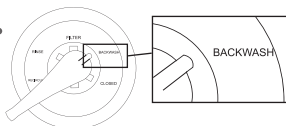

Use a flat blade screwdriver to adjust the wall quick connect knob to reach 23 PSI (+/- 3)

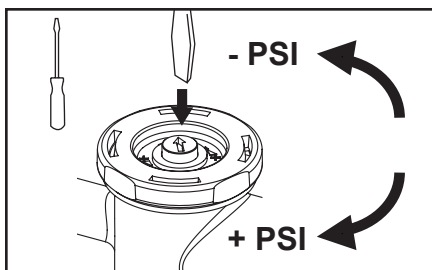

Check pressure regularly

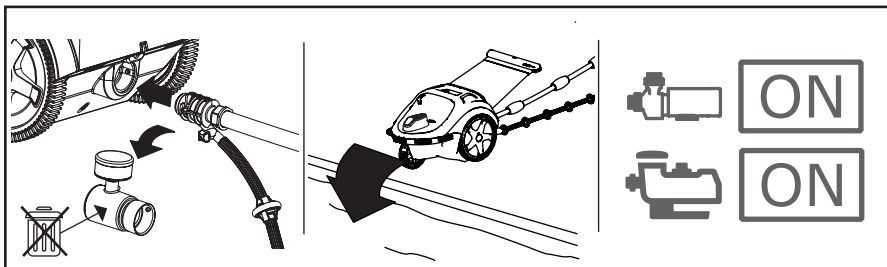

TRIVAC NORMAL OPERATION

The TriVac 500 (bottom/wall only) and 700 (when in bottom/wall mode) offers best in class pool coverage. Its unique AquaDrive system enables the cleaner to easily climb walls often reaching into areas such as sun shelves or benches that other pressure cleaners simply can't.

While most of the pool can be cleaned in 1 hour, 3 hours is considered normal for complete coverage of a standard pool. The cleaning cycle should be extended on pools with special features or shapes such as shelves, steps or swim-outs to allow the TriVac to fully clean all surfaces.

Please note that TriVac will not operate properly on areas where the water is less than 8" deep.

OPERATING THE TRIVAC 700

CHANGING BOTTOM TO SKIM

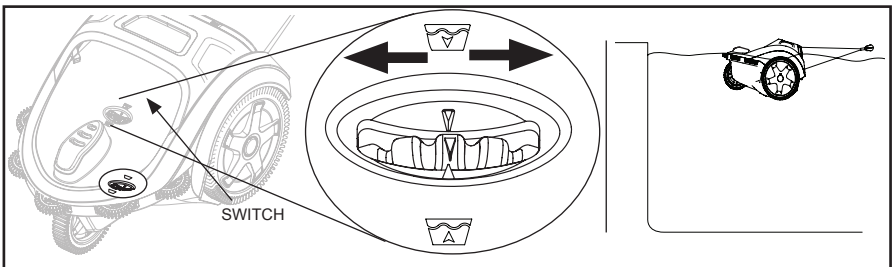

CHANGING SKIM TO BOTTOM

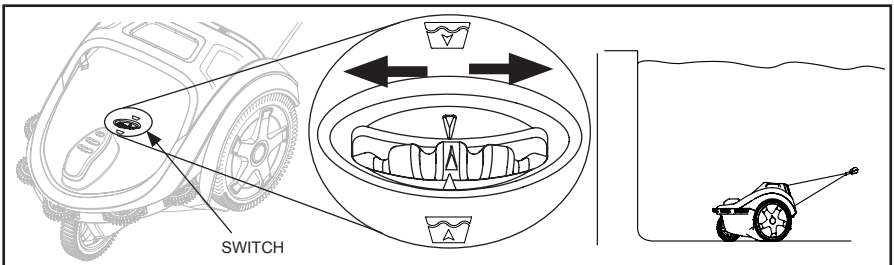

ADJUSTING THE SWEEP HOSE

ADJUSTING SWEEP HOSE POWER

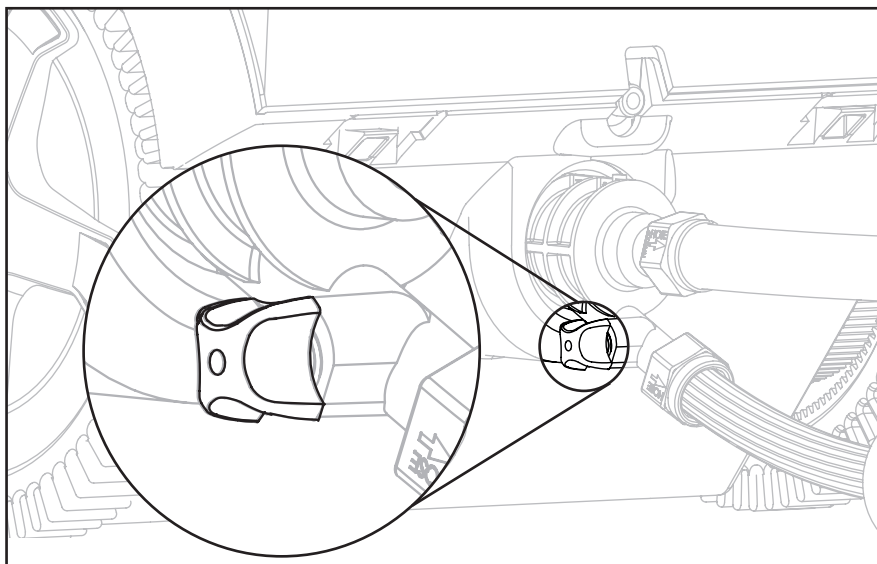

SWEEP HOSE MOVES SLOWLY OR NOT AT ALL: turn the adjustment knob counter-clockwise to increase sweep hose power.

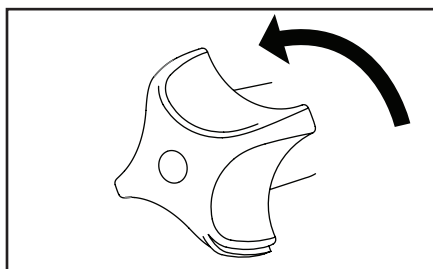

SWEEP HOSE FREQUENTLY SPRAYS OUT OF THE POOL: turn the adjustment knob clockwise to reduce sweep hose power.

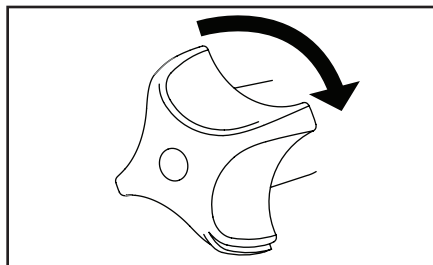

MAINTENANCE

REMOVE CLEANER FROM POOL

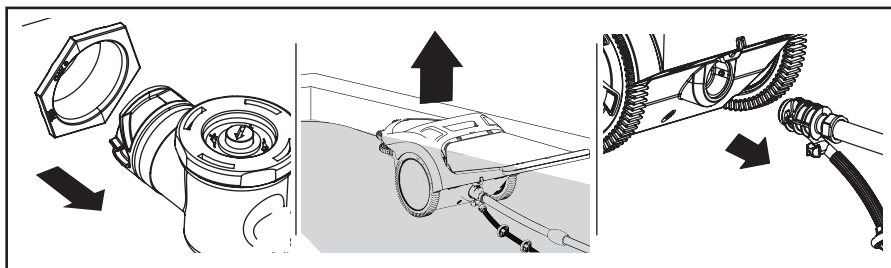

CLEANING THE IN-LINE FILTER

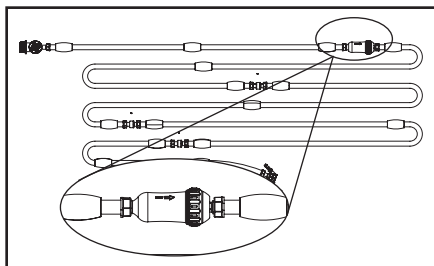

if the screen frequently becomes plugged, the filtration system is not performing properly or there is another plumbing problem.

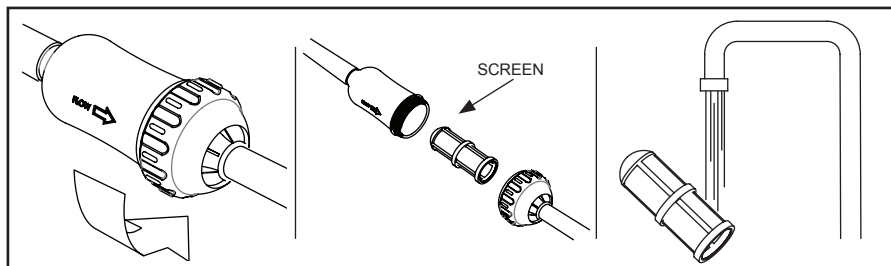

Make sure the o-ring is in place and properly seated.

REPLACING PARTS

SWEEP HOSE

If a hole forms in the sweep hose, it should be replaced. Unscrew the mender nut from the hose and pull the sweep hose off the cleaner connector. Attach a new sweep hose to the cleaner connector.

PART NUMBER: TVX7000HST-01

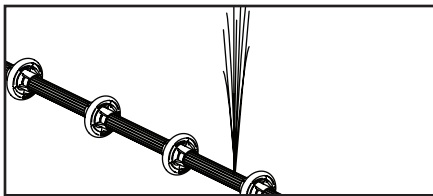

SWEEP HOSE ROLLERS

The Sweep hose rollers are wear parts. When the rollers wear-down to the outer groove (wear line) replace the wear roller.

PART NUMBER: TVX7081-01

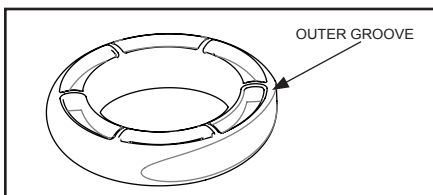

DEBRIS BAG

The debris bag should be replaced if it is torn.

PART NUMBER: TriVac 500 TVX5000BA

TriVac 700 TVX7000BA

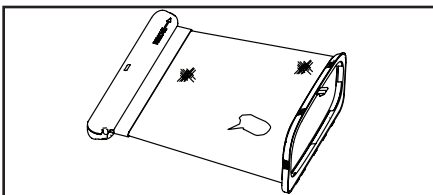

SWIVELS

If a swivel ceases to turn easily or leaks while the cleaner is running, it should be replaced.

PART NUMBER: TVX7000SA-01

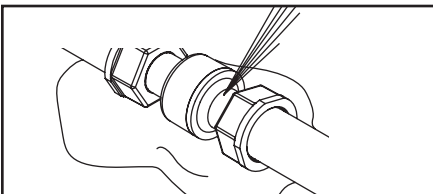

TIRES

The tires are wear parts. When the tires wear-down to the wear marks replace the tire.

PART NUMBER: TVX7000RW-01 (X2)

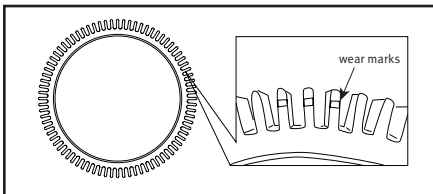

SIDE ROLLERS

The side rollers are wear parts. When the side rollers wear-down, replace the side rollers.

PART NUMBER: TVX7036-234 (X5)

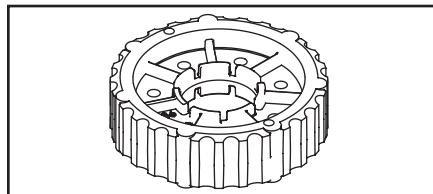

TROUBLESHOOTING

FOR TECHNICAL ASSISTANCE

CALL: 1-800-227-1477

PROBLEM	CAUSE	SOLUTION
Slow or no forward movement	Low or no water pressure	Check filtration and booster pumps, valves, cleaner connections. Check Cleaner pressure. (backwash)
Cleaner does not reach farthest point in pool	Hose too short	Add extra hose section if necessary
Cleaner unable to clear obstacles (stairs, steps...)	Hose too short	Add extra hose section
Hose frequently tangles	Float not properly placed	Check position of floats on the hose (see diagram)
	Hose too long	Check hose length
	Sweep hose not moving	Check sweep hose for holes or clogs, increase sweep hose power.
Sweep hose sprays out of pool	Sweep hose power too strong	Reduce sweep hose power
Little or no sweep hose movement	Sweep hose power too weak	Increase hose power
	Hole in sweep hose	Replace sweep hose
	Debris clogging sweep hose	Disconnect sweep hose and flush out
Trivac running on side or upside down	Heavy debris	Empty Bag
	Incorrect pressure setting	Check operating pressure
Cleaner cannot climb to the surface in TOP mode	Incorrect pressure setting	Check operating pressure
	Too much heavy debris in bag	Empty bag
Cleaner runs in small circles	Hose assembly bent	Layout in sun until straight
Cleaner get stuck on shallow area of pools (beach entry, tanning shelf...)	The sweep hose may interfere with obstacle	Operate the cleaner without the sweep hose
Cleaner inability to recover from obstacle or specific areas	The sweep hose may interfere with obstacle	Operate the cleaner without the sweep hose
	Operating pressure too low	Check operating pressure
Cleaner does not cover the entire pool	The sweep hose affects cleaning pattern of cleaner	Operate the cleaner without the sweep hose

WARRANTY

A limited warranty program protects your HAYWARD TRIVAC cleaner. To take full advantage of the limited warranty, **please, read, complete and return registration card within the 14 days of purchase date.** Your warranty card is packed in the Owner's Guide and accessory pack.

HAYWARD POOL PRODUCTS LIMITED WARRANTY

To original purchasers of this equipment, Hayward Pool Products warrants these cleaners to be free from defects in materials and workmanship for a period of TWO (2) year (TriVac 700) or One (1) year (TriVac 500) from the date of purchase, when used in single family residential applications.

The limited warranty excludes damage from freezing, negligence, improper installation, improper use or care or any Acts of God. Parts that fail from a defect or become defective during the warranty period shall be repaired or replaced, at our option, within 90 days of the receipt of defective product, barring unforeseen delays, without charge.

Proof of purchase is required for warranty service. In the event proof of purchase is not available, the manufacturing date of the product will be the sole determination of the purchase date.

To obtain warranty service, please contact the place of purchase or the nearest Hayward Authorized Service Center. For assistance on your nearest Hayward Authorized Service Center please visit us at www.hayward-pool.com.

Hayward shall not be responsible for cartage, removal, repair or installation labor or any other such costs incurred in obtaining warranty replacements or repair.

The Hayward Pool products warranty does not apply to components manufactured by others. For such products, the warranty established by the respective manufacturer will apply.

The express limited warranty above constitutes the entire warranty of Hayward Pool Products with respect to its' pool products and is in lieu of all other warranties expressed or implied, including warranties of merchantability or fitness for a particular purpose. In no event shall Hayward Pool products be responsible for any consequential, special or incidental damages of any nature.

Some states do not allow a limitation on how long an implied warranty lasts, or the exclusion of incidental or consequential damages, so the above limitation may not apply to you. This warranty gives you specific legal rights, and you may also have other rights, which vary from state to state.

REGISTRATION CARD

DETACH HERE: Fill out bottom portion completely and mail within 10 days of purchase/installation or register online

WARRANTY REGISTRATION CARD

Register online at www.haywardnet.com

Please Print Clearly:

First Name _____

Last Name _____

Street Address _____

City _____ State _____ Zip _____

Phone Number _____ Purchase Date _____

E-Mail Address _____

Serial Number _____

Model Number _____

Pool Capacity _____ (U.S. Gallons)

☐ Please include me on all e-mail communications regarding Hayward® Equipment or promotions.

Mail to: Hayward Pool Products, 620 Division Street, Elizabeth, NJ 07207

Attn: Warranty Dept

or REGISTER YOUR WARRANTY ON-LINE AT WWW.HAYWARDNET.COM

Thank you for your purchase.

Years Pool has been in service

☐ < 1 year ☐ 1-3 ☐ 4-5 ☐ 6-10 ☐ 11-15 ☐ >15

Purchased from

☐ Builder ☐ Retailer ☐ Pool Service ☐ Internet/Catalog

Company Name _____

Address _____

City _____ State _____ Zip _____

Phone _____

Type of Pool:

☐ Concrete/Gunite ☐ Vinyl ☐ Fiberglass

Other _____

☐ New Installation ☐ Replacement

Installation for:

☐ In Ground ☐ Above Ground ☐ Spa



Hayward Pool Products
620 Division Street | Elizabeth, NJ 07201
www.Hayward-Pool.com