

## Product Image and Dimensions

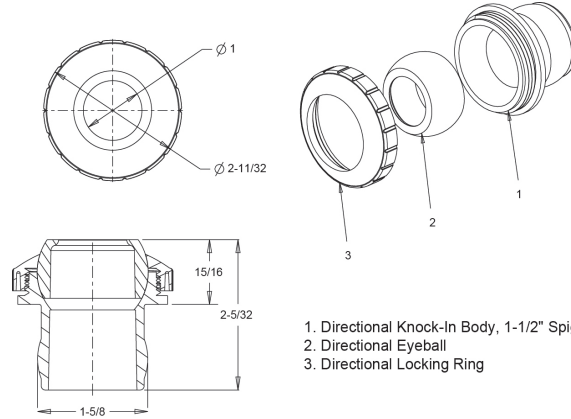

**Part # 41xx**









1. Directional Knock-In Body, 1-1/2" Spigot  
2. Directional Eyeball  
3. Directional Locking Ring

### FEATURES

- Knocks into standard 1½" pipe
- Self-leveling for pipe and surface construction variations
- Manufactured from engineered polymer UV-resistant ABS material

250 per case

### STANDARD COLORS

	4101	Additional orifice size suffix:
	4102	42xx - ¾"
	4103	43xx - ½"
	4104	44xx - Slotted Down-Jet
	4105	(i.e. 4201 = white ¾" orifice)
	4108	Also available in Clear
		(p/n 4100, 4200, 4300, 4400)

## AquaStar Specific Eyeball GPM, Velocity and Head Loss Ratings

GPM	41xx (1")		42xx (¾")		43xx (½")		44xx (Down-Jet)	
	Velocity (fps)	Head Loss (ft)	Velocity (fps)	Head Loss (ft)	Velocity (fps)	Head Loss (ft)	Velocity (fps)	Head Loss (ft)
5	2.2	0.1	3.6	0.5	8.2	2.4	10.1	2.1
10	4.4	0.5	7.3	1.8	16.3	8.7	20.2	8.1
15	6.6	1.1	10.9	3.7	24.5	18.6	30.3	20.7
20	8.8	1.9	14.5	6.2	32.4	32.0		
25	11.0	3.0	18.2	9.4				
30	13.2	4.4	21.8	13.1				
35	15.4	6.1	25.4	17.3				
40	17.6	8.0						
45	19.7	10.2						
50	21.9	12.7						