

32" CHANNEL DRAIN ANTI-ENTRAPMENT SUCTION OUTLET COVER AND PVC THREE-PORT MANUFACTURED SUMP



VGB CERTIFIED SPECIFICATIONS

Floor Flow Rating
236 GPM at 3.4 fps

Wall Flow Rating
136 GPM at 1.9 fps

Sump Depth
Use sump included

Open Area
22.6 in²

FEATURES

All components meet or exceed ANSI/APSP 16-2011 and NSF/ANSI 50-2009a national standards and ASTM G154 UV testing exposure

Three ports: bottom 2½" OD, 2" ID S/S; inside 2" threaded FPT; two 2" threaded plugs included

Strong PVC sump does not require transitional glue

Designed for use with 2" hydrostatic relief valve part #HVxxx (see page 103)

Disposable plastic pre-gunite/plaster insert keeps debris out and retains sump shape during construction

#316 stainless steel screws

Manufactured from superior UV-resistant engineered polymers

Online product support including downloadable CAD files, General Certificate of Conformity, third-party certificate, installation instructions and more

Replace drain cover every five years from the date of installation

4 per case

U.S. patent 20140157510

Unblockable!

NEW Improved water stop and sump design



NEW Water Stop and Textured Sump

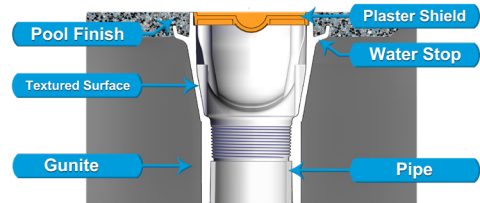

With sump (concrete pools)
Part # 32CDAVxxx

STANDARD COLORS

- 32CDAV101 – White
- 32CDAV102 – Black
- 32CDAV103 – Light Gray
- 32CDAV105 – Dark Gray

Also available as sump only,
p/n 32CDPxxx
4 per case

Also available cover only without
sump/frame, p/n 32CDAVNFxxx
20 per case

VGB 2008 Compliant

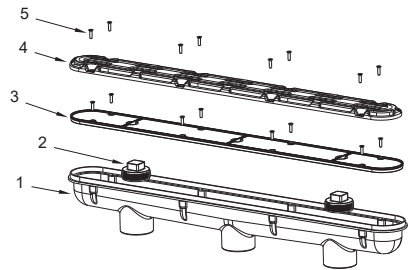
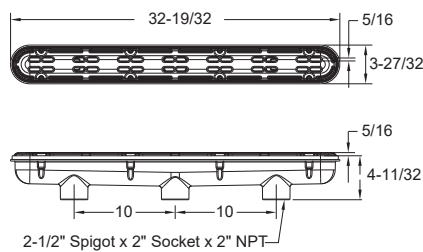

1. 32" Three-Port PVC Sump
2. 2" Tapered Threaded Pipe Plug, Qty 2
3. 32" Channel Drain Plaster Shield
4. 32" Channel Drain Anti-Entrapment Cover
5. 10 x 3/4" Flat Head Phillips, 316 SS, Qty 16